

KENNEDY STREET

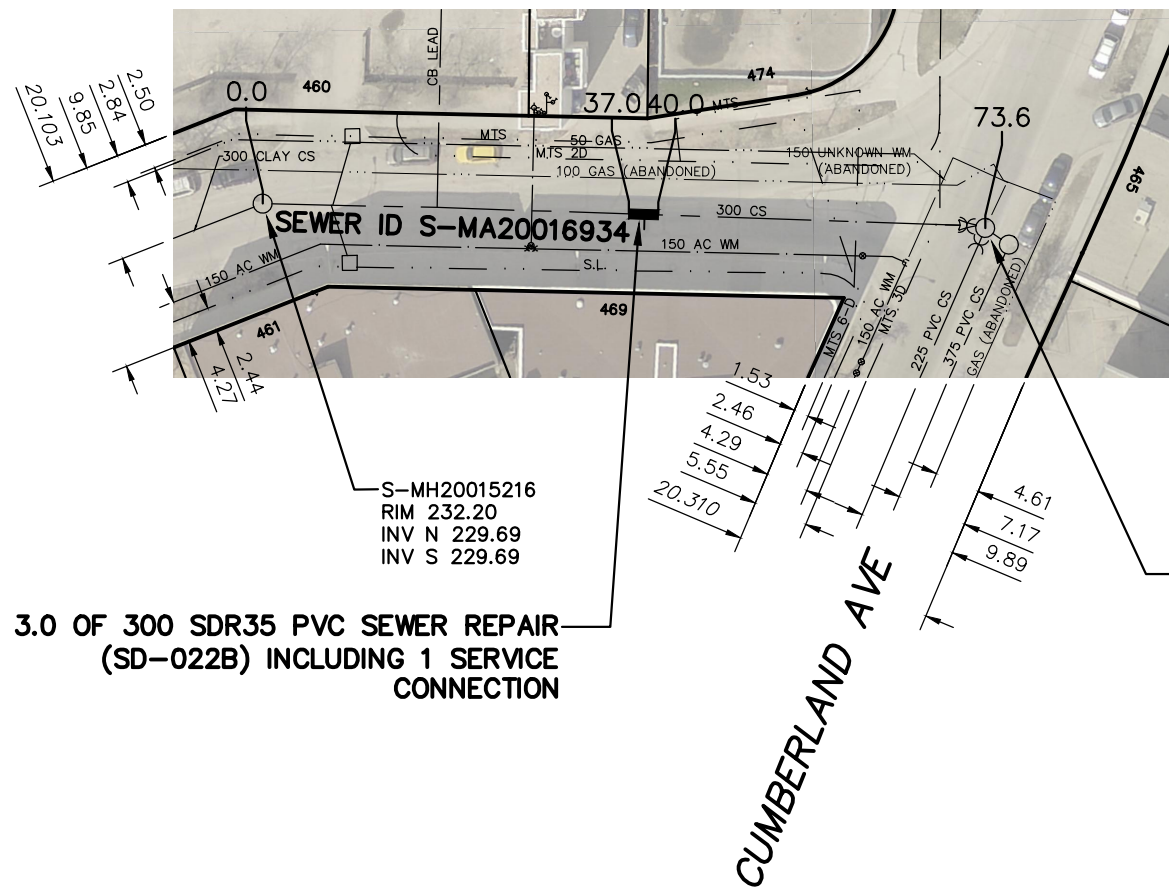
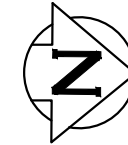

SEWER JUNCTION INFORMATION FROM SEWER VIDEO INSPECTION		
SEWER ID S-MA20016934		
DISTANCE FROM MH ID S-MH20015216		
DISTANCE	DIAMETER	CLOCK
12.8	250	10
25.3	250	3
25.9	250	9
34.1	150	10
38.6	150	3
46.6	150	10
59.1	150	10
64.8	150	10

FOR INDEX SEE 11308

3.0 OF 300 SDR35 PVC SEWER REPAIR (SD-022B) INCLUDING 1 SERVICE CONNECTION

S-MH70040161
RIM 232.17
WEIR 229.17
INV N 228.49
INV E 228.90
INV S 228.94

WARNING

IF POWER EQUIPMENT OR EXPLOSIVES ARE TO BE USED FOR EXCAVATION ON THIS PROJECT THE CONTRACTOR MUST:

- 1) NOTIFY THE GAS COMPANY OF THE PROPOSED LOCATION OF EXCAVATION.
- 2) TAKE PRECAUTION TO AVOID DAMAGE TO GAS COMPANY INSTALLATIONS.

SEE PROVINCIAL REGULATION 210/72 FOR DETAILS

METRIC

WHOLE NUMBERS INDICATE MILLIMETRES
DECIMALIZED NUMBERS INDICATE METRES

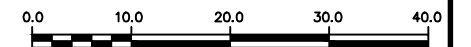

LOCATION APPROVED
UNDERGROUND STRUCTURES

SUPV. U/G STRUCTURES COMMITTEE DATE

NOTE:

LOCATION OF UNDERGROUND STRUCTURES AS SHOWN ARE BASED ON THE BEST INFORMATION AVAILABLE BUT NO GUARANTEE IS GIVEN THAT ALL EXISTING UTILITIES ARE SHOWN OR THAT THE GIVEN LOCATIONS ARE EXACT. CONFIRMATION OF EXISTENCE AND EXACT LOCATION OF ALL SERVICES MUST BE OBTAINED FROM THE INDIVIDUAL UTILITIES BEFORE PROCEEDING WITH CONSTRUCTION.

B.M. ELEV.			
NO.	REVISIONS	DATE	BY

DESIGNED BY	TS	CHECKED BY	SC
DRAWN BY	RJ	APPROVED BY	KZ
SCALE:	1:750	RELEASED FOR CONSTRUCTION	K. ZUREK
HORIZONTAL		DATE	
VERTICAL	DATE	2016 11 18	

ENGINEER'S SEAL
ORIGINAL SIGNED BY S.R.J. COURNOYER 16/11/14
CONSULTANT DRAWING NUMBER -



THE CITY OF WINNIPEG
WATER AND WASTE DEPARTMENT
ENGINEERING DIVISION

2016 SEWER MAIN RENEWALS
BY EXTERNAL POINT REPAIR
KENNEDY STREET
1ST MH S OF CUMBERLAND AVENUE TO
MH AT CUMBERLAND AVENUE

SHEET 13 OF 29
CITY DRAWING NUMBER

11320

PLOT DATE: 2016 11 18

BID OPPORTUNITY: 967-2016
CONTRACT NUMBER: 6A

FILE PATH: R:\DRAWINGS\SEWER\2016 RENEWALS\Contract 6A\CONSTRUCTION\
FILE NAME: KENNEDY_S-MA20016934.dwg