

ROOM FINISH SCHEDULE

RM NO.	NAME	FLOOR		BASE			NORTH WALL		EAST WALL		SOUTH WALL		WEST WALL		CEILING			MISCELLANEOUS		OTHER REQUIREMENTS
		SUB FLOOR	FIN	HGT	MATL	FIN	MATL	FIN	MATL	FIN	MATL	FIN	MATL	FIN	MATL	FIN	HGT	ITEM	MATL	
M102	WOMEN'S LOCKER ROOM	-	-	-	-	-	-	-	-	-	-	-	-	-	ACT/CEMBD	-/PTD	VARIABLE	-	-	*ONLY AT SHOWER AREAS INDICATED ON DRAWINGS
M107	STORAGE ROOM 2	CONC	CLR SLR	-	-	-	EXST	PTD	EXST	PTD	CMU/EXST	PTD	EXST	PTD*	ACT	-	2800	-	-	*ONLY AT SHOWER AREAS INDICATED ON DRAWINGS
M110	MEN'S LOCKER ROOM	CONC	CT*	-	-	-	EXST	CT	EXST	CT	EXST	CT	EXST	CT*	ACT/CEMBD	-/PTD	VARIABLE	-	-	*ONLY AT SHOWER AREAS INDICATED ON DRAWINGS -SEE DWGS & DETAILS FOR LOCATION OF CEMENT BOARD DRYWALL BULKHEAD
M123	CONTROL ROOM	CONC	SMLQ	100	SST	SST	GWB	PTD	GWB	PTD	GWB	PTD	GWB	PTD	ACT/GSB	-/PTD	2800/2750	-	-	-
M145	JANITOR'S CLOSET	CONC	CLR SLR	200	CONC	CLR SLR	CMU	PTD	EXST	PTD	EXST	PTD	CMU	PTD	-	-	-	-	-	-

ABBREVIATIONS

AC	ACOUSTICAL CEILING	CRC	CHEMICAL RESISTANT COATING	HGT	HEIGHT	RRUB	RADIAL RUBBER FLOORING
ACFL	ACCESS FLOORING	CT	CERAMIC TILE	HDNR	HARDENER	RSF	RUBBER SHEET FLOORING SEALER
ACMU	ACOUSTICAL CMU	EIFS	EXTERIOR INSULATION FINIS SYSTEM	MATL	MATERIAL	SF	SPECIAL (SEAMLESS) FLOORING SEALER
ACT	ACOUSTIC TILE CEILING	EXP	EXPOSED STRUCTURE	MDO	MEDIUM DENSITY OVERLAY	SLR	SEALER
AFP	ALUMINUM FACED PLYWOOD PANEL	FRP	FIBERGLASS REINFORCED PLASTIC	METAL	METAL	SMLS	SEAMLESS EXPOXY
AL	ALUMINUM	FRP	FIBERGLASS REINFORCED PLASTIC	PLAM	PLASTIC LAMINATE	SMLQ	SEAMLESS FLOORING (QUARTZ)
BRK	BRICK	FWC	FABRIC WALL COVERING	PLAS	PLASTER	SOI	SPRAYED - ON INSULATION
CLR	CLEAR	FNSH	FINISH	PAVT	PAVER TILE	SVIN	SHEET VINYL
CEMBD	CEMENT BOARD	GMU	GLASS MASONRY UNITS	PLWD	PLYWOOD	TCTG	TRAFFIC COATING
CMU	CONCRETE MASONRY UNITS	GCMU	GLAZED CONCRETE MASONRY	PNL	PANELING	TLS	TO LATER SELECTION
COL	COLOR	GWB	GLASS MASONRY UNITS	PTD	PAINTED	VCT	VINYL COMPOSITION TILE
CONC	CONCRETE	GSB	GYPSTUM SOFFIT BOARD	PTN	PARTITION	VT	VINYL TILE
CNTR	COUNTER	GLZ	GLAZING	QT	QUARRY TILE	VWC	VINYL WALL COVERING
CPT	CARPET			RESIL	RESILIENT	X	OPEN
CS	COLOR SEALER						

GENERAL NOTES

1. PROVIDE ABRASIVE NOSING INSERTS ON ALL STAIRS AND LANDINGS.
2. PAINT ALL EXPOSED STEEL STRUCTURE.
3. PAINT U/S OF STAIRS, LANDINGS AND ALL EXPOSED STAIR COMPONENTS.
4. EXTENT OF CT ON WALLS MIN. 200mm ABOVE ACOUSTICAL CEILING.
5. COLOUR OF ALL FINISHES: TLS

DOOR AND HARDWARE SCHEDULE

LEVEL	DOOR NO.	FROM ROOM NO.	TO ROOM NO.	DOOR DATA					FRAME DATA			HARDWARE DATA																						
				DOOR SIZE	ULC LABEL (MINUTES)	DOOR TYPE	MATERIAL	FINISH	GLASS	FRAME TYPE (ELEVATION)	MATERIAL	FINISH	FRAME TYPE (SECTION)	HINGE	LOCKSET	EXIT DEVICE (ACTIVE LEAF)	EXIT DEVICE (INACTIVE LEAF)	CLOSER	DOOR STOP	BOLTS	KICKPLATE	THRESHOLD	AUTOMATIC DOOR BOTTOM	WEATHER STRIPPING	ELECTRIC STRIKE / ELECTRIC HINGES	POWER SUPPLY	PULL HANDLE	SECURITY CONTROL SYSTEM	NAMEPLATE	MISCELLANEOUS				
BASEMENT	M107-A	M107	-	900 x 2150	-	D1	STL	PTD	-	F1	STL	PTD	1	H1	L6	-	-	C4	-	-	-	-	-	-	-	-	-	-	-	-	-	-	N1	VERIFY EXISTING OPENING
	M110-A	M110	-	900 x 2150	-	D1	STL	PTD	-	F1	STL	PTD	1	H1	-	-	-	C4	S2	-	-	-	-	-	-	-	-	-	-	-	-	-	N1	VERIFY EXISTING OPENING
	M110-B	M110	-	900 x 2150	-	D1	STL	PTD	-	F1	STL	PTD	1	H1	-	-	-	C4	-	-	-	-	-	-	-	-	-	-	-	-	-	-	N1	VERIFY EXISTING OPENING
	M110-C	M110	-	900 x 2150	-	D1	STL	PTD	-	F1	STL	PTD	1	H1	-	-	-	C4	S2	-	-	-	-	-	-	-	-	-	-	-	-	-	N1	VERIFY EXISTING OPENING
	M110-D	M110	-	900 x 2150	-	D1	STL	PTD	-	F1	STL	PTD	1	H1	-	-	-	C4	-	-	-	-	-	-	-	-	-	-	-	-	-	-	N1	VERIFY EXISTING OPENING
GROUND FLOOR	M123-A	M127	M123	900 x 2150 625 x 2150	-	D6	STL	PTD	WG	F4	STL	PTD	1	H1	L13	-	-	C3	S1	B1	-	-	-	-	-	-	-	-	-	-	-	N1	VERIFY EXISTING OPENING	
	M145-A	M127	M145	900 x 2150	-	D1	STL	PTD	WG	F1	STL	PTD	1	H1	L6	-	-	C1	-	-	-	-	-	-	-	-	-	-	-	-	-	N1	VERIFY EXISTING OPENING	

DOOR TYPES

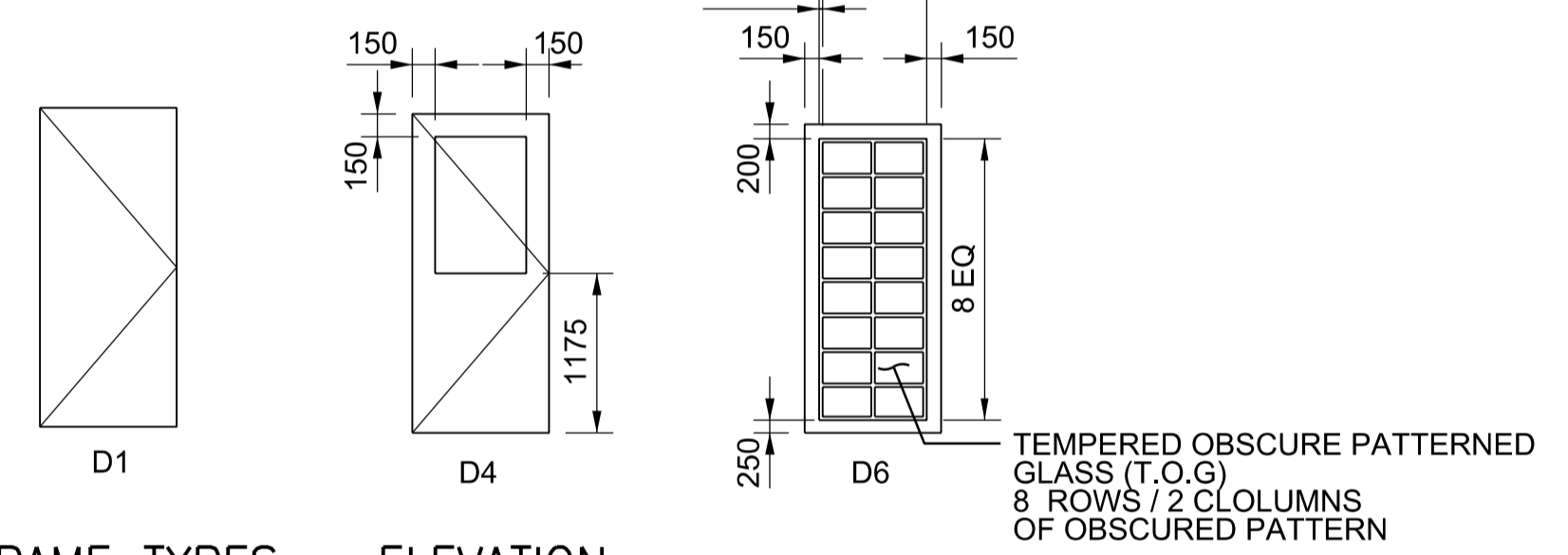

FRAME TYPES - ELEVATION

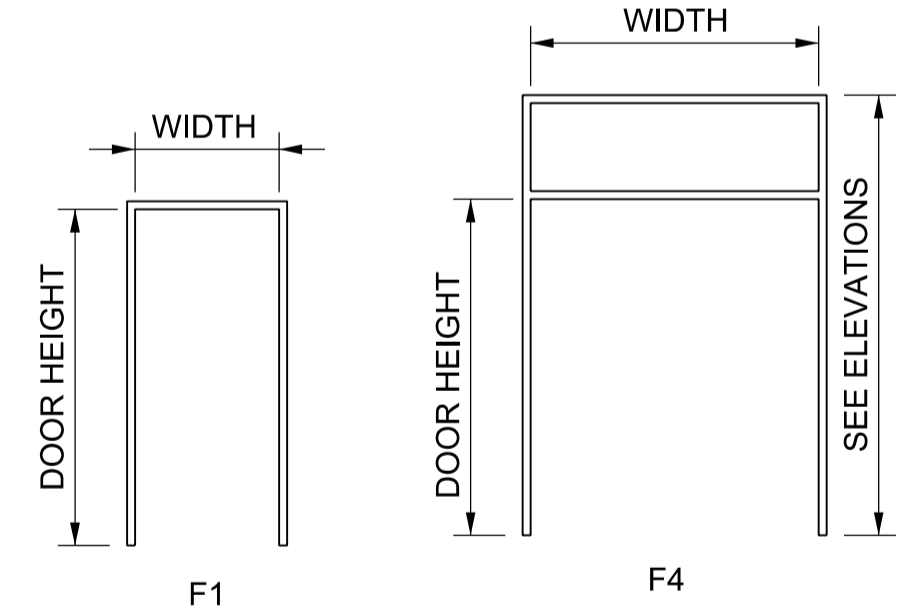

FRAME TYPES - SECTIONS

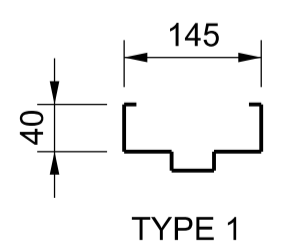

ABBREVIATIONS

AL	ALUMINUM	HM	HOLLOW METAL	RFS	ROLL-UP FIRE SHUTTER
AS	AS SELECTED	IP	INSULATED PANEL	SCI	SECURITY CONTROL ITEMS
CA	CLEAR ANODIZED	IAP	INSULATED ALUMINUM PANEL	STL	STEEL
CLSR	CLOSER	KEY	KEY GROUP	SST	STAINLESS STEEL
COL	COLOR	K-PL	KICKPLATE (BOTH SIDES)	TSHD	THRESHOLD
CONSTR	CONSTRUCTION	MATL	MATERIAL	TLS	TO LATER SELECTION
ES	ELECTRIC STRIKE	MET	METAL	WG	WIRED GLASS
FCTY	FACTORY	OHD	OVERHEAD ROLLING DOOR	W-S	WEATHERSTRIPPING
FNSH	FINISH	P-P	PUSH - PULL		
FRP	FIBERGLASS REINFORCED PLASTIC	PTD	PAINTED		
		PS	POWER SUPPLY		

GENERAL NOTES

1. PROVIDE DOOR HARDWARE ON BOTH LEAFS IN PAIRS OF DOORS, UNLESS NOTED OTHERWISE.
2. PROVIDE KICKPLATES ON BOTH SIDES OF DOORS UNLESS NOTED OTHERWISE.
3. ALL EXTERIOR METAL ROLLING DOORS ARE TO BE INSULATED.
4. SEE SPECIFICATION SECTION 08 80 00 FOR TYPES OF GLASS.
5. ELECTRIC STRIKE, ELECTRIC HINGES & SECURITY CONTROL SYSTEM BY OTHERS.



CH2MHILL CANADA Architects Inc.

DESIGNED BY:	R. ZAKKO	CHECKED BY:	W. YU
DRAWN BY:	R. BATHAN	APPROVED BY:	H.T. FRIEHAMMER
SCALE:	NTS	ISSUED FOR CONSTRUCTION BY:	J. SHUMKA
DATE:	2017/04/05	DATE:	2017/04/05
CONSULTANT NO.:	474248		

ENGINEER'S SEAL

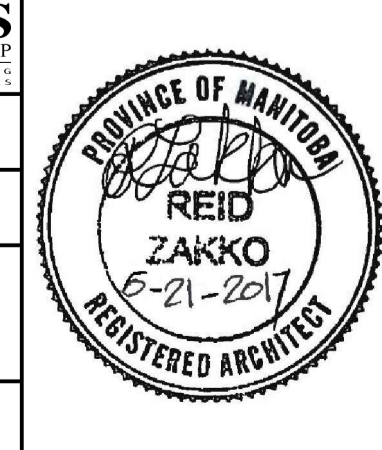

THE CITY OF WINNIPEG WATER AND WASTE DEPARTMENT

SOUTH END WATER POLLUTION CONTROL CENTRE SEWPCC UPGRADE/EXPANSION PROJECT BUILDING ADMINISTRATION BUILDING ROOM FINISH, DOOR AND HARDWARE SCHEDULES		
CITY DRAWING NUMBER	SHEET	REV. SIZE
1-0102-BSCH-M001	001	01 A1