

WORKING POINTS (W.P.) COORDINATES		
Mk. No.	NORTHING	EASTING
W.P.6	10407.169	9834.241
W.P.9	10309.992	9652.888
W.P.10	10314.728	9664.613
W.P.11	10344.712	9745.533
W.P.12	10386.617	9842.614
W.P.13	10381.525	9881.410
W.P.14	10382.422	9884.284
W.P.15	10398.314	9905.861

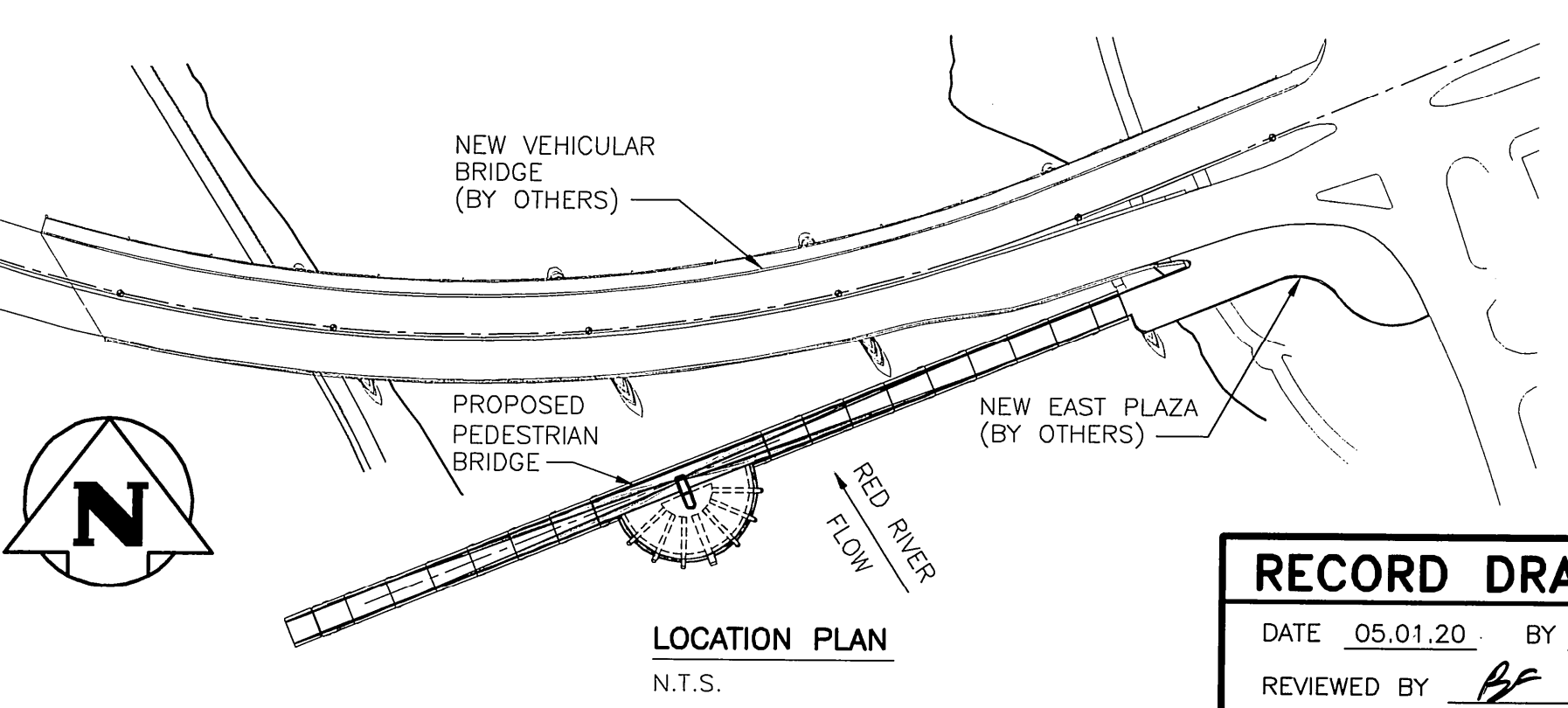

APEGM
 Certificate of Authorization
 No. 195
 Expires APRIL 30, 2003
 W.R. HALDANE-WILSONE
 signature
 date 02.05.06

RECORD DRAWING
 DATE 05.01.20 BY G.I.
 REVIEWED BY *BF*

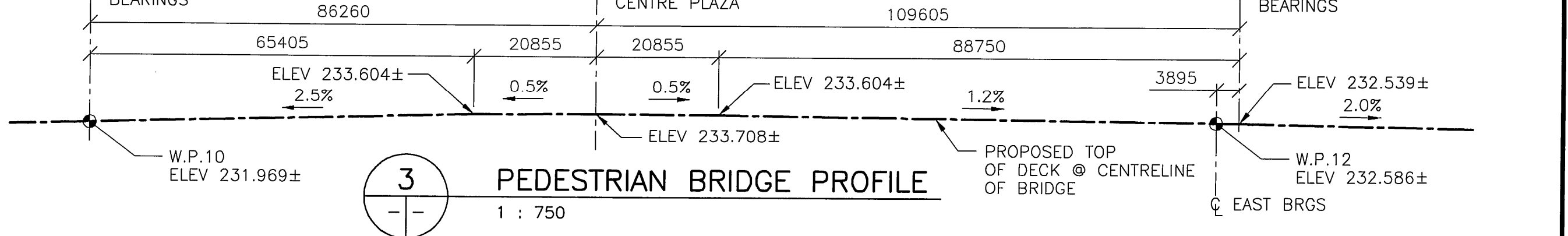

B.M. ELEV.	F.B.	DESIGNED BY	CHECKED BY	APPROVED BY	DATE
		R.H.W.	R.H.W.	R.V.G.	
		G.I.			
3	RECORD DRAWING	05.01.20	<i>BF</i>		
2	GENERAL REVISIONS	02.09.13	R.H.W.		
1	ISSUED FOR CONSTRUCTION	02.07.29	R.H.W.		
0	ISSUED FOR TENDER	02.05.06	R.H.W.		
NO.	REVISIONS	DATE	BY	DATE	02.05.06

ORIGINAL DRAWING REVISION "0" SEALED BY W.R. HALDANE-WILSONE 02.05.06
 CONSULTANT DRAWING NO. 010007-13-01

WARDROP Engineering Inc.

THE CITY OF WINNIPEG
 PUBLIC WORKS DEPARTMENT
 ENGINEERING DIVISION

PROVENCHER PAIRED BRIDGES PROJECT
 PEDESTRIAN BRIDGE

GENERAL ARRANGEMENT PLAN AND ELEVATION

CITY DRAWING NUMBER **B231-02-005**
 SHEET OF **105**