

NOTE: CHAINAGES SHOWN ARE ALONG N.  $\ell$  OF PANDORA AVENUE E.

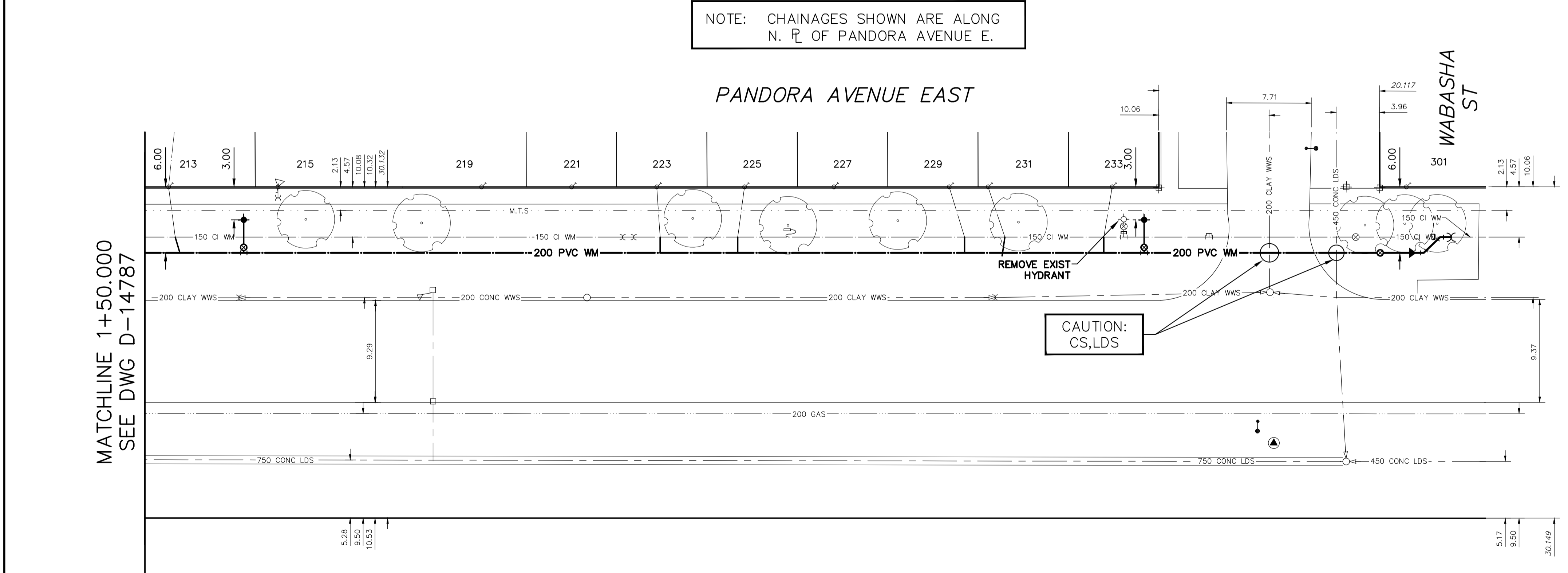

**WATER SERVICE INFORMATION**

ADDRESS (STREET)	SIZE (mm) MATERIAL	SIZE (mm) MATERIAL (PROP.)	SHORT & LONG MEASUREMENT	CORP. LOCATION	REMARKS
117 PANDORA AVE E RESIDENTIAL	20 CU	20	1.41 WEL HSE	0.1 W OF S/C	OUTSIDE SET LIMITS
119 PANDORA AVE E RESIDENTIAL	20 CU	20	73.516 WEL KANATA ST	0.8 E OF S/C	RECONNECT SERVICE
121 PANDORA AVE E RESIDENTIAL	20 CU	20	57.659 WEL KANATA ST	-	RECONNECT SERVICE
123 PANDORA AVE E RESIDENTIAL	20 CU	20	1.36 WEL HSE	-	RECONNECT SERVICE
125 PANDORA AVE E RESIDENTIAL	20 CU	20	49.581 WEL KANATA ST	-	RECONNECT SERVICE
127 PANDORA AVE E RESIDENTIAL	20 CU	20	2.81 EW HSE	0.3 W OF S/C	RECONNECT SERVICE
129 PANDORA AVE E RESIDENTIAL	20 CU	20	41.753 WEL KANATA ST	-	RECONNECT SERVICE
131 PANDORA AVE E RESIDENTIAL	20 CU	20	2.87 EW HSE	-	RECONNECT SERVICE
133 PANDORA AVE E RESIDENTIAL	20 CU	20	30.241 WEL KANATA ST	-	RECONNECT SERVICE
135 PANDORA AVE E RESIDENTIAL	20 CU	20	0.99 EEL HSE	-	RECONNECT SERVICE
137 PANDORA AVE E RESIDENTIAL	20 CU	20	13.994 WEL KANATA ST	-	RECONNECT SERVICE
139 PANDORA AVE E RESIDENTIAL	20 CU	20	4.36 SNL HSE	OPP S/C	SERVICED OFF KANATA ST
141 PANDORA AVE E RESIDENTIAL	20 CU	20	12.029 WEL PANDORA AVE E	-	RECONNECT SERVICE
143 PANDORA AVE E RESIDENTIAL	20 CU	20	2.45 WEL HSE	-	RECONNECT SERVICE
145 PANDORA AVE E RESIDENTIAL	20 CU	20	16.195 WEL KANATA ST	-	RECONNECT SERVICE
147 PANDORA AVE E RESIDENTIAL	20 CU	20	0.50 EW HSE	-	RECONNECT SERVICE
149 PANDORA AVE E RESIDENTIAL	20 CU	20	23.974 WEL KANATA ST	-	RECONNECT SERVICE
151 PANDORA AVE E RESIDENTIAL	20 CU	20	3.28 WEL HSE	-	RECONNECT SERVICE
153 PANDORA AVE E RESIDENTIAL	20 CU	20	41.146 WEL KANATA ST	-	RECONNECT SERVICE
155 PANDORA AVE E RESIDENTIAL	20 CU	20	6.19 WEL HSE	0.6 E OF S/C	RECONNECT SERVICE
157 PANDORA AVE E RESIDENTIAL	20 CU	20	90.211 WEL WABASHA ST	-	RECONNECT SERVICE
159 PANDORA AVE E RESIDENTIAL	20 CU	20	2.05 EW HSE	-	RECONNECT SERVICE
161 PANDORA AVE E RESIDENTIAL	20 CU	20	80.235 WEL WABASHA ST	-	RECONNECT SERVICE
163 PANDORA AVE E RESIDENTIAL	16 LEAD	16	2.83 WEL HSE	-	RECONNECT SERVICE
165 PANDORA AVE E RESIDENTIAL	20 CU	20	61.700 WEL WABASHA ST	-	RECONNECT SERVICE
167 PANDORA AVE E RESIDENTIAL	20 CU	20	2.63 WEL HSE	-	RECONNECT SERVICE
169 PANDORA AVE E RESIDENTIAL	20 CU	20	53.501 WEL WABASHA ST	-	RECONNECT SERVICE
171 PANDORA AVE E RESIDENTIAL	20 CU	20	3.197 WEL HSE	-	RECONNECT SERVICE
173 PANDORA AVE E RESIDENTIAL	20 CU	20	45.735 WEL WABASHA ST	0.3 E OF S/C	RECONNECT SERVICE
175 PANDORA AVE E RESIDENTIAL	20 CU	20	3.07 EW HSE	0.6 W OF S/C	RECONNECT SERVICE
177 PANDORA AVE E RESIDENTIAL	20 CU	20	37.752 WEL WABASHA ST	-	RECONNECT SERVICE
179 PANDORA AVE E RESIDENTIAL	20 CU	20	3.32 EW HSE	-	RECONNECT SERVICE
181 PANDORA AVE E RESIDENTIAL	20 CU	20	29.609 WEL WABASHA ST	-	RECONNECT SERVICE
183 PANDORA AVE E RESIDENTIAL	20 CU	20	1.74 WEL HSE	1.4 E OF S/C	RECONNECT SERVICE
185 PANDORA AVE E RESIDENTIAL	20 CU	20	19.101 WEL WABASHA ST	-	RECONNECT SERVICE
187 PANDORA AVE E RESIDENTIAL	20 CU	20	0.47 EW HSE	-	RECONNECT SERVICE
189 PANDORA AVE E RESIDENTIAL	20 CU	20	15.556 WEL WABASHA ST	1.5 E OF S/C	RECONNECT SERVICE
191 PANDORA AVE E RESIDENTIAL	20 CU	20	3.43 EW HSE	0.8 W OF S/C	RECONNECT SERVICE
193 PANDORA AVE E RESIDENTIAL	20 CU	20	24.374 WEL WABASHA ST	-	RECONNECT SERVICE
195 PANDORA AVE E RESIDENTIAL	20 CU	20	1.58 EW HSE	-	RECONNECT SERVICE
197 PANDORA AVE E RESIDENTIAL	20 CU	20	22.534 WEL WABASHA ST	-	RECONNECT SERVICE

\*SERVICES TO BE RENEWED TO  $\ell$ . ALL OTHERS TO BE RECONNECTED

NOTE: ALL VALVES TO BE INSTALLED CLOCKWISE TO CLOSE

FOR INDEX SEE D-14780

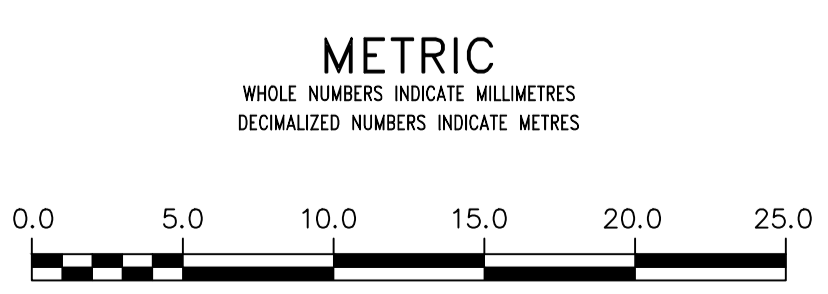

**WARNING**  
 IF POWER EQUIPMENT OR EXPLOSIVES ARE TO BE USED FOR EXCAVATION ON THIS PROJECT THE CONTRACTOR MUST:  
 1) NOTIFY THE GAS COMPANY OF THE PROPOSED LOCATION OF EXCAVATION.  
 2) TAKE PRECAUTION TO AVOID DAMAGE TO GAS COMPANY INSTALLATIONS.  
 SEE PROVINCIAL REGULATION 210/72 FOR DETAILS

**LOCATION APPROVED UNDERGROUND STRUCTURES**  
 SUPV. U/G STRUCTURES COMMITTEE DATE  
 NOTE:  
 LOCATION OF UNDERGROUND STRUCTURES AS SHOWN ARE BASED ON THE BEST INFORMATION AVAILABLE BUT NO GUARANTEE IS GIVEN THAT ALL EXISTING UTILITIES ARE SHOWN OR THAT THE GIVEN LOCATIONS ARE EXACT. CONFIRMATION OF EXISTENCE AND EXACT LOCATION OF ALL UTILITIES MUST BE OBTAINED FROM THE INDIVIDUAL UTILITIES BEFORE PROCEEDING WITH CONSTRUCTION.

B.M. ELEV.	NO.	REVISIONS	DATE	BY

DESIGNED BY	TS	CHECKED BY	SC
DRAWN BY	RS	APPROVED BY	KZ
SCALE:	RELEASED FOR CONSTRUCTION		
HORIZONTAL	1:250	KAS ZUREK	
VERTICAL	1:50	DATE 2017 06 23	
DATE	2017 06 23	DATE	2017 06 23

ENGINEER'S SEAL  
 ORIGINAL SIGNED BY S.J.R. COURNOYER 17/06/23  
 CONSULTANT DRAWING NUMBER

**THE CITY OF WINNIPEG**  
 WATER AND WASTE DEPARTMENT  
 ENGINEERING DIVISION  
 2017 WATER MAIN RENEWALS  
 CONTRACT 1  
**PANDORA AVENUE EAST**  
 50 E OF KANATA STREET TO WABASHA STREET

SHEET 10 OF 13  
 CITY DRAWING NUMBER  
 D-14788