

NOTE: CHAINAGES SHOWN ARE ALONG CL OF PROPOSED PIPE

WARNING
 IF POWER EQUIPMENT OR EXPLOSIVES ARE TO BE USED FOR EXCAVATION ON THIS PROJECT THE CONTRACTOR MUST:
 1) NOTIFY THE GAS COMPANY OF THE PROPOSED LOCATION OF EXCAVATION.
 2) TAKE PRECAUTION TO AVOID DAMAGE TO GAS COMPANY INSTALLATIONS.
 SEE PROVINCIAL REGULATION 210/72 FOR DETAILS

- CONSTRUCTION NOTES:**
- SEWER AND WATER SERVICES SHOWN ON DRAWING ARE APPROXIMATE ONLY.
 - LOCATION OF ALL SEWER AND WATER LINES TO BE CONFIRMED IN FIELD.
 - INSTALL NEW SEWER BY TRENCHLESS METHODS, UNLESS OTHERWISE NOTED.
 - FRONT ACCESS TO ALL YALE AVENUE PROPERTIES TO BE MAINTAINED AT ALL TIMES DURING CONSTRUCTION PERIOD.
 - EXISTING 600 WWS INSTALLED AS PART OF TRANSCONA CONTRACT NO. 2 (BID OPPORTUNITY 743-2016). INVERT AND EXACT LOCATION TO BE FIELD VERIFIED.
 - ABANDONED AS PART OF TRANSCONA CONTRACT NO. 2 (BID OPPORTUNITY 743-2016).

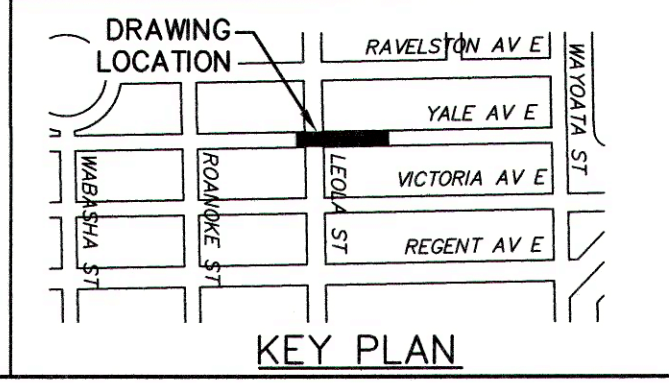
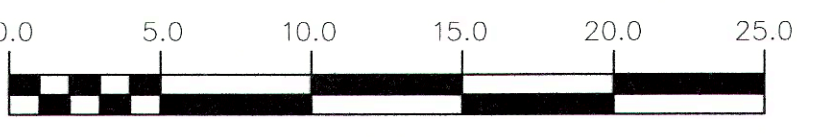
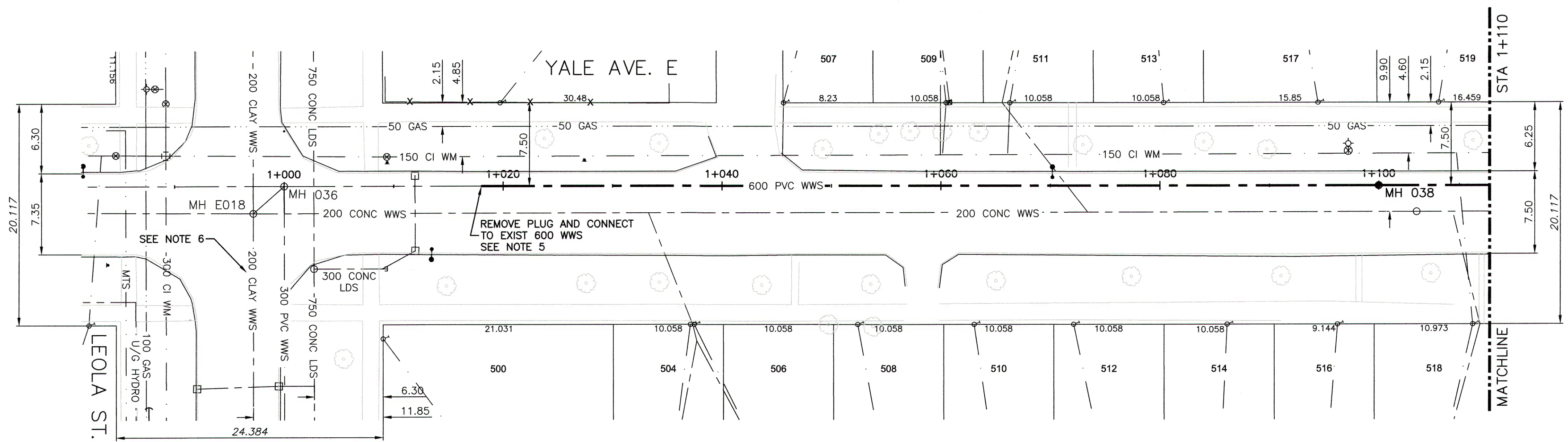

<table border="1"> <tr> <th>200 WM</th> <th>WATERMAIN</th> <th>200 WM</th> <th>SL, HYDRO</th> <th>150 WM</th> <th>WATERMAIN</th> <th>150 WM</th> </tr> <tr> <td>⊕</td> <td>HYDRANT</td> <td>⊕</td> <td>MTS</td> <td>⊕</td> <td>HYDRANT</td> <td>⊕</td> </tr> <tr> <td>⊕</td> <td>VALVE</td> <td>⊕</td> <td>TRAFFIC SIGNALS</td> <td>⊕</td> <td>VALVE</td> <td>⊕</td> </tr> <tr> <td>525 LDS</td> <td>LAND DRAINAGE SEWER</td> <td>525 LDS</td> <td>GAS</td> <td>50 GAS</td> <td>300 LDS</td> <td>LAND DRAINAGE SEWER</td> </tr> <tr> <td>375 WWS</td> <td>WASTEWATER SEWER</td> <td>375 WWS</td> <td>SURVEY BAR</td> <td>250 WWS</td> <td>250 WWS</td> <td>WASTEWATER SEWER</td> </tr> <tr> <td>○</td> <td>MANHOLE</td> <td>●</td> <td>FENCE</td> <td>⊕</td> <td>⊕</td> <td>PROFILE</td> </tr> <tr> <td>□</td> <td>CATCH BASIN</td> <td>■</td> <td>POLE - HYDRO, MTS</td> <td>---</td> <td>---</td> <td>GROUND ABOVE PIPE</td> </tr> <tr> <td>▽</td> <td>CURB INLET</td> <td>▲</td> <td>CURB STOP</td> <td></td> <td></td> <td></td> </tr> <tr> <td>+</td> <td>JUNCTIONS</td> <td>+</td> <td>GUY ANCHOR</td> <td></td> <td></td> <td></td> </tr> <tr> <td>⊔</td> <td>CULVERT</td> <td>⊔</td> <td>LIGHT STANDARD</td> <td></td> <td></td> <td></td> </tr> <tr> <td>⊕</td> <td>ANODE</td> <td>⊕</td> <td>TREE</td> <td></td> <td></td> <td></td> </tr> <tr> <td>---</td> <td>EXISTING</td> <td>---</td> <td>PROPOSED</td> <td>---</td> <td>---</td> <td>PROPOSED</td> </tr> </table>	200 WM	WATERMAIN	200 WM	SL, HYDRO	150 WM	WATERMAIN	150 WM	⊕	HYDRANT	⊕	MTS	⊕	HYDRANT	⊕	⊕	VALVE	⊕	TRAFFIC SIGNALS	⊕	VALVE	⊕	525 LDS	LAND DRAINAGE SEWER	525 LDS	GAS	50 GAS	300 LDS	LAND DRAINAGE SEWER	375 WWS	WASTEWATER SEWER	375 WWS	SURVEY BAR	250 WWS	250 WWS	WASTEWATER SEWER	○	MANHOLE	●	FENCE	⊕	⊕	PROFILE	□	CATCH BASIN	■	POLE - HYDRO, MTS	---	---	GROUND ABOVE PIPE	▽	CURB INLET	▲	CURB STOP				+	JUNCTIONS	+	GUY ANCHOR				⊔	CULVERT	⊔	LIGHT STANDARD				⊕	ANODE	⊕	TREE				---	EXISTING	---	PROPOSED	---	---	PROPOSED	<p>LOCATION APPROVED UNDERGROUND STRUCTURES</p> <p>SUPV. U/G STRUCTURES COMMITTEE DATE</p> <p>NOTE: LOCATION OF UNDERGROUND STRUCTURES AS SHOWN ARE BASED ON THE BEST INFORMATION AVAILABLE BUT NO GUARANTEE IS GIVEN THAT ALL EXISTING UTILITIES ARE SHOWN OR THAT THE GIVEN LOCATIONS ARE EXACT. CONFIRMATION OF EXISTENCE AND EXACT LOCATION OF ALL SERVICES MUST BE OBTAINED FROM THE INDIVIDUAL UTILITIES BEFORE PROCEEDING WITH CONSTRUCTION.</p>	<p>B.M. ELEV.</p> <p>CONSTRUCTION COMPLETION DATE: YYYY MM DD</p>	<p>ch2m</p> <p>DESIGNED BY: MAF CHECKED BY: MD DRAWN BY: JBC APPROVED BY: <i>[Signature]</i> SCALE: HORIZONTAL 1:250 VERTICAL 1:50 RELEASED FOR CONSTRUCTION: <i>[Signature]</i> DATE: <i>Oct 24/17</i></p>	<p>ENGINEER'S SEAL</p> <p>PROVINCE OF MANITOBA</p> <p><i>[Signature]</i> S. D. GODON Member 25524 REGISTERED PROFESSIONAL ENGINEER</p> <p>CONSULTANT DRAWING NUMBER: C-231</p>	<p>THE CITY OF WINNIPEG WATER AND WASTE DEPARTMENT ENGINEERING DIVISION</p> <p>TRANSCONA SEWER RELIEF WORKS CONTRACT NO. 3 YALE AVENUE E. FROM STA 1+000 TO 1+110</p>	<p>SHEET 5 OF 19</p> <p>CITY DRAWING NUMBER: LD-8081</p>
200 WM	WATERMAIN	200 WM	SL, HYDRO	150 WM	WATERMAIN	150 WM																																																																																				
⊕	HYDRANT	⊕	MTS	⊕	HYDRANT	⊕																																																																																				
⊕	VALVE	⊕	TRAFFIC SIGNALS	⊕	VALVE	⊕																																																																																				
525 LDS	LAND DRAINAGE SEWER	525 LDS	GAS	50 GAS	300 LDS	LAND DRAINAGE SEWER																																																																																				
375 WWS	WASTEWATER SEWER	375 WWS	SURVEY BAR	250 WWS	250 WWS	WASTEWATER SEWER																																																																																				
○	MANHOLE	●	FENCE	⊕	⊕	PROFILE																																																																																				
□	CATCH BASIN	■	POLE - HYDRO, MTS	---	---	GROUND ABOVE PIPE																																																																																				
▽	CURB INLET	▲	CURB STOP																																																																																							
+	JUNCTIONS	+	GUY ANCHOR																																																																																							
⊔	CULVERT	⊔	LIGHT STANDARD																																																																																							
⊕	ANODE	⊕	TREE																																																																																							
---	EXISTING	---	PROPOSED	---	---	PROPOSED																																																																																				

SEE DRAWING LD-8082