

1+080 1+100 1+120 1+140 1+160

NOTE: CHAINAGES SHOWN ARE ALONG CL OF PROPOSED PIPE

WARNING
 IF POWER EQUIPMENT OR EXPLOSIVES ARE TO BE USED FOR EXCAVATION ON THIS PROJECT THE CONTRACTOR MUST:
 1) NOTIFY THE GAS COMPANY OF THE PROPOSED LOCATION OF EXCAVATION.
 2) TAKE PRECAUTION TO AVOID DAMAGE TO GAS COMPANY INSTALLATIONS.
 SEE PROVINCIAL REGULATION 210/72 FOR DETAILS

- CONSTRUCTION NOTES:**
- SEWER AND WATER SERVICES SHOWN ON DRAWING ARE APPROXIMATE ONLY.
 - LOCATION OF ALL SEWER AND WATER LINES TO BE CONFIRMED IN FIELD.
 - INSTALL NEW SEWER BY TRENCHLESS METHODS, UNLESS OTHERWISE NOTED.
 - FRONT ACCESS TO ALL HAROLD AVENUE PROPERTIES TO BE MAINTAINED AT ALL TIMES DURING CONSTRUCTION PERIOD.
 - EXISTING 200 WWS IN HAROLD AVENUE TO BE ABANDONED AFTER ALL LIVE CONNECTIONS DIVERTED TO NEW 375 WWS AS PER SPECIFICATIONS.
 - EXISTING INCOMING 200 WWS PIPES (NORTH AND EAST) TO BE ABANDONED AFTER ALL LIVE CONNECTIONS DIVERTED TO NEW 375 WWS AS PER SPECIFICATIONS.
 - CONTRACTOR TO ENSURE THAT ALL NEW RELIEF PIPE WORK FROM EXISTING MH E30 TO CONNECTION TO KILDARE AVENUE EXISTING SEWER AND ALL SEWER SERVICE CONNECTIONS ARE IN PLACE PRIOR TO THE ABANDONMENT OF EXISTING WWS SEWERS. IT IS NOTED THAT TEMPORARY BY-PASSING OPERATIONS WILL BE NECESSARY AT CROSS POINT OF EXISTING AND NEW RELIEF SEWER AT INTERSECTION OF HAROLD AVENUE AND REGINA PLACE. THIS OPERATION WILL BE COMPLETED FOLLOWING THE CITY OF WINNIPEG SPECIFICATIONS.

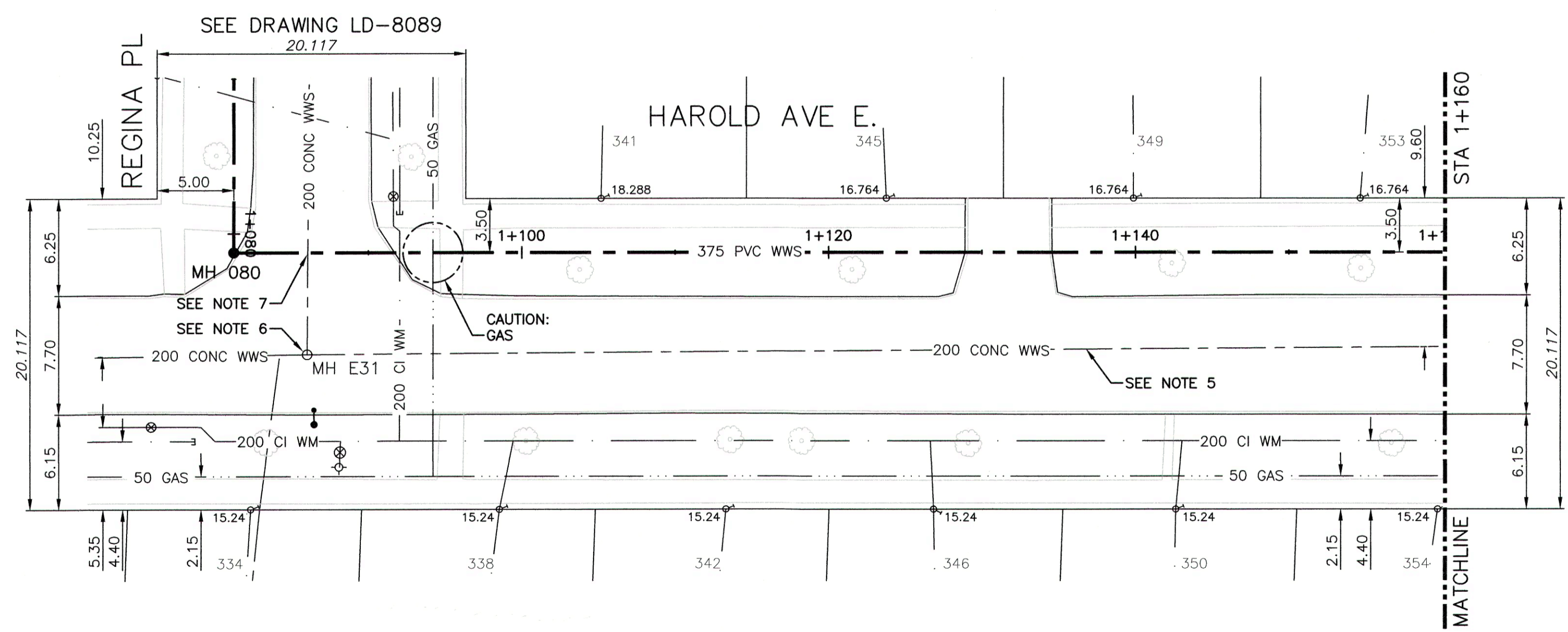

SEWER JUNCTION INFORMATION FROM SEWER VIDEO INSPECTION
 DISTANCE FROM MH ID E43

DISTANCE	DIAMETER	CLOCK
23.8	150	11
26.8	150	1
41.2	150	11
43.5	150	10
44.8	150	1
57.5	150	11
64.6	150	1
72.0	150	11
80.6	150	1
88.1	150	11

ALL EXISTING LIVE SEWER SERVICES TO BE RENEWED FROM PROPERTY LINE TO NEW 375 WWS

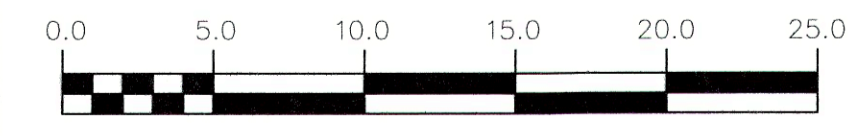

APEGM
 Certificate of Authorization
 CH2M HILL Canada Ltd.
 No. 1441

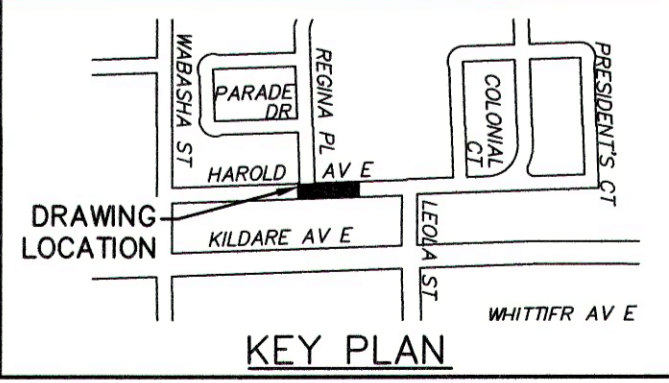

200 WM	WATERMAIN	200 WM	SL, HYDRO	150 WM	WATERMAIN	150 WM
⊕	HYDRANT	⊕	MTS	⊕	HYDRANT	⊕
⊕	VALVE	⊕	TRAFFIC SIGNALS	⊕	VALVE	⊕
525 LDS	LAND DRAINAGE SEWER	525 LDS	50 GAS	50 GAS	300 LOS	LAND DRAINAGE SEWER
375 WWS	WASTEWATER SEWER	375 WWS	SURVEY BAR	250 WWS	WASTEWATER SEWER	250 WWS
○	MANHOLE	●	FENCE	⊕	⊕	PROFILE
□	CATCH BASIN	□	POLE - HYDRO, MTS	⊕	⊕	GROUND ABOVE PIPE
▽	CURB INLET	▽	CURB STOP	⊕	⊕	
⊕	JUNCTIONS	⊕	GUY ANCHOR	⊕	⊕	
⊕	CULVERT	⊕	LIGHT STANDARD	⊕	⊕	
⊕	ANODE	⊕	TREE	⊕	⊕	
EXISTING	LEGEND-PLAN	PROPOSED	EXISTING	LEGEND-PLAN	PROPOSED	EXISTING

LOCATION APPROVED UNDERGROUND STRUCTURES

DATE: _____

NOTE:
 LOCATION OF UNDERGROUND STRUCTURES AS SHOWN ARE BASED ON THE BEST INFORMATION AVAILABLE BUT NO GUARANTEE IS GIVEN THAT ALL EXISTING UTILITIES ARE SHOWN OR THAT THE GIVEN LOCATIONS ARE EXACT. CONFIRMATION OF EXISTENCE AND EXACT LOCATION OF ALL SERVICES MUST BE OBTAINED FROM THE INDIVIDUAL UTILITIES BEFORE PROCEEDING WITH CONSTRUCTION.

DESIGNED BY: MAF

CHECKED BY: MD

DRAWN BY: JBC

APPROVED BY: *E. Sharp*

SCALE: HORIZONTAL 1:250
 VERTICAL 1:50

RELEASED FOR CONSTRUCTION: *Ben J. [Signature]*

DATE: 10/17/17

ENGINEER'S SEAL
 PROVINCE OF MANITOBA
 S. D. GODON
 Member 25524
 REGISTERED PROFESSIONAL ENGINEER

THE CITY OF WINNIPEG
 WATER AND WASTE DEPARTMENT
 ENGINEERING DIVISION

TRANSCONA SEWER RELIEF WORKS
 CONTRACT NO. 3
 HAROLD AVENUE E.
 REGINA PL TO STA 1+160

SHEET 14 OF 19
 CITY DRAWING NUMBER
 LD-8090