

- NOTES:**
- THE CONTRACTOR SHALL OBTAIN ALL NECESSARY PERMITS. PAY ALL NECESSARY FEES AND GIVE ALL NECESSARY NOTICES.
 - CONTRACTOR SHALL TAKE PRECAUTIONARY STEPS TO PROTECT EXISTING TREES WITHIN THE LIMITS OF ACTIVITIES AS OUTLINED IN THE SPECIFICATIONS
 - CONTRACTOR TO CONFIRM THE LOCATION OF ALL UTILITIES/SERVICES IN THE FIELD PRIOR TO CONSTRUCTION
 - THE CONTRACTOR SHALL PROVIDE CONSTRUCTION LAYOUT THROUGHOUT THE PROJECT.
 - RESTORATION OF THE SITE TO EQUAL OR BETTER CONDITION TO BE COMPLETED IMMEDIATELY FOLLOWING CONSTRUCTION ACTIVITIES AT CONTRACTORS EXPENSE.
 - GRANULAR PATH TO BE CONSTRUCTED 75mm LOWER THAN PROPOSED ASPHALT PROFILE
 - SIDESLOPE TO BE 4:1 MAX. CONTRACTOR IS TO CONSTRUCT WHERE POSSIBLE TO MIN. SLOPE OF 10:1.

CURVE TABLE							
CURVE	RADIUS	CURVE LENGTH (L)	DELTA Δ	CHORD	TANGENT	START POINT	END POINT
C1	14.50	12.29	48°32'48"	11.922	6.54	N:5534540.314 E:629054.590	N:5534529.671 E:629059.961
C2	8.50	6.93	46°44'03"	6.743	3.67	N:5534529.671 E:629059.961	N:5534523.605 E:629062.903

LINE TABLE					
LINE #	LENGTH	START STATION	END STATION	START POINT	END POINT
L1	6.59	1+000.00	1+006.59	N:5534544.455 E:629049.467	N:5534540.314 E:629054.590
L2	22.47	1+025.81	1+048.28	N:5534523.605 E:629062.903	N:5534508.681 E:629079.704

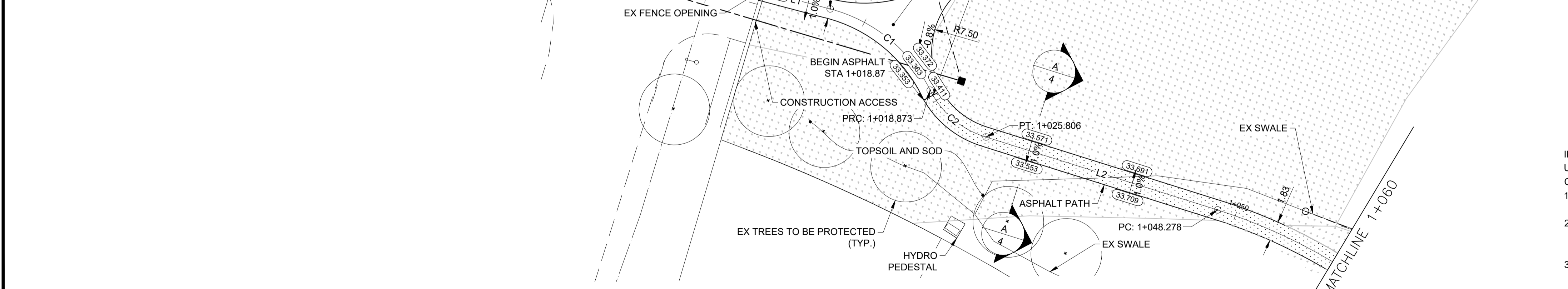

WARNING

IF POWER EQUIPMENT OR EXPLOSIVES ARE TO BE USED FOR EXCAVATION ON THIS PROJECT THE CONTRACTOR MUST:

- NOTIFY THE GAS COMPANY OF THE PROPOSED LOCATION OF EXCAVATION.
- TAKE PRECAUTION TO AVOID DAMAGE TO GAS COMPANY INSTALLATIONS SEE PROVINCIAL REGULATION 210/72 FOR DETAILS.
- OBTAIN EXCAVATION PERMITS PRIOR TO CONSTRUCTION.

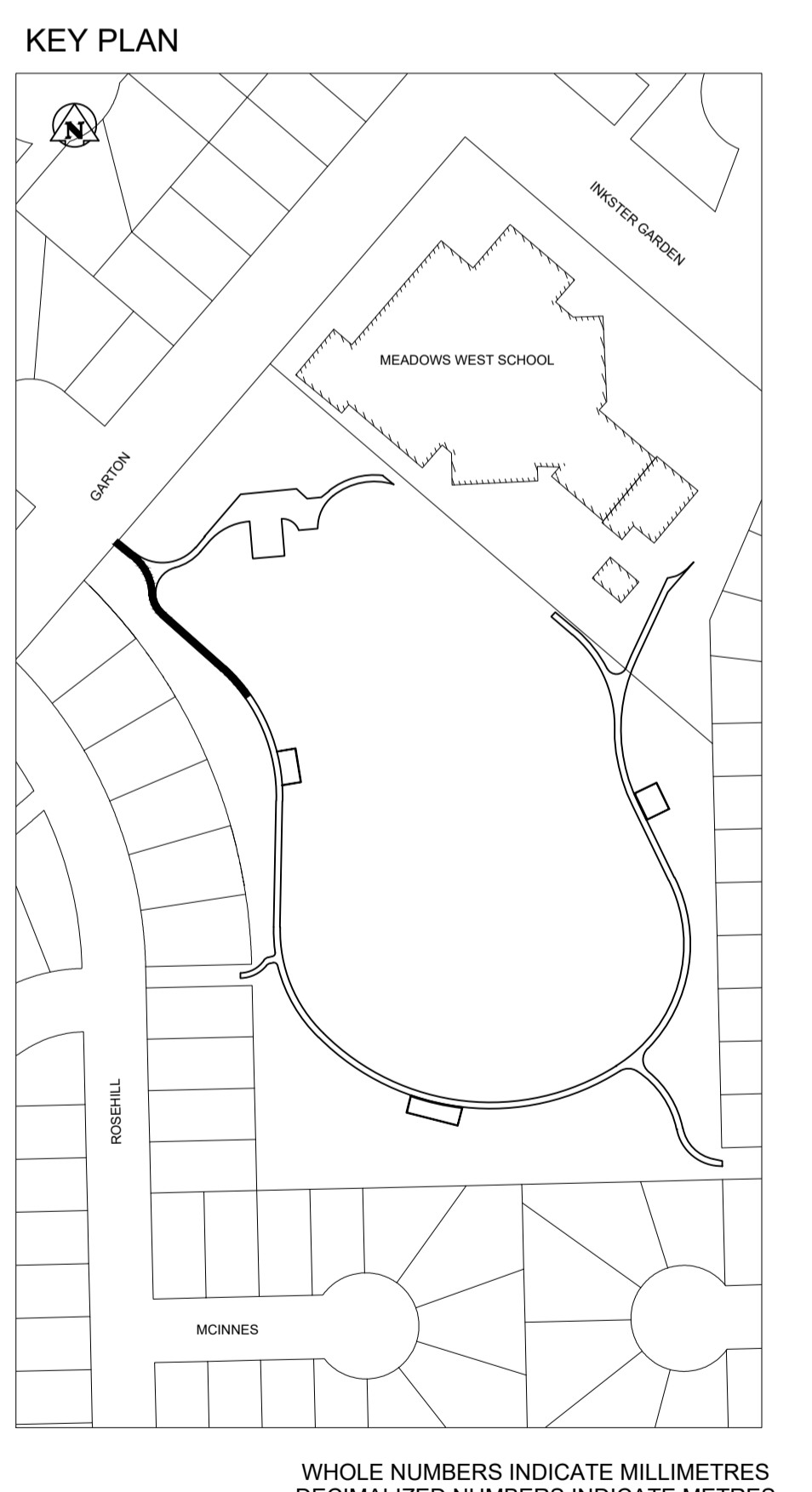

CHAINAGE MEASURED ALONG ε OF PATHWAY

150 mm WM	WATERMAIN	150 mm WM	HYDRO	MTS	HYDRO	150 mm WM	WATERMAIN	HYDRANT	300 mm LDS	LAND DRAINAGE SEWER	300 mm LDS	LIMIT OF ASPHALT	300 mm LDS	SEWER	300 mm LDS	SOUTH/EAST R	NORTH/WEST R	PROFILE
⊕	HYDRANT	⊕	---	---	---	⊕	HYDRANT	+	⊕	WASTE WATER SEWER	⊕	---	⊕	---	---	---	---	---
⊙	VALVE	⊙	---	---	---	⊙	VALVE	+	⊙	MANHOLE	⊙	---	⊙	---	---	---	---	---
⊕	LAND DRAINAGE SEWER	⊕	---	---	---	⊕	SEWER	+	⊕	CATCH BASIN	⊕	---	⊕	---	---	---	---	---
⊕	WASTE WATER SEWER	⊕	---	---	---	⊕	VALVE	+	⊕	CURB INLET	⊕	---	⊕	---	---	---	---	---
⊕	MANHOLE	⊕	---	---	---	⊕	SEWER	+	⊕	HYDRO POLES	⊕	---	⊕	---	---	---	---	---
⊕	CATCH BASIN	⊕	---	---	---	⊕	VALVE	+	⊕	LAMP STANDARD	⊕	---	⊕	---	---	---	---	---
⊕	CURB INLET	⊕	---	---	---	⊕	SEWER	+	⊕	GAS	⊕	---	⊕	---	---	---	---	---
⊕	HYDRO POLES	⊕	---	---	---	⊕	SEWER	+	⊕	LEGEND - PLAN	⊕	---	⊕	---	---	---	---	---
⊕	LAMP STANDARD	⊕	---	---	---	⊕	SEWER	+	⊕	PROPOSED	⊕	---	⊕	---	---	---	---	---
⊕	GAS	⊕	---	---	---	⊕	SEWER	+	⊕	EXISTING	⊕	---	⊕	---	---	---	---	---
---	LEGEND - PLAN	---	---	---	---	---	SEWER	+	---	PROPOSED	---	---	---	---	---	---	---	---
---	PROPOSED	---	---	---	---	---	SEWER	+	---	EXISTING	---	---	---	---	---	---	---	---
---	EXISTING	---	---	---	---	---	SEWER	+	---	PROPOSED	---	---	---	---	---	---	---	---
---	LEGEND - PROFILE	---	---	---	---	---	SEWER	+	---	EXISTING	---	---	---	---	---	---	---	---
---	PROPOSED	---	---	---	---	---	SEWER	+	---	PROPOSED	---	---	---	---	---	---	---	---
---	EXISTING	---	---	---	---	---	SEWER	+	---	EXISTING	---	---	---	---	---	---	---	---

UNDERGROUND STRUCTURES

SUPV. U/G STRUCTURES COMMITTEE DATE

NOTE:
LOCATION OF UNDERGROUND STRUCTURES AS SHOWN ARE BASED ON THE BEST INFORMATION AVAILABLE, BUT NO GUARANTEE IS GIVEN THAT ALL EXISTING UTILITIES ARE SHOWN OR THAT THE GIVEN LOCATIONS ARE EXACT. CONFIRMATION OF EXISTENCE AND EXACT LOCATION OF ALL SERVICES MUST BE OBTAINED FROM THE INDIVIDUAL UTILITIES BEFORE PROCEEDING WITH CONSTRUCTION.

B.M.	CENTER OF MH AT STA 1+148 BEHIND 26 ROSE HILL WAY	ELEV.
	232.107	

URBAN DESIGN DIVISION PARKS PLANNING & DEVELOPMENT			
DESIGNED BY	PRD	CHECKED BY	IL
DRAWN BY	PRD	APPROVED BY	SP
HOR. SCALE:	1 : 250	RELEASED FOR CONSTRUCTION	
VERTICAL:	1 : 10	DATE	
ISSUED FOR REVIEW	17/04/07	PRD	
NO. REVISIONS	YYMMDD	BY	

PROFESSIONAL'S SEAL

PRELIMINARY

NOT FOR CONSTRUCTION

CONSULTANT PROJECT NUMBER

N/A

THE CITY OF WINNIPEG
PLANNING, PROPERTY & DEVELOPMENT DEPARTMENT

ROSEHILL PARK
FITNESS PATH

ROSEHILL PARK - 186 GARTON AVE.
HORIZONTAL & VERTICAL ALIGNMENT
STA 1+000 TO STA 1+060

BID OPPORTUNITY NUMBER
298-2017

SHEET 4 OF 12

CITY DRAWING NUMBER
R.28D4

V:\Design\Branch\Projects\2016_33_Rosehill_Paths\0300_drawing\0305_working\sheet_files\ROSEHILL-202-2017.dwg 4/7/2017 2:16 PM