

ISO A1 - 564mm x 841mm
 M:\Projects\170005\Drawings\06 Sheets\170005 McGillivray-PP-01.dwg
 Last Saved: 6/19/2017 2:36 PM by DDeszpod
 Plotted: 6/19/2017 3:42 PM by Daniel Doszpod

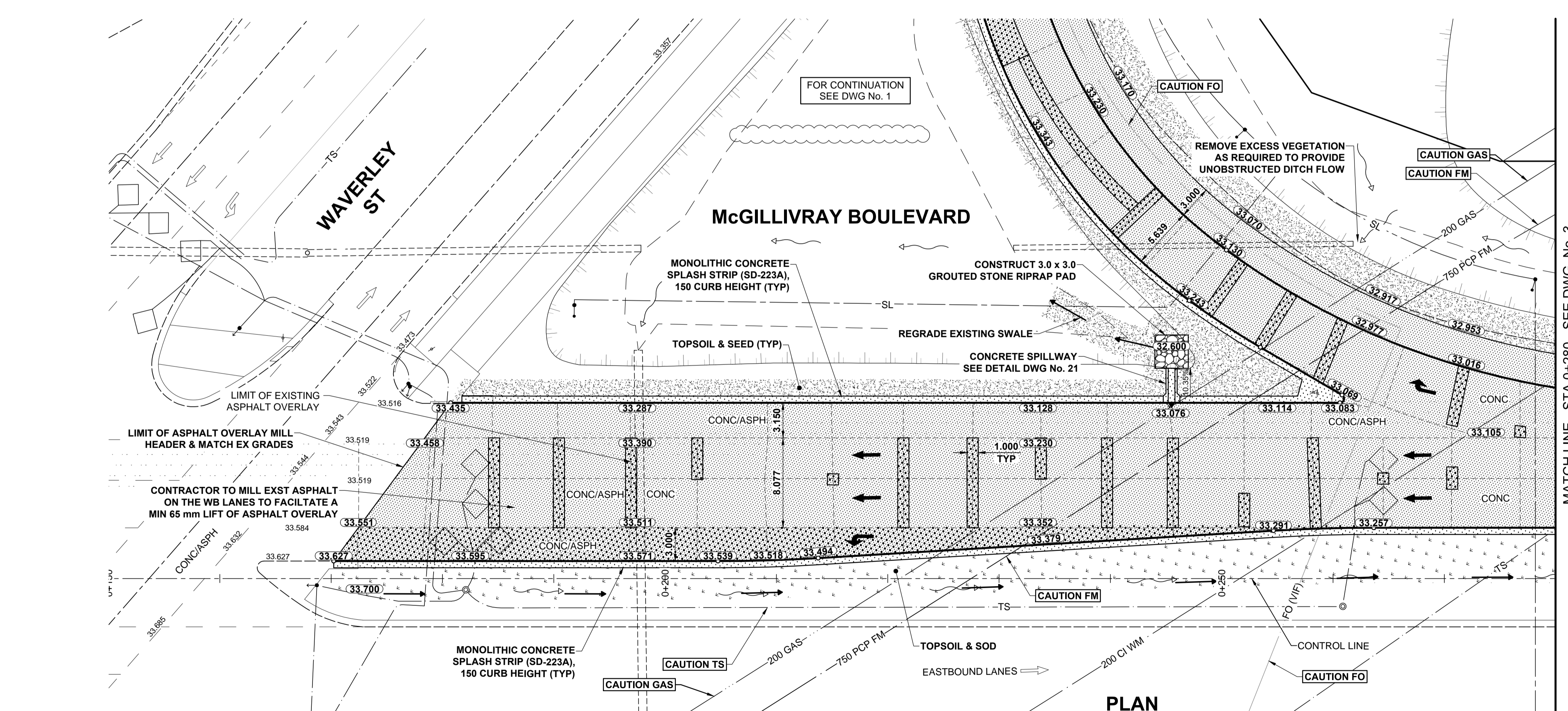
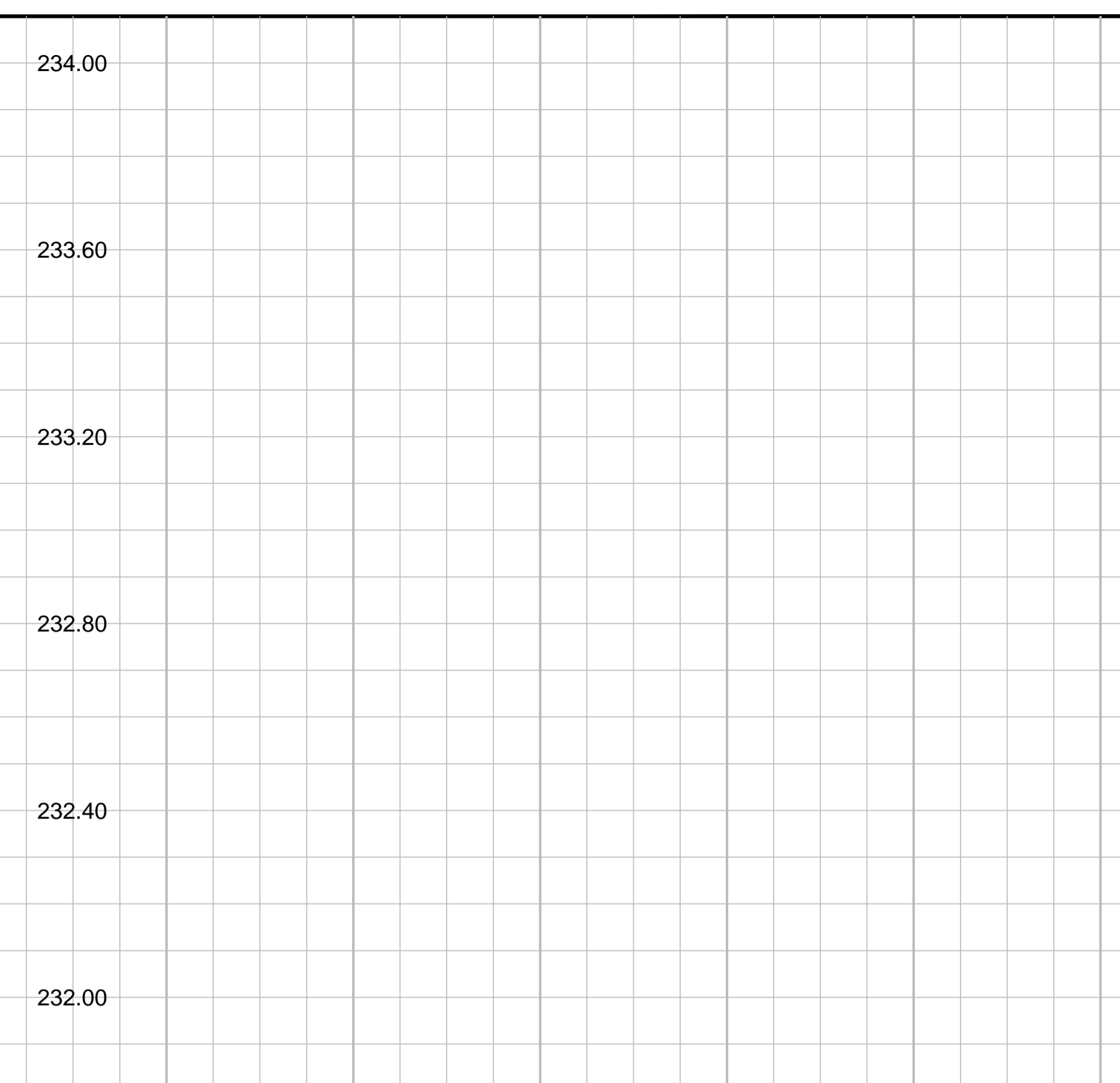
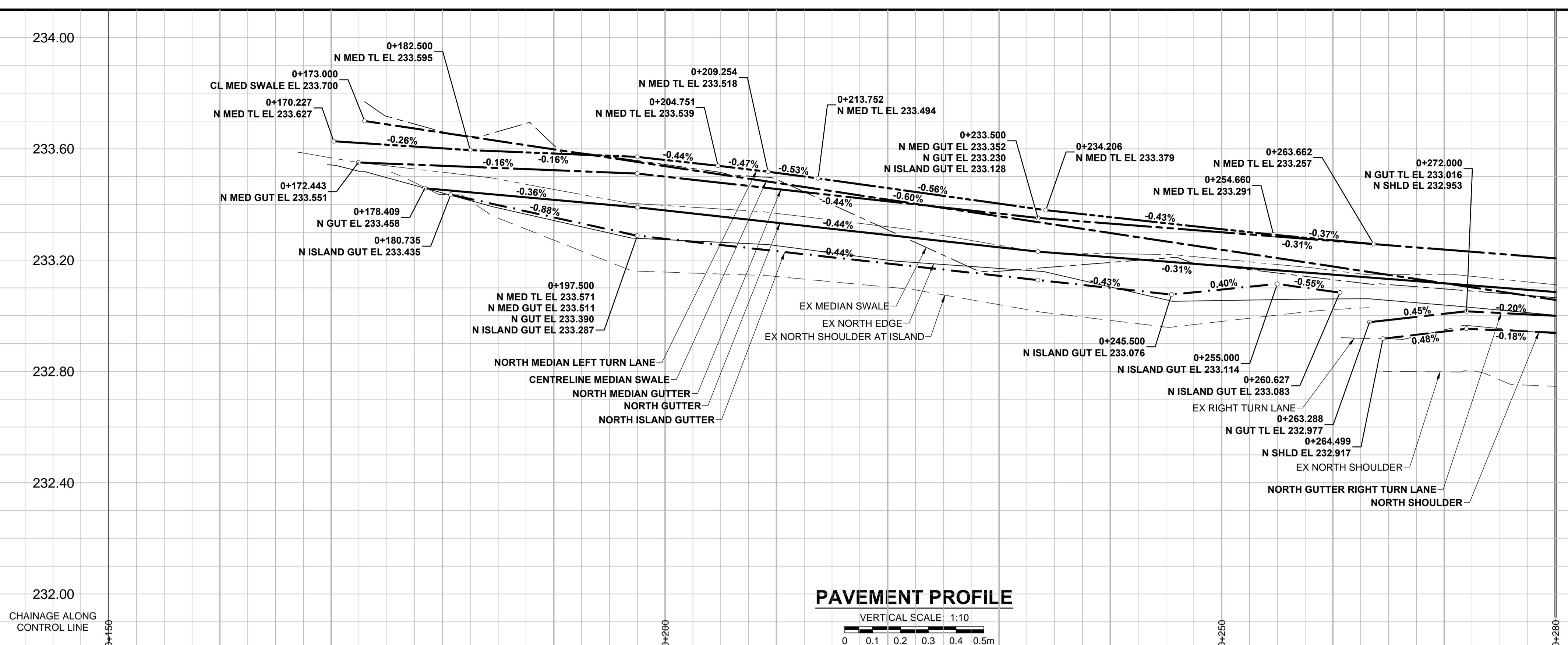

AQUEDUCT/FEDERMAIN NOTES:

- CONTACT THE WATER AND WASTE DEPARTMENT'S CONSTRUCTION SERVICES COORDINATOR AT 204-986-4289, 7 DAYS PRIOR TO THE COMMENCEMENT OF CONSTRUCTION TO ARRANGE FOR AN INSPECTION.
- PRIOR TO ANY CONSTRUCTION, THE AQUEDUCT/FEDERMAIN MUST BE EXPOSED BY A SOFT DIG METHOD SO AS TO CONFIRM DEPTH AND LOCATION.
- A MINIMUM CLEARANCE OF 0.5m MUST BE PROVIDED BETWEEN THE UNDERSIDE OF THE PROPOSED WORKS AND THE TOP OF ANY EXISTING AQUEDUCT/FEDERMAIN BY TRENCHLESS OR OPEN TRENCH.
- DO NOT OPERATE VIBRATORY EQUIPMENT OVER OR WITHIN 3.0m OF THE AQUEDUCT CENTRELINE.
- CONCRETE DEMOLITION AND REMOVAL WITHIN 3 METRES HORIZONTALLY OF THE AQUEDUCT/FEDERMAIN SHALL COMPLETED BY SAWCUTTING AND REMOVAL, OR BY THE USE OF HAND HELD JACKHAMMERS. USE OF MACHINE MOUNTED CONCRETE BREAKERS ABOVE THE AQUEDUCT/FEDERMAIN SHALL NOT BE PERMITTED.

NOTES:

- ADJUST MH AND CB RIMS TO NEW GRADES.
- CONTRACTOR TO REGRADE/RENEW EXISTING PRIVATE SIDEWALKS TO LIMITS AS SHOWN. SIDEWALKS TO BE RENEWED WITH CONCRETE UNLESS NOTED OTHERWISE.
- CONTRACTOR TO TAKE PRECAUTIONARY STEPS TO PROTECT EXISTING TREES WITHIN THE LIMITS OF CONSTRUCTION FROM DAMAGE FROM CONSTRUCTION ACTIVITIES AS OUTLINED IN THE SPECIFICATIONS.
- MODIFIED BARRIER CURB TO BE CONSTRUCTED AT ALL INTERSECTION RADI, BACK LANE RADI AND BULLNOSES.
- CONTRACTOR TO CONFIRM THE LOCATION OF ALL UTILITIES/SERVICES IN THE FIELD PRIOR TO CONSTRUCTION.
- ADD 200.000m TO ABBREVIATED ELEVATIONS TO OBTAIN GEODETIC ELEVATIONS.
- CB SD-024 OFFSETS ARE DIMENSIONED TO BOC. CB SD-025 OFFSETS ARE DIMENSIONED O.C.
- ALL DIMENSIONS TO BACK OF CURB.

MATCH LINE - STA 0+280 - SEE DWG. No. 3

METRIC
 WHOLE NUMBERS INDICATE MILLIMETRES
 DECIMALIZED NUMBERS INDICATE METRES

GAS		MANHOLE		CONCRETE PAVEMENT		LOCATION APPROVED UNDERGROUND STRUCTURES	
	GAS		MANHOLE		CONCRETE PAVEMENT		LOCATION APPROVED
	MTS / PEDESTAL		CATCH BASIN / CATCH PIT		CONC SIDEWALK / MEDIAN		ASPHALT PAVEMENT
	HYDRO / CABINET		CURB INLET WITH BOX		PAVING STONE		GRAVEL
	CATV / FIBRE OPTIC		TREE		RAMP CURB		PLANING / REMOVAL
	TRAFFIC SIGNALS / PIT		TEST HOLE				
	LAND DRAINAGE SEWER		PROPERTY LINE				
	SANITARY/COMBINED SEWER		SURVEY BAR				
	CB LEAD / SSP / DCP		FENCE				
	WATER MAIN		BOC / EDGE OF PAVEMENT				
	SUBDRAIN		ELEVATION				
	DITCH		TRAFFIC SIGN				
	EXISTING		LEGEND - PLAN		EXISTING		LEGEND - PLAN
	NEW		EXISTING		NEW		EXISTING

NOTE:
 LOCATION OF UNDERGROUND STRUCTURES AS SHOWN ARE BASED ON THE BEST INFORMATION AVAILABLE BUT NO GUARANTEE IS GIVEN THAT ALL EXISTING UTILITIES ARE SHOWN OR THAT THE GIVEN LOCATIONS ARE EXACT. CONFIRMATION OF EXISTENCE AND EXACT LOCATION OF ALL SERVICES MUST BE OBTAINED FROM THE INDIVIDUAL UTILITIES BEFORE PROCEEDING WITH CONSTRUCTION.

No.	REVISIONS	DATE	BY
A	ISSUED FOR TENDER	17/06/20	JGK
B	ISSUED FOR CLIENT REVIEW	17/06/09	JGK
			Y/M/MDD

MORRISON HERSHFIELD

DESIGNED BY: WRJ
 CHECKED BY: RPB
 DRAWN BY: DID, DML
 APPROVED BY: BWB
 RELEASED FOR CONSTRUCTION: 17/06/09

PROFESSIONAL'S SEAL
 PROVINCE OF MANITOBA
 REGISTERED PROFESSIONAL ENGINEER
R.P. BRUCE
 CONSULTANT FILE NAME: W170005 McGillivray-PP-01.dwg

THE CITY OF WINNIPEG
 PUBLIC WORKS DEPARTMENT
 ENGINEERING DIVISION

2017 REGIONAL AND LOCAL STREET RENEWAL PROGRAM
McGILLIVRAY BOULEVARD REHABILITATION
 WAVERLEY STREET TO PEMBINA HIGHWAY
 HORIZONTAL AND VERTICAL ALIGNMENT
 WAVERLEY ST TO STA 0+280

CITY DRAWING NUMBER: P-3482-2
 SHEET 2 OF 30
 DRAWING No. REV: 2 B

BID OPPORTUNITY No. 300-2017