

- REFERENCE NOTES**
- A. PAVEMENT DIMENSIONS ARE TO BACK OF CURB
 - B. BASELINE IS CENTRE LINE RIGHT-OF-WAY
 - C. PROPERTY LINES OBTAINED FROM CITY OF WINNIPEG L.B.I.S., AND NO SCALE FACTOR WAS APPLIED
 - D. REFER TO AECOM FIELD BOOK NO. 4977

- CONSTRUCTION NOTES**
1. PLACE NEW ASPHALTIC PAVEMENT TYPE 1A (AVG THICKNESS 85mm)
 2. RENEW EXISTING BARRIER CURB (100mm REVEAL HT. DOWELED)
 3. REMOVE EXISTING CONCRETE PAVEMENT AND CONSTRUCT NEW 150mm REINFORCED CONCRETE PAVEMENT c/w ASPHALTIC OVERLAY
 4. REMOVE EXISTING BARRIER CURB AND CONSTRUCT NEW CONCRETE MODIFIED BARRIER CURB (150mm REVEAL HT. DOWELED)
 5. RENEW EXISTING 100mm CONCRETE SIDEWALK
 6. CONSTRUCT CURB RAMP (10mm REVEAL HT. MONOLITHIC)
 7. CONSTRUCT NEW CONCRETE BARRIER CURB (100mm REVEAL HT. SEPERATE)
 8. ABANDON EXISTING DRAINAGE INLET AND LEAD
 9. INSTALL NEW CATCHPIT (SD-023) AND CONNECT TO EXISTING CATCHBASIN
 10. CONSTRUCT NEW CONCRETE MODIFIED BARRIER CURB (150mm REVEAL HT. INTEGRAL)
 11. ADJUST EXISTING MANHOLE/CATCHBASIN TO GRADE
 12. REMOVE EXISTING FRAME AND COVER AND INSTALL NEW FRAME AND SOLID COVER (AP-006& AP-007)
 13. INSTALL NEW CAST IRON RISER RING
 14. ADJUST EXISTING WATER VALVE TO GRADE
 15. INSTALL NEW DETECTABLE WARNING SURFACE TILES
 16. CONSTRUCT CURB RAMP (10mm REVEAL HT. INTEGRAL)
 17. REMOVE EXISTING OPEN GRATE FRAME AND COVER AND INSTALL NEW OPEN GRATE FRAME AND COVER (AP-006 & AP-008)

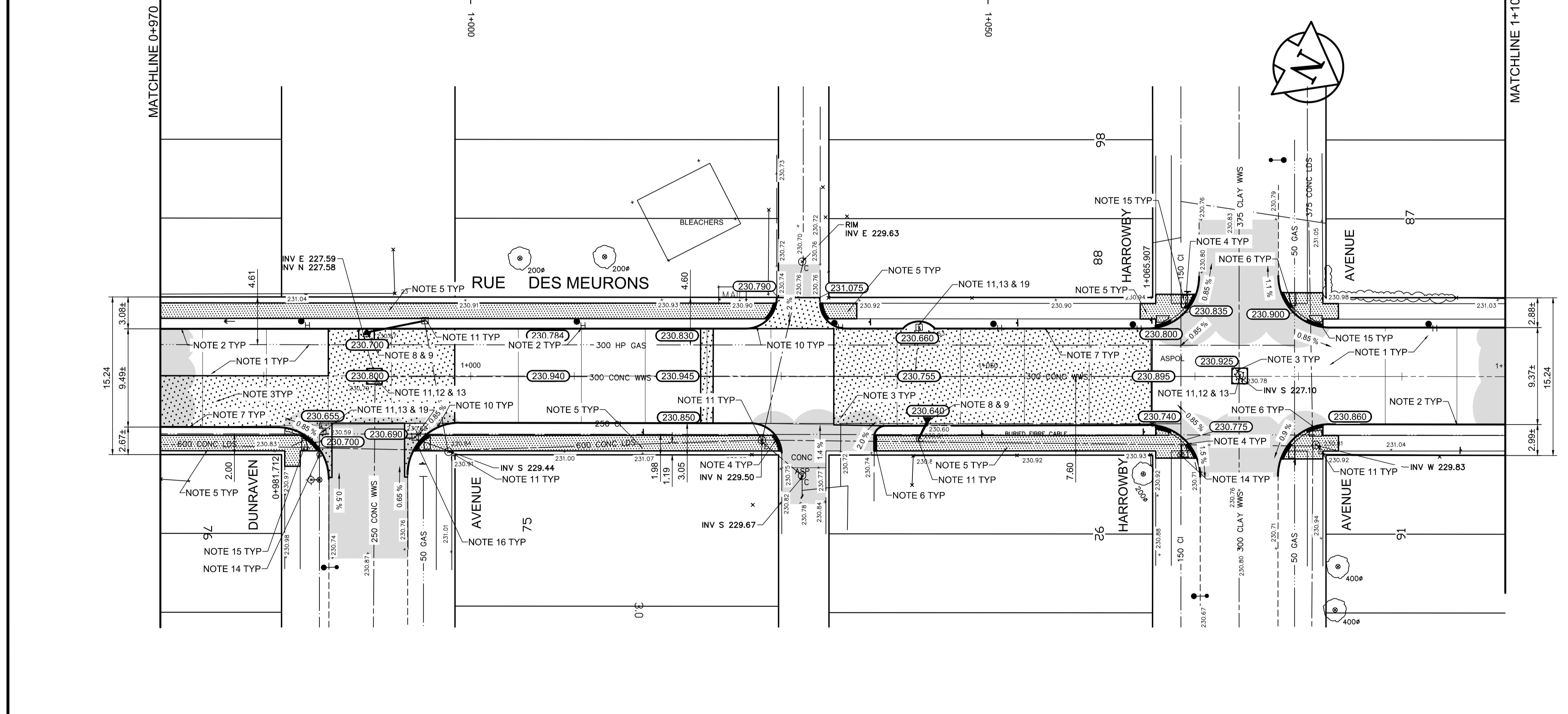

METRIC
WHOLE NUMBERS INDICATE MILLIMETRES
DECIMALIZED NUMBERS INDICATE METRES

150 mm W.W.		300 mm W.W.		HYDRO		C PROFILE	
	WATERMAIN		150 mm W.W.		M.T.S.		WEST GUTTER
	VALVE		300mm L.D.S.		CONCRETE		EAST GUTTER
	LAND DRAINAGE SEWER		250mm W.W.S.		ASPHALT		NW PROPERTY LINE
	WASTEWATER SEWER		MANHOLE		PROPERTY LINE		S/E PROPERTY LINE
	CATCH BASIN		SURVEY BAR		ELEVATION (235.750)		
	CATCH PIT		TREE		SIDEWALK RAMP		
	JUNCTIONS		CONCRETE SIDEWALK		FENCE		
	CULVERT						
	GAS						
	EXISTING		LEGEND - PLAN		PROPOSED		LEGEND - PROFILE
	PROPOSED		LEGEND - PLAN		PROPOSED		LEGEND - PROFILE

LOCATION APPROVED UNDERGROUND STRUCTURES

SUPV. U/G STRUCTURES COMMITTEE DATE

NOTE:
LOCATION OF UNDERGROUND STRUCTURES AS SHOWN ARE BASED ON THE BEST INFORMATION AVAILABLE, BUT NO GUARANTEE IS GIVEN THAT ALL EXISTING UTILITIES ARE SHOWN OR THAT THE GIVEN LOCATIONS ARE EXACT. CONFIRMATION OF EXISTENCE AND EXACT LOCATION OF ALL SERVICES MUST BE OBTAINED FROM THE INDIVIDUAL UTILITIES BEFORE PROCEEDING WITH CONSTRUCTION.

B.M. 52-054 85R410 S.W. Cor. Des Meurons & Vivian Ave., 1.8 m E. of W.L. of Rue Des Meurons & on S.L. of Vivian

ELEV. 231.032

NO.	REVISIONS	DATE	BY
1	MISCELLANEOUS REVISIONS	05/15/17	BC
0	ISSUED FOR TENDER	05/10/17	BC
A	ISSUED FOR REVIEW	05/01/17	BC

AECOM

DESIGNED BY: JT
CHECKED BY: TDW/BC
DRAWN BY: BC/PB
APPROVED BY:
HOR. SCALE: 1:250
VERTICAL: 1:10
RELEASED FOR CONSTRUCTION BY:
DATE

ENGINEER'S SEAL
PROVINCE OF MANITOBA
K.W. RAE
REGISTERED PROFESSIONAL ENGINEER
CONSULTANT DRAWING NO. CT-08

THE CITY OF WINNIPEG
PUBLIC WORKS DEPARTMENT
ENGINEERING DIVISION

2017 LOCAL STREET RENEWAL PROGRAM

RUE DES MEURONS - REGAL AVENUE / VIVIAN AVENUE
PAVEMENT REHABILITATION
STATION 0+970 TO STATION 1+100

CITY DRAWING NUMBER
SHEET 08 OF 27