

MATCHLINE 0+300

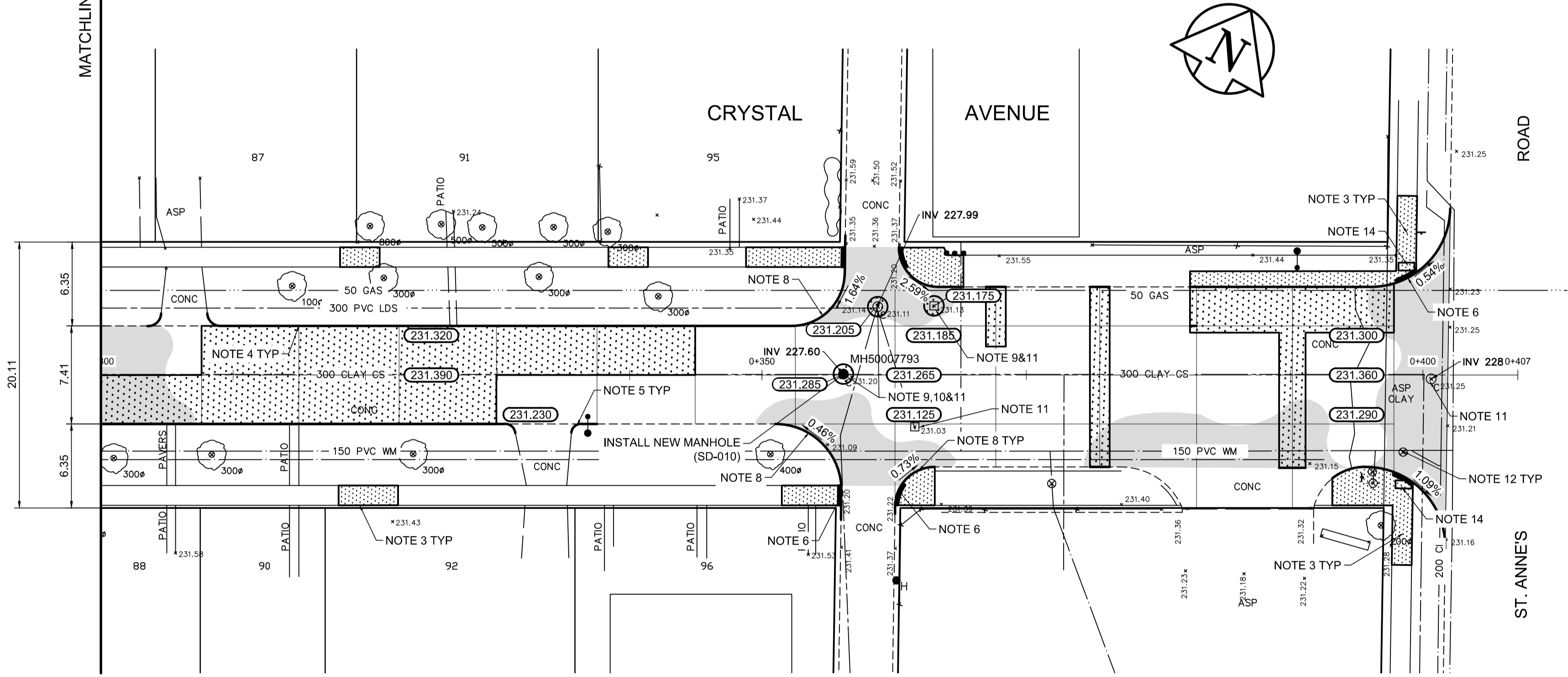

REFERENCE NOTES

- A. PAVEMENT DIMENSIONS ARE TO BACK OF CURB
- B. BASELINE IS CENTRE LINE RIGHT-OF-WAY
- C. PROPERTY LINES OBTAINED FROM CITY OF WINNIPEG L.B.I.S., AND NO SCALE FACTOR WAS APPLIED
- D. REFER TO AECOM FIELD BOOK NO. 4978

CONSTRUCTION NOTES

1. REMOVE EXISTING CONCRETE PAVEMENT AND CONSTRUCT NEW 150mm REINFORCED CONCRETE PAVEMENT C/W NEW ASPHALT OVERLAY
2. PLACE NEW ASPHALTIC OVERLAY TYPE 1A (85mm AVG. THICKNESS)
3. RENEW EXISTING 100mm CONCRETE SIDEWALK
4. CONSTRUCT NEW BARRIER CURB (100mm REVEAL HT. SEPERATE)
5. RENEW EXISTING CONCRETE BARRIER CURB (100mm REVEAL HT. DOWELLED)
6. CONSTRUCT NEW CURB RAMP (10mm REVEAL HT. INTEGRAL)
7. CONSTRUCT NEW MODIFIED BARRIER CURB (150mm REVEAL HT. INTEGRAL)
8. CONSTRUCT NEW MODIFIED BARRIER CURB (150mm REVEAL HT. DOWELLED)
9. ADJUST EXISTING MANHOLE/CATCH BASIN TO GRADE
10. REMOVE EXISTING FRAME AND COVER AND INSTALL NEW FRAME AND SOLID COVER (AP-006 AND AP-007)
11. INSTALL NEW CAST IRON RISER RING
12. ADJUST EXISTING WATER VALVE TO GRADE
13. ADJUST EXISTING PATIO BLOCK
14. INSTALL NEW DETECTABLE WARNING SURFACE TILES



METRIC
WHOLE NUMBERS INDICATE MILLIMETRES
DECIMALIZED NUMBERS INDICATE METRES

EXISTING	LEGEND - PLAN	PROPOSED	EXISTING	LEGEND - PLAN	PROPOSED	EXISTING	LEGEND - PROFILE	PROPOSED
	WATERMAIN			HYDRO			NORTH GUTTER	
	HYDRANT			CONCRETE			SOUTH GUTTER	
	VALVE			ASPHALT			N/W PROPERTY LINE	
	LAND DRAINAGE SEWER			PROPERTY LINE			S/E PROPERTY LINE	
	WASTEWATER SEWER			SURVEY BAR			ELEVATION	
	MANHOLE			TREE			SIDEWALK RAMP	
	CATCH BASIN			CONCRETE SIDEWALK			FENCE	
	CATCH PIT			EXISTING		EXISTING	LEGEND - PLAN	PROPOSED
	JUNCTIONS			EXISTING		EXISTING	LEGEND - PROFILE	PROPOSED
	CULVERT			EXISTING		EXISTING	LEGEND - PROFILE	PROPOSED
	GAS			EXISTING		EXISTING	LEGEND - PROFILE	PROPOSED

LOCATION APPROVED UNDERGROUND STRUCTURES

SUPV. U/G STRUCTURES COMMITTEE DATE

NOTE:
LOCATION OF UNDERGROUND STRUCTURES AS SHOWN ARE BASED ON THE BEST INFORMATION AVAILABLE, BUT NO GUARANTEE IS GIVEN THAT ALL EXISTING UTILITIES ARE SHOWN OR THAT THE GIVEN LOCATIONS ARE EXACT. CONFIRMATION OF EXISTENCE AND EXACT LOCATION OF ALL SERVICES MUST BE OBTAINED FROM THE INDIVIDUAL UTILITIES BEFORE PROCEEDING WITH CONSTRUCTION.

NO.	REVISIONS	DATE	BY
1	MISCELLANEOUS REVISIONS	05/15/17	BC
0	ISSUED FOR TENDER	05/10/17	BC
A	ISSUED FOR REVIEW	05/01/17	BC

B.M. 19-054 N.E. Cor. St. Anne's Rd. & Bank Ave., Tbl. in W. ELEV. 231.660 Conc. foundation of St. Vital Baptist Church

AECOM

DESIGNED BY	JC	CHECKED BY	TDW/KWR
DRAWN BY	JC/PB	APPROVED BY	
HOR. SCALE:	1:250	RELEASED FOR CONSTRUCTION BY:	
VERTICAL:	1:10	DATE	

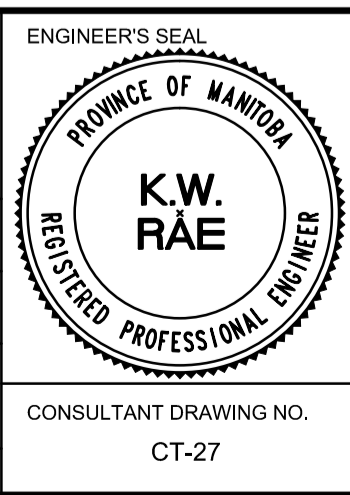

THE CITY OF WINNIPEG
PUBLIC WORKS DEPARTMENT
ENGINEERING DIVISION

2017 LOCAL STREET RENEWAL PROGRAM

CRYSTAL AVENUE - ST. THOMAS ROAD TO ST. ANNE'S ROAD
PAVEMENT REHABILITATION
STATION 0+300 TO ST. ANNE'S ROAD

CITY DRAWING NUMBER
SHEET 27 OF 27

CONSULTANT DRAWING NO. CT-27