

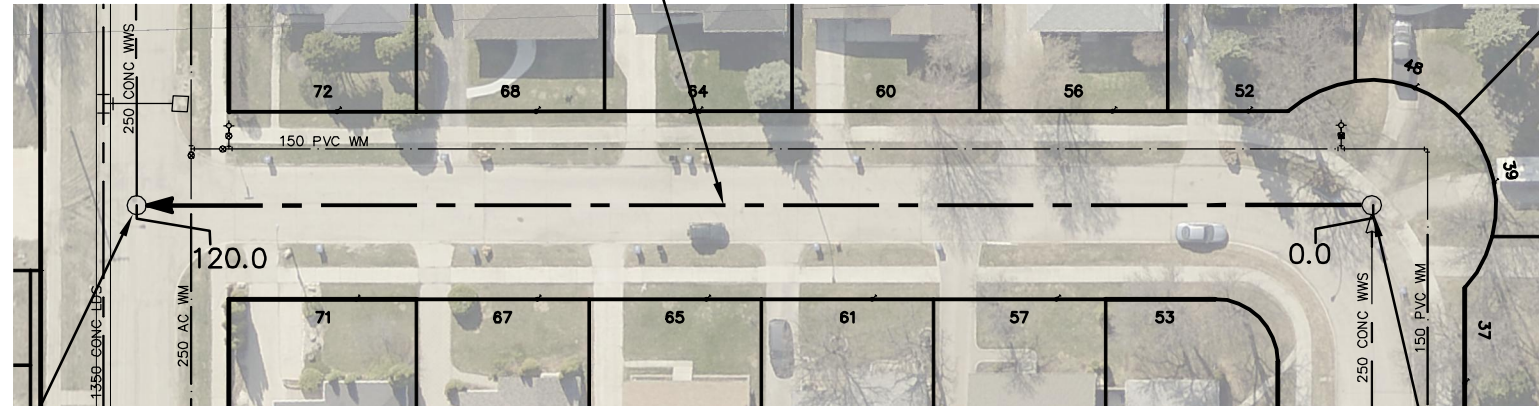

GOLDEN GATE BAY (W.LEG)

120.0 OF 250 VC WWS TO BE LINED
FULLY DETERIORATED
S-MA20005328



| SEWER JUNCTION INFORMATION FROM SEWER VIDEO INSPECTION | | |
|--|----------|-------|
| SEWER ID S-MA20005328 | | |
| DISTANCE FROM MH ID S-MH20004877 | | |
| DISTANCE | DIAMETER | CLOCK |
| 3.4 | 150 | 2 |
| 16.6 | 150 | 2 |
| 31.3 | 150 | 10 |
| 34.8 | 150 | 2 |
| 49.1 | 150 | 10 |
| 52.8 | 150 | 2 |
| 66.2 | 150 | 10 |
| 71.2 | 150 | 2 |
| 80.0 | 150 | 10 |
| 89.5 | 150 | 2 |
| 100.0 | 150 | 2 |
| 108.6 | 150 | 2 |
| 111.3 | 150 | 1 |

S-MH20004885
RIM 236.99
INV N 233.00
INV W 233.00

LODGE AVENUE

GOLDEN GATE BAY (N.LEG)

S-MH20004877
RIM 236.90
INV E 233.42
INV S 233.42

WARNING

IF POWER EQUIPMENT OR EXPLOSIVES ARE TO BE USED FOR EXCAVATION ON THIS PROJECT THE CONTRACTOR MUST:

- 1) NOTIFY THE GAS COMPANY OF THE PROPOSED LOCATION OF EXCAVATION.
- 2) TAKE PRECAUTION TO AVOID DAMAGE TO GAS COMPANY INSTALLATIONS.

SEE PROVINCIAL REGULATION 210/72 FOR DETAILS

FOR INDEX SEE
11551

METRIC

WHOLE NUMBERS INDICATE MILLIMETRES
DECIMALIZED NUMBERS INDICATE METRES

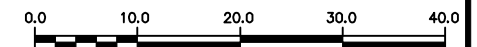

LOCATION APPROVED
UNDERGROUND STRUCTURES

B.M.
ELEV.

SUPV. U/G STRUCTURES COMMITTEE DATE

NOTE:

LOCATION OF UNDERGROUND STRUCTURES AS SHOWN ARE BASED ON THE BEST INFORMATION AVAILABLE BUT NO GUARANTEE IS GIVEN THAT ALL EXISTING UTILITIES ARE SHOWN OR THAT THE GIVEN LOCATIONS ARE EXACT. CONFIRMATION OF EXISTENCE AND EXACT LOCATION OF ALL SERVICES MUST BE OBTAINED FROM THE INDIVIDUAL UTILITIES BEFORE PROCEEDING WITH CONSTRUCTION.

| NO. | REVISIONS | DATE | BY |
|-----|-----------|------|----|
| | | | |
| | | | |
| | | | |

| | | | |
|-------------|-------|---------------------------|------------|
| DESIGNED BY | SC | CHECKED BY | SC |
| DRAWN BY | RJ | APPROVED BY | KZ |
| SCALE: | 1:750 | RELEASED FOR CONSTRUCTION | K. ZUREK |
| HORIZONTAL | | DATE | 2017 06 06 |
| VERTICAL | | DATE | 2017 07 04 |

PLOT DATE: 2017 07 04

ENGINEER'S SEAL

ORIGINAL
SIGNED BY
S.R.J.
COURNOYER
17/06/05

CONSULTANT DRAWING NUMBER

-

BID OPPORTUNITY: 343-2017
CONTRACT NUMBER: 5



THE CITY OF WINNIPEG
WATER AND WASTE DEPARTMENT
ENGINEERING DIVISION

2016 SEWER MAIN RENEWALS
BY CIPP LINING
GOLDEN GATE BAY (W.LEG)
MH AT GOLDEN GATE BAY (N.LEG) TO
MH AT LODGE AVENUE

SHEET 33 OF 79

CITY DRAWING NUMBER

11582

FILE PATH: R:\DRAWINGS\SEWER\2016 RENEWALS\Contract 5\Construction Dwg\
FILE NAME: GOLDENGATE_S-MA20005328.dwg