

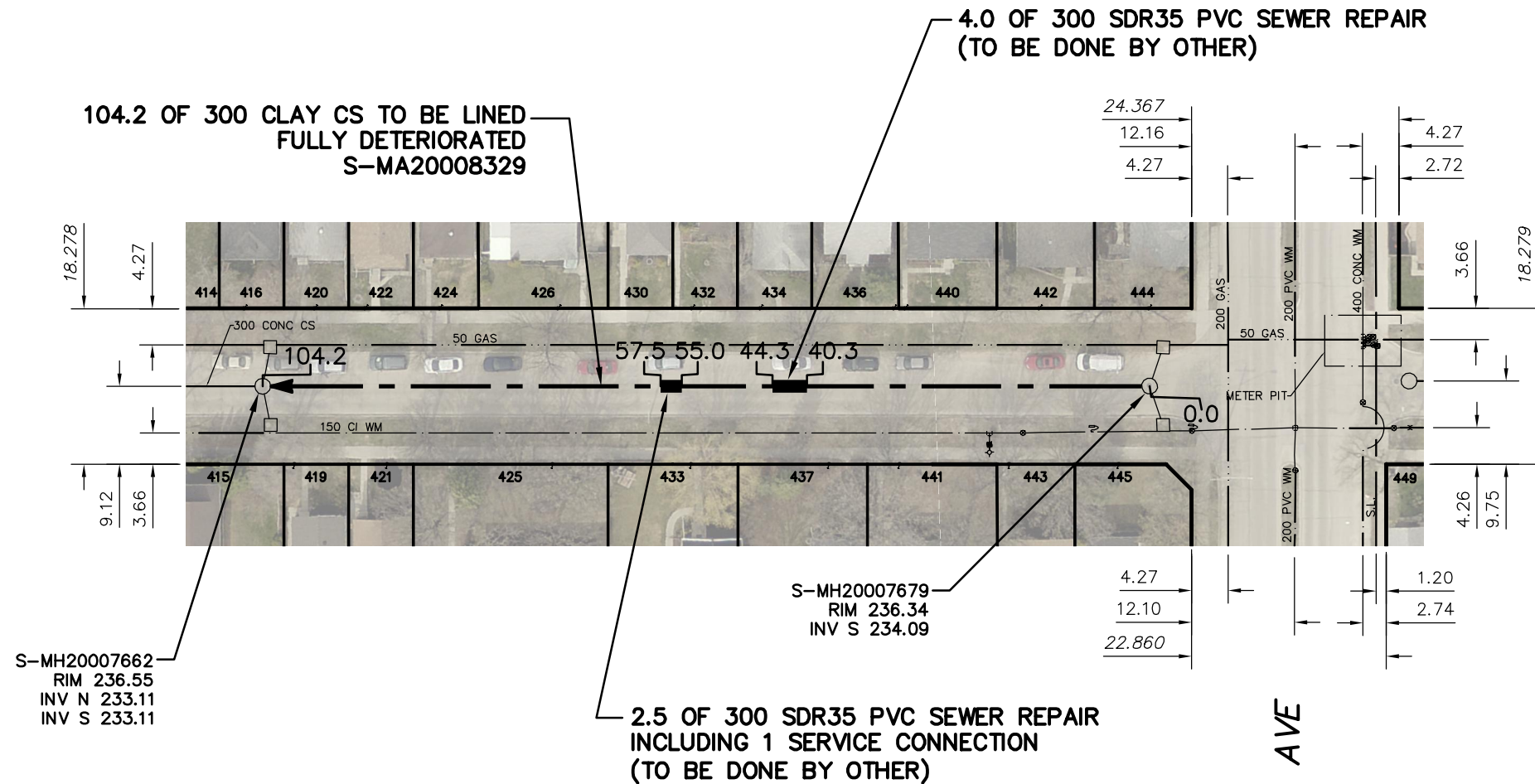

# ROSEBERRY STREET



SEWER JUNCTION INFORMATION FROM SEWER VIDEO INSPECTION		
SEWER ID S-MA20008329		
DISTANCE FROM MH ID S-MH20007679		
DISTANCE	DIAMETER	CLOCK
2.3	150	2
3.3	150	11
15.7	150	10
16.4	150	11
18.7	150	11
25.0	150	11
30.0	150	1
31.3	150	1
32.1	150	11
38.3	150	1
39.0	150	11
39.8	150	11
46.9	150	2
47.6	150	11
54.8	150	2
55.5	150	11
60.2	150	1
68.7	150	1
69.5	150	11
84.3	150	1
89.9	150	10
91.3	150	1
97.0	150	10
99.3	150	2
100.7	150	10

### WARNING

IF POWER EQUIPMENT OR EXPLOSIVES ARE TO BE USED FOR EXCAVATION ON THIS PROJECT THE CONTRACTOR MUST:

- 1) NOTIFY THE GAS COMPANY OF THE PROPOSED LOCATION OF EXCAVATION.
- 2) TAKE PRECAUTION TO AVOID DAMAGE TO GAS COMPANY INSTALLATIONS.

SEE PROVINCIAL REGULATION 210/72 FOR DETAILS

FOR INDEX SEE  
11552

### METRIC

WHOLE NUMBERS INDICATE MILLIMETRES  
DECIMALIZED NUMBERS INDICATE METRES

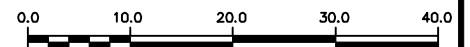

LOCATION APPROVED  
UNDERGROUND STRUCTURES

SUPV. U/G STRUCTURES COMMITTEE DATE

NOTE:

LOCATION OF UNDERGROUND STRUCTURES AS SHOWN ARE BASED ON THE BEST INFORMATION AVAILABLE BUT NO GUARANTEE IS GIVEN THAT ALL EXISTING UTILITIES ARE SHOWN OR THAT THE GIVEN LOCATIONS ARE EXACT. CONFIRMATION OF EXISTENCE AND EXACT LOCATION OF ALL SERVICES MUST BE OBTAINED FROM THE INDIVIDUAL UTILITIES BEFORE PROCEEDING WITH CONSTRUCTION.

NO.	REVISIONS	DATE	BY

DESIGNED BY	SC	CHECKED BY	SC
DRAWN BY	RJ	APPROVED BY	KZ
SCALE:	1:750	RELEASED FOR CONSTRUCTION	K. ZUREK
HORIZONTAL		DATE	2017 07 04
VERTICAL		DATE	2017 06 06

ENGINEER'S SEAL  
ORIGINAL  
SIGNED BY  
S.R.J.  
COURNOYER  
17/06/05  
CONSULTANT DRAWING NUMBER  
-



**THE CITY OF WINNIPEG**  
WATER AND WASTE DEPARTMENT  
ENGINEERING DIVISION

2016 SEWER MAIN RENEWALS  
BY AUGMENTATION  
**ROSEBERRY STREET**  
MH AT SILVER AVENUE (SR) TO  
1ST MH S OF SILVER AVENUE

SHEET 55 OF 79  
CITY DRAWING NUMBER

11604