

ELLICE AVENUE

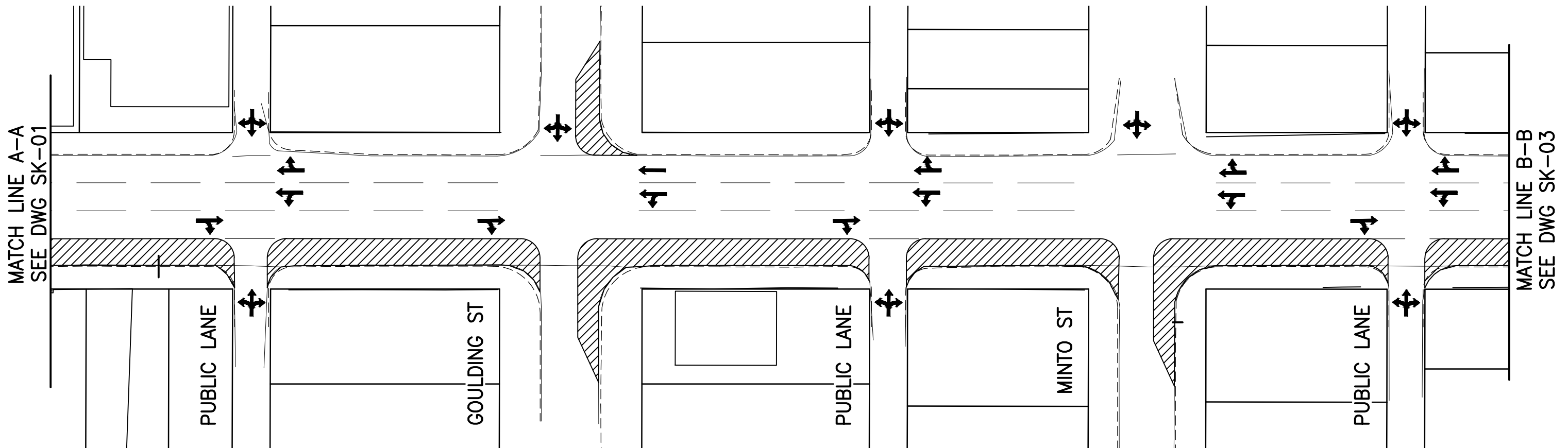

TRAFFIC CONTROL DURING CONSTRUCTION SHALL BE AS FOLLOWS:

1. MAINTAIN A MINIMUM OF ONE LANE IN THE EASTBOUND AND WESTBOUND DIRECTIONS ON ELLICE AVENUE AT ALL TIMES. MAINTAIN TWO LANES WESTBOUND AND ONE LANE EASTBOUND FROM 15:30 TO 17:30 HOURS MONDAY TO FRIDAY.
2. CONSTRUCTION ACTIVITIES ON REGIONAL STREETS SHALL BE RESTRICTED TO THE CLOSED LANES BETWEEN 07:00 TO 09:00 HOURS AND 15:30 TO 17:30 HOURS MONDAY TO FRIDAY AND OTHER HOURS AS DIRECTED BY THE CONTRACT ADMINISTRATOR.
3. THE CONTRACTOR WILL HAVE ACCESS TO THE OPEN LANES OF TRAFFIC DURING NON-RESTRICTED HOURS PROVIDED FLAG PERSONS ARE USED IN ACCORDANCE WITH SECTION 3.12 OF THE CITY OF WINNIPEG, "MANUAL OF TEMPORARY TRAFFIC CONTROL IN WORK AREAS ON CITY STREETS" TO MAINTAIN TRAFFIC SAFETY.



LEGEND:

CONSTRUCTION AREA/
LANE CLOSURES

BID OPPORTUNITY 351-2017

LOCATION APPROVED
UNDERGROUND STRUCTURES

SUPV. U/G STRUCTURES COMMITTEE DATE

NOTE:
LOCATION OF UNDERGROUND STRUCTURES AS SHOWN ARE BASED ON THE BEST INFORMATION AVAILABLE BUT NO GUARANTEE IS GIVEN THAT ALL EXISTING UTILITIES ARE SHOWN OR THAT THE GIVEN LOCATIONS ARE EXACT. CONFIRMATION OF EXISTENCE AND EXACT LOCATION OF ALL SERVICES MUST BE OBTAINED FROM THE INDIVIDUAL UTILITIES BEFORE PROCEEDING WITH CONSTRUCTION.

B.M. ELEV.	NO.	REVISIONS	DATE	BY



DESIGNED BY	R.S.	CHECKED BY	W.B.
DRAWN BY	R.S.	APPROVED BY	R.S.
HOR. SCALE:	1:500	RELEASED FOR CONSTRUCTION:	
VERTICAL:		DATE	2017.04.12

ENGINEER'S SEAL

CONSULTANT DRAWING NO.
C-702



THE CITY OF WINNIPEG
WATER AND WASTE DEPARTMENT

TRAFFIC MANAGEMENT PLAN
ELLICE AVENUE - WALL ST. TO PUBLIC LANE
2017 WATERMAIN RENEWALS
CONTRACT NO. 10

SHEET	2	OF	6
CAD FILE DRAWING NUMBER	16670c-701		
CITY DRAWING NUMBER	SK-02		

V:\1112\active\11216670\0300_drawing\0301_sketches\16670c-701.dwg

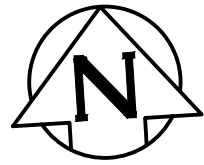

ELLICE AVENUE

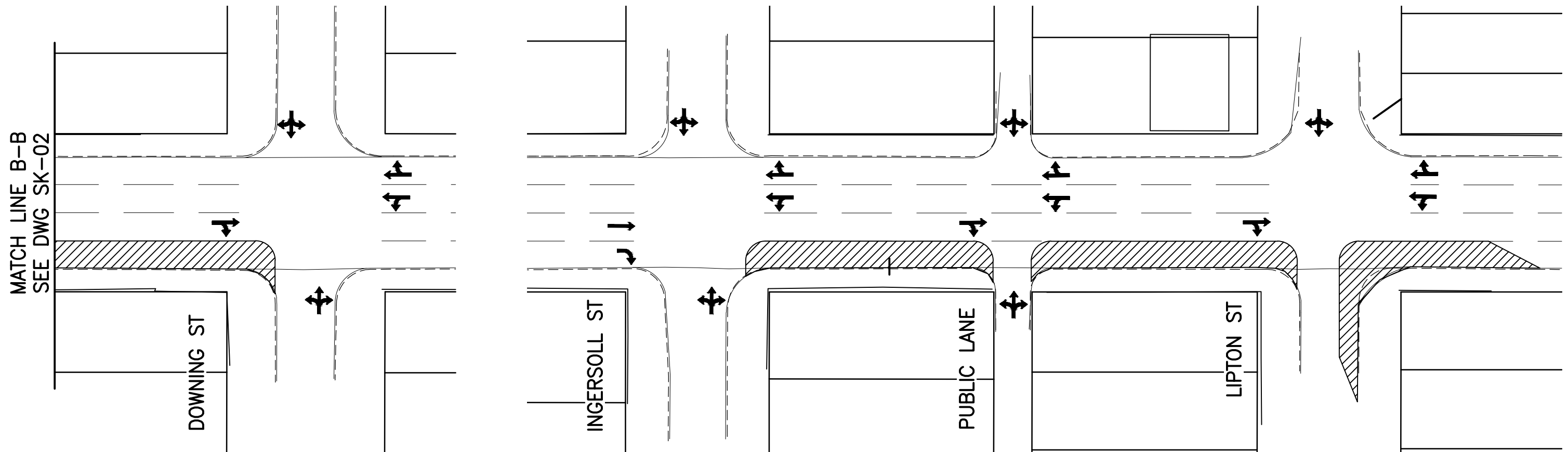

MATCH LINE B-B
SEE DWG SK-02

TRAFFIC CONTROL DURING CONSTRUCTION SHALL BE AS FOLLOWS:

1. MAINTAIN A MINIMUM OF ONE LANE IN THE EASTBOUND AND WESTBOUND DIRECTIONS ON ELLICE AVENUE AT ALL TIMES. MAINTAIN TWO LANES WESTBOUND AND ONE LANE EASTBOUND FROM 15:30 TO 17:30 HOURS MONDAY TO FRIDAY.
2. CONSTRUCTION ACTIVITIES ON REGIONAL STREETS SHALL BE RESTRICTED TO THE CLOSED LANES BETWEEN 07:00 TO 09:00 HOURS AND 15:30 TO 17:30 HOURS MONDAY TO FRIDAY AND OTHER HOURS AS DIRECTED BY THE CONTRACT ADMINISTRATOR.
3. THE CONTRACTOR WILL HAVE ACCESS TO THE OPEN LANES OF TRAFFIC DURING NON-RESTRICTED HOURS PROVIDED FLAG PERSONS ARE USED IN ACCORDANCE WITH SECTION 3.12 OF THE CITY OF WINNIPEG, "MANUAL OF TEMPORARY TRAFFIC CONTROL IN WORK AREAS ON CITY STREETS" TO MAINTAIN TRAFFIC SAFETY.



LEGEND:



BID OPPORTUNITY 351-2017

LOCATION APPROVED UNDERGROUND STRUCTURES	
SUPV. U/G STRUCTURES COMMITTEE	DATE
NOTE: LOCATION OF UNDERGROUND STRUCTURES AS SHOWN ARE BASED ON THE BEST INFORMATION AVAILABLE BUT NO GUARANTEE IS GIVEN THAT ALL EXISTING UTILITIES ARE SHOWN OR THAT THE GIVEN LOCATIONS ARE EXACT. CONFIRMATION OF EXISTENCE AND EXACT LOCATION OF ALL SERVICES MUST BE OBTAINED FROM THE INDIVIDUAL UTILITIES BEFORE PROCEEDING WITH CONSTRUCTION.	
NO.	REVISIONS
DATE	BY

B.M. ELEV.			

Stantec
500-311 Portage Ave, Winnipeg, Manitoba
Tel 204-489-5900 Fax 204-453-9012

DESIGNED BY	R.S.	CHECKED BY	W.B.
DRAWN BY	R.S.	APPROVED BY	R.S.
HOR. SCALE:	1:500	RELEASED FOR CONSTRUCTION:	
VERTICAL:		DATE	
DATE	2017.04.12	DATE	

ENGINEER'S SEAL

CONSULTANT DRAWING NO.
C-703

THE CITY OF WINNIPEG
WATER AND WASTE DEPARTMENT

TRAFFIC MANAGEMENT PLAN
ELLICE AVE. - DOWNING ST. & INGERSOLL ST. TO LIPTON ST.
2017 WATERMAIN RENEWALS
CONTRACT NO. 10

SHEET	3	OF	6
CAD FILE DRAWING NUMBER 16670c-701			
CITY DRAWING NUMBER SK-05			

V:\1112\active\11216670\0300_drawing\0301_sketches\16670c-701.dwg

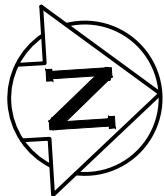

MATCH LINE C-C
SEE DWG SK-05

EMPRESS STREET

ST. MATTHEWS AVE

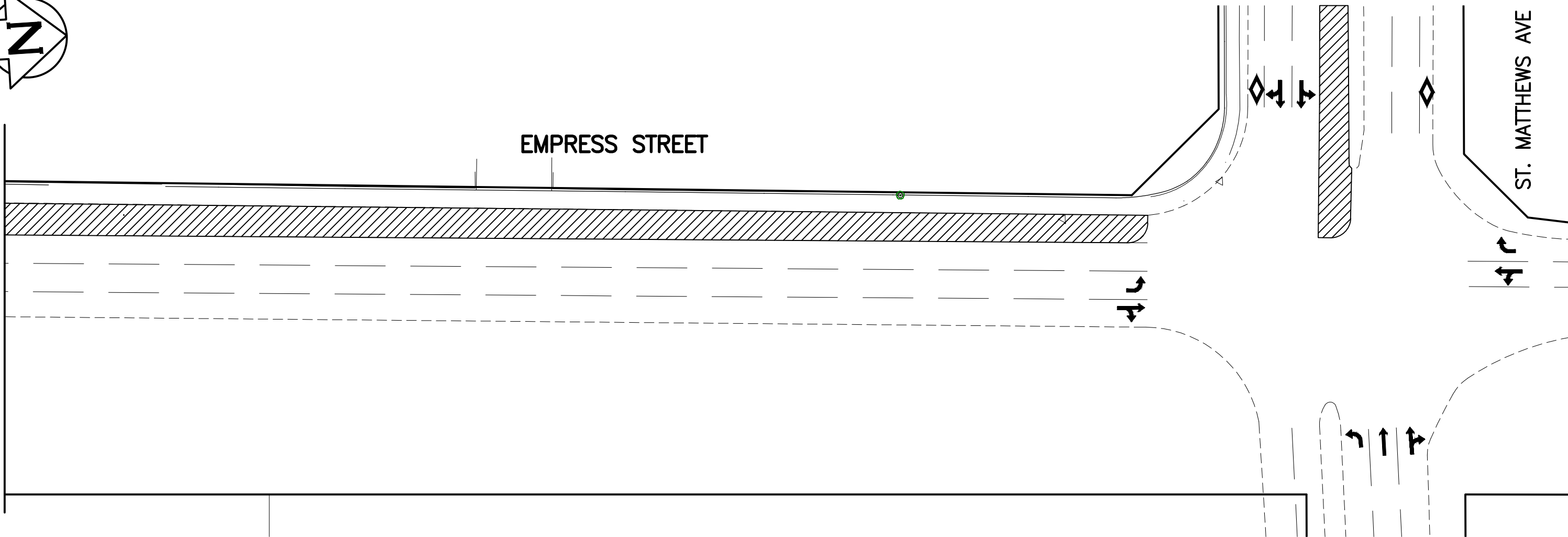

TRAFFIC CONTROL DURING CONSTRUCTION SHALL BE AS FOLLOWS:

1. MAINTAIN A MINIMUM OF ONE LANE IN THE SOUTHBOUND DIRECTION AND TWO LANES IN THE NORTHBOUND DIRECTION ON EMPRESS STREET AT ALL TIMES.
2. CONSTRUCTION ACTIVITIES ON REGIONAL STREETS SHALL BE RESTRICTED TO THE CLOSED LANES BETWEEN 07:00 TO 09:00 HOURS AND 15:30 TO 17:30 HOURS MONDAY TO FRIDAY AND OTHER HOURS AS DIRECTED BY THE CONTRACT ADMINISTRATOR.
3. THE CONTRACTOR WILL HAVE ACCESS TO THE OPEN LANES OF TRAFFIC DURING NON-RESTRICTED HOURS PROVIDED FLAG PERSONS ARE USED IN ACCORDANCE WITH SECTION 3.12 OF THE CITY OF WINNIPEG, "MANUAL OF TEMPORARY TRAFFIC CONTROL IN WORK AREAS ON CITY STREETS" TO MAINTAIN TRAFFIC SAFETY.



LEGEND:

CONSTRUCTION AREA/
LANE CLOSURES

BID OPPORTUNITY 351-2017

LOCATION APPROVED UNDERGROUND STRUCTURES

SUPV. U/G STRUCTURES COMMITTEE _____ DATE _____

NOTE:
LOCATION OF UNDERGROUND STRUCTURES AS SHOWN ARE BASED ON THE BEST INFORMATION AVAILABLE BUT NO GUARANTEE IS GIVEN THAT ALL EXISTING UTILITIES ARE SHOWN OR THAT THE GIVEN LOCATIONS ARE EXACT. CONFIRMATION OF EXISTENCE AND EXACT LOCATION OF ALL SERVICES MUST BE OBTAINED FROM THE INDIVIDUAL UTILITIES BEFORE PROCEEDING WITH CONSTRUCTION.

NO.	REVISIONS	DATE	BY

Stantec
500-311 Portage Ave, Winnipeg, Manitoba
Tel 204-489-5900 Fax 204-453-9012

DESIGNED BY	R.S.	CHECKED BY	W.B.
DRAWN BY	R.S.	APPROVED BY	R.S.
HOR. SCALE:	1:500	RELEASED FOR CONSTRUCTION:	
VERTICAL:			
DATE	2017.04.12	DATE	

ENGINEER'S SEAL

CONSULTANT DRAWING NO.
C-704

THE CITY OF WINNIPEG
WATER AND WASTE DEPARTMENT

TRAFFIC MANAGEMENT PLAN
EMPRESS ST - 155m>NNL MAROONS RD TO ST. MATTHEWS AVE
2017 WATERMAIN RENEWALS
CONTRACT NO. 10

SHEET	OF
6	6
CAD FILE DRAWING NUMBER 16670c-701	
CITY DRAWING NUMBER SK-06	

V:\1112\active\11216670\0300_drawing\0301_sketches\16670c-701.dwg