

NOTE: CHAINAGES SHOWN ARE ALONG S. P. OF ELLICE AVE

ELLICE AVENUE

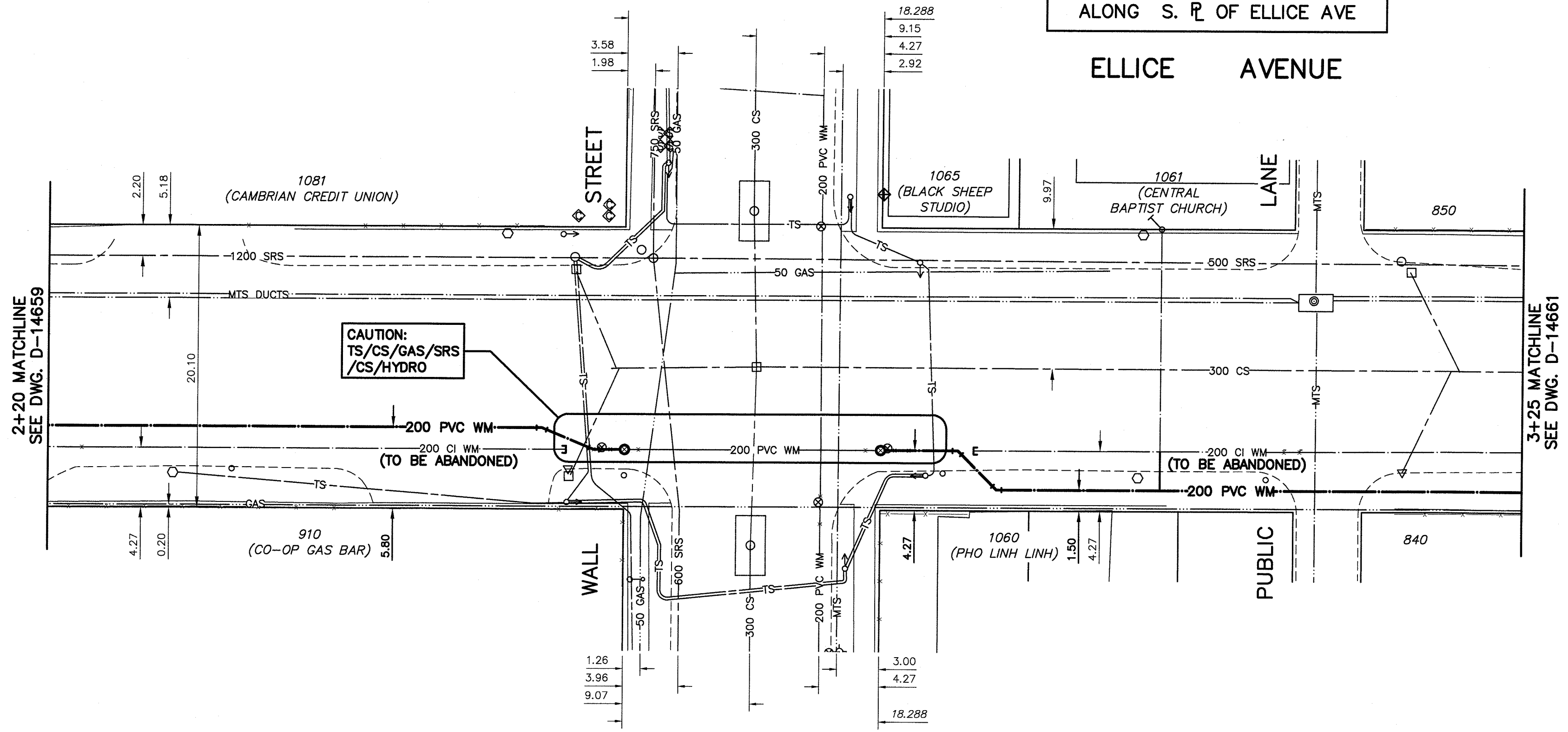

WATER SERVICE INFORMATION

ADDRESS	SIZE (mm) MATERIAL (STREET)	SIZE (mm) MATERIAL (PROP.)	SHORT & LONG MEASUREMENT	CORP. LOCATION	REMARKS
1061 ELLICE AVENUE COMMERCIAL	25 COPPER	25 COPPER	8.2m WEL	-	RECONNECT SERVICE

* SERVICES TO BE RENEWED TO P/L. ALL OTHERS TO BE RECONNECTED



NOTE: ALL VALVES TO BE INSTALLED COUNTERCLOCKWISE TO CLOSE

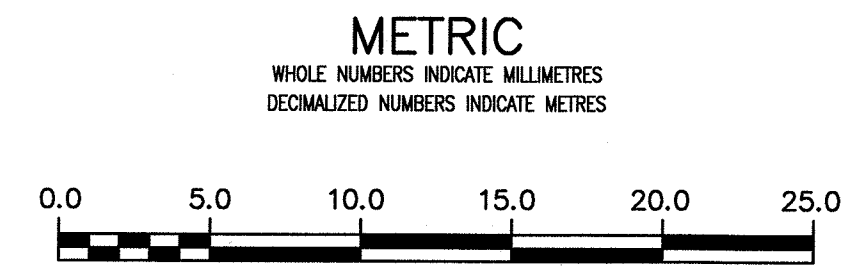

WARNING
IF POWER EQUIPMENT OR EXPLOSIVES ARE TO BE USED FOR EXCAVATION ON THIS PROJECT THE CONTRACTOR MUST:
1) NOTIFY THE GAS COMPANY OF THE PROPOSED LOCATION OF EXCAVATION.
2) TAKE PRECAUTION TO AVOID DAMAGE TO GAS COMPANY INSTALLATIONS.
SEE PROVINCIAL REGULATION 210/72 FOR DETAILS

LOCATION APPROVED UNDERGROUND STRUCTURES
SUPV. U/O STRUCTURES COMMITTEE DATE
NOTE:
LOCATION OF UNDERGROUND STRUCTURES AS SHOWN ARE BASED ON THE BEST INFORMATION AVAILABLE BUT NO GUARANTEE IS GIVEN THAT ALL EXISTING UTILITIES ARE SHOWN OR THAT THE GIVEN LOCATIONS ARE EXACT. CONFIRMATION OF EXISTENCE AND EXACT LOCATION OF ALL SERVICES MUST BE OBTAINED FROM THE INDIVIDUAL UTILITIES BEFORE PROCEEDING WITH CONSTRUCTION.

B.M. 37-33 ELEV. 233.716m	N.W. Cor. St. Matthews Ave. & Dominion St., Tblt. in S. tyndall stone foundation of Minto Armoury, 0.7m		
DESIGNED BY	RS	CHECKED BY	WB
DRAWN BY	KR	APPROVED BY	RS
SCALE:	HORIZONTAL 1:250	VERTICAL 1:50	RELEASED FOR CONSTRUCTION
DATE	2017 03 22	DATE	4/28/17
NO.	REVISIONS	DATE	BY
02	ISSUED FOR TENDER	2017.04.28	RS
01	ISSUED FOR REVIEW	2017.04.18	RS

ENGINEER'S SEAL
PROVINCE OF MANITOBA
APRIL 28/17
R.M. SHERLOCK
MEMBER 24045
REGISTERED PROFESSIONAL ENGINEER
CONSULTANT DRAWING NUMBER
C-202

THE CITY OF WINNIPEG
WATER AND WASTE DEPARTMENT
ENGINEERING DIVISION

2017 WATERMAIN RENEWALS
CONTRACT 10
ELLICE AVENUE
120 EWL ERIN STREET TO
46 EEL WALL STREET

SHEET 4 OF 17
CITY DRAWING NUMBER
D14660