

NOTE: CHAINAGES SHOWN ARE ALONG S. R. OF ELLICE AVE

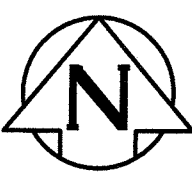

NOTE: ALL VALVES TO BE INSTALLED COUNTERCLOCKWISE TO CLOSE

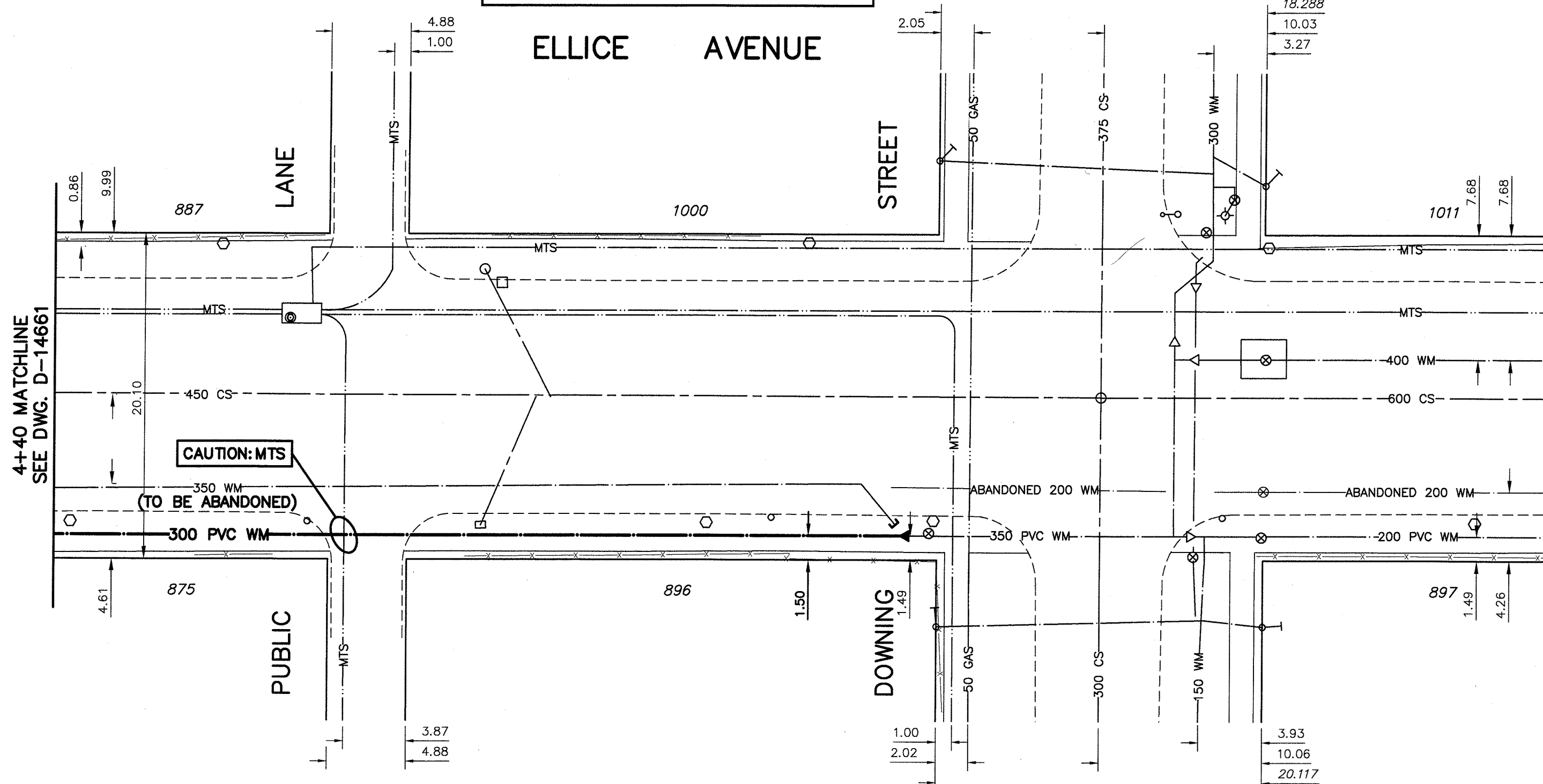
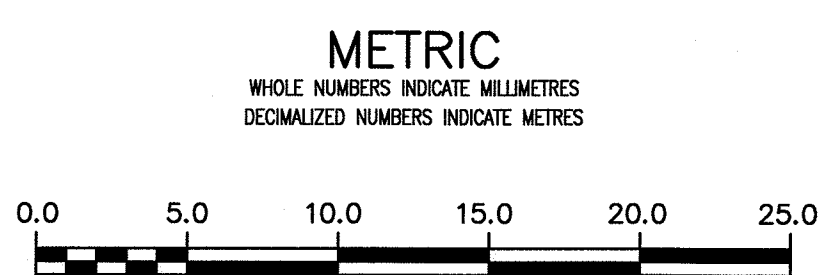

WARNING
IF POWER EQUIPMENT OR EXPLOSIVES ARE TO BE USED FOR EXCAVATION ON THIS PROJECT THE CONTRACTOR MUST:
1) NOTIFY THE GAS COMPANY OF THE PROPOSED LOCATION OF EXCAVATION.
2) TAKE PRECAUTION TO AVOID DAMAGE TO GAS COMPANY INSTALLATIONS.
SEE PROVINCIAL REGULATION 210/72 FOR DETAILS

LOCATION APPROVED UNDERGROUND STRUCTURES
SHPV. U/G STRUCTURES COMMITTEE DATE
NOTE:
LOCATION OF UNDERGROUND STRUCTURES AS SHOWN ARE BASED ON THE BEST INFORMATION AVAILABLE BUT NO GUARANTEE IS GIVEN THAT ALL EXISTING UTILITIES ARE SHOWN OR THAT THE GIVEN LOCATIONS ARE EXACT. CONFIRMATION OF EXISTENCE AND EXACT LOCATION OF ALL UTILITIES MUST BE OBTAINED FROM THE INDIVIDUAL UTILITIES BEFORE PROCEEDING WITH CONSTRUCTION.

B.M. 37-33 ELEV. 233.716m	N.W. Cor. St. Matthews Ave. & Dominion St., Tblt. in S. byndall stone foundation of Minto Armoury, 0.7m		
NO.	REVISIONS	DATE	BY
02	ISSUED FOR TENDER	2017.04.28	RS
01	ISSUED FOR REVIEW	2017.04.18	RS

Stantec

DESIGNED BY: RS
DRAWN BY: KR
SCALE: HORIZONTAL 1:250, VERTICAL 1:50
DATE: 2017 03 22
PLOT DATE: 2017 04 27

CHECKED BY: WB
APPROVED BY: RS
RELEASED FOR CONSTRUCTION
DATE: 2017 04 27

ENGINEER'S SEAL
PROVINCE OF MANITOBA
APRIL 2 2017
R.M. SHERLOCK
MEMBER 24045
REGISTERED PROFESSIONAL ENGINEER
CONSULTANT DRAWING NUMBER C-204

THE CITY OF WINNIPEG
WATER AND WASTE DEPARTMENT
ENGINEERING DIVISION

2017 WATERMAIN RENEWALS
CONTRACT 10
ELLICE AVENUE
6 EEL MINTO STREET TO
DOWNING STREET

SHEET 6 OF 17
CITY DRAWING NUMBER D-14662

APEGM
Certificate of Authorization
Stantec Consulting Ltd.
No. 1301