

NOTE: CHAINAGES SHOWN ARE ALONG W. P. OF EMPRESS STREET

EMPRESS STREET

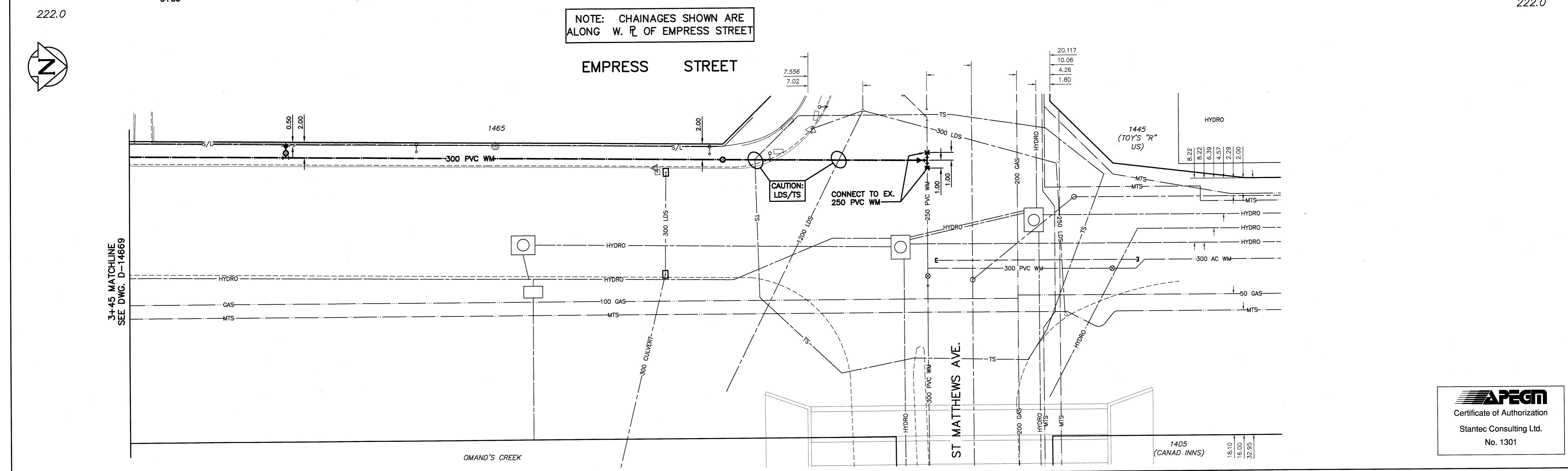

APEGM
Certificate of Authorization
Stantec Consulting Ltd.
No. 1301

NOTE: ALL VALVES TO BE INSTALLED COUNTERCLOCKWISE TO CLOSE

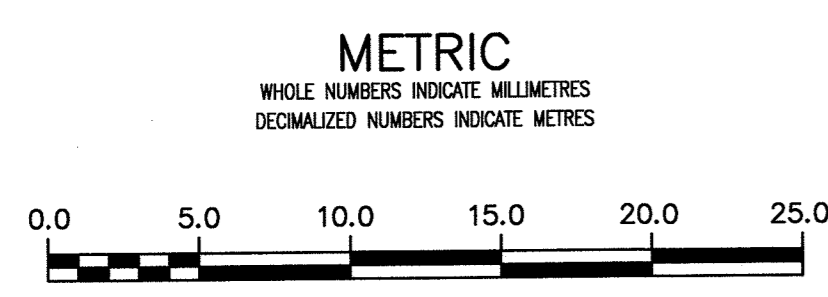

WARNING
IF POWER EQUIPMENT OR EXPLOSIVES ARE TO BE USED FOR EXCAVATION ON THIS PROJECT THE CONTRACTOR MUST:
1) NOTIFY THE GAS COMPANY OF THE PROPOSED LOCATION OF EXCAVATION.
2) TAKE PRECAUTION TO AVOID DAMAGE TO GAS COMPANY INSTALLATIONS.
SEE PROVINCIAL REGULATION 210/72 FOR DETAILS

LOCATION APPROVED UNDERGROUND STRUCTURES
SUPV. U/G STRUCTURES COMMITTEE DATE
NOTE:
LOCATION OF UNDERGROUND STRUCTURES AS SHOWN ARE BASED ON THE BEST INFORMATION AVAILABLE BUT NO GUARANTEE IS GIVEN THAT ALL EXISTING UTILITIES ARE SHOWN OR THAT THE GIVEN LOCATIONS ARE EXACT. CONFIRMATION OF EXISTENCE AND EXACT LOCATION OF ALL SERVICES MUST BE OBTAINED FROM THE INDIVIDUAL UTILITIES BEFORE PROCEEDING WITH CONSTRUCTION.

B.M. 37-3 ELEV. 233.449m	Bolt in 7.3m Conc. pile on St Matthews & Strathcona		
NO.	REVISIONS	DATE	BY
02	ISSUED FOR TENDER	2017.04.28	RS
01	ISSUED FOR REVIEW	2017.04.18	RS

Stantec

DESIGNED BY	RS	CHECKED BY	WB
DRAWN BY	KR	APPROVED BY	RS
SCALE:	RELEASED FOR CONSTRUCTION		
HORIZONTAL	1:250		
VERTICAL	1:50		
DATE	2017 03 22		
PLOT DATE:	2017 04 27		

ENGINEER'S SEAL
PROVINCE OF MANITOBA
APRIL 28 2017
R.M. SHERLOCK
REGISTERED PROFESSIONAL ENGINEER
CONSULTANT DRAWING NUMBER
C-212

THE CITY OF WINNIPEG
WATER AND WASTE DEPARTMENT
ENGINEERING DIVISION

2017 WATERMAIN RENEWALS
CONTRACT 10
EMPRESS STREET
245 NSL MAROONS ROAD TO
ST. MATTHEWS AVENUE

SHEET 14 OF 17
CITY DRAWING NUMBER
D-14670