





Location Plan
n.t.s.



Legend

-  water hydrant
-  water valve
-  catch basin
-  sewer manhole



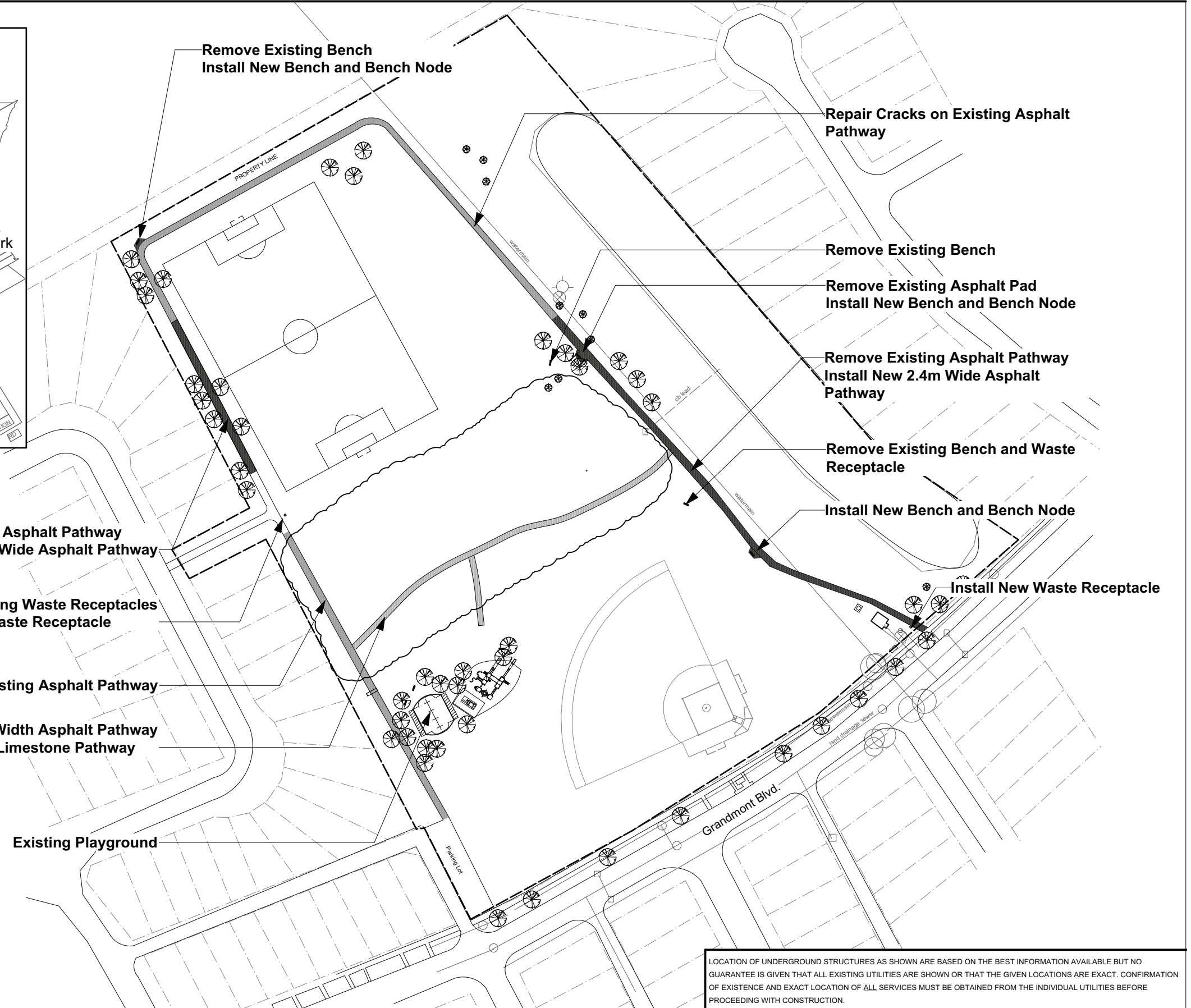

LOCATION OF UNDERGROUND STRUCTURES AS SHOWN ARE BASED ON THE BEST INFORMATION AVAILABLE BUT NO GUARANTEE IS GIVEN THAT ALL EXISTING UTILITIES ARE SHOWN OR THAT THE GIVEN LOCATIONS ARE EXACT. CONFIRMATION OF EXISTENCE AND EXACT LOCATION OF ALL SERVICES MUST BE OBTAINED FROM THE INDIVIDUAL UTILITIES BEFORE PROCEEDING WITH CONSTRUCTION.



THE CITY OF WINNIPEG
Planning, Property and Development Dept.
Urban Design Division
15-30 Fort Street, Winnipeg, MB, (R3C 4X5)

DESIGNED BY	CH	CHECKED BY	APPROVED BY
DRAWN BY	CH	RELEASED FOR CONSTRUCTION	
HORIZ. SCALE	1 : 1500		
VERT. SCALE			
DATE	May/17	MANAGER, URBAN DESIGN DIVISION	DATE

DRAWING TITLE	GRANDMONT PARK Proposed Pathway Work
SITE ADDRESS	225 Grandmont Blvd.

CAD DRAWING NO.	
DRAWING NO.	G.7-G1