

**NOTES:**

- ISOLATE EXISTING HYDRO POLES AS DIRECTED BY CONTRACT ADMINISTRATOR
- RENEW EXISTING APPROACHES AND SIDEWALK AS DIRECTED BY CONTRACT ADMINISTRATOR
- ADDITIONAL EXCAVATION AND INSTALLATION OF SUBGRADE GEOGRID TO BE DETERMINED BY CONTRACT ADMINISTRATOR
- ADJUSTMENTS TO PROPOSED CROSSFALL, WHERE REQUIRED, ARE TO BE DETERMINED BY CONTRACT ADMINISTRATOR TO SUIT EXISTING DRIVEWAYS, APPROACHES, ETC.
- LIGHT STANDARDS, HYDROPOLES, AND ANCHORS MAY REQUIRE SUPPORT AND/OR REMOVAL AND REPLACEMENT AT CONTRACTORS EXPENSE

NOTE: CHAINAGES SHOWN ARE ALONG  $\phi$  OF PUBLIC RIGHT-OF-WAY

FOR CONTINUATION SEE DWG 171-01396-00-28

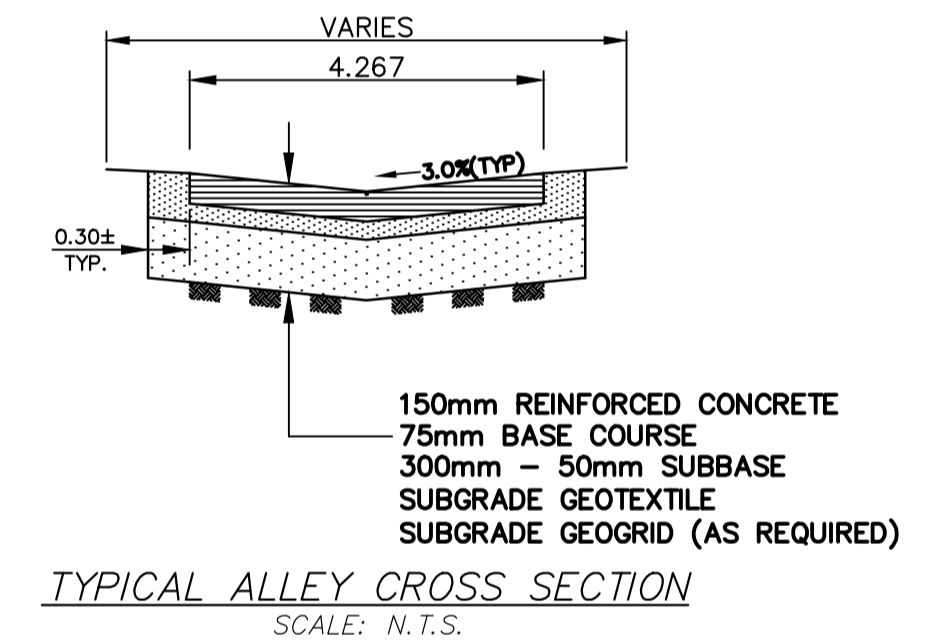
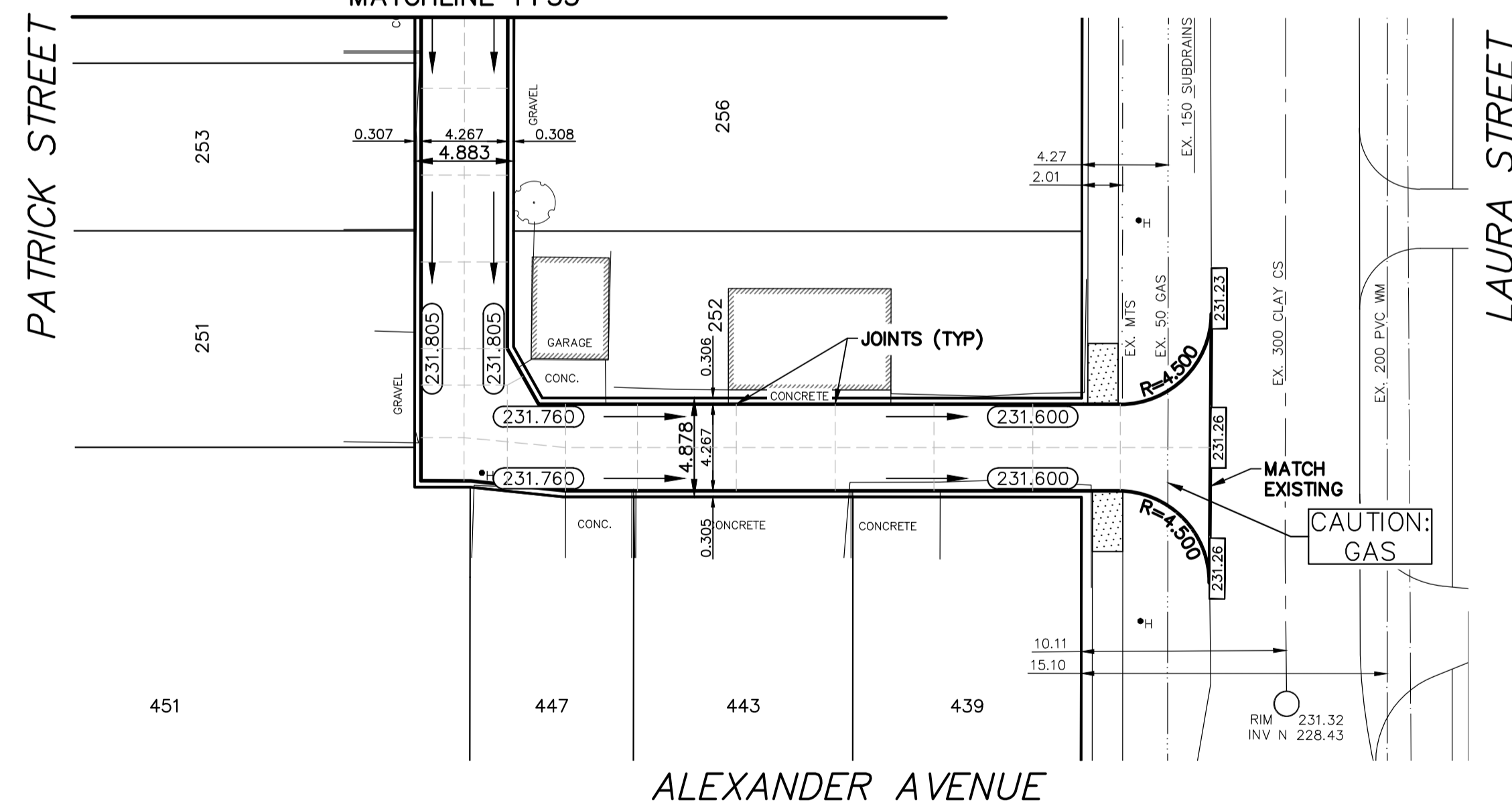

**METRIC**  
WHOLE NUMBERS INDICATE MILLIMETRES  
DECIMALIZED NUMBERS INDICATE METRES



EXISTING	LEGEND - PLAN	PROPOSED	EXISTING	LEGEND - PLAN	PROPOSED	EXISTING	LEGEND - PROFILE	PROPOSED
	WATERMAIN			GAS			WATERMAIN VALVE	
	HYDRANT			M.T.S.			LAND DRAINAGE SEWER	
	VALVE			TRAFFIC SIGNALS			WASTE WATER SEWER	
	CURB STOP			CONCRETE/ASPHALT			CENTERLINE	
	LAND DRAINAGE SEWER			SIDEWALK			SOUTH & EAST GUTTER	
	WASTE WATER SEWER			CURB RAMP			NORTH & WEST GUTTER	
	CB LEAD			ELEVATIONS			S & E GARAGE PAD	
	MANHOLE			PROPERTY LINE			N & W GARAGE PAD	
	CATCH BASIN			SURVEY BAR				
	CURB INLET							
	HYDRO							

**LOCATION APPROVED UNDERGROUND STRUCTURES**

SUPV. COMMITTEE	U/G STRUCTURES	DATE

NOTE: LOCATION OF UNDERGROUND STRUCTURES AS SHOWN ARE BASED ON THE BEST INFORMATION AVAILABLE BUT NO GUARANTEE IS GIVEN THAT ALL EXISTING UTILITIES ARE SHOWN OR THAT THE GIVEN LOCATIONS ARE EXACT. CONFIRMATION OF EXISTENCE AND EXACT LOCATION OF ALL SERVICES MUST BE OBTAINED FROM THE INDIVIDUAL UTILITIES BEFORE PROCEEDING WITH CONSTRUCTION.

B.M. ELEV.			

	111-93 Lombard Avenue Winnipeg, Manitoba R3B 3B1 Canada Phone: 204-943-3178 Fax: 204-943-4948 wsp.com
DESIGNED BY	K.G.
CHECKED BY	R.H.
DRAWN BY	K.G.
APPROVED BY	S.M.
HOR. SCALE:	1:250
VERT. SCALE:	1:25
RELEASED FOR CONSTRUCTION	



**THE CITY OF WINNIPEG**  
PUBLIC WORKS DEPARTMENT

2017 ALLEY RENEWALS - CONTRACT 2  
LOGAN AVENUE/ALEXANDER AVENUE ALLEY  
FROM MATCHLINE AT 1+60 TO LAURA STREET

CONCRETE PAVEMENT

CITY DRAWING NO. SHEET 2 OF 2  
BID OPPORTUNITY NO. 380-2017

CONSULTANT DRAWING NO. 171-01396-00 -29