

Filename: P:\Projects\2011\11-0107-18\DWG\Mun\C3 - Pond\11-0107-18_POND.dwg - Tab: C301 Plotted By: Gloewen 17/07/12 [Wed 10:47am]

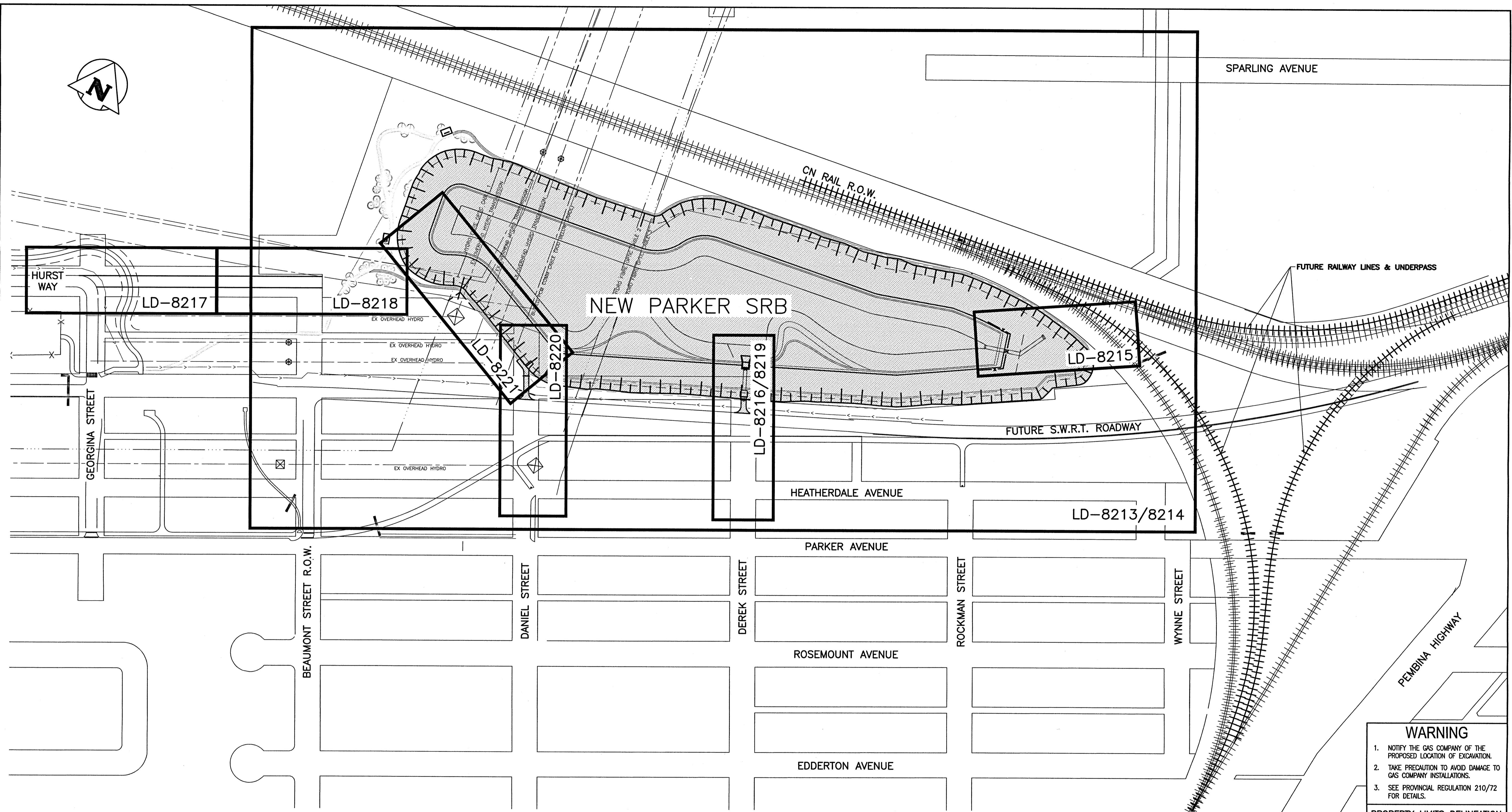

CONSTRUCTION NOTES:

1. LOCATION OF ALL SERVICES SHOWN ON THE DRAWING ARE APPROXIMATE AND TO BE CONFIRMED IN THE FIELD.
2. ALL MATERIALS SHALL CONFORM TO THE CITY OF WINNIPEG STANDARD CONSTRUCTION SPECIFICATIONS.
3. NO STOCKPILING OF MATERIALS AT TOP OF SLOPES.
4. ALL WORK NEAR HYDRO TRANSMISSION TOWERS TO COMPLY WITH HYDRO REQUIREMENTS FOR MINIMUM HORIZONTAL AND VERTICAL CLEARANCES FROM THE TOWER AND TRANSMISSION LINES.

WARNING
 1. NOTIFY THE GAS COMPANY OF THE PROPOSED LOCATION OF EXCAVATION.
 2. TAKE PRECAUTION TO AVOID DAMAGE TO GAS COMPANY INSTALLATIONS.
 3. SEE PROVINCIAL REGULATION 210/72 FOR DETAILS.

PROPERTY LIMITS DELINEATION
 DELINEATION OF PROPERTY LIMITS AS SHOWN ON THIS DWG DOES NOT REPRESENT A "LEGAL SURVEY". KGS GROUP MAKES NO REPRESENTATION OR WARRANTY AS TO THE ACCURACY OF PROPERTY LIMITS DELINEATED ON THIS DWG, NOR ON THE DIMENSIONAL ACCURACY OF DWG FEATURES RELATIVE TO THOSE PROPERTY LIMITS.

METRIC
 WHOLE NUMBERS INDICATE MILLIMETRES
 DECIMALIZED NUMBERS INDICATE METRES

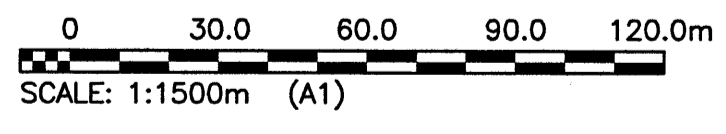

APGM
 Certificate of Authorization
 KGS Group
 No. 245

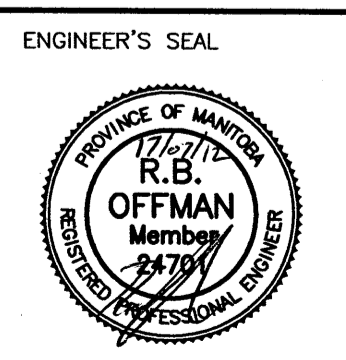

CONSULTANT DRAWING NO.
 11-0107-18_C301

THE CITY OF WINNIPEG
 WATER AND WASTE DEPARTMENT

PROJECT TITLE
COCKBURN/CALROSSIE COMBINED SEWER RELIEF WORKS - CONTRACT 3

STORMWATER RETENTION BASIN
 GENERAL PLAN & DRAWING INDEX

SHEET OF
1 OF 1

COMPUTER FILE NAME
 11-0107-18_POND

CITY DRAWING NUMBER
LD-8212

B.M. KGS BASE ELEV.	ALL DATA PROVIDED IS IN UTM ZONE 14, NAD83, CSRS, CGVD28	KGS GROUP CONSULTING ENGINEERS	DESIGNED BY JMM	CHECKED BY RBO
			DRAWN BY GEL	APPROVED BY RBU
			HOR. SCALE: 1:1500	RELEASED FOR CONSTRUCTION: DATE 7-12-17
0	ISSUED FOR CONSTRUCTION	17/07/12	DATE	16/06/10
NO.	REVISIONS	DATE	BY	DATE