

File Name: P:\Projects\2011\11-0107-18_POND.dwg - Tab: C309 Plotted By: Cloewen 17/07/12 [Wed 2:08pm]

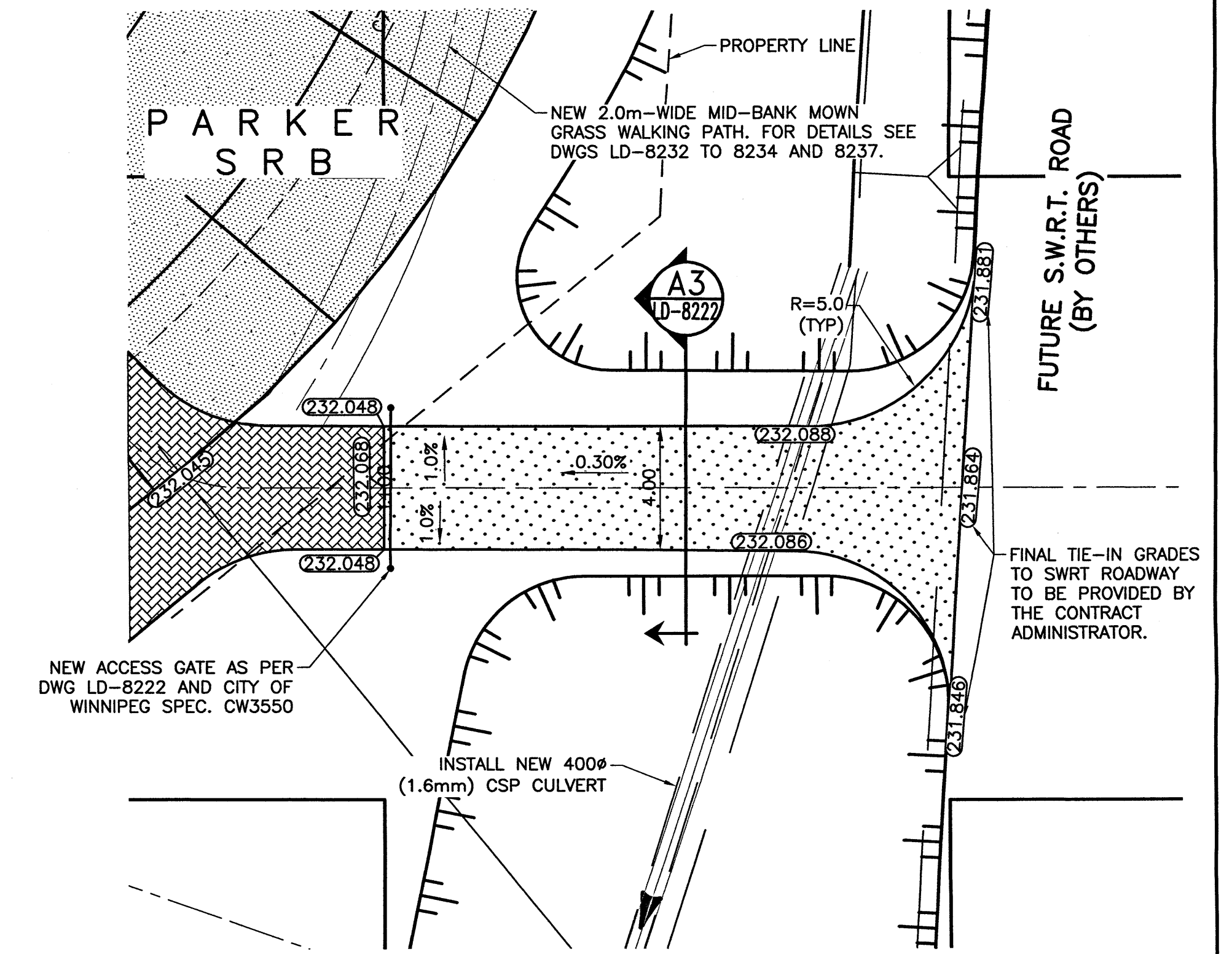
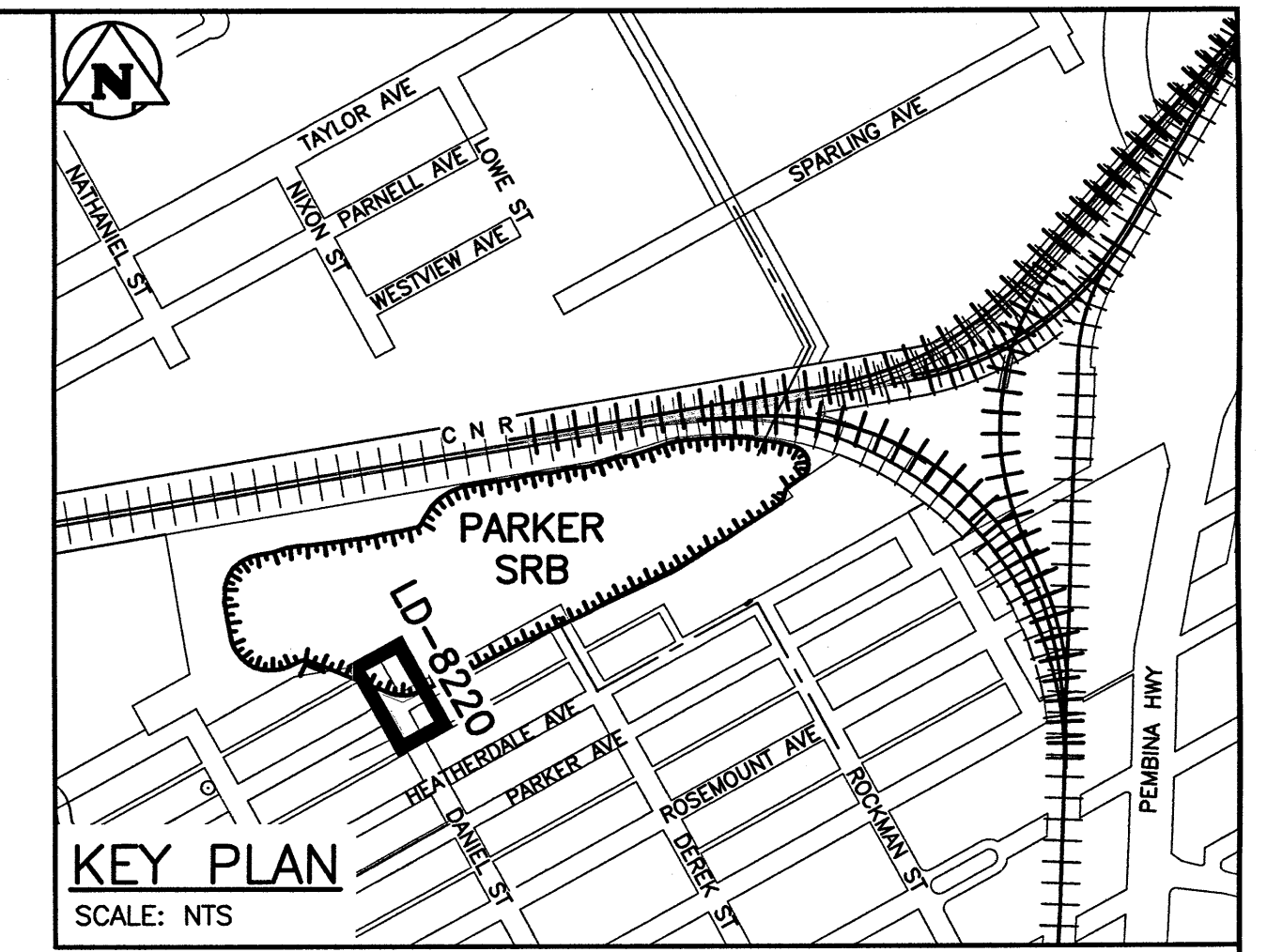
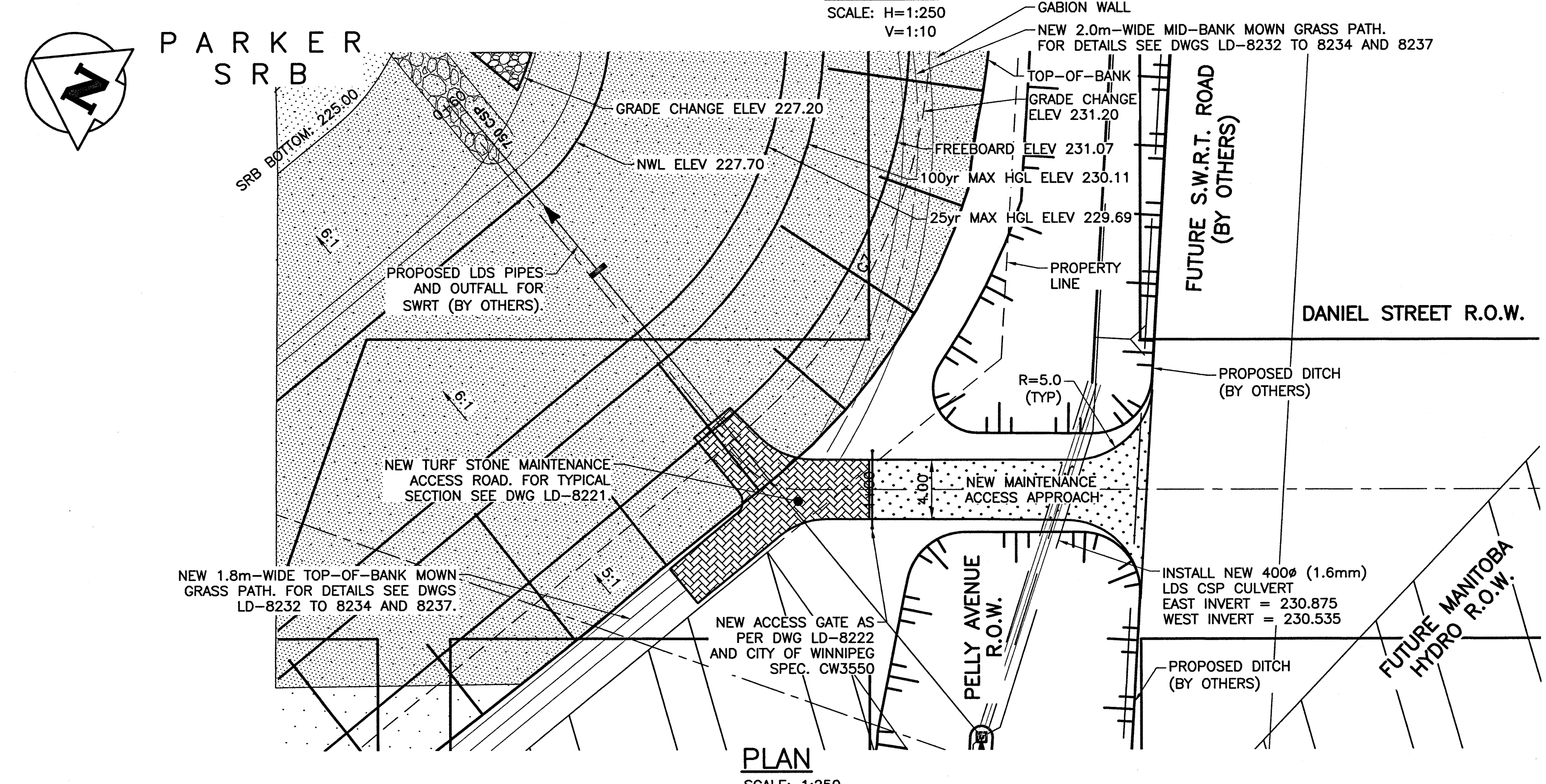
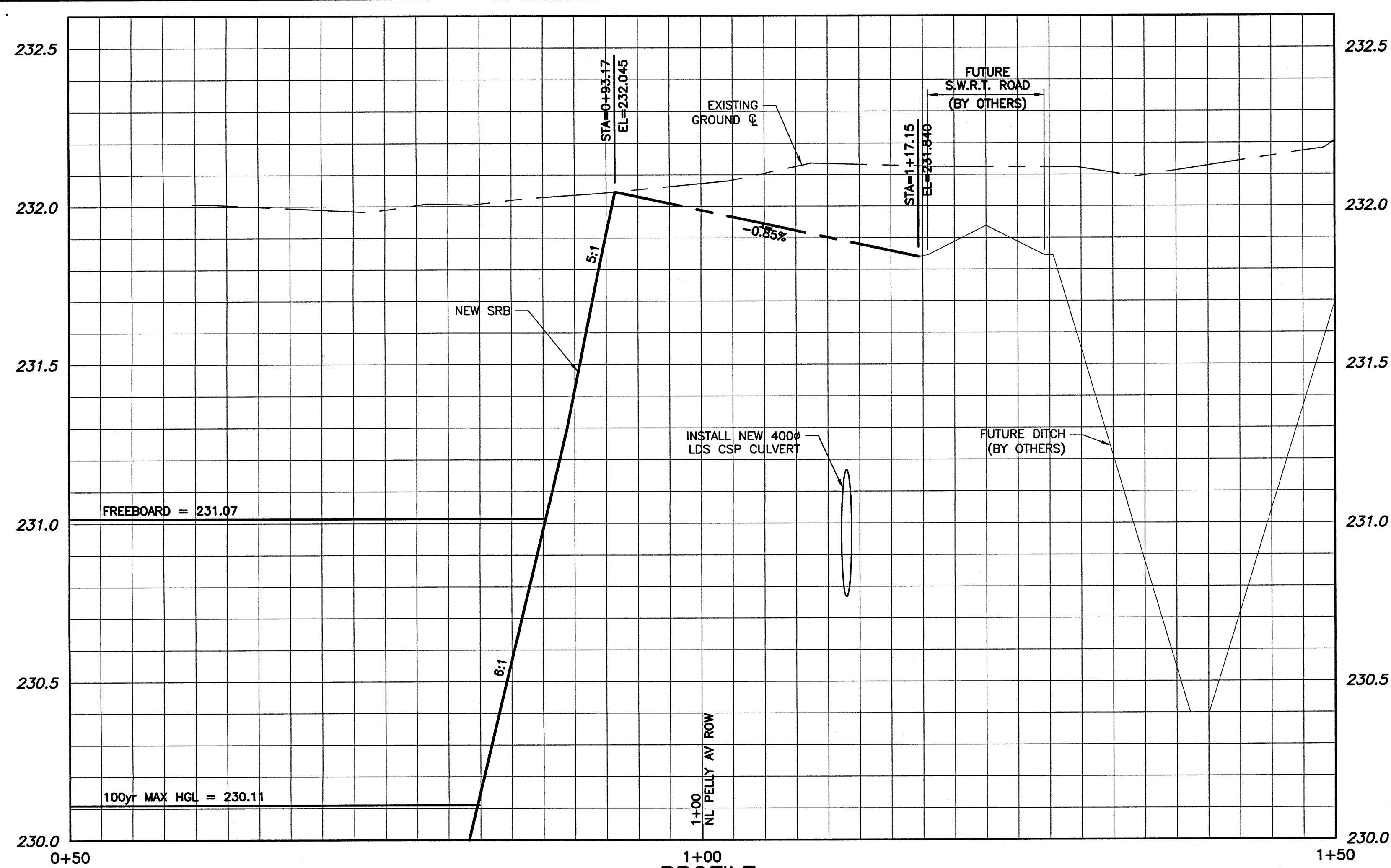

WARNING

- NOTIFY THE GAS COMPANY OF THE PROPOSED LOCATION OF EXCAVATION.
- TAKE PRECAUTION TO AVOID DAMAGE TO GAS COMPANY INSTALLATIONS.
- SEE PROVINCIAL REGULATION 210/72 FOR DETAILS.

PROPERTY LIMITS DELINEATION

DELINEATION OF PROPERTY LIMITS AS SHOWN ON THIS DWG DOES NOT REPRESENT A "LEGAL SURVEY". KGS GROUP MAKES NO REPRESENTATION OR WARRANTY AS TO THE ACCURACY OF PROPERTY LIMITS DELINEATED ON THIS DWG, NOR ON THE DIMENSIONAL ACCURACY OF DWG FEATURES RELATIVE TO THOSE PROPERTY LIMITS.

METRIC

WHOLE NUMBERS INDICATE MILLIMETRES
DECIMALIZED NUMBERS INDICATE METRES

0 3.0 6.0 9.0 12.0m
SCALE: 1:150m (A1)

0 200 400 600 800mm
SCALE: 1:10m (A1)

0 5.0 10.0 15.0 20.0m
SCALE: 1:250m (A1)

150 WM	WATER MAIN	150 WM	HYDRANT	150 WM	WATER MAIN	150 WM	HYDRANT, VALVE
300 LBS	LAND DRAINAGE SEWER	300 LBS	VALVE	300 LBS	LAND DRAINAGE SEWER	300 LBS	MANHOLE
250 WWS	WASTE WATER SEWER	250 WWS	MANHOLE	250 WWS	WASTE WATER SEWER	250 WWS	CATCH BASIN
	HYDRO		CATCH BASIN		CENTRELINE		CURB INLET
	M.T.S.		CURB INLET		NORTH/WEST GUTTER		RAILWAY TRACKS
	GAS		RAILWAY TRACKS		SOUTH/EAST GUTTER		DITCH
	CONCRETE		DITCH		N/W, S/E R'S		FENCE
	ASPHALT		FENCE				HYDRO POLE
	SIDEWALK		HYDRO POLE				HYDRO TOWER
	TURF STONE		HYDRO TOWER				TEST HOLE
	PROPERTY LINE		TEST HOLE				
EXISTING	LEGEND-PLAN	PROPOSED	EXISTING	LEGEND-PLAN	PROPOSED	EXISTING	LEGEND-PROFILE

LOCATION APPROVED UNDERGROUND STRUCTURES

SUPV. U/G STRUCTURES COMMITTEE DATE

NOTE:
LOCATION OF UNDERGROUND STRUCTURES AS SHOWN ARE BASED ON THE BEST INFORMATION AVAILABLE BUT NO GUARANTEE IS GIVEN THAT THE GIVEN LOCATIONS ARE EXACT. CONFIRMATION OF EXISTENCE AND EXACT LOCATION OF ALL SERVICES MUST BE OBTAINED FROM THE INDIVIDUAL UTILITIES BEFORE PROCEEDING WITH CONSTRUCTION.

B.M. KGS BASE ELEV.	ALL DATA PROVIDED IS IN UTM ZONE 14, NAD83, CSRS, CGVD28
0	ISSUED FOR CONSTRUCTION 17/07/12 RBO
No. REVISIONS	DATE BY

KGS GROUP CONSULTING ENGINEERS

DESIGNED BY JMM CHECKED BY RBO

DRAWN BY GEL APPROVED BY RBO

HOR. SCALE: 1:250
VERTICAL: 1:10

RELEASED FOR CONSTRUCTION: 16/06/10

DATE: 17-07-12

ENGINEER'S SEAL

PROVINCE OF MANITOBA
REGISTERED PROFESSIONAL ENGINEER
R.E. OFFMAN
Member 29701

THE CITY OF WINNIPEG WATER AND WASTE DEPARTMENT

PROJECT TITLE: COCKBURN/CALROSSIE COMBINED SEWER RELIEF WORKS - CONTRACT 3

STORMWATER RETENTION BASIN PERMANENT SITE ACCESS - PLAN/PROFILE DANIEL STREET

SHEET OF 1 OF 1

COMPUTER FILE NAME: 11-0107-18_POND

CITY DRAWING NUMBER: LD-8220

CONSULTANT DRAWING NO.: 11-0107-18_C309