

1 TELECOM CLOSET LAYOUT
 SCALE: 1:20mm (24"x36")

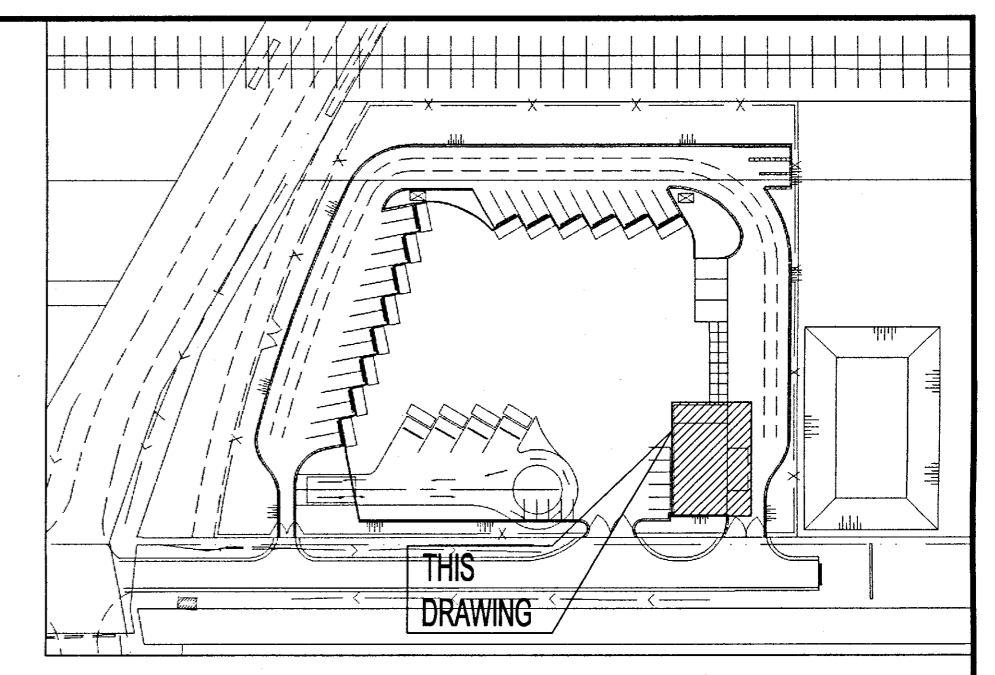

KEY PLAN
 SCALE: N.T.S.

- KEYNOTES:**
- 1 MOUNT THE EXTERIOR SECURITY STROBE 600mm ABOVE THE ROOF LINE ON A GALVANIZED RIGID STEEL CONDUIT.
 - 2 MOUNT THE EXTERIOR WALL MOUNTED VIDEO CAMERAS AT ELEVATION 103.7m.
 - 3 MOUNT THE INFRARED ILLUMINATORS FOR THE BUILDING MOUNTED VIDEO CAMERAS ON THE CAMERAS HOUSING. PROVIDE 120VAC - 24VAC POWER SUPPLIES AS REQUIRED AND POWER THE POWER SUPPLY FROM CIRCUIT B-73.

- GENERAL NOTES:**
1. ALL INTRUSION DEVICE WIRING SHALL BE CONCEALED AND INSTALLED IN CONDUIT BACK TO THE INTRUSION ALARM CONTROL PANEL IN GARAGE.
 2. ALL CCTV CAMERA DEVICE WIRING SHALL BE CONCEALED AND INSTALLED IN CONDUIT BACK TO THE TELECOM CLOSET.

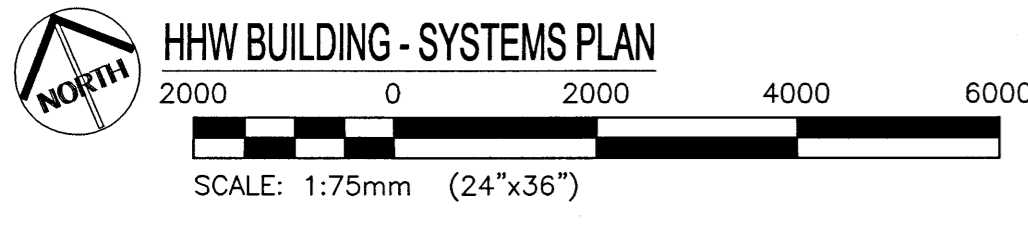

LOCATION APPROVED UNDERGROUND STRUCTURES

SUPV. U/G STRUCTURES COMMITTEE DATE

NOTE:
 LOCATION OF UNDERGROUND STRUCTURES AS SHOWN ARE BASED ON THE BEST INFORMATION AVAILABLE BUT NO GUARANTEE IS GIVEN THAT ALL EXISTING UTILITIES ARE SHOWN OR THAT THE GIVEN LOCATIONS ARE EXACT. CONFIRMATION OF EXISTENCE AND EXACT LOCATION OF ALL SERVICES MUST BE OBTAINED FROM THE INDIVIDUAL UTILITIES BEFORE PROCEEDING WITH CONSTRUCTION.

NO.	ISSUED FOR TENDER	DATE	BY
0	ISSUED FOR TENDER	17/03/14	CLS
	REVISIONS	DATE	BY

DESIGNED BY		CHECKED BY	
CLS		CLS	
DRAWN BY		APPROVED BY	
SDC		CLS	
HOR. SCALE:		RELEASED FOR CONSTRUCTION:	
AS NOTED			
VERTICAL:		DATE	
AS NOTED		16/08/17	

ENGINEER'S SEAL

CONSULTANT PROJECT NO.
16-0107-010

THE CITY OF WINNIPEG WATER AND WASTE DEPARTMENT

Winnipeg

PROJECT TITLE
4R WINNIPEG DEPOT
EAST WINNIPEG COMMUNITY RESOURCE RECOVERY CENTRE

HHW BUILDING - SYSTEMS PLAN

SHEET OF
31 OF 41

COMPUTER FILE NAME
16-0107-010

CONSULTANT DRAWING NUMBER
E06