

NOTE: CHAINAGES SHOWN ARE ALONG S. R. OF ST MATTHEWS AVE

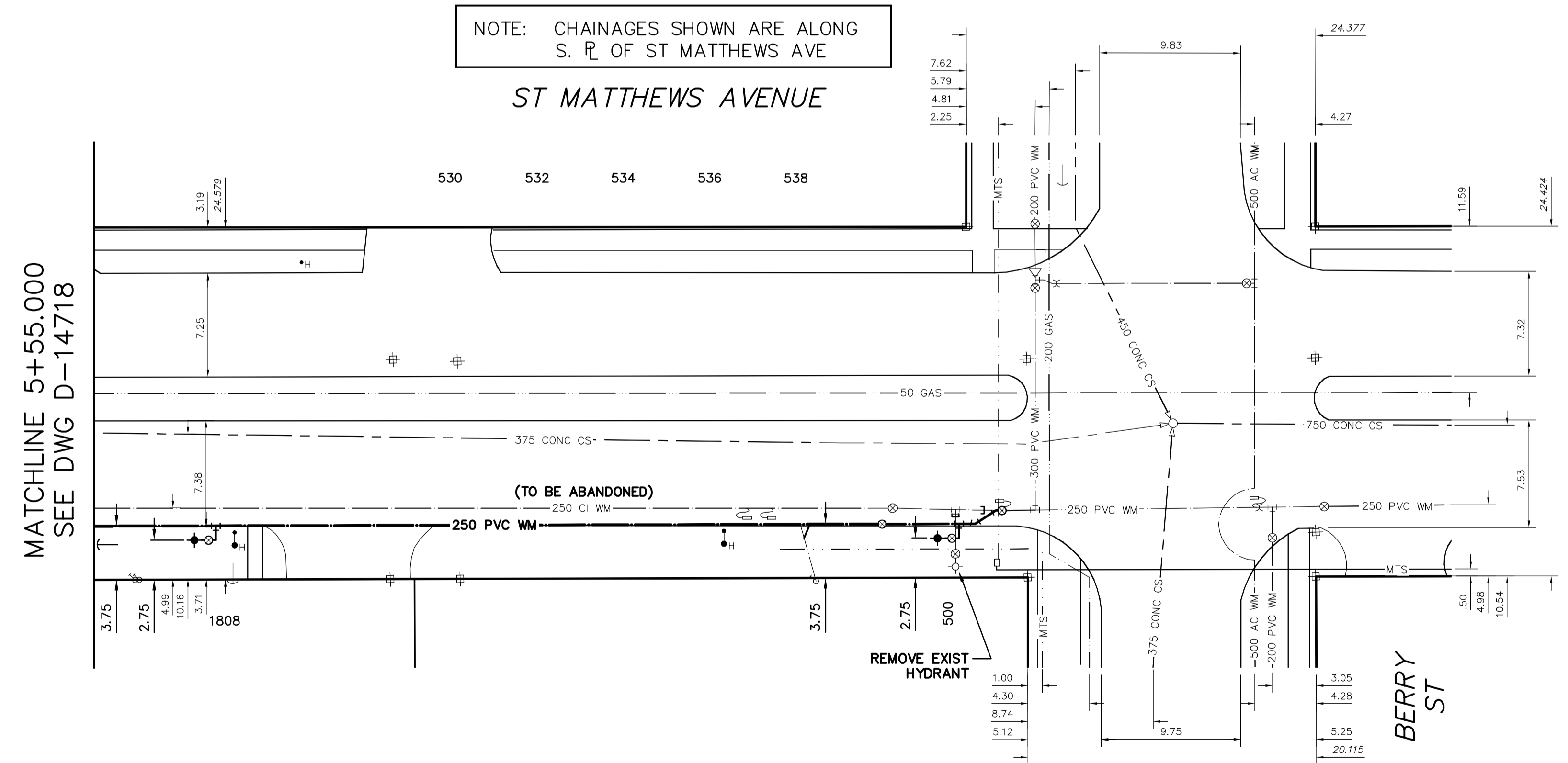

WATER SERVICE INFORMATION

ADDRESS	SIZE (mm) MATERIAL (STREET)	SIZE (mm) MATERIAL (PROP.)	SHORT & LONG MEASUREMENT	CORP. LOCATION	REMARKS
534 FERRY RD	20	12	2.07 NSL HSE	1.8 S OF S/C	OUTSIDE SET LIMITS
RESIDENTIAL	CU	CU	9.147 SSL ST MATTHEWS AVE	-	-
535 FERRY RD	12	12	1.90 SSL HSE	0.3 S OF S/C	OUTSIDE SET LIMITS
RESIDENTIAL	CU	CU	11.285 SSL ST MATTHEWS AVE	-	-
541 FERRY RD	38	20	16.33 EWL BLDG	-	RECONNECT SERVICE
COMMERCIAL	CU	CU	17.689 EEL FERRY RD	-	-
532 COLLEGIATE ST	20	20	1.18 NSL HSE	0.9 N OF S/C	OUTSIDE SET LIMITS
RESIDENTIAL	CU	CU	7.628 SSL ST MATTHEWS AVE	-	-
533 COLLEGIATE ST	20	20	1.35 NSL HSE	1.3 S OF S/C	OUTSIDE SET LIMITS
RESIDENTIAL	CU	CU	6.355 SSL ST MATTHEWS AVE	-	-
530 ROSEBERRY ST	20	-	2.69 NSL HSE	0.5 S OF S/C	OUTSIDE SET LIMITS
RESIDENTIAL	CU	-	4.219 SSL ST MATTHEWS AVE	-	-
531 ROSEBERRY ST	-	-	0.19 NSL HSE	0.3 N OF S/C	OUTSIDE SET LIMITS
RESIDENTIAL	-	-	3.269 SSL ST MATTHEWS AVE	-	-
526 PARKVIEW ST	20	20	5.24 NSL HSE	1.8 N OF S/C	OUTSIDE SET LIMITS
RESIDENTIAL	CU	CU	6.399 SSL ST MATTHEWS AVE	-	-
523 PARKVIEW ST	20	20	3.04 NSL HSE	1.0 N OF S/C	OUTSIDE SET LIMITS
RESIDENTIAL	CU	CU	4.709 SSL ST MATTHEWS AVE	-	-
511 MARJORIE ST	20	-	1.34 NSL HSE	0.7 N OF S/C	OUTSIDE SET LIMITS
RESIDENTIAL	CU	-	4.486 SSL ST MATTHEWS AVE	-	-
516 MARJORIE ST	20	-	1.61 NSL HSE	0.5 S OF S/C	OUTSIDE SET LIMITS
RESIDENTIAL	CU	-	3.010 SSL ST MATTHEWS AVE	-	-
540 MARJORIE ST	150	150	19.84 EWL BLDG	-	RECONNECT SERVICE
SPRINKLER	-	-	56.671 WWL MARJORIE ST	OPP VLV	-
510 HAMPTON ST	-	-	1.68 NSL HSE	2.0 N OF S/C	OUTSIDE SET LIMITS
RESIDENTIAL	-	-	8.515 SSL ST MATTHEWS AVE	-	-
500 BERRY ST	38	-	8.84 WEL BLDG	1.1 W OF S/C	RECONNECT SERVICE
COMMERCIAL	CU	-	14.797 WWL BERRY ST	-	-
1808 ST MATTHEWS AVE	-	-	10.28 WEL BLDG	-	RECONNECT SERVICE
COMMERCIAL	-	-	23.612 EEL HAMPTON ST	-	-
1810 ST MATTHEWS AVE	-	-	14.27 EWL BLDG	-	RECONNECT SERVICE
COMMERCIAL	-	-	23.307 EEL HAMPTON ST	-	-
1811 ST MATTHEWS AVE	-	-	-	-	RECONNECT SERVICE
COMMERCIAL	-	-	-	-	-
1841 ST MATTHEWS AVE	-	-	-	-	RECONNECT SERVICE
COMMERCIAL	-	-	-	-	-
1845 ST MATTHEWS AVE	-	-	-	-	RECONNECT SERVICE
COMMERCIAL	-	-	-	-	-
1899 ST MATTHEWS AVE	-	25	6.65 NSL BLDG	-	OUTSIDE SET LIMITS
COMMERCIAL	CU	CU	21.011 NNW ST MATTHEWS ST	-	-

* SERVICES TO BE RENEWED TO R. ALL OTHERS TO BE RECONNECTED

NOTE: ALL VALVES TO BE INSTALLED COUNTERCLOCKWISE TO CLOSE

FOR INDEX SEE D-14707

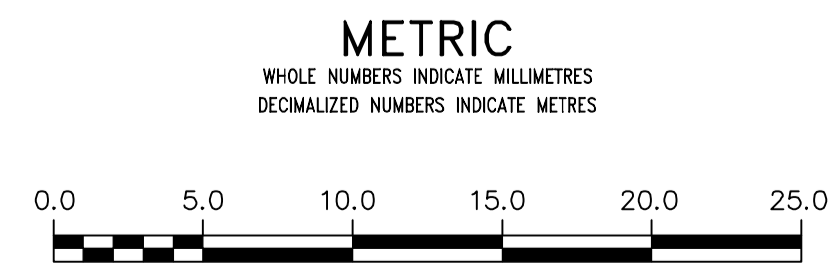

WARNING
IF POWER EQUIPMENT OR EXPLOSIVES ARE TO BE USED FOR EXCAVATION ON THIS PROJECT THE CONTRACTOR MUST:
1) NOTIFY THE GAS COMPANY OF THE PROPOSED LOCATION OF EXCAVATION.
2) TAKE PRECAUTION TO AVOID DAMAGE TO GAS COMPANY INSTALLATIONS.
SEE PROVINCIAL REGULATION 210/72 FOR DETAILS

LOCATION APPROVED UNDERGROUND STRUCTURES
SUPV. U/G STRUCTURES COMMITTEE DATE
NOTE: LOCATION OF UNDERGROUND STRUCTURES AS SHOWN ARE BASED ON THE BEST INFORMATION AVAILABLE BUT NO GUARANTEE IS GIVEN THAT ALL EXISTING UTILITIES ARE SHOWN OR THAT THE GIVEN LOCATIONS ARE EXACT. CONFIRMATION OF EXISTENCE AND EXACT LOCATION OF ALL SERVICES MUST BE OBTAINED FROM THE INDIVIDUAL UTILITIES BEFORE PROCEEDING WITH CONSTRUCTION.

NO.	REVISIONS	DATE	BY

DESIGNED BY	JC	CHECKED BY	SC
DRAWN BY	RJ	APPROVED BY	KZ
SCALE:		RELEASED FOR CONSTRUCTION	
HORIZONTAL	1:250		
VERTICAL	1:50		
DATE	2017 05 10	DATE	2017 05 09
PLOT DATE:	2017 05 10		

ENGINEER'S SEAL
ORIGINAL SIGNED BY S.J.R. COUNROYER 17/05/10
CONSULTANT DRAWING NUMBER

THE CITY OF WINNIPEG
WATER AND WASTE DEPARTMENT
ENGINEERING DIVISION

2017 WATER MAIN RENEWALS
CONTRACT 3
ST MATTHEWS AVENUE
20 E OF HAMPTON STREET TO BERRY STREET

SHEET 14 OF 16
CITY DRAWING NUMBER
D-14719