

NOTE: CHAINAGES SHOWN ARE ALONG E P L OF LISTOWEL BAY

FOR CONTINUATION SEE DWG D-14749

LISTOWEL BAY (EAST LEG)

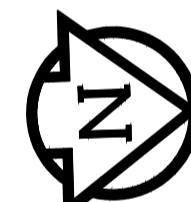
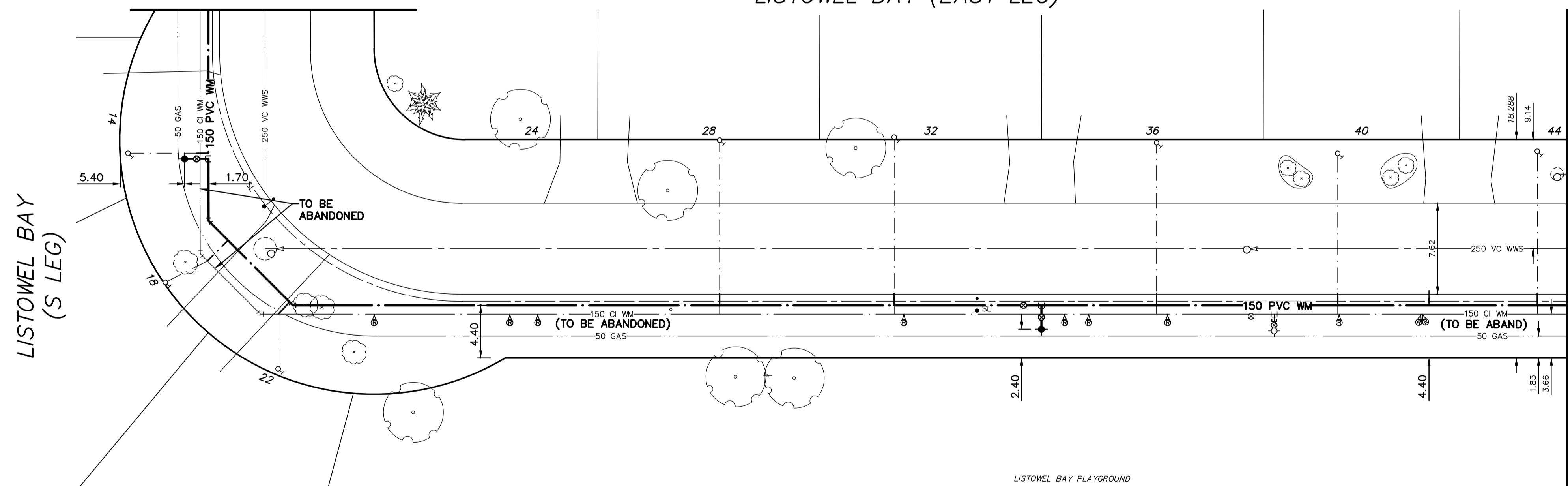

WATER SERVICE INFORMATION

ADDRESS	SIZE (mm) MATERIAL (STREET)	SIZE (mm) MATERIAL (PROP.)	SHORT & LONG MEASUREMENT	CORP. LOCATION	REMARKS
24 LISTOWEL BY	-	20	5.18 EWHL	-	RECONNECT SERVICE
RESIDENTIAL	-	CU	-	-	RECONNECT SERVICE
28 LISTOWEL BY	-	20	6.22 NSHL	-	RECONNECT SERVICE
RESIDENTIAL	-	CU	-	-	RECONNECT SERVICE
32 LISTOWEL BY	-	20	7.98 NSHL	-	RECONNECT SERVICE
RESIDENTIAL	-	CU	-	-	RECONNECT SERVICE
36 LISTOWEL BY	-	20	6.80 NSHL	-	RECONNECT SERVICE
RESIDENTIAL	-	CU	-	-	RECONNECT SERVICE
40 LISTOWEL BY	-	20	5.98 NSHL	-	RECONNECT SERVICE
RESIDENTIAL	-	CU	-	-	RECONNECT SERVICE
44 LISTOWEL BY	-	20	5.97 NSHL	-	RECONNECT SERVICE
RESIDENTIAL	-	CU	-	-	RECONNECT SERVICE

\* SERVICES TO BE RENEWED TO R. ALL OTHERS TO BE RECONNECTED



FOR INDEX SEE D-14739

NOTE: ALL VALVES TO BE INSTALLED COUNTER-CLOCKWISE TO CLOSE

METRIC  
WHOLE NUMBERS INDICATE MILLIMETRES  
DECIMALIZED NUMBERS INDICATE METRES



WARNING

IF POWER EQUIPMENT OR EXPLOSIVES ARE TO BE USED FOR EXCAVATION ON THIS PROJECT THE CONTRACTOR MUST:

- 1) NOTIFY THE GAS COMPANY OF THE PROPOSED LOCATION OF EXCAVATION.
- 2) TAKE PRECAUTION TO AVOID DAMAGE TO GAS COMPANY INSTALLATIONS.

SEE PROVINCIAL REGULATION 2107/2 FOR DETAILS

LOCATION APPROVED UNDERGROUND STRUCTURES

SUPV. U/G STRUCTURES COMMITTEE DATE

NOTE:

LOCATION OF UNDERGROUND STRUCTURES AS SHOWN ARE BASED ON THE BEST INFORMATION AVAILABLE BUT NO GUARANTEE IS GIVEN THAT ALL EXISTING UTILITIES ARE SHOWN OR THAT THE GIVEN LOCATIONS ARE EXACT. CONFIRMATION OF EXISTENCE AND EXACT LOCATION OF ALL UTILITIES MUST BE OBTAINED FROM THE INDIVIDUAL UTILITIES BEFORE PROCEEDING WITH CONSTRUCTION.

B.M. 39-032 ELEV. 238.871 S.W. Cor. Moray St. & Silver Ave., Tbit. in N. Conc. foundation No. 65 Moray Village, 3 m W. & 0.1 m below brick of N.E. Cor. of apartment unit.

NO. REVISIONS DATE BY



DESIGNED BY	JKH	CHECKED BY	HAK
DRAWN BY	DML	APPROVED BY	BWB
SCALE:		RELEASED FOR CONSTRUCTION	KAS ZUREK
HORIZONTAL	1:250		
VERTICAL	1:50		
DATE	2017 05 11	DATE	2017 05 17

ENGINEER'S SEAL

ORIGINAL SIGNED BY H.A. KATZ 2017 05 17

CONSULTANT DRAWING NUMBER



2017 WATER MAIN RENEWALS CONTRACT 9 LISTOWEL BAY (EAST LEG) 91 m S OF BRAINTREE CRESCENT (NORTH LEG)

SHEET 13 OF 21 CITY DRAWING NUMBER D-14750

BID OPPORTUNITY: 415-2017 CONTRACT NUMBER: 9

FILE PATH: M:\Proj\W170016\4 Design\1 Drawings\06 Sheets FILE NAME: W170016-LISTOWEL-02.dwg

PLOT DATE: 2017/5/16 5:11:57 PM