

**MAIN FLOOR PLAN - NAT.GAS PIPING**  
SCALE: 1:100

**DRAWING NOTES**

- 1 PROPOSED LOCATION OF NATURAL GAS METER/PRV ASSEMBLY AT BUILDING EXTERIOR. PROVIDE PROTECTIVE BOLLARDS AT BUILDING EXTERIOR PER CSA B149.1; COORDINATE WITH GENERAL CONTRACTOR AS REQUIRED. ROUTE GAS PIPING INTO WASHBAY AND EXTEND UP TO HIGH LEVEL, OFFSET TO GAS FIRED APPLIANCES. TOTAL CONNECTED LOAD APPROXIMATELY 472MBHI.
- 2 GAS FIRED UNIT HEATERS SUSPENDED FROM STRUCTURE AT HIGH LEVEL; EXTEND NAT.GAS PIPING TO UNIT CONNECTIONS.
- 3 EXTEND NAT.GAS PIPING DOWN FROM HIGH LEVEL IN SHOP 111 AND OFFSET THRU TO CEILING SPACE OF ADJACENT CORRIDOR.
- 4 EXTEND NAT.GAS PIPING FROM HIGH LEVEL IN SHOP 111 THRU EXTERIOR WALL (MINIMUM 2'-0" ABOVE ROOF LEVEL), OFFSET DOWN AND ACROSS ROOF TO ROOF MOUNT APPLIANCE. PROVIDE FLASHING AND SEAL WALL PENETRATION WEATHERTIGHT; COORDINATE WITH GENERAL CONTRACTOR AS REQUIRED.
- 5 GAS FIRED HWT-1 IN MECH 108; EXTEND NAT.GAS PIPING TO APPLIANCE CONNECTION.
- 6 GAS FIRED RTU-1 ON ROOF; EXTEND NAT.GAS PIPING ACROSS ROOF TO APPLIANCE CONNECTION. PIPING ON ROOF TO BE SUPPORTED AS PER SPECIFICATIONS.

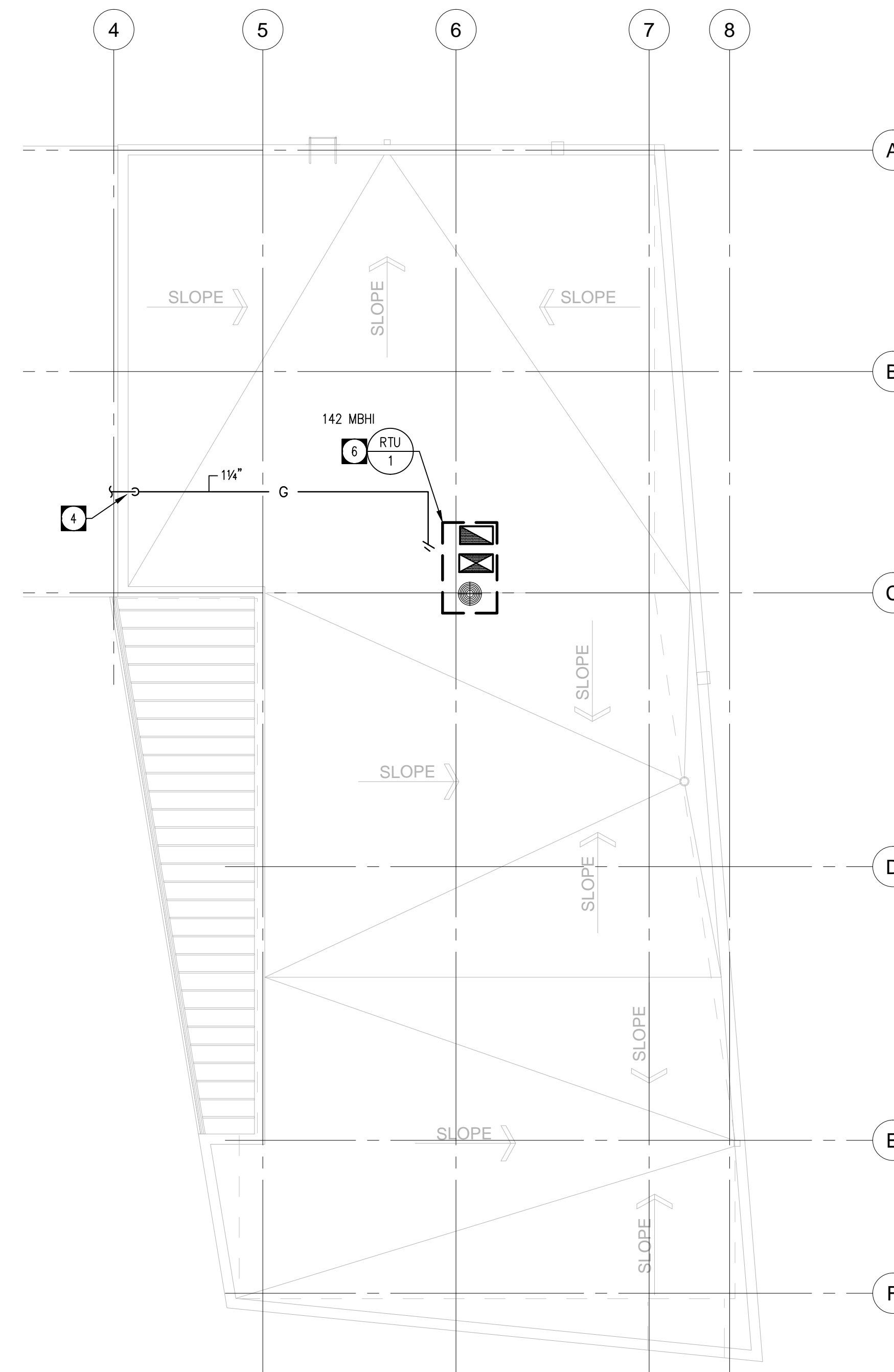

**PARTIAL ROOF PLAN - MECHANICAL**  
SCALE: 1:100

No.	DATE	REVISION / ISSUANCE
4	YY.MM.DD	-
3	YY.MM.DD	-
2	YY.MM.DD	-
1	2017-08-22	ADDENDUM NO.1
0	2017-07-06	ISSUED FOR CONSTRUCTION

Architect

**x | architecture inc.**  
100 Fort Street, Suite 101 Winnipeg, Manitoba R3C 1C7 204.318.2810

Engineer

**NOVA 3 ENGINEERING LTD.**  
CONSULTING ENGINEERS  
201-120 FORT STREET TEL: (204) 943-6142  
WINNIPEG, MANITOBA R3C 1C7 FAX: (204) 942-1276  
WWW.NOVA3.CA JN: 36-087

THIS DRAWING IS THE EXCLUSIVE PROPERTY OF NOVA 3 ENGINEERING LTD. AND MAY ONLY BE REPRODUCED WITH THE WRITTEN PERMISSION OF NOVA 3 ENGINEERING LTD.

THE CONCEPT AND DESIGN INCORPORATED INTO THIS DRAWING ARE BASED ON INFORMATION PROVIDED BY THE CLIENT AND OTHER RELATED SOURCES. PROFESSIONAL ENGINEER ACCEPTS NO RESPONSIBILITY FOR DRAWING AND DESIGN UNLESS DRAWING IS ACCOMPANIED BY ORIGINAL SEALED LETTER OF INTENT OR EQUIVALENT ACCEPTABLE FACSIMILE. PROFESSIONAL ENGINEER ACCEPTS NO RESPONSIBILITY FOR FINAL INSTALLATION CONFORMANCE WITHOUT ORIGINAL SEALED CERTIFICATE OF INSPECTION OR EQUIVALENT ACCEPTABLE FACSIMILE.

Project

**BID OPPORTUNITY 450-2017**  
**KILDONAN PARK**  
**MAINTENANCE BUILDING**

Sheet Title

**NATURAL GAS PIPING**

Project No.

1559

Date

JULY 6, 2017

Sheet

**M3.1**