

WESTBOUND

EASTBOUND

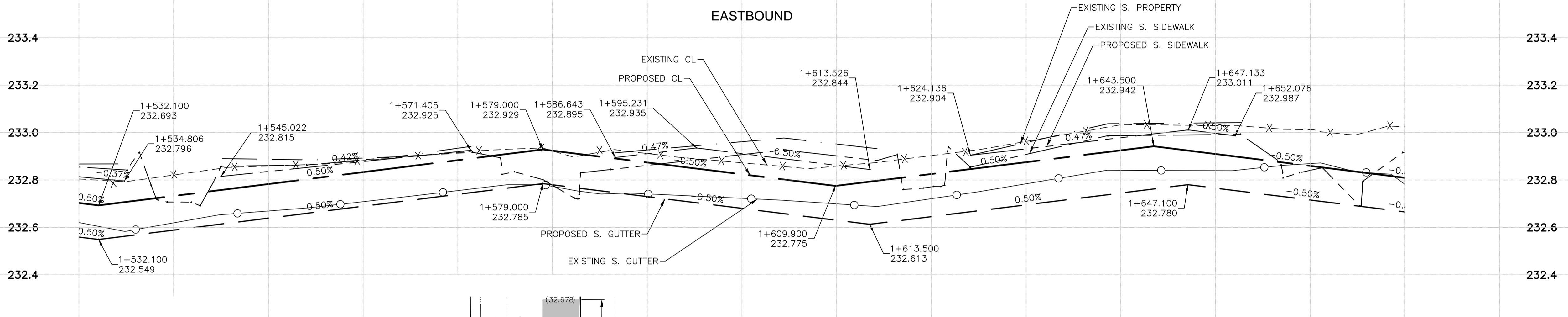
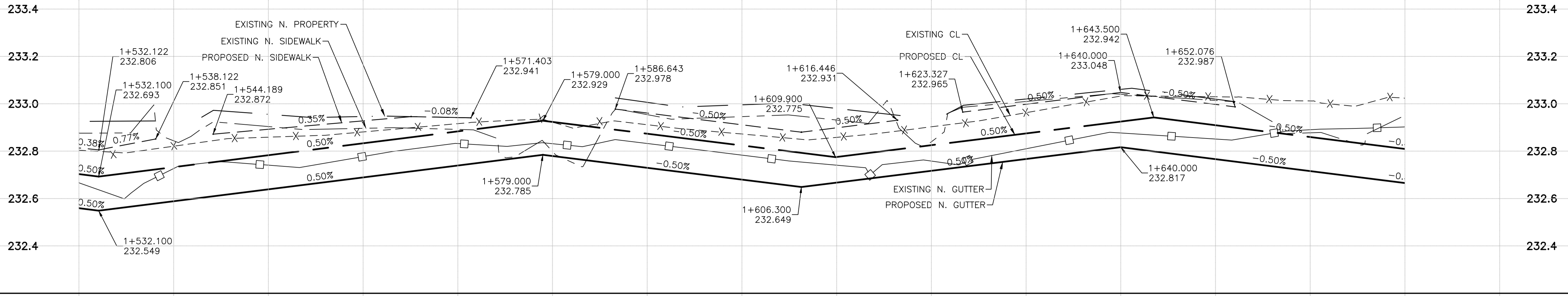

- CONSTRUCTION NOTES: (RECONSTRUCTION)**
- ADJUST ALL ROADWAY APPURTENANCE TO MATCH FINAL GRADES.
 - ADJUST MANHOLE AND CATCHBASIN WITHIN THE ROADWAY 50mm BELOW FINAL GRADE TO ACCOMMODATE A RISER RING.
 - COMPLETE DRAINAGE INLET WORKS AS NOTED.
 - ALL RADII CURB TO BE MODIFIED BARRIER CURB AND RAMP CURB (TYP.).
 - BACK LANE & SIDE STREET APPROACH PAVEMENT SECTION:
 - 150 REINFORCED CONCRETE PAVEMENT
 - 75 - 20mm CRUSHED BASE COURSE
 - 300 - 50mm CRUSHED SUBBASE
 - SUBGRADE COMPACTION
 - WORKS IN CLOSE PROXIMITY TO THE 400 WM AER TO COMPLY WITH THE CONTRACT SPECIFICATIONS

- GENERAL NOTES:**
- MAINTAIN TRAFFIC AS OUTLINED IN THE TRAFFIC MANAGEMENT SPECIFICATION AND TRAFFIC CONTROL/CONSTRUCTION STAGING DRAWINGS. PROVIDE 1 WEEK NOTICE FOR STREET LIGHT RELOCATES AND EXCAVATION WORK WITHIN 1.5m OF EXISTING HYDRO POLES. COORDINATED WITH MANITOBA HYDRO.



METRIC
WHOLE NUMBERS INDICATE MILLIMETRES
DECIMALIZED NUMBERS INDICATE METRES

WARNING
IF POWER EQUIPMENT OR EXPLOSIVES ARE TO BE USED FOR EXCAVATION ON THIS PROJECT THE CONTRACTOR MUST:

- NOTIFY THE GAS COMPANY OF THE PROPOSED LOCATION OF EXCAVATION.
- TAKE PRECAUTION TO AVOID DAMAGE TO GAS COMPANY INSTALLATIONS SEE PROVINCIAL REGULATION 210/72 FOR DETAILS.
- OBTAIN EXCAVATION PERMITS PRIOR TO CONSTRUCTION.

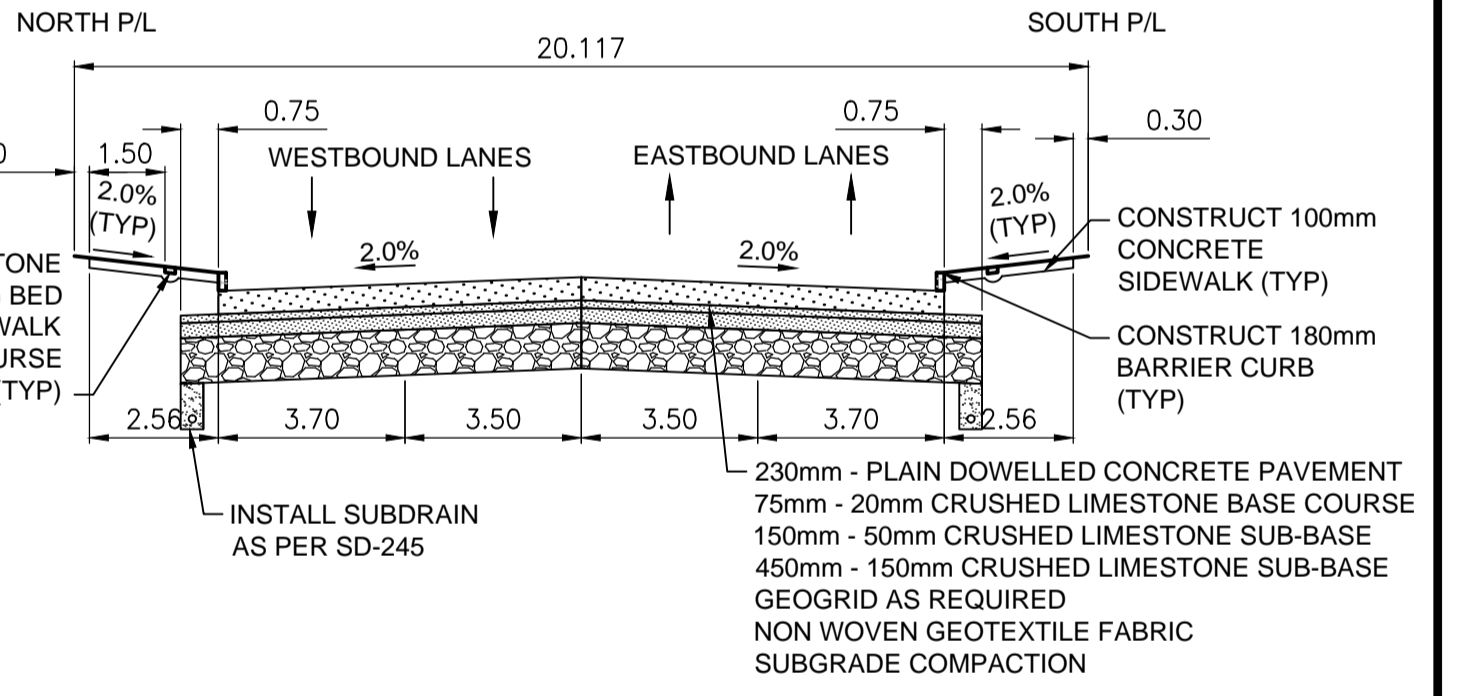
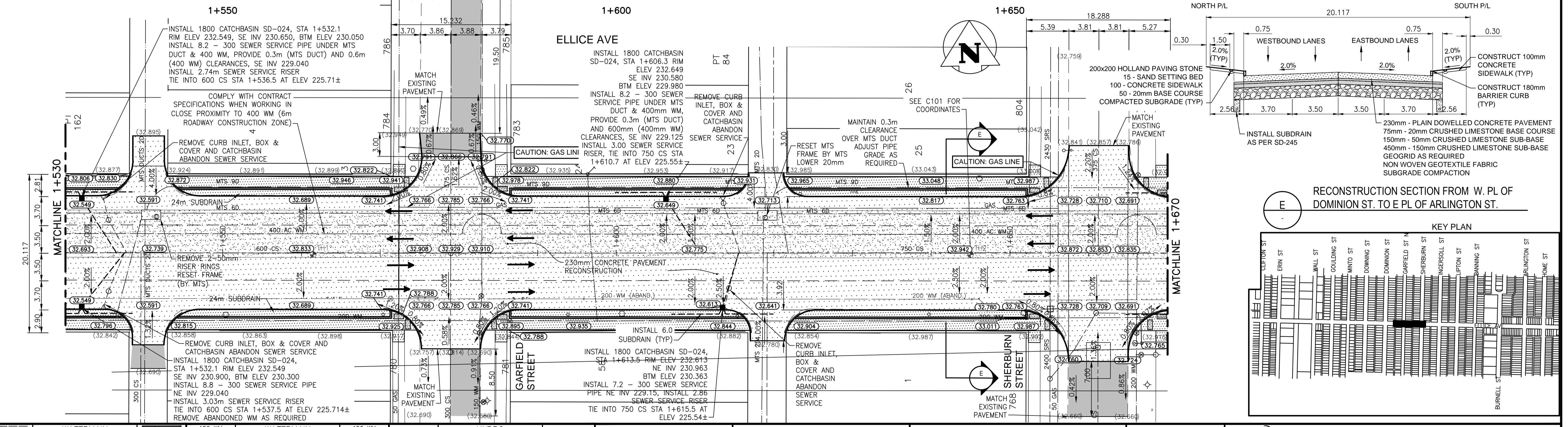

150 WM	WATERMAIN	150 WM	WATERMAIN	150 WM	HYDRO
±	HYDRANT, VALVE	±	HYDRANT VALVE	±	M.T.S.
300 LDS	LAND DRAINAGE SEWER	300 LDS	LAND DRAINAGE SEWER	300 LDS	CONCRETE
250 WWS	WASTE WATER SEWER	250 WWS	WASTE WATER SEWER	250 WWS	MILL AND OVERLAY
X	PROFILE	X	PROFILE	X	CONCRETE SIDEWALK
○	NORTH OR WEST GUTTER	○	MANHOLE	○	HYDRO POLE
○	SOUTH OR EAST GUTTER	○	CATCH BASIN	○	SIGN
○	NORTH OR WEST R	○	CURB INLET/CATCH PIT	○	PROPERTY LINE
○	SOUTH OR EAST R	○	TRAFFIC SIGNAL	○	CORE HOLE
△	NORTH OR WEST DITCH	△	GAS	△	ELEVATION (32.515)
▽	SOUTH OR EAST DITCH	▽	GAS	▽	SIDEWALK DETECTABLE
EXISTING	LEGEND-PROFILE	PROPOSED	LEGEND-PLAN	PROPOSED	LEGEND-PLAN

LOCATION APPROVED UNDERGROUND STRUCTURES

SUPV. U/G STRUCTURES COMMITTEE

NOTE:
LOCATION OF UNDERGROUND STRUCTURES AS SHOWN ARE BASED ON THE BEST INFORMATION AVAILABLE BUT NO GUARANTEE IS GIVEN THAT ALL EXISTING UTILITIES ARE SHOWN OR THAT THE GIVEN LOCATIONS ARE EXACT. CONFIRMATION OF EXISTENCE AND EXACT LOCATION OF ALL SERVICES MUST BE OBTAINED FROM THE INDIVIDUAL UTILITIES BEFORE PROCEEDING WITH CONSTRUCTION.

B.M. ELEV.	
1	ISSUED FOR TENDER 17.06.12
0	ISSUED FOR REVIEW 17.05.30
NO. REVISIONS	DATE BY

Stantec
500 - 311 Portage Avenue, Winnipeg MB
www.stantec.com

DESIGNED BY: D.L. CHECKED BY: D.M.
DRAWN BY: G.P. APPROVED BY: S.B.C.

HOR. SCALE: 1:250
VERTICAL: 1:10

RELEASSED FOR CONSTRUCTION: 2017.04.13

PRELIMINARY DRAWING

NOT TO BE USED FOR CONSTRUCTION

CONSULTANT DRAWING NO. C205

THE CITY OF WINNIPEG
PUBLIC WORKS DEPARTMENT
ENGINEERING DIVISION

2017 REGIONAL STREET RENEWAL PROGRAM
ELLICE AVENUE
ERIN STREET TO ARLINGTON STREET
RECONSTRUCTION

SHEET 12 OF 20
CAD FILE DRAWING NUMBER 07271c-201-xxx.dwg
CITY DRAWING NUMBER P-3485-12