

NOTES:

- STATION IN CENTRE OF ST MATTHEWS RIGHT-OF-WAY UNLESS OTHERWISE NOTED.
- BASELINE IS CENTRELINE OF ST MATTHEWS RIGHT-OF-WAY.
- WEST PROPERTY LINE OF FERRY ROAD IS STA 1+00.0
- ALL MEASUREMENTS TO BACK OF CURB.
- ALL EXISTING TREES TO BE PROTECTED AND MAINTAINED THROUGHOUT CONSTRUCTION.
- ALL BUS STOPS WITHIN LIMITS OF CONSTRUCTION TO BE TEMPORARILY RELOCATED BY OTHERS DURING WORKS.
- HAND OR SOFT DIG METHODS REQUIRED OVER ALL UTILITIES AT INTERVALS DETERMINED BY THE ENGINEER TO DETERMINE DEPTH OF COVER.
- NO WORKS, INCLUDING CONCRETE CUTTING OR BREAKING, TO BE UNDERTAKEN NEAR GAS LINES UNTIL DEPTH OF COVER IS DETERMINED AND A MB HYDRO SAFETY WATCH IS ON SITE.
- ANY GAS MAINS OR SERVICES EXPOSED IN THE EXCAVATION AREA TO BE ROCK WRAPPED IN ACCORDANCE WITH MB HYDRO STANDARDS PRIOR TO WORK PROCEEDING ON SITE.
- NO VIBRATORY COMPACTION PERMITTED WITHIN 1M OF GAS MAINS.
- INSTALL MODIFIED BARRIER CURB AT ALL INTERSECTION RADII, ALLEY RADII, AND BULLNOSES.
- CONSTRUCT NEW MONOLITHIC CURB RAMP (10mm HEIGHT INTEGRAL)
- REPLACE EXISTING SD-24 CATCHBASIN INSTALL BARRIER CURB AND GUTTER INLET FRAME (AP-008) AND AND INLET COVER (AP-008) AND REPLACE 250 LEAD @ 2% MINIMUM GRADE.
- TRANSVERSE JOINTS SPACED AT 5.0 INTERVALS UNLESS OTHERWISE NOTED.
- CONCRETE PATCH LIMITS SHOWN BASED ON VISUAL INSPECTION PRIOR TO MILLING. FINAL PATCHING LIMITS AND DIMENSIONS ARE EXPECTED TO VARY FROM THOSE SHOWN.
- RECONSTRUCTION TO REHABILITATION TRANSITION STATION MAY BE ADJUSTED AFTER ASPHALT MILLING TO SUIT UNDERLYING PAVEMENT CONDITIONS.

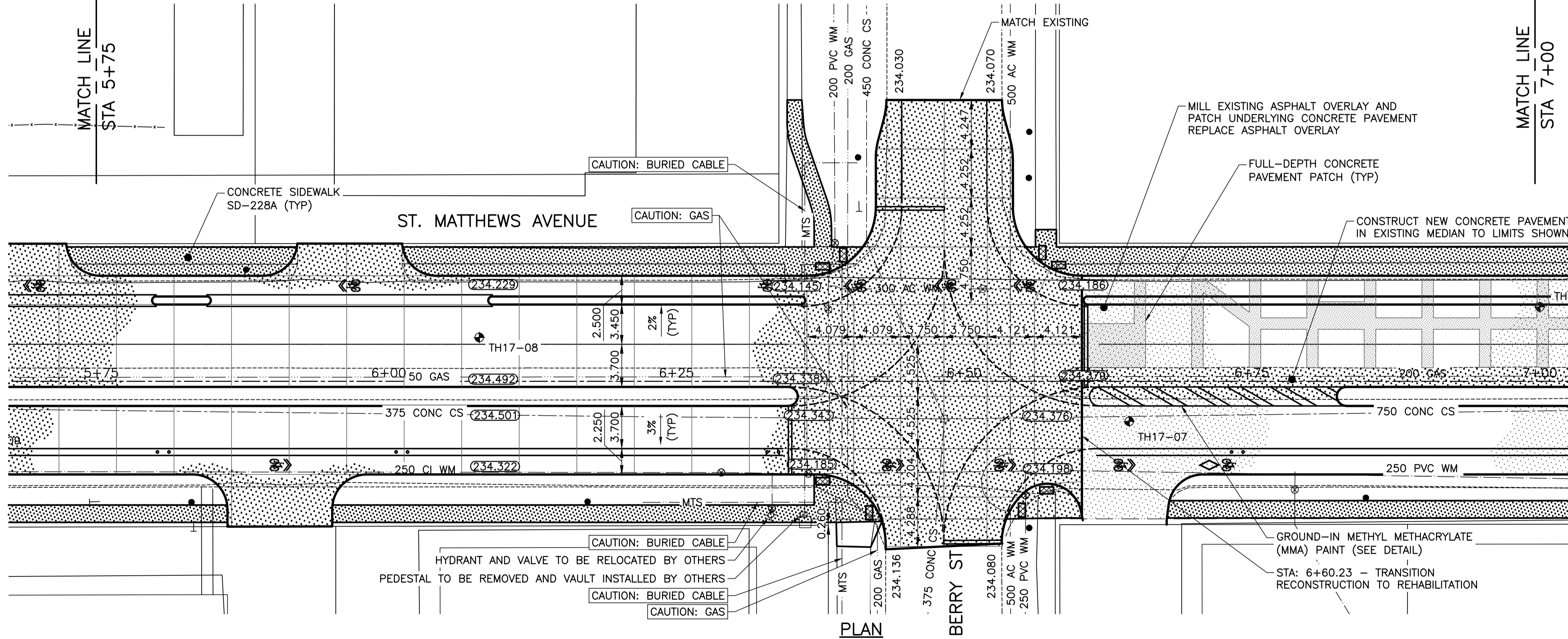
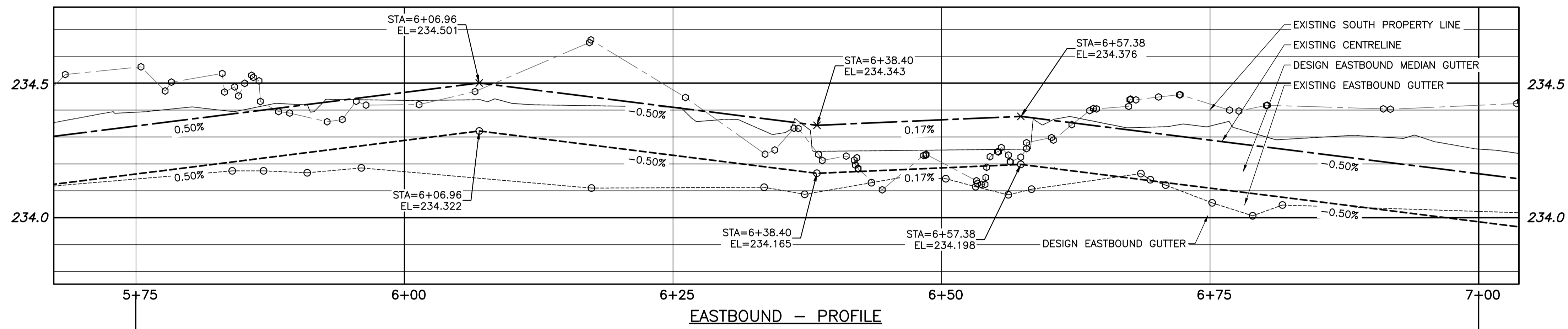
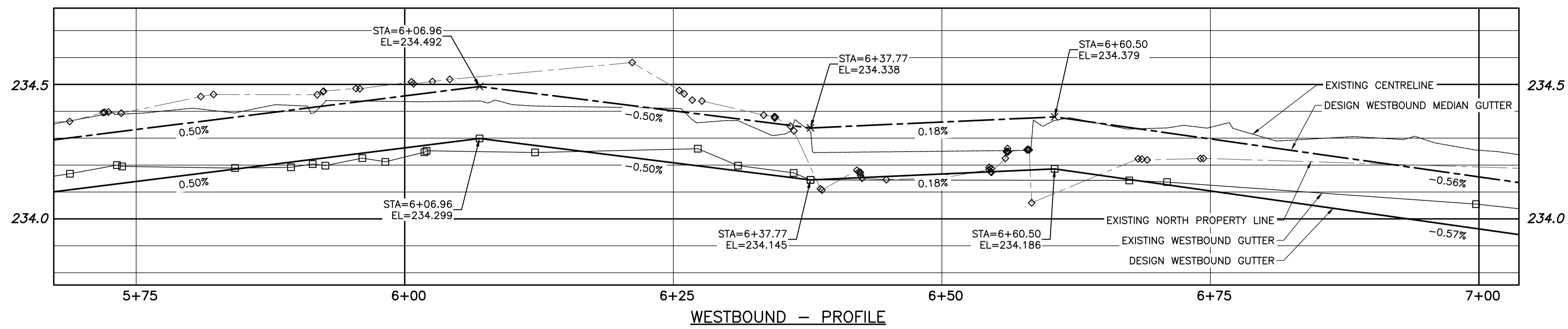

WARNING

NOTIFY THE GAS COMPANY OF THE PROPOSED LOCATION OF EXCAVATION.

TAKE PRECAUTION TO AVOID DAMAGE TO GAS COMPANY INSTALLATIONS.

SEE PROVINCIAL REGULATION 210/72 FOR DETAILS.

PROPERTY LIMITS DELINEATION

DELINEATION OF PROPERTY LIMITS AS SHOWN ON THIS DWG DOES NOT REPRESENT A "LEGAL SURVEY". KGS GROUP MAKES NO REPRESENTATION OR WARRANTY AS TO THE ACCURACY OF PROPERTY LIMITS DELINEATED ON THIS DWG, NOR ON THE DIMENSIONAL ACCURACY OF DWG FEATURES RELATIVE TO THOSE PROPERTY LIMITS.

METRIC

WHOLE NUMBERS INDICATE MILLIMETRES
DECIMALIZED NUMBERS INDICATE METRES

PRELIMINARY
NOT TO BE USED FOR CONSTRUCTION

300 LQS	LAND DRAINAGE SEWER	300 LQS		TEST HOLE			
250 WWS	WASTE WATER SEWER	250 WWS		GUY WIRE			
	GAS			LIGHT STANDARD			
	HYDRO			BACK OF CURB			
	M.T.S.			CONCRETE			
150 WM	WATERMAIN	150 WM		ASPHALT			
	HYDRANT			SIDEWALK			
	VALVE			PROPERTY LINE			
	MANHOLE			SURVEY BAR			
	CATCH BASIN			GEODETIC BENCHMARK			
	CURB INLET			ELEVATION			
	POLES						
EXISTING	LEGEND-PLAN	PROPOSED	EXISTING	LEGEND-PLAN	PROPOSED	EXISTING	LEGEND-PROFILE

LOCATION APPROVED UNDERGROUND STRUCTURES

B.M. KGS_BASE ELEV. 249.213

COORDINATE SYSTEM: CDV28

SUPV. U/G STRUCTURES COMMITTEE DATE

NOTE:
LOCATION OF UNDERGROUND STRUCTURES AS SHOWN ARE BASED ON THE BEST INFORMATION AVAILABLE BUT NO GUARANTEE IS GIVEN THAT ALL EXISTING UTILITIES ARE SHOWN OR THAT THE GIVEN LOCATIONS ARE EXACT. CONFIRMATION OF EXISTENCE AND EXACT LOCATION OF ALL SERVICES MUST BE OBTAINED FROM THE INDIVIDUAL UTILITIES BEFORE PROCEEDING WITH CONSTRUCTION.

B	ISSUED FOR TENDER	17/06/21	
A	ISSUED FOR REVIEW	17/06/12	
NO.	REVISIONS	DATE	BY

KGS GROUP CONSULTING ENGINEERS

DESIGNED BY	JB	CHECKED BY	
DRAWN BY	JB	APPROVED BY	
HOR. SCALE:	1:250	RELEASED FOR CONSTRUCTION:	
VERTICAL:	1:10	DATE	

ENGINEER'S SEAL

CONSULTANT DRAWING NO. **C206**

THE CITY OF WINNIPEG PUBLIC WORKS DEPARTMENT ENGINEERING DIVISION

PROJECT TITLE: **2017 INDUSTRIAL STREETS PACKAGE**

ST. MATTHEWS AVENUE PLAN/PROFILE STA 5+75 TO STA 7+00

SHEET **20** OF **26**

COMPUTER FILE NAME: **ST. MATTHEWS_CALL.DWG**

CITY DRAWING NUMBER

P:\PROJECTS\2017\17-0107-005\DESIGN\MUN\ST_MATTHEWS_DESIGN.dwg
PLOT 1:1 (A-1)