

TYPICAL TRAFFIC BEARING WATERPROOFING MEMBRANE DETAILS

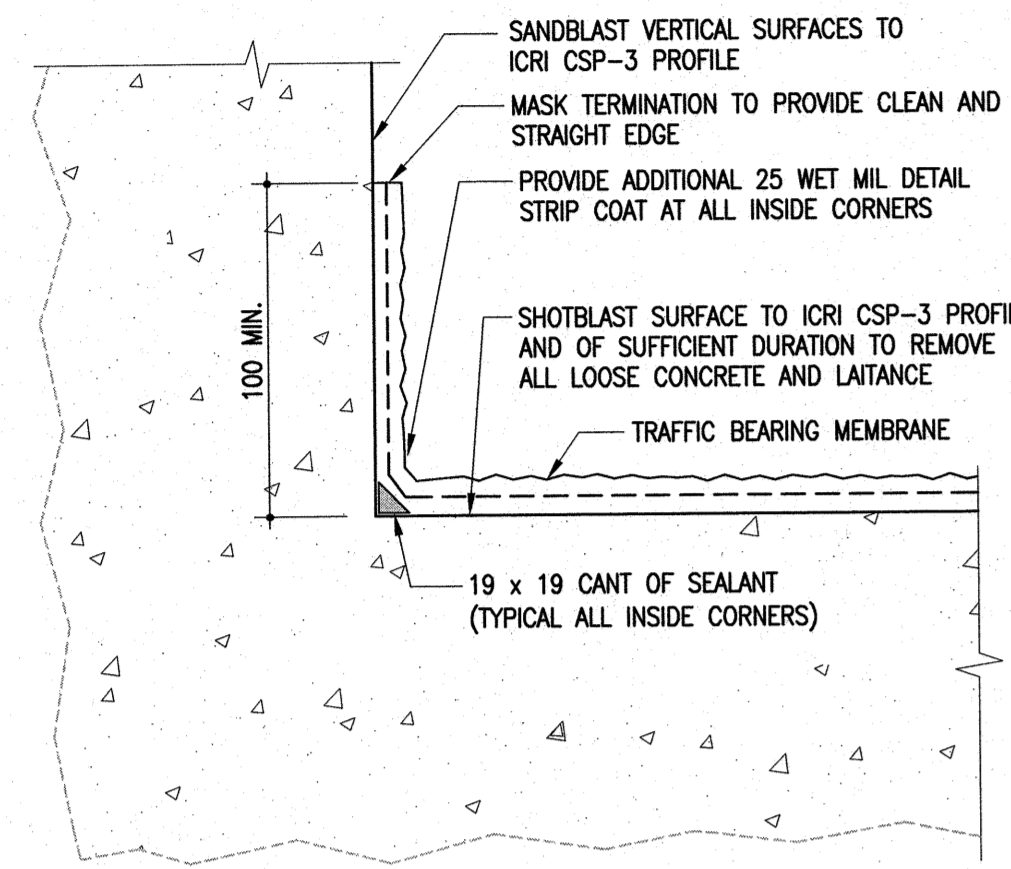

A TYPICAL DETAIL AT VERTICAL TRANSITION
- S6.2 N.T.S. (FIXED PRICE)

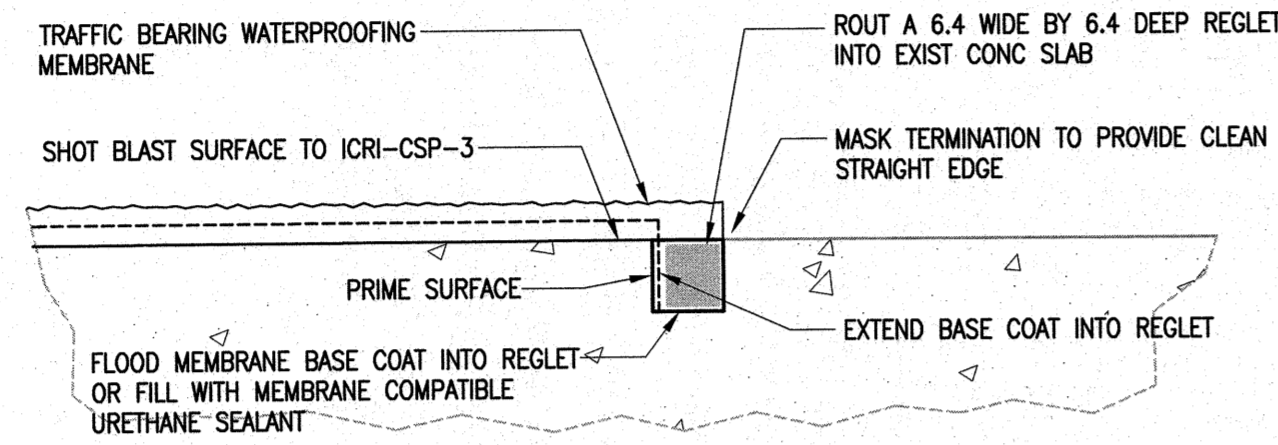

B TYPICAL HORIZ TERMINATION DETAIL
- S6.2 N.T.S. (FIXED PRICE)

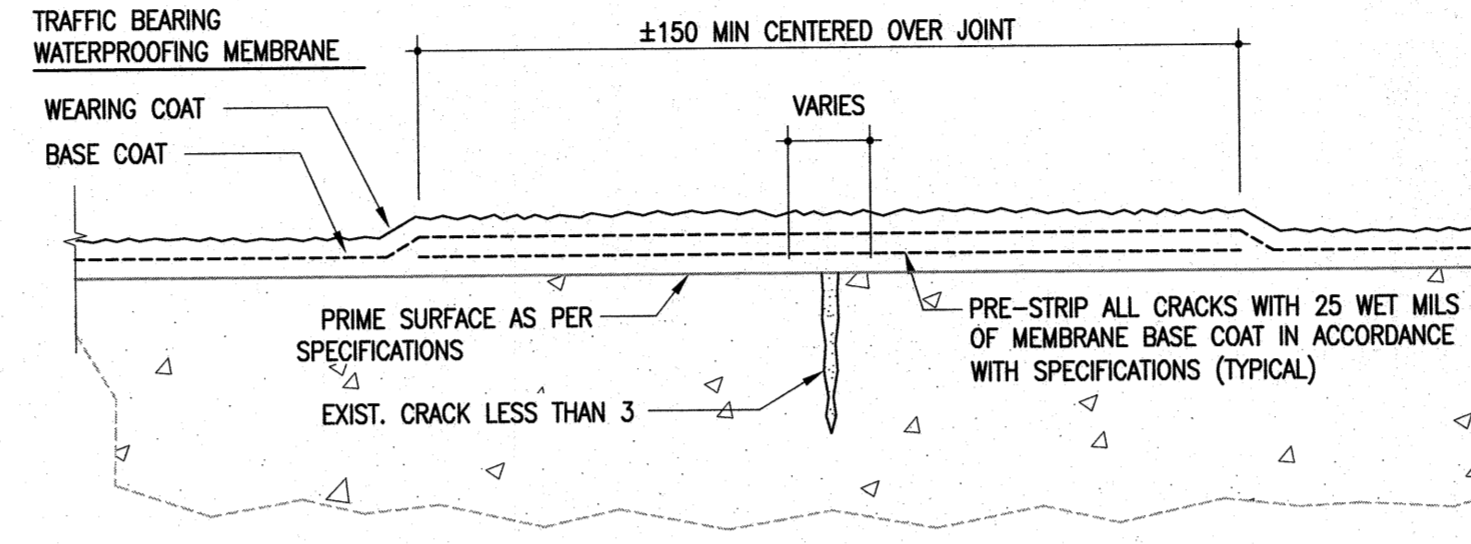

C TYPICAL DETAIL AT CRACKS
- S6.2 N.T.S. (FIXED PRICE)

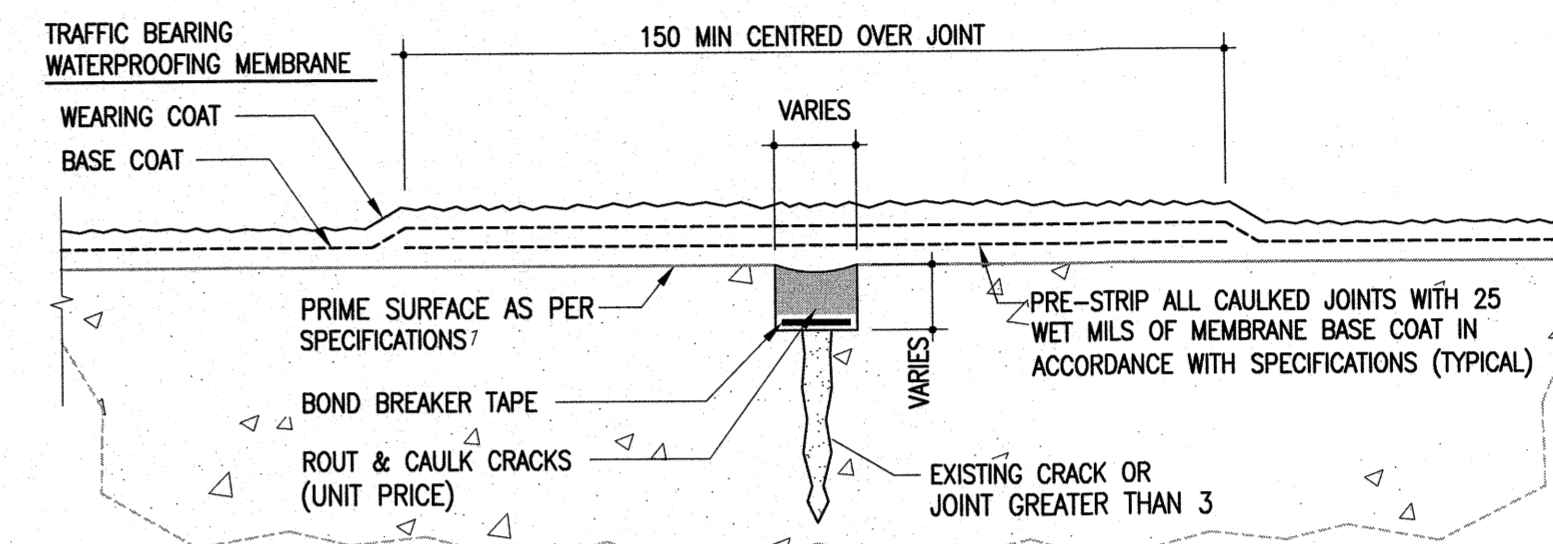

D TYPICAL DETAIL AT CAULKING JOINT
- S6.2 N.T.S. (FIXED PRICE)

TYPICAL HIGH-BUILD WATERPROOFING MEMBRANE DETAILS

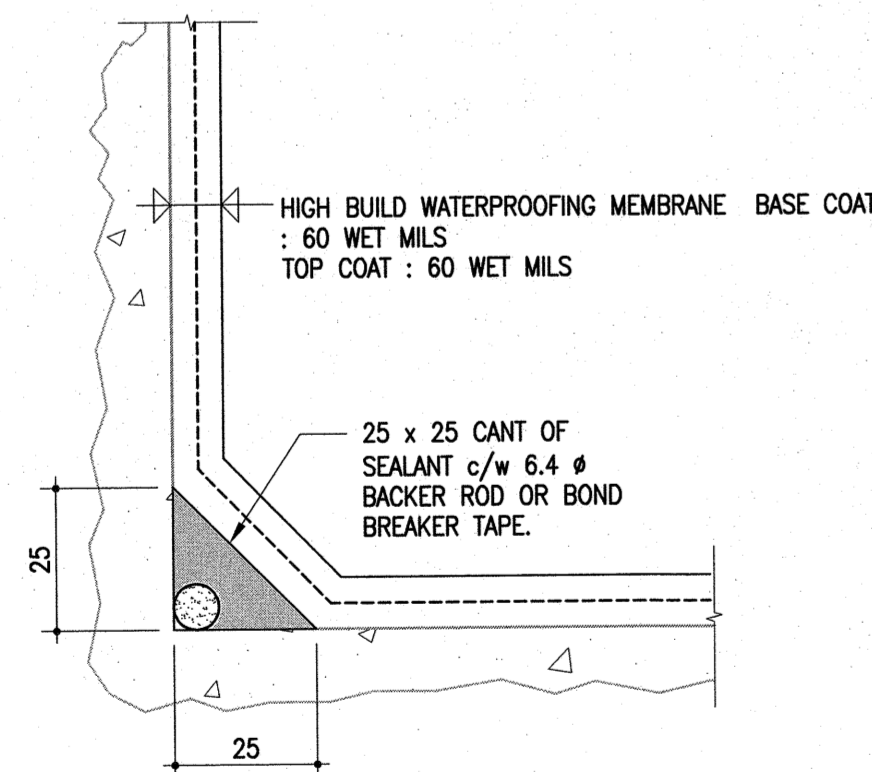

E TYPICAL INSIDE CORNER DETAIL
- S6.2 N.T.S. (FIXED PRICE)

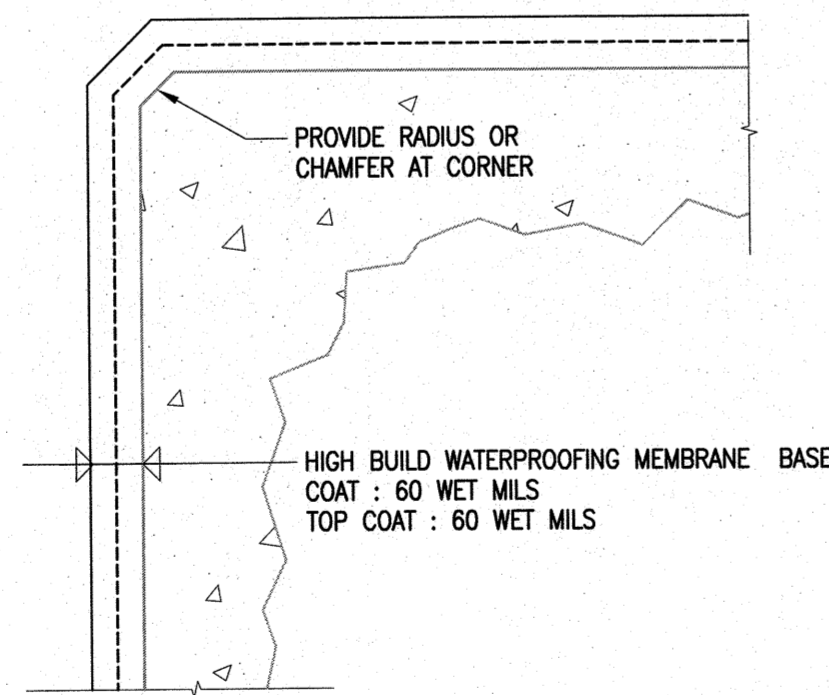

F TYPICAL OUTSIDE CORNER DETAIL
- S6.2 N.T.S. (FIXED PRICE)

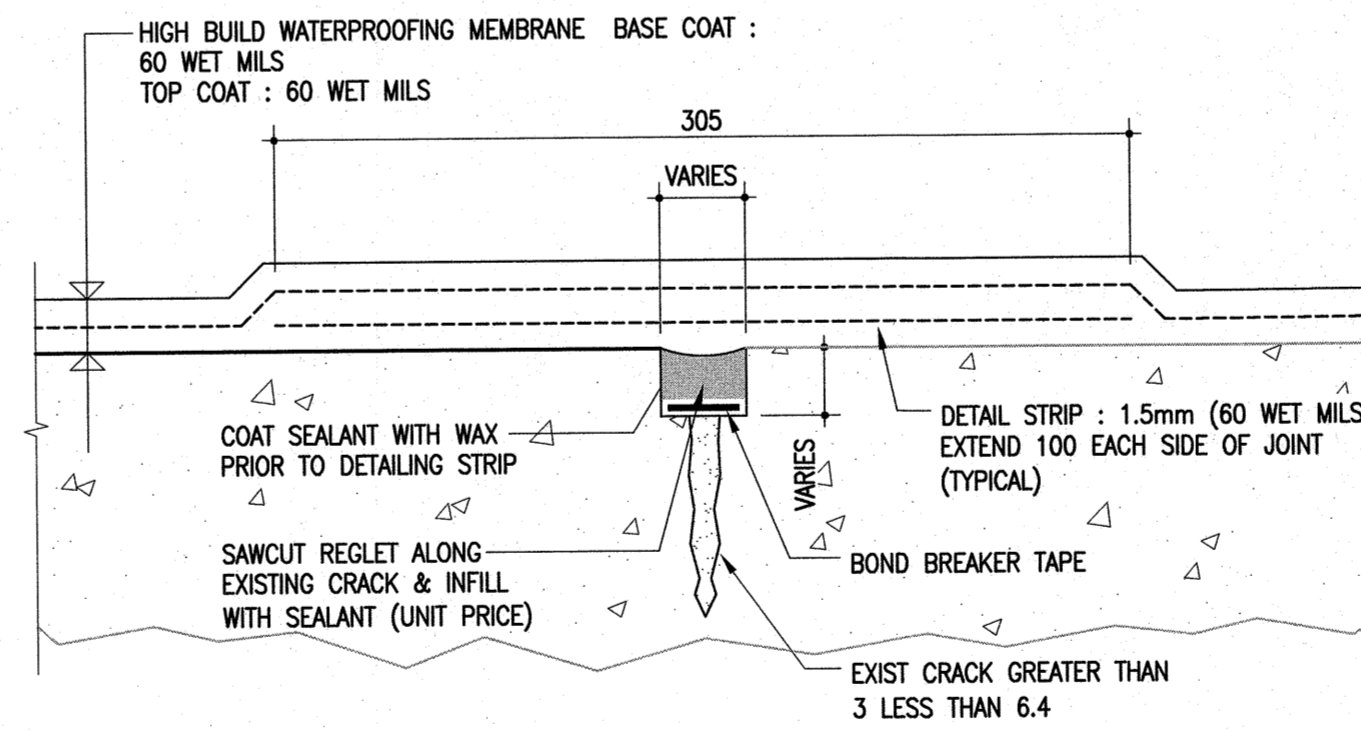

G TYPICAL DETAIL AT CAULKING JOINT
- S6.2 N.T.S. (FIXED PRICE)

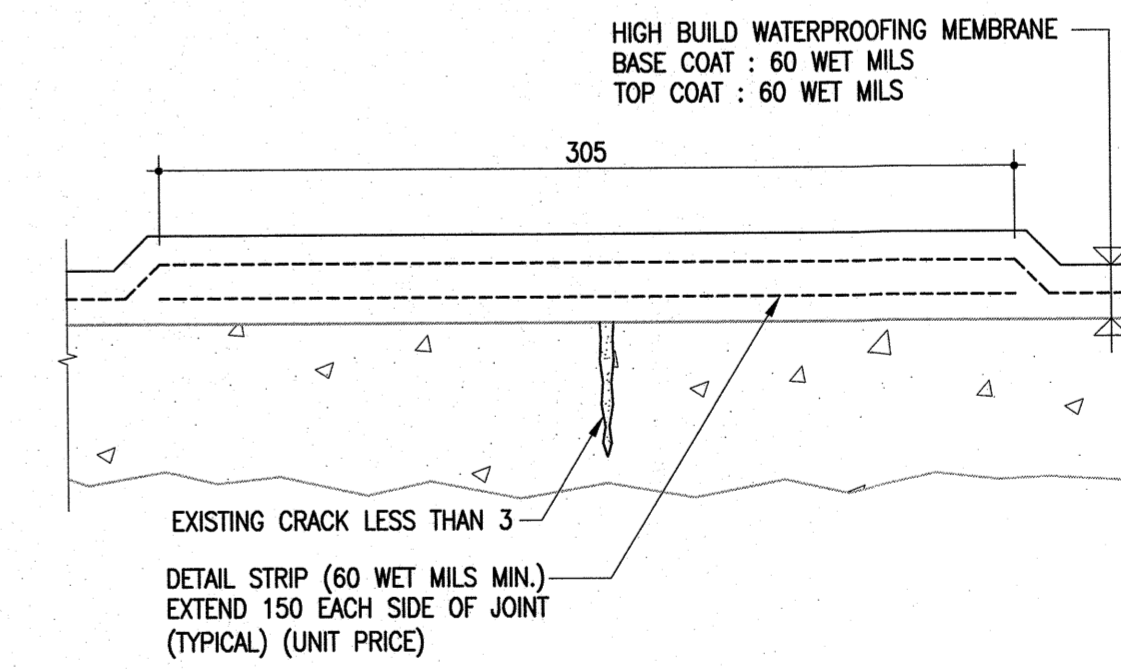

H TYPICAL DETAIL AT EXISTING CRACK
- S6.2 N.T.S. (FIXED PRICE)

The General Contractor shall check & verify all dimensions and report any errors or omissions to the designers.

No.	Date	Issue/Revision	By
0	2017-06-28	ISSUED FOR CONSTRUCTION	WB



Consultant



Project
DYNASTY BUILDING
COURTYARD WATERPROOFING
180 KING STREET
WINNIPEG, MANITOBA

Sheet Title
TYPICAL WATERPROOFING MEMBRANE DETAILS

File	2017-0306	Date	2017-06-28
Design	WB	Drawn	RJM

Revision	Sheet No.
0	S6.2