

NOTES

- ADJUST MH AND CB RIMS TO NEW GRADES.
- CONTRACTOR TO REGRADE/RENEW EXISTING PRIVATE SIDEWALKS TO LIMITS AS SHOWN. SIDEWALKS TO BE RENEWED WITH CONCRETE UNLESS NOTED OTHERWISE.
- CONTRACTOR TO TAKE PRECAUTIONARY STEPS TO PROTECT EXISTING TREES WITHIN THE LIMITS OF CONSTRUCTION FROM DAMAGE FROM CONSTRUCTION ACTIVITIES AS OUTLINED IN THE SPECIFICATIONS.
- MODIFIED BARRIER CURB TO BE CONSTRUCTED AT ALL INTERSECTION RADII, BACK LANE RADII AND BULLNOSES.
- CONTRACTOR TO CONFIRM THE LOCATION OF ALL UTILITIES/SERVICES IN THE FIELD PRIOR TO CONSTRUCTION.
- ADD 200.000m TO ABBREVIATED ELEVATIONS TO OBTAIN GEODETIC ELEVATIONS.
- ALL DIMENSIONS TO BACK OF CURB/EDGE OF ASPHALT.

RUE DES TRAPPISTES

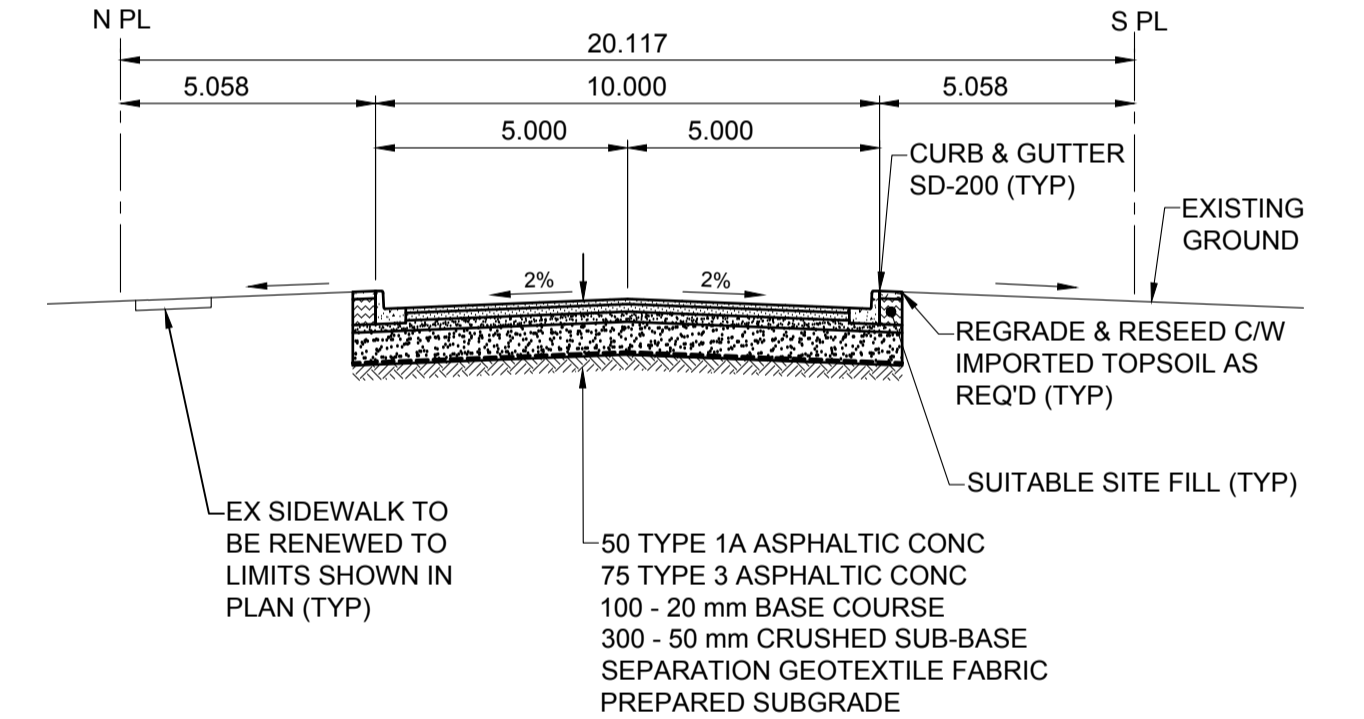
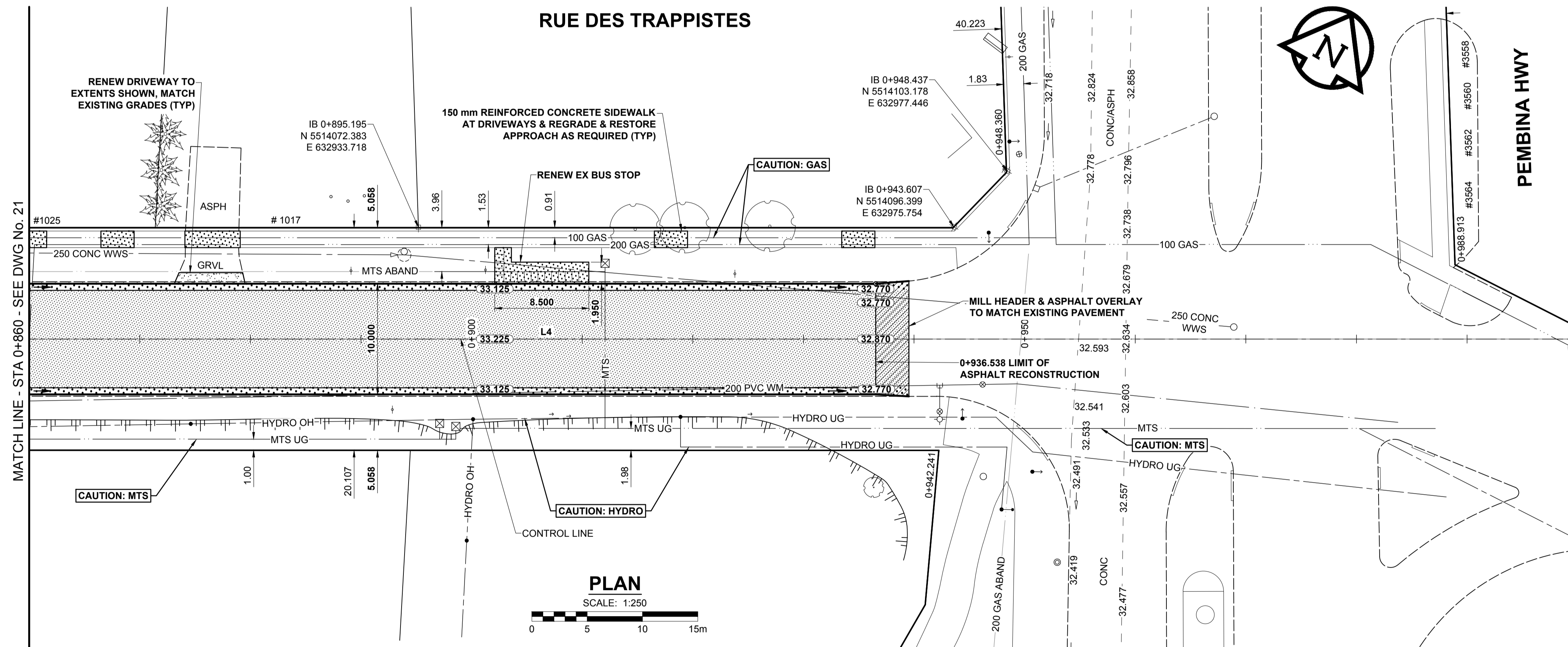

CENTRELINE RUE DES TRAPPISTES - CONTROL LINE GEOMETRY

NUMBER	LENGTH	RADIUS	DELTA	TANGENT	START STATION	NORTHING	EASTING	END STATION	NORTHING	EASTING
L4	219.996				0+793.021	5514012.976	632849.978	1+013.016	5514122.000	633041.059

METRIC
WHOLE NUMBERS INDICATE MILLIMETRES
DECIMALIZED NUMBERS INDICATE METRES

EXISTING	LEGEND - PLAN	NEW	EXISTING	LEGEND - PLAN	NEW	EXISTING	LEGEND - PLAN	NEW
○	MANHOLE	●	○	MANHOLE	●	□	CATCH BASIN/CATCH PIT	■
□	CATCH BASIN/CATCH PIT	▲	□	CURB INLET WITH BOX	▲	○	TREE	○
△	CURB INLET WITH BOX	○	○	TREE	○	⊕	TEST HOLE	⊕
○	TREE	⊕	⊕	TEST HOLE	⊕	⊕	PROPERTY LINE	⊕
⊕	TEST HOLE	⊕	⊕	PROPERTY LINE	⊕	⊕	SURVEY BAR	⊕
⊕	PROPERTY LINE	⊕	⊕	SURVEY BAR	⊕	⊕	FENCE	⊕
⊕	SURVEY BAR	⊕	⊕	FENCE	⊕	⊕	BOC/EDGE OF PAVEMENT	⊕
⊕	FENCE	⊕	⊕	BOC/EDGE OF PAVEMENT	⊕	⊕	ELEVATION	(33.333)
⊕	BOC/EDGE OF PAVEMENT	⊕	⊕	ELEVATION	(33.333)	⊕	TRAFFIC SIGN	⊕
⊕	ELEVATION	(33.333)	⊕	TRAFFIC SIGN	⊕	⊕		
⊕	TRAFFIC SIGN	⊕						

LOCATION APPROVED
UNDERGROUND STRUCTURES

DATE: _____

NOTE:
LOCATION OF UNDERGROUND STRUCTURES AS SHOWN ARE BASED ON THE BEST INFORMATION AVAILABLE BUT NO GUARANTEE IS GIVEN THAT ALL EXISTING UTILITIES ARE SHOWN OR THAT THE GIVEN LOCATIONS ARE EXACT. CONFIRMATION OF EXISTENCE AND EXACT LOCATION OF ALL SERVICES MUST BE OBTAINED FROM THE INDIVIDUAL UTILITIES BEFORE PROCEEDING WITH CONSTRUCTION.

BM 88-029 N. side Rue des Trappistes, @ Rue Du Monastere;
ELEV 231.421 m
Tall: on top of 0.05 m dia. x 2.4 m iron pipe, 23.5 m
W. of W. wall & 22.0 m N. of N. wall of attached garage on N. side of No. 2 Rue Du Monastere.

0	ISSUED FOR TENDER	17/09/15	GFC
No.	REVISIONS	YY/MM/DD	BY

MORRISON HERSHFELD

DESIGNED BY	GFC	CHECKED BY	RPB
DRAWN BY	DML	APPROVED BY	BWB
RELEASED FOR CONSTRUCTION			
HOR SCALE	1:250		
VERT SCALE	1:10		
DATE	17/08/04		

PROFESSIONAL'S SEAL
PROVINCE OF MANITOBA
G.F. COOLIDGE
ORIGINAL SIGNED
170915
24465
REGISTERED PROFESSIONAL ENGINEER

CONSULTANT FILE NAME
5160966-PP-06.dwg

THE CITY OF WINNIPEG
PUBLIC WORKS DEPARTMENT
ENGINEERING DIVISION

**RUE DES TRAPPISTES AT WESTENDORF
COULEE CULVERT REPLACEMENT AND
ROAD RECONSTRUCTION**

RUE DES TRAPPISTES
HORIZONTAL AND VERTICAL ALIGNMENT
STA 0+860 TO PEMBINA HWY

CITY DRAWING NUMBER	N/A
SHEET	22 OF 22
DRAWING No.	REV
	22 0

BID OPPORTUNITY No. 698-2017