

ALEXANDER AVENUE

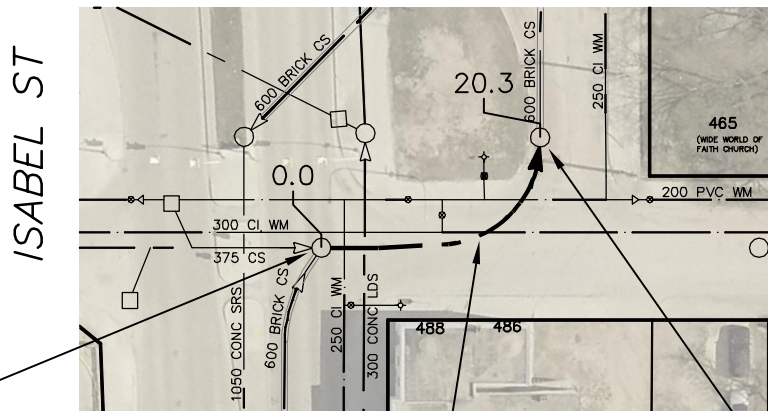
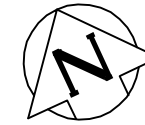

S-MH20016866
RIM 231.95
INV E 226.64
INV W 226.64
INV W 226.64

S-MH20016867
RIM 232.03
INV N 226.56
INV S 226.57

20.3 OF 375 CLAY CS TO BE LINED
S-MA20018748
(PARTIALLY DETERIORATED)

SEWER JUNCTION INFORMATION FROM SEWER VIDEO INSPECTION		
SEWER ID S-MA20018748		
DISTANCE FROM MH ID S-MH20016866		
DISTANCE	DIAMETER	CLOCK
5.1	250	12
7.0	150	11

FOR INDEX SEE
11465

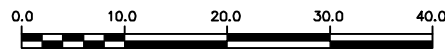

METRIC

WHOLE NUMBERS INDICATE MILLIMETRES
DECIMALIZED NUMBERS INDICATE METRES

LOCATION APPROVED UNDERGROUND STRUCTURES SUPV. U/G STRUCTURES COMMITTEE _____ DATE _____ NOTE: LOCATION OF UNDERGROUND STRUCTURES AS SHOWN ARE BASED ON THE BEST INFORMATION AVAILABLE BUT NO GUARANTEE IS GIVEN THAT ALL EXISTING UTILITIES ARE SHOWN OR THAT THE GIVEN LOCATIONS ARE EXACT. CONFIRMATION OF EXISTENCE AND EXACT LOCATION OF ALL SERVICES MUST BE OBTAINED FROM THE INDIVIDUAL UTILITIES BEFORE PROCEEDING WITH CONSTRUCTION.	B.M. ELEV.			ENGINEER'S SEAL		 THE CITY OF WINNIPEG WATER AND WASTE DEPARTMENT ENGINEERING DIVISION	2016 SEWER MAIN RENEWALS BY CIPP LINING ALEXANDER AVENUE MH AT ISABEL STREET (E) TO MH AT ISABEL STREET (E)	SHEET 7 OF 80
		DESIGNED BY SC	CHECKED BY SC	ORIGINAL SIGNED BY S.R.J. COURNOYER 17/02/10	CONSULTANT DRAWING NUMBER -			CITY DRAWING NUMBER 11472
		DRAWN BY AD	APPROVED BY KZ	RELEASED FOR CONSTRUCTION K. ZURIK				
		SCALE: HORIZONTAL 1:750		DATE 2017 02 15				
		DATE 2017 02 16		PLOT DATE: 2017 02 16				