

ANNABELLA STREET

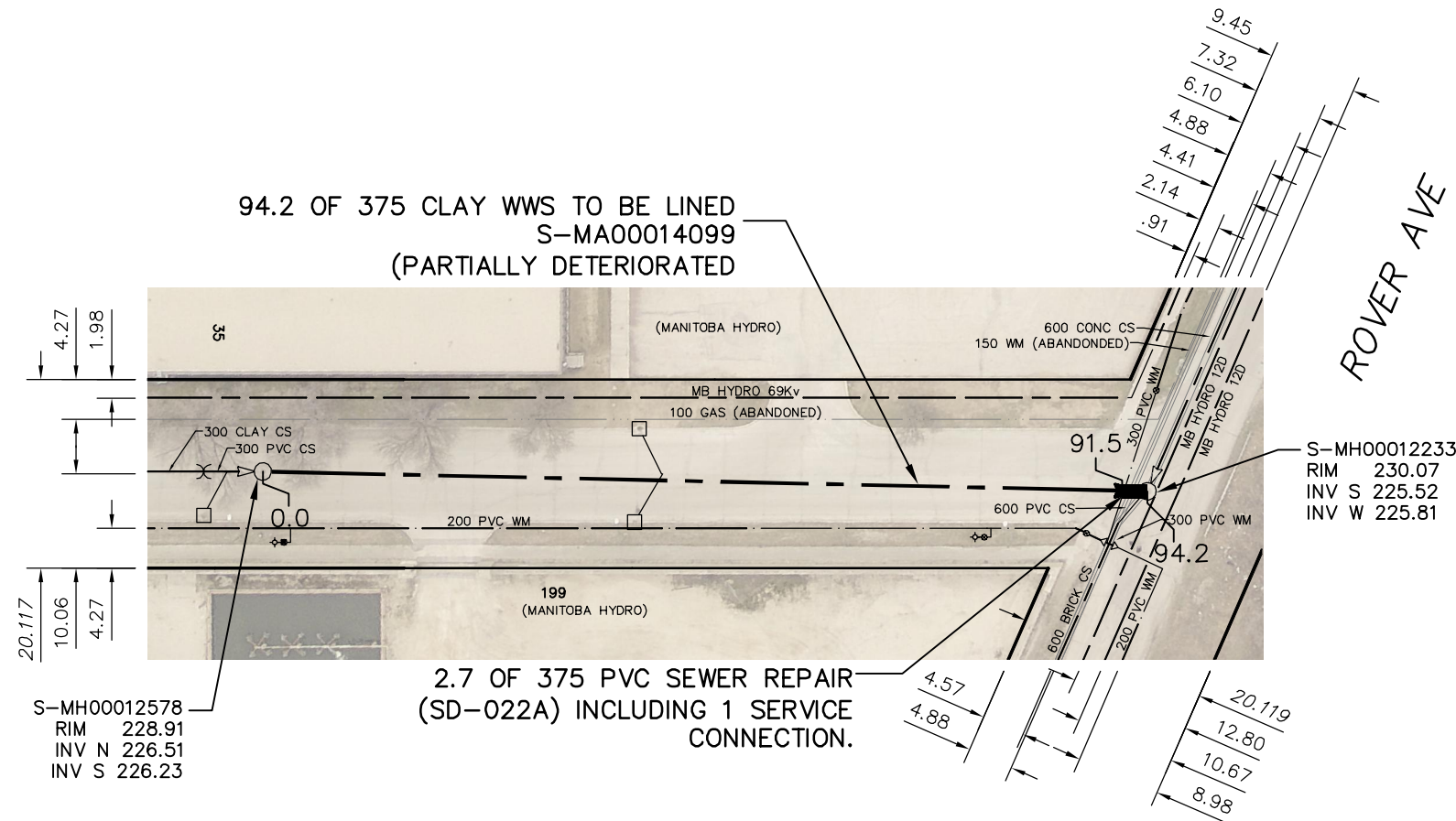

94.2 OF 375 CLAY WWS TO BE LINED
S-MA00014099
(PARTIALLY DETERIORATED)

2.7 OF 375 PVC SEWER REPAIR
(SD-022A) INCLUDING 1 SERVICE
CONNECTION.

S-MH00012233
RIM 230.07
INV S 225.52
INV W 225.81

S-MH00012578
RIM 228.91
INV N 226.51
INV S 226.23

SEWER JUNCTION INFORMATION FROM SEWER VIDEO INSPECTION		
SEWER ID S-MA00014099		
DISTANCE FROM MH ID S-MH00012578		
DISTANCE	DIAMETER	CLOCK
3.7	150	2
4.2	152	1
16.6	150	10
16.8	100	2
26.6	150	2
28.4	100	11
41.3	150	2
42.1	150	10
76.4	150	10

FOR INDEX SEE
11465

WARNING

IF POWER EQUIPMENT OR EXPLOSIVES
ARE TO BE USED FOR EXCAVATION ON
THIS PROJECT THE CONTRACTOR MUST:

- 1) NOTIFY THE GAS COMPANY OF THE PROPOSED LOCATION OF EXCAVATION.
- 2) TAKE PRECAUTION TO AVOID DAMAGE TO GAS COMPANY INSTALLATIONS.

SEE PROVINCIAL REGULATION 210/72 FOR DETAILS

METRIC

WHOLE NUMBERS INDICATE MILLIMETRES
DECIMALIZED NUMBERS INDICATE METRES

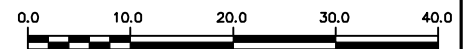

LOCATION APPROVED
UNDERGROUND STRUCTURES

SUPV. U/G STRUCTURES COMMITTEE DATE

NOTE:

LOCATION OF UNDERGROUND STRUCTURES AS SHOWN ARE BASED ON THE BEST INFORMATION AVAILABLE BUT NO GUARANTEE IS GIVEN THAT ALL EXISTING UTILITIES ARE SHOWN OR THAT THE GIVEN LOCATIONS ARE EXACT. CONFIRMATION OF EXISTENCE AND EXACT LOCATION OF ALL SERVICES MUST BE OBTAINED FROM THE INDIVIDUAL UTILITIES BEFORE PROCEEDING WITH CONSTRUCTION.

NO.	REVISIONS	DATE	BY

DESIGNED BY	SC	CHECKED BY	SC
DRAWN BY	AD	APPROVED BY	KZ
SCALE:	1:750	RELEASED FOR CONSTRUCTION	K. ZURIK
HORIZONTAL		DATE	2017 02 15
VERTICAL		DATE	2017 02 16

ENGINEER'S SEAL

ORIGINAL
SIGNED BY
S.R.J.
COURNOYER
17/02/10

CONSULTANT DRAWING NUMBER
-



THE CITY OF WINNIPEG
WATER AND WASTE DEPARTMENT
ENGINEERING DIVISION

2016 SEWER MAIN RENEWALS
BY AUGMENTATION
ANNABELLA STREET
1ST MH S OF ROVER AVENUE TO
MH AT ROVER AVENUE

SHEET 10 OF 80

CITY DRAWING NUMBER

11475