

ATLANTIC AVENUE

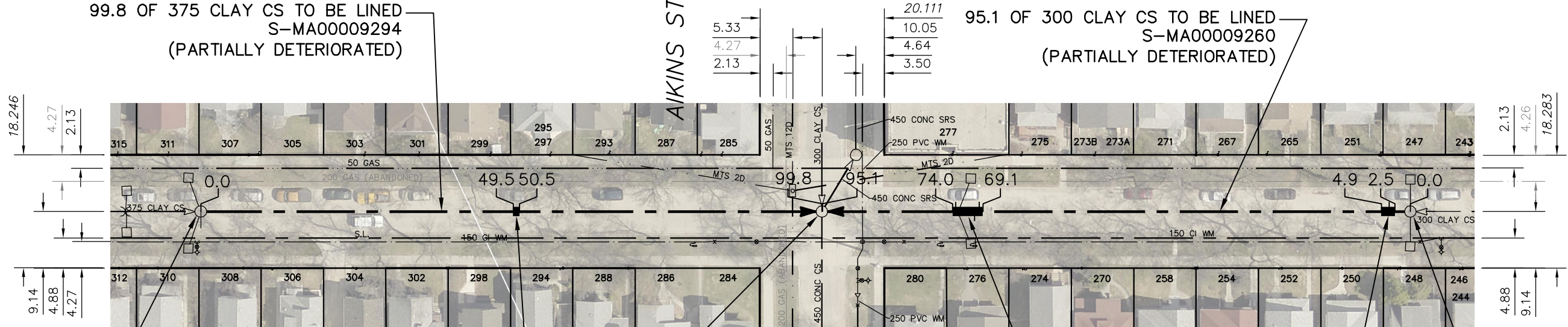
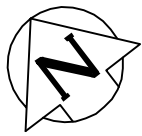

99.8 OF 375 CLAY CS TO BE LINED
S-MA00009294
(PARTIALLY DETERIORATED)

95.1 OF 300 CLAY CS TO BE LINED
S-MA00009260
(PARTIALLY DETERIORATED)

1.0 OF 375 CLAY SEWER REPAIR
(SD-022A)
(TO BE DONE BY OTHERS)

4.9 OF 300 PVC SEWER REPAIR
(SD-022B), INCLUDING 3 SERVICE
CONNECTIONS.
(TO BE DONE BY OTHERS)

2.2 OF 300 PVC SEWER REPAIR
(SD-022A), INCLUDING 1 SERVICE
CONNECTION.
(TO BE DONE BY OTHERS)

S-MH00010950
RIM 230.47
INV E 226.71
INV W 226.71

S-MH00010948
RIM 230.86
WEIR 226.26
INV N 226.29
INV E 226.11
INV S 226.38
INV W 226.38

S-MH00010930
RIM 230.75
INV E 226.99
INV W 226.99

SEWER JUNCTION INFORMATION FROM SEWER VIDEO INSPECTION
SEWER ID S-MA00009294

DISTANCE FROM MH ID S-MH00010950		
DISTANCE	DIAMETER	CLOCK
1.0	150	2
9.0	150	2
9.6	150	10
28.7	150	2
29.4	150	10
39.6	150	2
40.1	150	10
59.4	150	2
60.0	150	10
68.6	150	2
70.3	150	10
79.9	150	10
90.0	150	10

SEWER JUNCTION INFORMATION FROM SEWER VIDEO INSPECTION
SEWER ID S-MA00009260

DISTANCE FROM MH ID S-MH00010930		
DISTANCE	DIAMETER	CLOCK
3.4	150	10
13.6	150	10
14.4	150	2
23.7	150	10
24.4	150	2
33.6	150	10
34.4	150	2
47.5	150	2
53.6	150	10
54.4	150	2
63.5	150	10
64.3	150	2
69.7	150	11
70.4	150	2
73.5	150	10
74.2	150	2
83.4	150	10

FOR INDEX SEE
11465

METRIC
WHOLE NUMBERS INDICATE MILLIMETRES
DECIMALIZED NUMBERS INDICATE METRES

WARNING
IF POWER EQUIPMENT OR EXPLOSIVES ARE TO BE USED FOR EXCAVATION ON THIS PROJECT THE CONTRACTOR MUST:
1) NOTIFY THE GAS COMPANY OF THE PROPOSED LOCATION OF EXCAVATION.
2) TAKE PRECAUTION TO AVOID DAMAGE TO GAS COMPANY INSTALLATIONS.
SEE PROVINCIAL REGULATION 210/72 FOR DETAILS

<p>LOCATION APPROVED UNDERGROUND STRUCTURES</p> <p>SUPV. U/G STRUCTURES COMMITTEE _____ DATE _____</p> <p>NOTE: LOCATION OF UNDERGROUND STRUCTURES AS SHOWN ARE BASED ON THE BEST INFORMATION AVAILABLE BUT NO GUARANTEE IS GIVEN THAT ALL EXISTING UTILITIES ARE SHOWN OR THAT THE GIVEN LOCATIONS ARE EXACT. CONFIRMATION OF EXISTENCE AND EXACT LOCATION OF ALL SERVICES MUST BE OBTAINED FROM THE INDIVIDUAL UTILITIES BEFORE PROCEEDING WITH CONSTRUCTION.</p>	<p>B.M. ELEV.</p> <table border="1" style="width:100%; height: 40px;"> <tr><td> </td><td> </td><td> </td><td> </td></tr> </table>					<table border="1" style="width:100%;"> <tr> <td>DESIGNED BY</td> <td>SC</td> <td>CHECKED BY</td> <td>SC</td> </tr> <tr> <td>DRAWN BY</td> <td>RJ</td> <td>APPROVED BY</td> <td>KZ</td> </tr> <tr> <td>SCALE:</td> <td colspan="3">1:750</td> </tr> <tr> <td>HORIZONTAL</td> <td colspan="3"> </td> </tr> <tr> <td>VERTICAL</td> <td colspan="3"> </td> </tr> <tr> <td>DATE</td> <td>2017 02 16</td> <td>RELEASED FOR CONSTRUCTION</td> <td>K. ZURIK</td> </tr> <tr> <td>DATE</td> <td>2017 02 15</td> <td>CONSULTANT DRAWING NUMBER</td> <td>-</td> </tr> </table>	DESIGNED BY	SC	CHECKED BY	SC	DRAWN BY	RJ	APPROVED BY	KZ	SCALE:	1:750			HORIZONTAL				VERTICAL				DATE	2017 02 16	RELEASED FOR CONSTRUCTION	K. ZURIK	DATE	2017 02 15	CONSULTANT DRAWING NUMBER	-	<p>ENGINEER'S SEAL</p> <p>ORIGINAL SIGNED BY S.R.J. COURNOYER 17/02/10</p>	<p>THE CITY OF WINNIPEG WATER AND WASTE DEPARTMENT ENGINEERING DIVISION</p> <p>2016 SEWER MAIN RENEWALS BY AUGMENTATION ATLANTIC AVENUE 1ST MH W OF AIKINS STREET TO 1ST MH E OF AIKINS STREET</p>	<p>SHEET 12 OF 80</p> <p>CITY DRAWING NUMBER 11477</p>
DESIGNED BY	SC	CHECKED BY	SC																																		
DRAWN BY	RJ	APPROVED BY	KZ																																		
SCALE:	1:750																																				
HORIZONTAL																																					
VERTICAL																																					
DATE	2017 02 16	RELEASED FOR CONSTRUCTION	K. ZURIK																																		
DATE	2017 02 15	CONSULTANT DRAWING NUMBER	-																																		
<p>NO. REVISIONS DATE BY</p>		<p>PLOT DATE: 2017 02 16</p>		<p>BID OPPORTUNITY: 71-2017 CONTRACT NUMBER: 4</p>		<p>FILE PATH: R:\DRAWINGS\SEWER\2016 RENEWALS\Contract 4\Construction Dwg\New folder\corrections\ FILE NAME: 11477.dwg</p>																															