

CARMEN AVENUE

138.4 OF 300 CLAY CS TO BE LINED
S-MA40003427
(FULLY DETERIORATED)

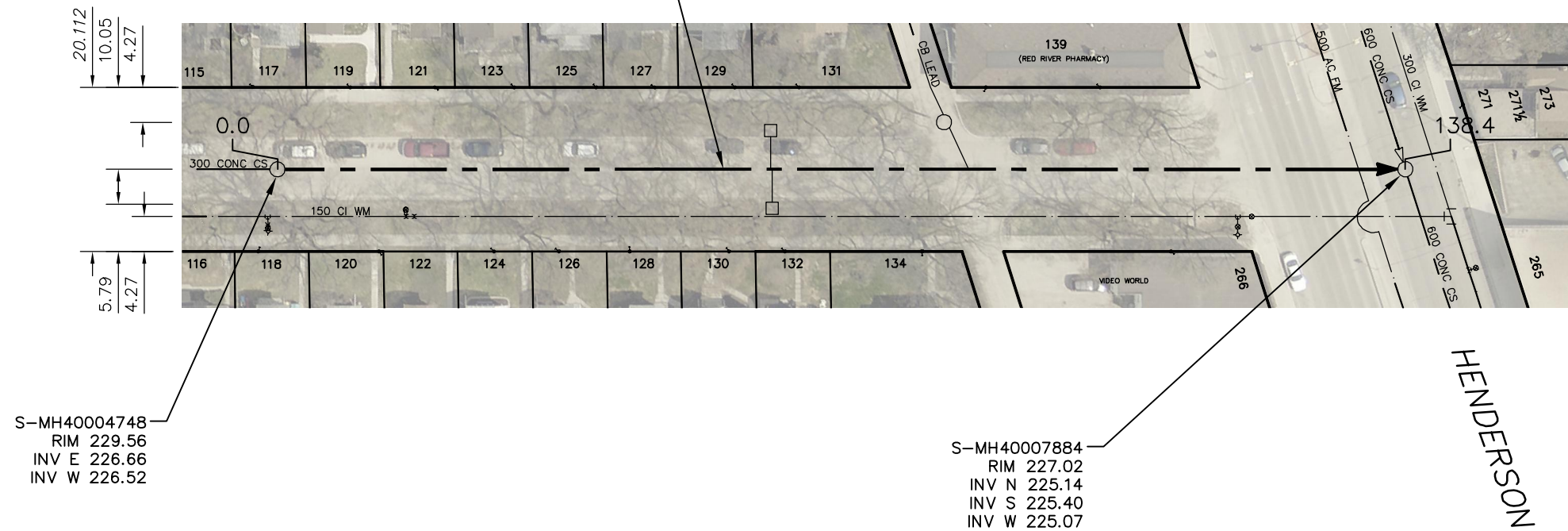

SEWER JUNCTION INFORMATION FROM SEWER VIDEO INSPECTION		
SEWER ID S-MA40003427		
DISTANCE FROM MH ID S-MH40004748		
DISTANCE	DIAMETER	CLOCK
11.6	150	10
21.1	150	10
30.1	150	10
30.6	150	2
30.7	150	2
38.8	150	2
39.4	150	10
48.9	150	10
49.4	150	2
57.5	150	10
58.3	150	2
61.3	200	2
61.9	200	10
67.0	150	10
67.7	150	2
77.1	150	10
86.7	200	10
90.0	150	10
97.6	150	10
104.1	150	2
105.6	150	10
111.9	150	2
113.0	150	10
119.3	150	2
131.1	200	2
133.7	150	12

S-MH40004748
RIM 229.56
INV E 226.66
INV W 226.52

S-MH40007884
RIM 227.02
INV N 225.14
INV S 225.40
INV W 225.07

HENDERSON HWY

FOR INDEX SEE
11465

WARNING

IF POWER EQUIPMENT OR EXPLOSIVES ARE TO BE USED FOR EXCAVATION ON THIS PROJECT THE CONTRACTOR MUST:

- 1) NOTIFY THE GAS COMPANY OF THE PROPOSED LOCATION OF EXCAVATION.
- 2) TAKE PRECAUTION TO AVOID DAMAGE TO GAS COMPANY INSTALLATIONS.

SEE PROVINCIAL REGULATION 210/72 FOR DETAILS

METRIC

WHOLE NUMBERS INDICATE MILLIMETRES
DECIMALIZED NUMBERS INDICATE METRES

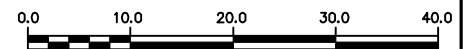

LOCATION APPROVED
UNDERGROUND STRUCTURES

B.M.
ELEV.

SUPV. U/G STRUCTURES COMMITTEE DATE

NOTE:

LOCATION OF UNDERGROUND STRUCTURES AS SHOWN ARE BASED ON THE BEST INFORMATION AVAILABLE BUT NO GUARANTEE IS GIVEN THAT ALL EXISTING UTILITIES ARE SHOWN OR THAT THE GIVEN LOCATIONS ARE EXACT. CONFIRMATION OF EXISTENCE AND EXACT LOCATION OF ALL SERVICES MUST BE OBTAINED FROM THE INDIVIDUAL UTILITIES BEFORE PROCEEDING WITH CONSTRUCTION.

NO.	REVISIONS	DATE	BY

DESIGNED BY	SC	CHECKED BY	SC
DRAWN BY	RJ	APPROVED BY	KZ
SCALE:		RELEASED FOR CONSTRUCTION	
HORIZONTAL	1:750		K. ZURIK
VERTICAL			
DATE	2017 02 16	DATE	2017 02 15

ENGINEER'S SEAL

ORIGINAL
SIGNED BY
S.R.J.
COURNOYER
17/02/10

CONSULTANT DRAWING NUMBER



THE CITY OF WINNIPEG

WATER AND WASTE DEPARTMENT
ENGINEERING DIVISION

2016 SEWER MAIN RENEWALS
BY CIPP LINING

CARMEN AVENUE
1ST MH W OF HENDERSON HIGHWAY TO
MH AT HENDERSON HIGHWAY

SHEET 19 OF 80

CITY DRAWING NUMBER

11484