



SPENCE STREET

40.3 OF 300 WWS TO BE LINED
S-MA20016959
(PARTIALLY DETERIORATED)

78.8 OF 300 WWS TO BE LINED
S-MA20017041
(FULLY DETERIORATED)

SEWER JUNCTION INFORMATION FROM SEWER VIDEO INSPECTION SEWER ID S-MA20016959		
DISTANCE FROM MH ID S-MH20015239		
DISTANCE	DIAMETER	CLOCK
11.2	100	10
12.1	150	9
12.8	150	2
17.7	150	10
22.2	150	10
23.2	150	2
32.6	150	9
33.6	150	10

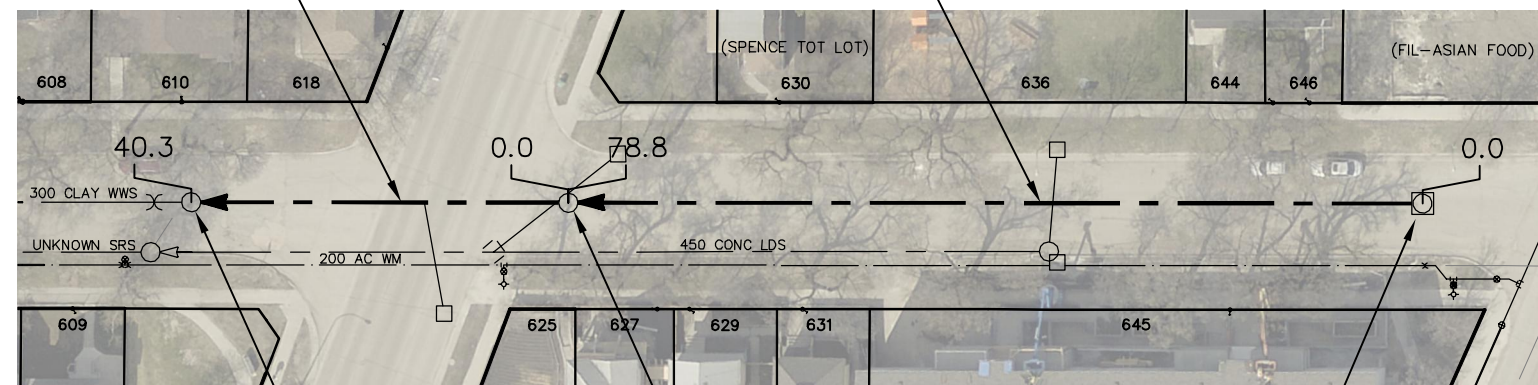

SEWER JUNCTION INFORMATION FROM SEWER VIDEO INSPECTION SEWER ID S-MA20017041		
DISTANCE FROM MH ID S-MH20016536		
DISTANCE	DIAMETER	CLOCK
12.2	150	10
13.3	150	2
18.0	150	9
21.4	150	1
22.5	150	2
30.0	150	3
30.4	150	10
31.7	150	10
48.5	150	10
56.6	150	2
64.5	150	10
65.1	150	2
73.7	150	2
74.7	150	10

CUMBERLAND AVE

NOTRE DAME AVE

S-MH20015246
RIM 231.82
INV N 228.46
INV S 228.44

S-MH20015239
RIM 232.07
INV N 228.70
INV S 228.70

S-MH20016536
RIM 232.12
INV S 229.21

FOR INDEX SEE
11466

WARNING

IF POWER EQUIPMENT OR EXPLOSIVES ARE TO BE USED FOR EXCAVATION ON THIS PROJECT THE CONTRACTOR MUST:

- 1) NOTIFY THE GAS COMPANY OF THE PROPOSED LOCATION OF EXCAVATION.
- 2) TAKE PRECAUTION TO AVOID DAMAGE TO GAS COMPANY INSTALLATIONS.

SEE PROVINCIAL REGULATION 210/72 FOR DETAILS

METRIC

WHOLE NUMBERS INDICATE MILLIMETRES
DECIMALIZED NUMBERS INDICATE METRES



<p>LOCATION APPROVED UNDERGROUND STRUCTURES</p> <p>SUPV. U/G STRUCTURES COMMITTEE DATE</p> <p>NOTE: LOCATION OF UNDERGROUND STRUCTURES AS SHOWN ARE BASED ON THE BEST INFORMATION AVAILABLE BUT NO GUARANTEE IS GIVEN THAT ALL EXISTING UTILITIES ARE SHOWN OR THAT THE GIVEN LOCATIONS ARE EXACT. CONFIRMATION OF EXISTENCE AND EXACT LOCATION OF ALL SERVICES MUST BE OBTAINED FROM THE INDIVIDUAL UTILITIES BEFORE PROCEEDING WITH CONSTRUCTION.</p>	<p>B.M. ELEV.</p> <table border="1" style="width: 100%; height: 40px;"> <tr><td> </td><td> </td><td> </td><td> </td></tr> </table>					<table border="1" style="width: 100%;"> <tr> <td>DESIGNED BY</td> <td>SC</td> <td>CHECKED BY</td> <td>SC</td> </tr> <tr> <td>DRAWN BY</td> <td>RJ</td> <td>APPROVED BY</td> <td>KZ</td> </tr> <tr> <td>SCALE:</td> <td rowspan="2">1:750</td> <td>RELEASED FOR CONSTRUCTION</td> <td rowspan="2">K. ZURIK</td> </tr> <tr> <td>HORIZONTAL</td> <td> </td> </tr> <tr> <td>VERTICAL</td> <td> </td> <td> </td> <td> </td> </tr> <tr> <td>DATE</td> <td>2017 02 16</td> <td>DATE</td> <td>2017 02 15</td> </tr> <tr> <td>PLOT DATE:</td> <td colspan="3">2017 02 16</td> </tr> </table>	DESIGNED BY	SC	CHECKED BY	SC	DRAWN BY	RJ	APPROVED BY	KZ	SCALE:	1:750	RELEASED FOR CONSTRUCTION	K. ZURIK	HORIZONTAL		VERTICAL				DATE	2017 02 16	DATE	2017 02 15	PLOT DATE:	2017 02 16			<p>ENGINEER'S SEAL</p> <p>ORIGINAL SIGNED BY S.R.J. COURNOYER 17/02/10</p> <p>CONSULTANT DRAWING NUMBER -</p>	<div style="text-align: center;"> <p>THE CITY OF WINNIPEG WATER AND WASTE DEPARTMENT ENGINEERING DIVISION</p> <p>2016 SEWER MAIN RENEWALS BY CIPP LINING SPENCE STREET MH AT CUMBERLAND AVENUE TO MH AT NOTRE DAME AVENUE</p> </div> <table border="1" style="width: 100%; margin-top: 10px;"> <tr> <td style="width: 80%;">SHEET 67 OF 80</td> </tr> <tr> <td style="text-align: center;">CITY DRAWING NUMBER 11532</td> </tr> </table>	SHEET 67 OF 80	CITY DRAWING NUMBER 11532
DESIGNED BY	SC	CHECKED BY	SC																																	
DRAWN BY	RJ	APPROVED BY	KZ																																	
SCALE:	1:750	RELEASED FOR CONSTRUCTION	K. ZURIK																																	
HORIZONTAL																																				
VERTICAL																																				
DATE	2017 02 16	DATE	2017 02 15																																	
PLOT DATE:	2017 02 16																																			
SHEET 67 OF 80																																				
CITY DRAWING NUMBER 11532																																				