

WEST APPROACH SLAB
SHOWING CONCRETE BOTTOM REINFORCING
FOR CONCRETE TOP REINFORCING SEE EAST APPROACH PLAN

APPROACH PLAN
1:75

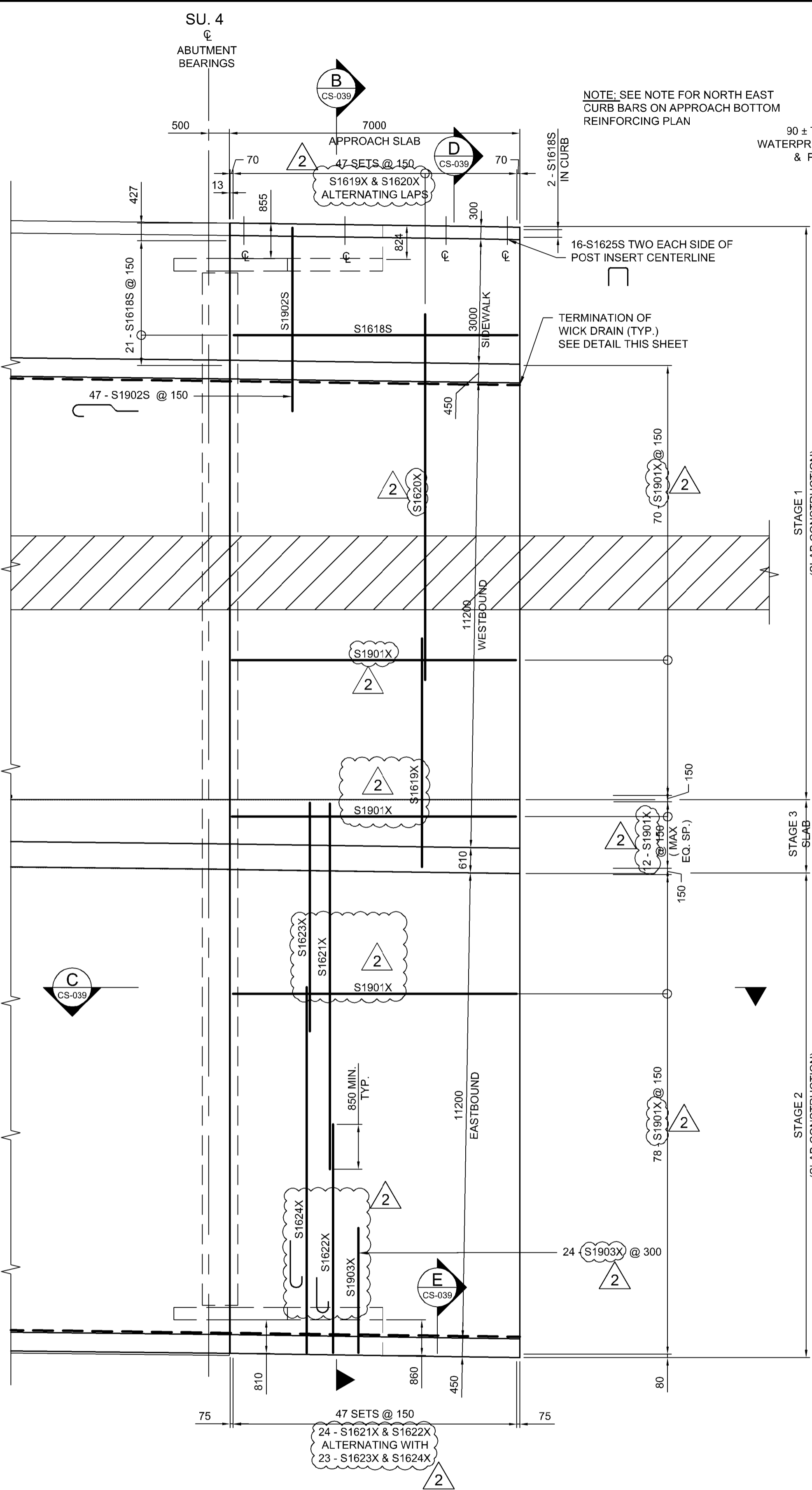

EAST APPROACH SLAB
SHOWING CONCRETE TOP REINFORCING
FOR CONCRETE BOTTOM REINFORCING SEE WEST APPROACH PLAN

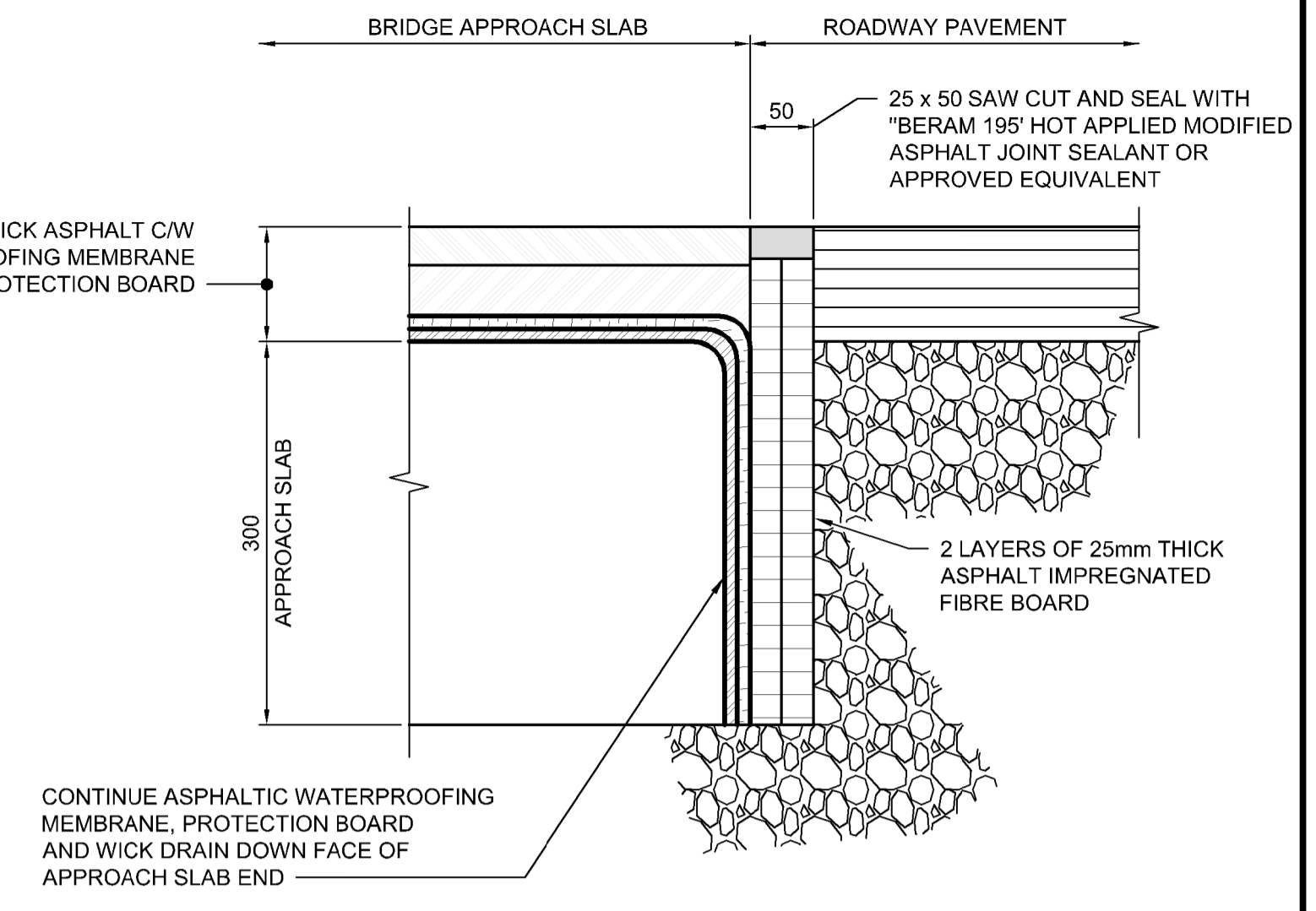

WICK DRAIN TERMINATION DETAIL
1:5

G:\CAD\175932\Drawings\Structural\BRIDGE\CON-CO-APPROACH-SLAB 1.dwg

APEGM
Certificate of Authorization
Dillon Consulting Limited (MB)
No. 1789 Date: 2018/02/09

DESIGNED BY	MS	CHECKED BY	SSR
DRAWN BY	NBG / DB	APPROVED BY	MBL
HOR. SCALE	AS SHOWN	RELEASED FOR CONSTRUCTION	
VERTICAL SCALE	AS SHOWN		
NO. REVISIONS	DATE	BY	DATE
1	ADDENDUM #2		18/02/22 DRA
0	ISSUED FOR TENDER		18/02/09 DRA
			2018/02/09

ENGINEER'S SEAL
PROVINCE OF MANITOBA
D.R.C. AMORIM
Member
33215
REGISTERED PROFESSIONAL ENGINEER
CONSULTANT PROJECT NUMBER
17-5932

THE CITY OF WINNIPEG
PUBLIC WORKS DEPARTMENT
FERMOR AVENUE BRIDGE OVER SEINE RIVER
BRIDGE REHABILITATION, PEDESTRIAN-CYCLIST UNDERPASS STRUCTURE
AND ROADWORKS FROM ST. ANNE'S ROAD TO ARCHIBALD STREET
CITY DRAWING NUMBER
B-118-2017-CS-038
SHEET
038 OF 100
CONSULTANT DRAWING NUMBER
CS-038