

STAGE 1A (2018)

1:100

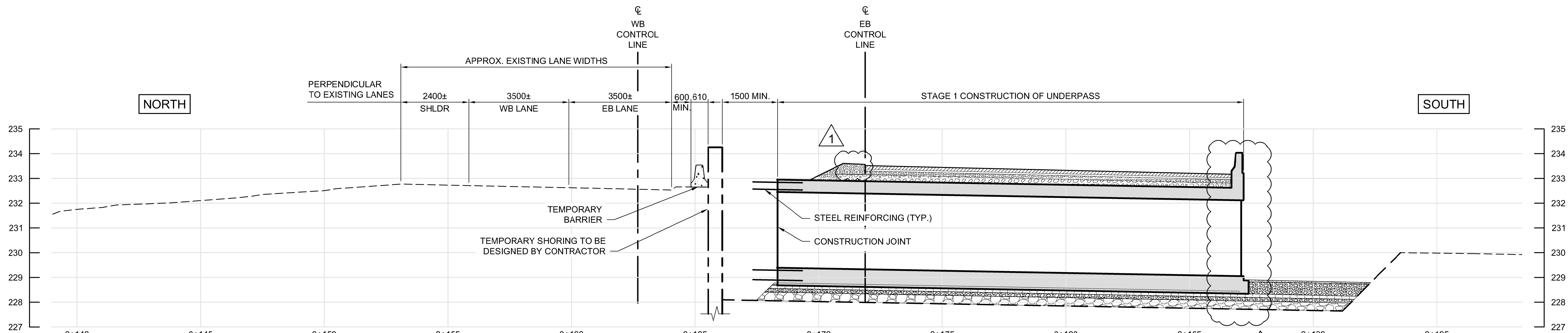

STAGE 1B (2018)

1:100

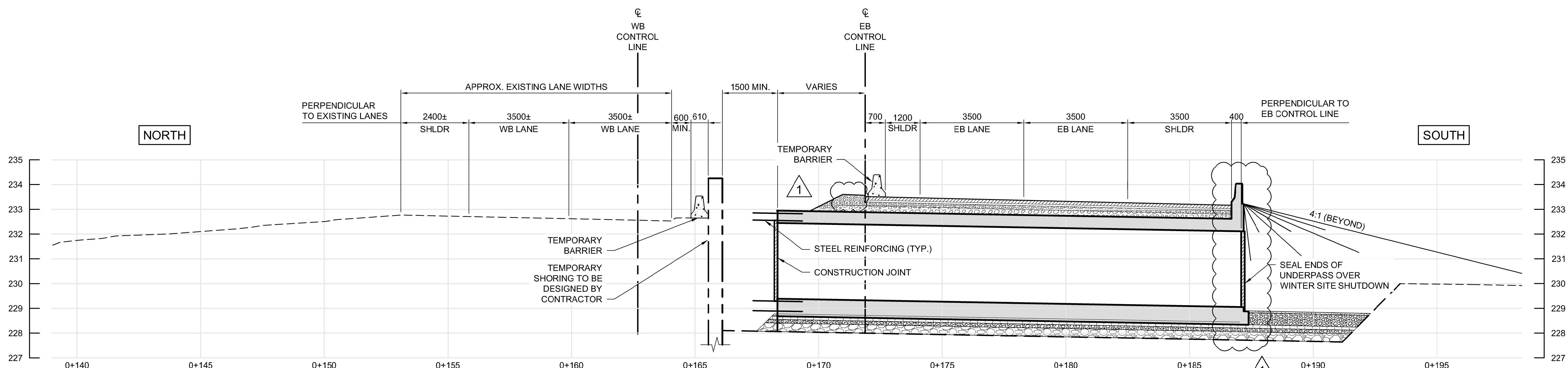

STAGE 1C - WINTER SITE SHUTDOWN (2018-2019)

1:100

NOTES:

1. THE INTENT OF THIS DRAWING IS TO SHOW THE INTENDED CONSTRUCTION SEQUENCING FOR THE PROPOSED PEDESTRIAN-CYCLIST UNDERPASS.
2. THESE DRAWINGS SHALL BE READ IN CONJUNCTION WITH THE ROADWORKS STAGING DRAWINGS (CT-010 TO CT-021).
3. SEQUENCE OF WORK:
 - 3.1. STAGE 1A (2018): DIVERT TRAFFIC TO EXISTING WESTBOUND LANES TO ALLOW FOR STAGE 1 CONSTRUCTION. INSTALL TEMPORARY SHORING AS REQUIRED (DESIGN BY CONTRACTOR). EXCAVATE FOR STAGE 1 UNDERPASS CONSTRUCTION.
 - 3.2. STAGE 1B (2018): COMPLETE STAGE 1 UNDERPASS WORKS INCLUDING SOUTH WING WALL, BACKFILL AND COMPLETE ROADWORKS AS PER ROADWORKS STAGING DRAWINGS.
 - 3.3. STAGE 1C - WINTER SITE SHUTDOWN (2018-2019): INSTALL TEMPORARY PRECAST CONCRETE BARRIERS AND RESUME EASTBOUND TRAFFIC OVER NEWLY CONSTRUCTED STAGE 1 UNDERPASS AND WESTBOUND TRAFFIC ON EXISTING WESTBOUND LANES. ALL LANES TO REMAIN IN OPERATION OVER WINTER SITE SHUTDOWN.
 - 3.4. STAGE 2A (2019): DIVERT TRAFFIC TO EASTBOUND LANES OVER NEWLY CONSTRUCTED UNDERPASS. EXCAVATE FOR STAGE 2 UNDERPASS CONSTRUCTION. PLACE CONCRETE APPROACH SLAB AND COMPLETE ASPHALT PATHWAY ON THE SOUTH SIDE.
 - 3.5. STAGE 2B (2019): COMPLETE STAGE 2 UNDERPASS WORKS INCLUDING NORTH WING WALL, ADJUST TEMPORARY SHORING AS REQUIRED TO COMPLETE WORK AT UNDERPASS. PLACE CONCRETE APPROACH SLAB AND COMPLETE ASPHALT PATHWAY ON THE NORTH SIDE.
 - 3.6. STAGE 2C (2019): REMOVE REMAINING TEMPORARY SHORING AND RESTORE TRAFFIC TO FINAL PROPOSED CONFIGURATION.

G:\CAD\175932\Drawings\Structural\Underpass\CON-CON-STAGING.dwg



NO.	REVISIONS	DATE	BY
1	ADDENDUM #5	18/03/16	DRA
0	ISSUED FOR TENDER	18/02/09	DRA

DESIGNED BY	DRA	CHECKED BY	SSR
DRAWN BY	CGC	APPROVED BY	MBL
HOR. SCALE	AS SHOWN	RELEASED FOR CONSTRUCTION	
VERTICAL	AS SHOWN		
DATE	2018/02/09	DATE	

ENGINEER'S SEAL
 PROVINCE OF MANITOBA
 D.R.C. AMORIM
 Member 33215
 REGISTERED PROFESSIONAL ENGINEER
 CONSULTANT PROJECT NUMBER
 17-5932

THE CITY OF WINNIPEG
 PUBLIC WORKS DEPARTMENT
Winnipeg
FERMOR AVENUE BRIDGE OVER SEINE RIVER
 BRIDGE RE-HABILITATION, PEDESTRIAN-CYCLIST UNDERPASS STRUCTURE AND ROADWORKS FROM ST. ANNE'S ROAD TO ARCHIBALD STREET
 PEDESTRIAN-CYCLIST UNDERPASS STAGES 1A, 1B & 1C
 CITY DRAWING NUMBER U-243-2017-CS-066
 SHEET 066 OF 100
 CONSULTANT DRAWING NUMBER CS-066