

STAGE 2A (2019)  
1:100

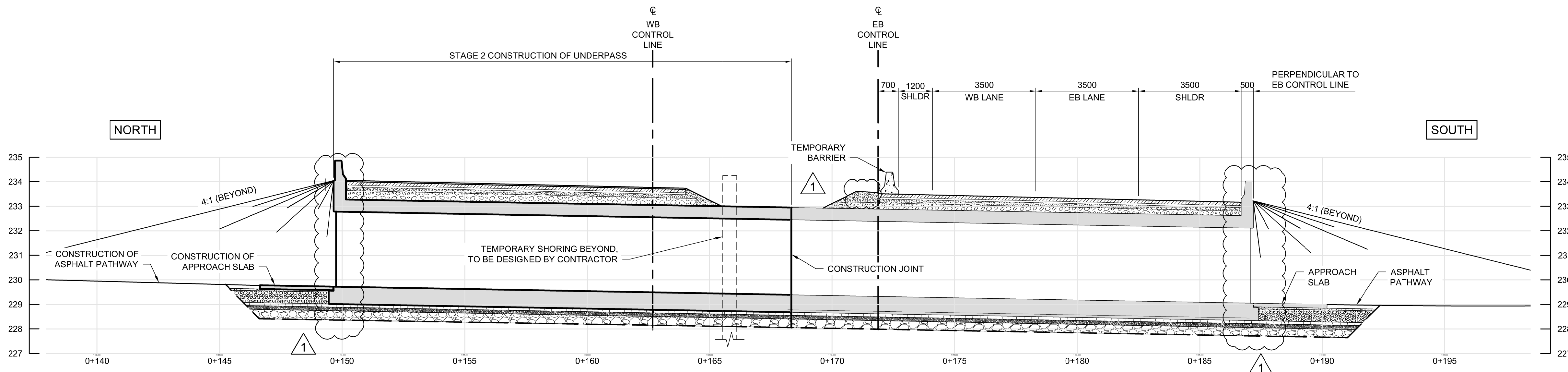

STAGE 2B (2019)  
1:100

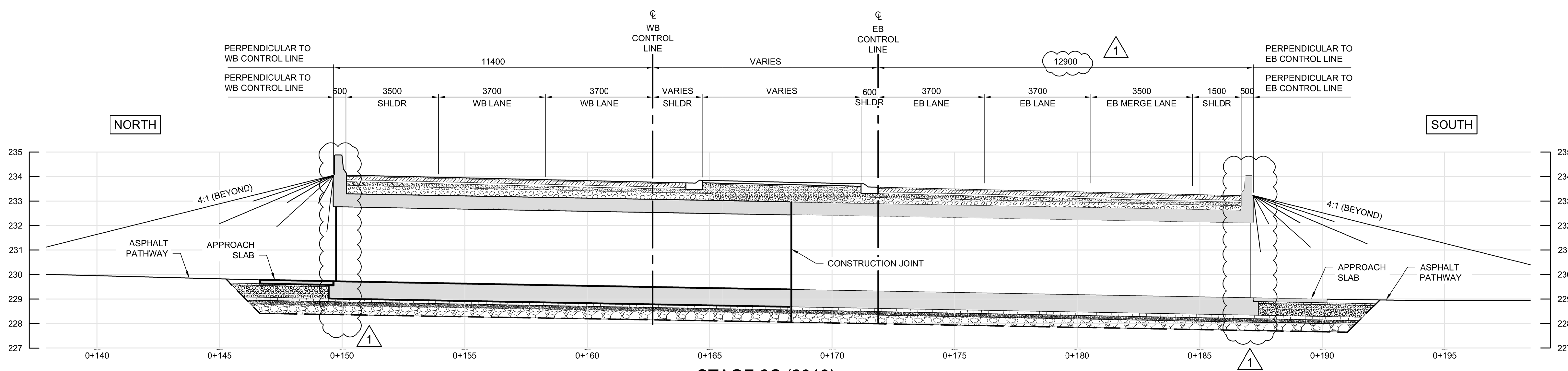

STAGE 2C (2019)  
1:100

**NOTES:**

1. THE INTENT OF THIS DRAWING IS TO SHOW THE INTENDED CONSTRUCTION SEQUENCING FOR THE PROPOSED PEDESTRIAN-CYCLIST UNDERPASS.
2. THESE DRAWINGS SHALL BE READ IN CONJUNCTION WITH THE ROADWORKS STAGING DRAWINGS (CT-010 TO CT-021).
3. SEQUENCE OF WORK:
  - 3.1. **STAGE 1A (2018):** DIVERT TRAFFIC TO EXISTING WESTBOUND LANES TO ALLOW FOR STAGE 1 CONSTRUCTION. INSTALL TEMPORARY SHORING AS REQUIRED (DESIGN BY CONTRACTOR). EXCAVATE FOR STAGE 1 UNDERPASS CONSTRUCTION.
  - 3.2. **STAGE 1B (2018):** COMPLETE STAGE 1 UNDERPASS WORKS INCLUDING SOUTH WING WALL, BACKFILL AND COMPLETE ROADWORKS AS PER ROADWORKS STAGING DRAWINGS.
  - 3.3. **STAGE 1C - WINTER SITE SHUTDOWN (2018-2019):** INSTALL TEMPORARY PRECAST CONCRETE BARRIERS AND RESUME EASTBOUND TRAFFIC OVER NEWLY CONSTRUCTED STAGE 1 UNDERPASS AND WESTBOUND TRAFFIC ON EXISTING WESTBOUND LANES. ALL LANES TO REMAIN IN OPERATION OVER WINTER SITE SHUTDOWN.
  - 3.4. **STAGE 2A (2019):** DIVERT TRAFFIC TO EASTBOUND LANES OVER NEWLY CONSTRUCTED UNDERPASS. EXCAVATE FOR STAGE 2 UNDERPASS CONSTRUCTION. PLACE CONCRETE APPROACH SLAB AND COMPLETE ASPHALT PATHWAY ON THE SOUTH SIDE.
  - 3.5. **STAGE 2B (2019):** COMPLETE STAGE 2 UNDERPASS WORKS INCLUDING NORTH WING WALL, ADJUST TEMPORARY SHORING AS REQUIRED TO COMPLETE WORK AT UNDERPASS. PLACE CONCRETE APPROACH SLAB AND COMPLETE ASPHALT PATHWAY ON THE NORTH SIDE.
  - 3.6. **STAGE 2C (2019):** REMOVE REMAINING TEMPORARY SHORING AND RESTORE TRAFFIC TO FINAL PROPOSED CONFIGURATION.

G:\CAD\175932\Drawings\Structural\Underpass\CON-STAGING.dwg



NO.	REVISIONS	DATE	BY
1	ADDENDUM #5	18/03/16	DRA
0	ISSUED FOR TENDER	18/02/09	DRA

DESIGNED BY	DRA	CHECKED BY	SSR
DRAWN BY	CGC	APPROVED BY	MBL
HOR. SCALE	AS SHOWN	RELEASED FOR CONSTRUCTION	
VERTICAL	AS SHOWN		
DATE	2018/02/09	DATE	

ENGINEER'S SEAL  
 PROVINCE OF MANITOBA  
**D.R.C. AMORIM**  
 Member  
 33215  
 REGISTERED PROFESSIONAL ENGINEER  
 CONSULTANT PROJECT NUMBER  
 17-5932

**THE CITY OF WINNIPEG**  
 PUBLIC WORKS DEPARTMENT  
**Winnipeg**  
**FERMOR AVENUE BRIDGE OVER SEINE RIVER**  
 BRIDGE RE-ABILITATION, PEDESTRIAN-CYCLIST UNDERPASS STRUCTURE  
 AND ROADWORKS FROM ST. ANNE'S ROAD TO ARCHIBALD STREET  
 PEDESTRIAN-CYCLIST UNDERPASS  
 STAGES 2A, 2B & 2C  
 CITY DRAWING NUMBER  
 U-243-2017-CS-067  
 SHEET 067 OF 100  
 CONSULTANT DRAWING NUMBER  
 CS-067