

WWS CONNECTION TO MH 070A

NOTE: CHAINAGES SHOWN ARE ALONG CL OF PROPOSED PIPE

WARNING
 IF POWER EQUIPMENT OR EXPLOSIVES ARE TO BE USED FOR EXCAVATION ON THIS PROJECT THE CONTRACTOR MUST:
 1) NOTIFY THE GAS COMPANY OF THE PROPOSED LOCATION OF EXCAVATION.
 2) TAKE PRECAUTION TO AVOID DAMAGE TO GAS COMPANY INSTALLATIONS.
 SEE PROVINCIAL REGULATION 210/72 FOR DETAILS.

- CONSTRUCTION NOTES:**
- SEWER AND WATER SERVICES SHOWN ON DRAWING ARE APPROXIMATE ONLY.
 - LOCATION OF ALL SEWER AND WATER LINES TO BE CONFIRMED IN FIELD.
 - INSTALL NEW SEWER BY TRENCHLESS METHODS, UNLESS OTHERWISE NOTED.
 - FRONT ACCESS TO ALL WAYOATA STREET PROPERTIES TO BE MAINTAIN AT ALL TIMES DURING CONSTRUCTION PERIOD.
 - REFER TO CONTRACT SPECIFICATION FOR TRAFFIC ACCOMMODATION AT INTERSECTION OF WAYOATA STREET AND KILDARE AVENUE.

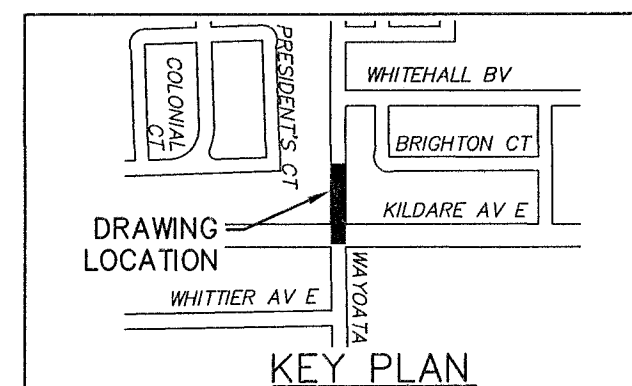
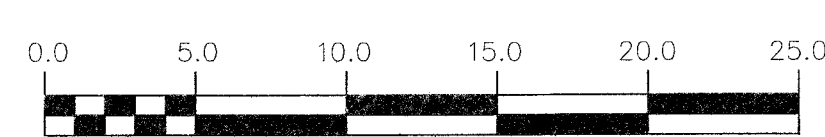
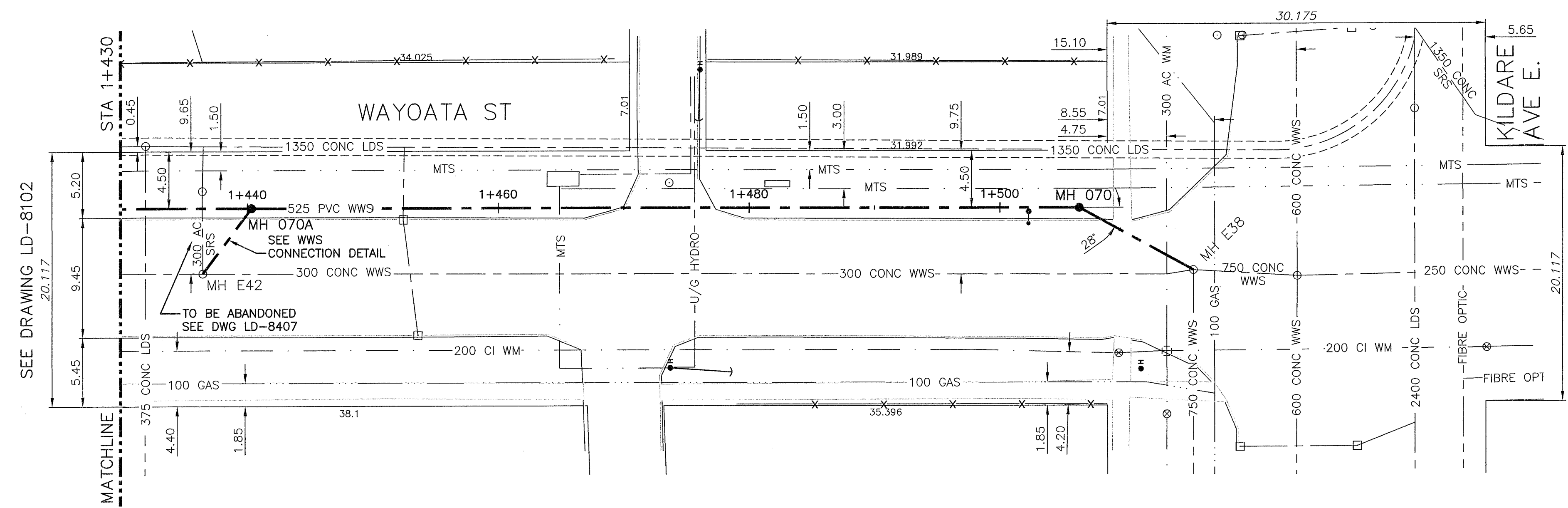

200 WM	WATERMAIN	200 WM	SL, HYDRO	150 WM	WATERMAIN	150 WM
⊕	HYDRANT	⊕	MTS	⊕	HYDRANT	⊕
⊕	VALVE	⊕	TRAFFIC SIGNALS	⊕	VALVE	⊕
—	LAND DRAINAGE SEWER	—	GAS	—	LAND DRAINAGE SEWER	—
—	WASTEWATER SEWER	—	SURVEY BAR	—	WASTEWATER SEWER	—
○	MANHOLE	●	FENCE	—	⊕ PROFILE	—
□	CATCH BASIN	■	POLE - HYDRO, MTS	—	GROUND ABOVE PIPE	—
▽	CURB INLET	▽	CURB STOP	—		
—	JUNCTIONS	—	GUY ANCHOR	—		
—	CULVERT	—	LIGHT STANDARD	—		
—	ANODE	—	TREE	—		
—	EXISTING	—	LEGEND-PLAN	—	LEGEND-PROFILE	—
—	LEGEND-PLAN	—	PROPOSED	—	PROPOSED	—

LOCATION APPROVED UNDERGROUND STRUCTURES

DESIGNED BY: MAF
 CHECKED BY: MD

DRAWN BY: JBC
 APPROVED BY: [Signature]

SCALE: HORIZONTAL 1:250
 VERTICAL 1:50

ISSUED FOR TENDER: 11/17 JBC
 REVISIONS: [Table with columns for NO., REVISIONS, DATE, BY]

NOTE:
 LOCATION OF UNDERGROUND STRUCTURES AS SHOWN ARE BASED ON THE BEST INFORMATION AVAILABLE BUT NO GUARANTEE IS GIVEN THAT ALL EXISTING UTILITIES ARE SHOWN OR THAT THE GIVEN LOCATIONS ARE EXACT. CONFIRMATION OF EXISTENCE AND EXACT LOCATION OF ALL SERVICES MUST BE OBTAINED FROM THE INDIVIDUAL UTILITIES BEFORE PROCEEDING WITH CONSTRUCTION.

ch2m

DESIGNED BY: MAF
 CHECKED BY: MD

DRAWN BY: JBC
 APPROVED BY: [Signature]

SCALE: HORIZONTAL 1:250
 VERTICAL 1:50

ISSUED FOR TENDER: 11/17 JBC
 REVISIONS: [Table with columns for NO., REVISIONS, DATE, BY]

DATE: 2017 11 02



THE CITY OF WINNIPEG
 WATER AND WASTE DEPARTMENT
 ENGINEERING DIVISION

TRANSCONA SEWER RELIEF WORKS
 CONTRACT NO. 4
 WAYOATA STREET
 FROM STA 1+430 TO
 KILDARE AVE E.

SHEET 8 OF 19
 CITY DRAWING NUMBER
 LD-8103

CONSULTANT DRAWING NUMBER: C-249

FILE PATH: C:\pwworkdir\den001\jcoritez\dl184428\ C-249.dwg