

NOTE: CHAINAGES SHOWN ARE ALONG CL OF PROPOSED PIPE

**WARNING**  
 IF POWER EQUIPMENT OR EXPLOSIVES ARE TO BE USED FOR EXCAVATION ON THIS PROJECT THE CONTRACTOR MUST:  
 1) NOTIFY THE GAS COMPANY OF THE PROPOSED LOCATION OF EXCAVATION.  
 2) TAKE PRECAUTION TO AVOID DAMAGE TO GAS COMPANY INSTALLATIONS.  
 SEE PROVINCIAL REGULATION 210/72 FOR DETAILS

- CONSTRUCTION NOTES:**
- SEWER AND WATER SERVICES SHOWN ON DRAWING ARE APPROXIMATE ONLY.
  - LOCATION OF ALL SEWER AND WATER LINES TO BE CONFIRMED IN FIELD.
  - INSTALL NEW SEWER BY TRENCHLESS METHODS, UNLESS OTHERWISE NOTED.
  - EXISTING SERVICE CONNECTIONS (FROM WEST ONLY) THAT ARE FOUND TO BE IN DIRECT CONFLICT WITH THE NEW RELIEF SEWER ARE TO BE RECONNECTED TO NEW 375 WWS PIPE. THE EXISTING SERVICES ARE TO BE PLUGGED/ABANDONED AS PER CITY OF WINNIPEG STANDARD SPECIFICATIONS. THE CONTRACTOR IS RESPONSIBLE TO CONFIRM ALIGNMENT AND DEPTH OF EXISTING SERVICES PRIOR TO INSTALLATION OF NEW 375 WWS RELIEF PIPE.

DISTANCE FROM MH ID E48		
DISTANCE	DIAMETER	CLOCK
9.7	150	1
24.9	150	1
41.9	150	1
57.7	150	11
75.6	150	11
87.6	150	11

ALL EXISTING LIVE SEWER SERVICES FOUND TO BE IN CONFLICT, TO BE RENEWED ONLY OVER 1m FROM NEW 375 WWS. REFER TO SPECIFICATION CLAUSE E27 FOR FULL RENEWAL/ABANDONMENT DETAILS

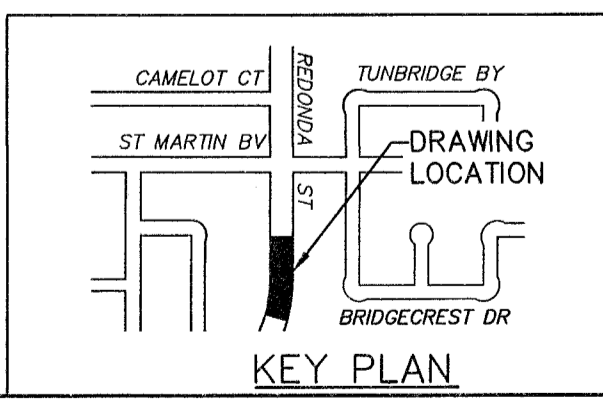
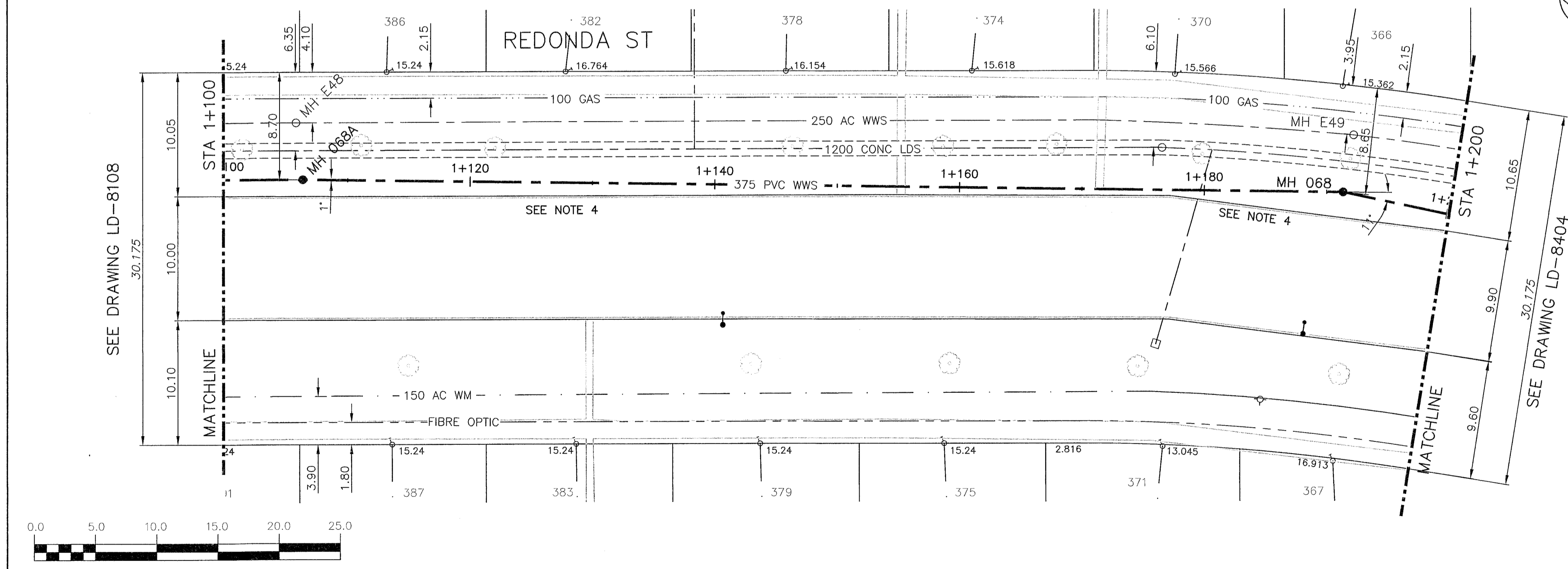
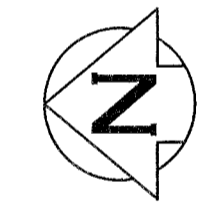

200 WM	WATERMAIN	200 WM	SL, HYDRO	150 WM	WATERMAIN	150 WM
⊕	HYDRANT	⊕	MTS	⊕	HYDRANT	⊕
⊕	VALVE	⊕	TRAFFIC SIGNALS	⊕	VALVE	⊕
---	525 LDS LAND DRAINAGE SEWER	---	GAS	---	50 GAS	---
---	375 WWS WASTEWATER SEWER	---	SURVEY BAR	---	300 LOS LAND DRAINAGE SEWER	---
○	MANHOLE	○	FENCE	---	250 WWS WASTEWATER SEWER	---
□	CATCH BASIN	□	POLE - HYDRO, MTS	---	⊕ PROFILE	---
▽	CURB INLET	▽	CURB STOP	---	GROUND ABOVE PIPE	---
+	JUNCTIONS	+	GUY ANCHOR	---		---
⊔	CULVERT	⊔	LIGHT STANDARD	---		---
⊔	ANODE	⊔	TREE	---		---
---	EXISTING	---	LEGEND-PLAN	---	LEGEND-PROFILE	---
---	PROPOSED	---	LEGEND-PLAN	---	PROPOSED	---

**LOCATION APPROVED UNDERGROUND STRUCTURES**

DATE: \_\_\_\_\_

NOTE: LOCATION OF UNDERGROUND STRUCTURES AS SHOWN ARE BASED ON THE BEST INFORMATION AVAILABLE BUT NO GUARANTEE IS GIVEN THAT ALL EXISTING UTILITIES ARE SHOWN OR THAT THE GIVEN LOCATIONS ARE EXACT. CONFIRMATION OF EXISTENCE AND EXACT LOCATION OF ALL SERVICES MUST BE OBTAINED FROM THE INDIVIDUAL UTILITIES BEFORE PROCEEDING WITH CONSTRUCTION.

DESIGNED BY	CHECKED BY
MAF	MD
DRAWN BY	APPROVED BY
JBC	<i>[Signature]</i>
SCALE: HORIZONTAL 1:250	RELEASED FOR CONSTRUCTION
VERTICAL 1:50	DATE: <i>[Signature]</i>



**THE CITY OF WINNIPEG**  
 WATER AND WASTE DEPARTMENT  
 ENGINEERING DIVISION

TRANSCONA SEWER RELIEF WORKS  
 CONTRACT NO. 4  
 REDONDA STREET  
 FROM STA 1+100 TO 1+200

SHEET 14 OF 19  
 CITY DRAWING NUMBER  
 LD-8109