

PROFILE - SASKATCHEWAN AVENUE - STA 0+061.905 TO 0+250

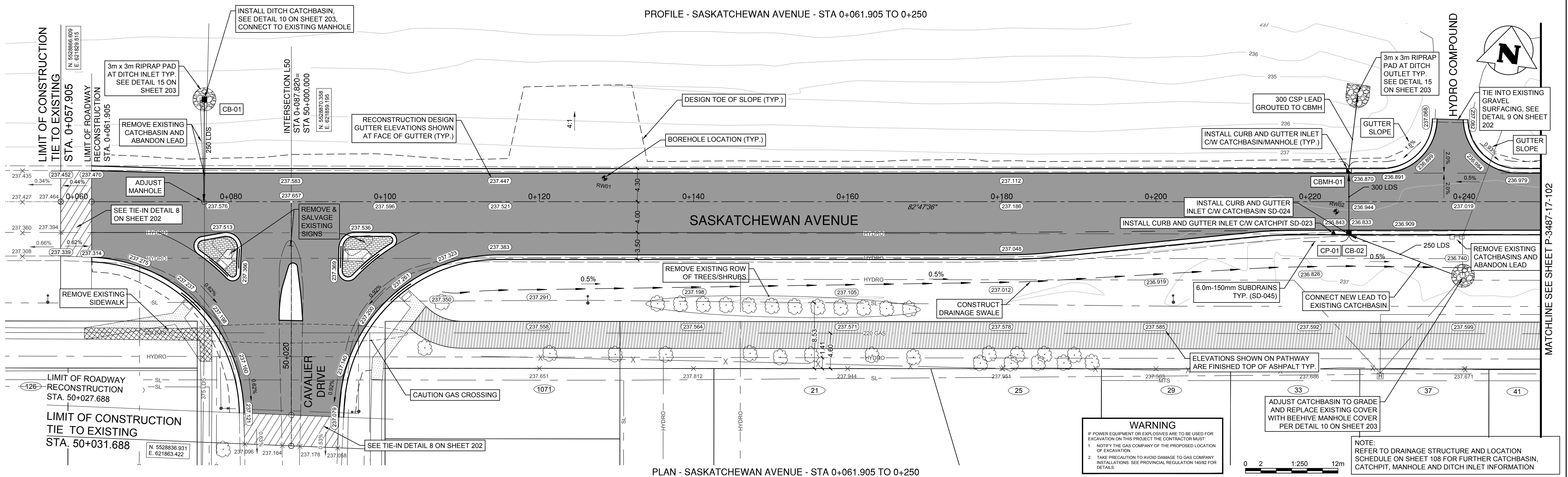

PLAN - SASKATCHEWAN AVENUE - STA 0+061.905 TO 0+250

150 WM	WATERMAIN	150 WM	SWALE	RIGHT-OF-WAY
400 FM	FEEDERMAIN	400 FM	MANHOLE	GAS
300 LDS	LAND DRAINAGE SEWER	300 LDS	CATCHBASIN	HYDRO
250 WWS	WASTEWATER SEWER	250 WWS	CATCHPIT	MTS
300 CS	COMBINED SEWER	300 CS	CATCHBASIN MANHOLE	DETECTABLE WARNING TILE
200 FCM	FORCEMAIN	200 FCM	HYDRO BOX	ELEVATION
	JUNCTIONS		HYDRO POLE	SIDEWALK
	HYDRANT		HYDRO STANDARD	CURB
	VALVE		ANCHOR	ASPHALT
	CURB STOP		TREE	CONCRETE
EXISTING	LEGEND-PLAN	PROPOSED	LEGEND-PLAN	PROPOSED

LOCATION APPROVED UNDERGROUND STRUCTURES

SUPV. U/G STRUCTURES COMMITTEE

NOTE: LOCATION OF UNDERGROUND STRUCTURES AS SHOWN ARE BASED ON THE BEST INFORMATION AVAILABLE. BUT NO GUARANTEE IS GIVEN THAT ALL EXISTING UTILITIES ARE SHOWN OR THAT THE GIVEN LOCATIONS ARE EXACT. CONFIRMATION OF EXISTENCE AND EXACT LOCATION OF ALL SERVICES MUST BE OBTAINED FROM THE INDIVIDUAL UTILITIES BEFORE PROCEEDING WITH CONSTRUCTION.

B.M.	CITY OF WINNIPEG 40-42
ELEV.	238.985
NO.	ISSUED FOR TENDER
NO.	REVISIONS
DATE	17.10.04
DATE	17.10.04

TETRA TECH

DESIGNED BY: DRA
DRAWN BY: MT
CHECKED BY: AF
APPROVED BY: EFS
ACCEPTED BY: [Signature]
DATE: 17.10.04

PROVINCE OF MANITOBA
REGISTERED PROFESSIONAL ENGINEER
D.R. ALEXANDER
ORIGINAL SIGNED 17.10.04
41334

THE CITY OF WINNIPEG
PUBLIC WORKS DEPARTMENT
ENGINEERING DIVISION

SASKATCHEWAN AT STURGEON CREEK
BRIDGE CONSTRUCTION

SASKATCHEWAN AVENUE ROADWORKS
PLAN, PROFILE & UTILITIES

CITY DRAWING NUMBER: P-3487-17-101
SHEET 49 OF 69

CONSULTANT DRAWING NO.: 1600070700-C049