

STA 1+840.00 LOOKING EAST

NOTE: LOCATIONS ARE APPROXIMATE AND FURTHER INVESTIGATION TO CONFIRM LOCATION MAYBE REQUIRED BY THE CONTRACTOR.

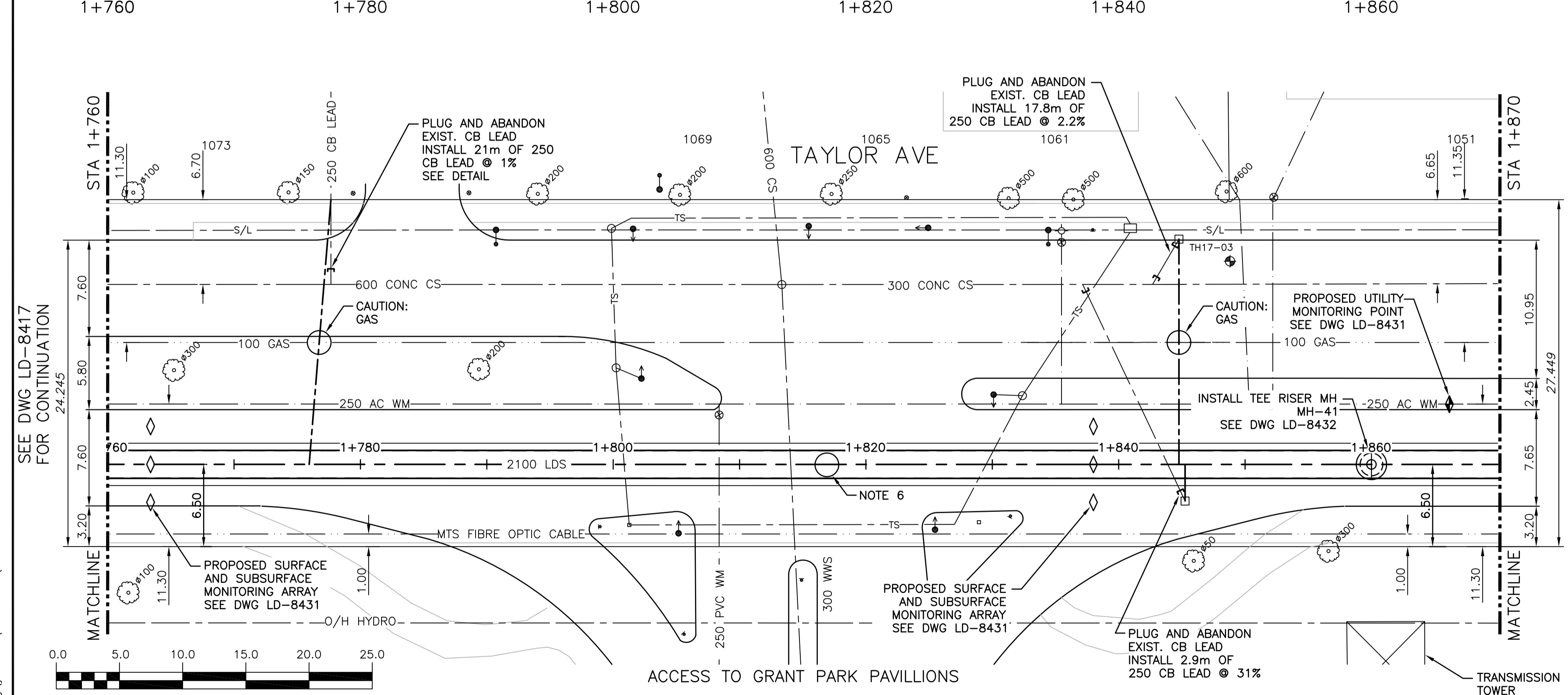

**WARNING**  
IF POWER EQUIPMENT OR EXPLOSIVES ARE TO BE USED FOR EXCAVATION ON THIS PROJECT THE CONTRACTOR MUST:  
1) NOTIFY THE GAS COMPANY OF THE PROPOSED LOCATION OF EXCAVATION.  
2) TAKE PRECAUTION TO AVOID DAMAGE TO GAS COMPANY INSTALLATIONS.  
SEE PROVINCIAL REGULATION 210/72 FOR DETAILS

**PROPERTY LIMITS DELINEATION**  
DELINEATION OF PROPERTY LIMITS AS SHOWN ON THIS DRAWING DOES NOT REPRESENT A "LEGAL SURVEY". CH2M HILL MAKES NO REPRESENTATION OR WARRANTY AS TO THE ACCURACY OF PROPERTY LIMITS DELINEATED ON THIS DRAWING, NOR ON THE DIMENSIONAL ACCURACY OF DRAWING FEATURES RELATIVE TO THOSE PROPERTY LIMITS.

- CONSTRUCTION NOTES:**
- SEWER AND WATER SERVICES SHOWN ON DRAWING ARE APPROXIMATE ONLY.
  - LOCATION OF ALL SEWER AND WATER LINES TO BE CONFIRMED IN FIELD.
  - INSTALL NEW SEWER BY TRENCHLESS METHODS, UNLESS OTHERWISE NOTED.
  - TRAFFIC MANAGEMENT PLAN TO BE IMPLEMENTED AS PER SPECIFICATIONS DURING EACH PHASE OF CONTRACT.
  - TEMPORARY MANHOLE TEE RISER SHAFT TO BE CONSTRUCTED PRIOR TO TUNNEL INSTALL. REFER TO DRAWING LD-8432.
  - PRE AND POST CCTV OF WWS CROSSINGS.

150 WM	WATER MAIN	150 WM	HYDRO	150 WM	WATER MAIN	150 WM
Hydrant	HYDRANT	Valve	M.T.S.	Hydrant, Valve	HYDRANT, VALVE	Hydrant, Valve
300 LDS	LAND DRAINAGE SEWER	300 LDS	CONCRETE	300 LDS	LAND DRAINAGE SEWER	300 LDS
250 WWS	WASTE WATER SEWER	250 WWS	ASPHALT	250 WWS	WASTE WATER SEWER	250 WWS
Manhole	MANHOLE	Catch Basin	SIDEWALK	Centreline	CATCH BASIN	Centreline
Curb Inlet	CURB INLET	Curb Stop	PLANNING	North/West Gutter	CURB INLET	North/West Gutter
Bend	BEND	TEE	PROPERTY LINE	South/East Gutter	BEND	South/East Gutter
Reducer	REDUCER	Survey Bar	SURVEY BAR	N/W, S/E R'S	REDUCER	N/W, S/E R'S
Existing	LEGEND-PLAN	Proposed	GAS	Curb Stop	Existing	LEGEND-PROFILE
Existing	LEGEND-PLAN	Proposed	Curb Stop	TEE	Existing	LEGEND-PROFILE
Existing	LEGEND-PLAN	Proposed	TEE	Proposed	Existing	LEGEND-PROFILE

**LOCATION APPROVED UNDERGROUND STRUCTURES**

SUPV. U/G STRUCTURES COMMITTEE DATE

NOTE: LOCATION OF UNDERGROUND STRUCTURES AS SHOWN ARE BASED ON THE BEST INFORMATION AVAILABLE BUT NO GUARANTEE IS GIVEN THAT ALL EXISTING UTILITIES ARE SHOWN OR THAT THE GIVEN LOCATIONS ARE EXACT. CONFIRMATION OF EXISTENCE AND EXACT LOCATION OF ALL SERVICES MUST BE OBTAINED FROM THE INDIVIDUAL UTILITIES BEFORE PROCEEDING WITH CONSTRUCTION.

B	ISSUED FOR RFQ	11/2017	JBC
A	ISSUED FOR REVIEW	10/2017	JBC
NO.	REVISIONS	DATE	BY

**KGS GROUP CONSULTING ENGINEERS**

DESIGNED BY: SDG  
DRAWN BY: JBC

CHECKED BY: MD  
APPROVED BY:

HOR. SCALE: 1:250  
VERTICAL: 1:50

RELEASED FOR CONSTRUCTION: DATE

ENGINEER'S SEAL

PRELIMINARY  
NOT FOR CONSTRUCTION

CONSULTANT DRAWING NO.  
C-244

**THE CITY OF WINNIPEG WATER AND WASTE DEPARTMENT**

PROJECT TITLE  
COCKBURN AND CALROSSIE COMBINED SEWER RELIEF WORKS - CONTRACT 5

TAYLOR AVENUE  
FROM STA 1+760 TO STA 1+870

SHEET OF  
7 OF 25

COMPUTER FILE NAME  
C-244.dwg

CITY DRAWING NUMBER  
LD-8418

