

STA 2+430.00 LOOKING EAST

NOTE:  
LOCATIONS ARE APPROXIMATE AND FURTHER INVESTIGATION TO  
CONFIRM LOCATION MAYBE REQUIRED BY THE CONTRACTOR.

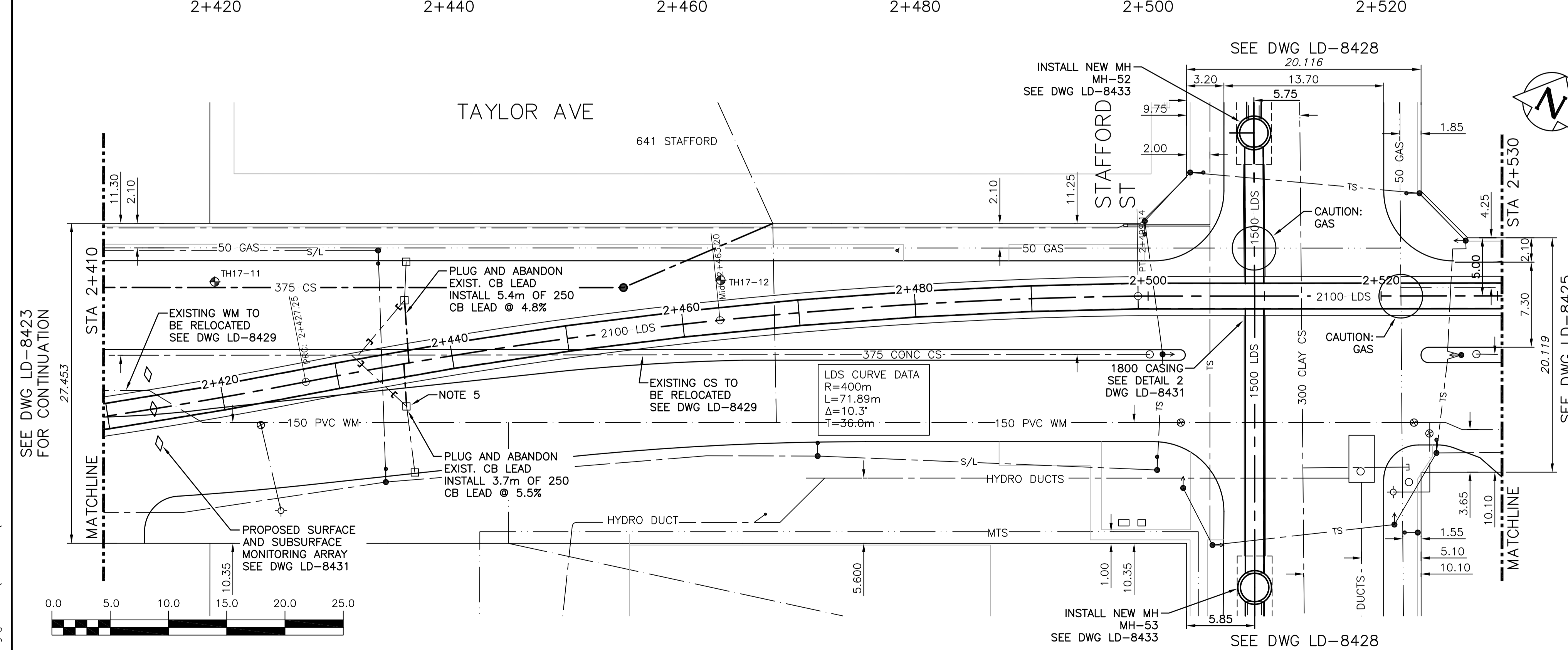

**WARNING**  
IF POWER EQUIPMENT OR EXPLOSIVES ARE TO BE USED FOR EXCAVATION  
ON THIS PROJECT THE CONTRACTOR MUST:  
1) NOTIFY THE GAS COMPANY OF THE PROPOSED LOCATION OF EXCAVATION.  
2) TAKE PRECAUTION TO AVOID DAMAGE TO GAS COMPANY INSTALLATIONS.  
SEE PROVINCIAL REGULATION 210/72 FOR DETAILS

**PROPERTY LIMITS DELINEATION**  
DELINEATION OF PROPERTY LIMITS AS SHOWN ON THIS  
DRAWING DOES NOT REPRESENT A "LEGAL SURVEY".  
CH2M HILL MAKES NO REPRESENTATION OR WARRANTY AS  
TO THE ACCURACY OF PROPERTY LIMITS DELINEATED ON  
THIS DRAWING, NOR ON THE DIMENSIONAL ACCURACY OF  
DRAWING FEATURES RELATIVE TO THOSE PROPERTY LIMITS.

- CONSTRUCTION NOTES:**
- SEWER AND WATER SERVICES SHOWN ON DRAWING ARE APPROXIMATE ONLY.
  - LOCATION OF ALL SEWER AND WATER LINES TO BE CONFIRMED IN FIELD.
  - INSTALL NEW SEWER BY TRENCHLESS METHODS, UNLESS OTHERWISE NOTED.
  - TRAFFIC MANAGEMENT PLAN TO BE IMPLEMENTED AS PER SPECIFICATIONS DURING EACH PHASE OF CONTRACT.
  - REPLACE SLOTTED MANHOLE LID WITH SOLID LID.

EXISTING	LEGEND-PLAN	PROPOSED	EXISTING	LEGEND-PLAN	PROPOSED	EXISTING	LEGEND-PROFILE	PROPOSED
150 WM	WATER MAIN	150 WM	HYDRO	M.T.S.	150 WM	WATER MAIN	150 WM	HYDRANT, VALVE
300 LDS	LAND DRAINAGE SEWER	300 LDS	CONCRETE	ASPHALT	300 LDS	LAND DRAINAGE SEWER	300 LDS	LAND DRAINAGE SEWER
250 WWS	WASTE WATER SEWER	250 WWS	SIDEWALK	PLANNING	250 WWS	WASTE WATER SEWER	250 WWS	WASTE WATER SEWER
MANHOLE	MANHOLE	MANHOLE	PROPERTY LINE	SURVEY BAR	MANHOLE	MANHOLE	MANHOLE	MANHOLE
CATCH BASIN	CATCH BASIN	CATCH BASIN	GAS	CURB STOP	CATCH BASIN	CATCH BASIN	CATCH BASIN	CATCH BASIN
CURB INLET	CURB INLET	CURB INLET	TEE	TEE	CURB INLET	CURB INLET	CURB INLET	CURB INLET
BEND	BEND	BEND			BEND	BEND	BEND	BEND
REDUCER	REDUCER	REDUCER			REDUCER	REDUCER	REDUCER	REDUCER

**LOCATION APPROVED UNDERGROUND STRUCTURES**

SUPV. U/G STRUCTURES COMMITTEE DATE

NOTE:  
LOCATION OF UNDERGROUND STRUCTURES AS SHOWN ARE BASED ON THE BEST INFORMATION AVAILABLE BUT NO GUARANTEE IS GIVEN THAT ALL EXISTING UTILITIES ARE SHOWN OR THAT THE GIVEN LOCATIONS ARE EXACT. CONFIRMATION OF EXISTENCE AND EXACT LOCATION OF ALL SERVICES MUST BE OBTAINED FROM THE INDIVIDUAL UTILITIES BEFORE PROCEEDING WITH CONSTRUCTION.

B.M. ELEV.	NO.	REVISIONS	DATE	BY
	B	ISSUED FOR RFQ	11/2017	JBC
	A	ISSUED FOR REVIEW	10/2017	

**KGS GROUP CONSULTING ENGINEERS**

DESIGNED BY: SDG  
DRAWN BY: JBC

CHECKED BY: MD  
APPROVED BY:

HOR. SCALE: 1:250  
VERTICAL: 1:50

RELEASED FOR CONSTRUCTION: DATE

ENGINEER'S SEAL

PRELIMINARY  
NOT FOR CONSTRUCTION

CONSULTANT DRAWING NO.  
C-250

**THE CITY OF WINNIPEG WATER AND WASTE DEPARTMENT**

PROJECT TITLE  
COCKBURN AND CALROSSIE COMBINED SEWER RELIEF WORKS - CONTRACT 5

TAYLOR AVENUE  
FROM STA 2+410 TO STA 2+530

SHEET OF  
13 OF 25

COMPUTER FILE NAME  
C-250.dwg

CITY DRAWING NUMBER  
LD-8424

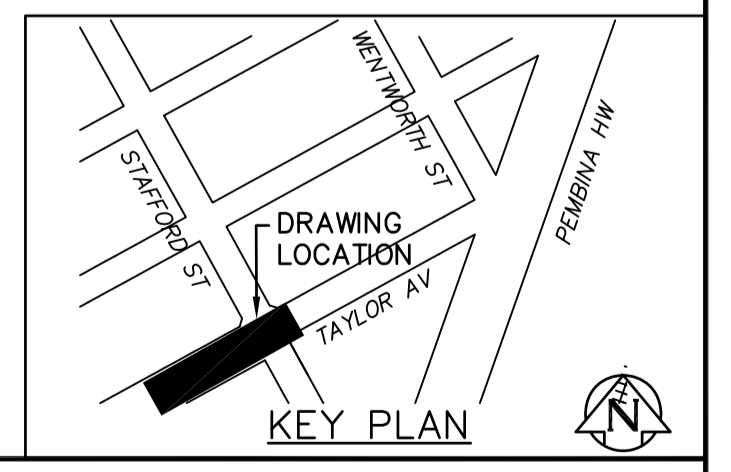

File name: C:\pw\_workdir\crt2mhill\_wbg\jcoritez\104366571