

STAGE 1 – INSTALL TEMPORARY 750 LDS

TRAFFIC CONTROLS IMPLEMENTED

- NO LEFT TURN – TAYLOR E/B
- MEDIAN LANE CLOSED – NATHANIEL N/B

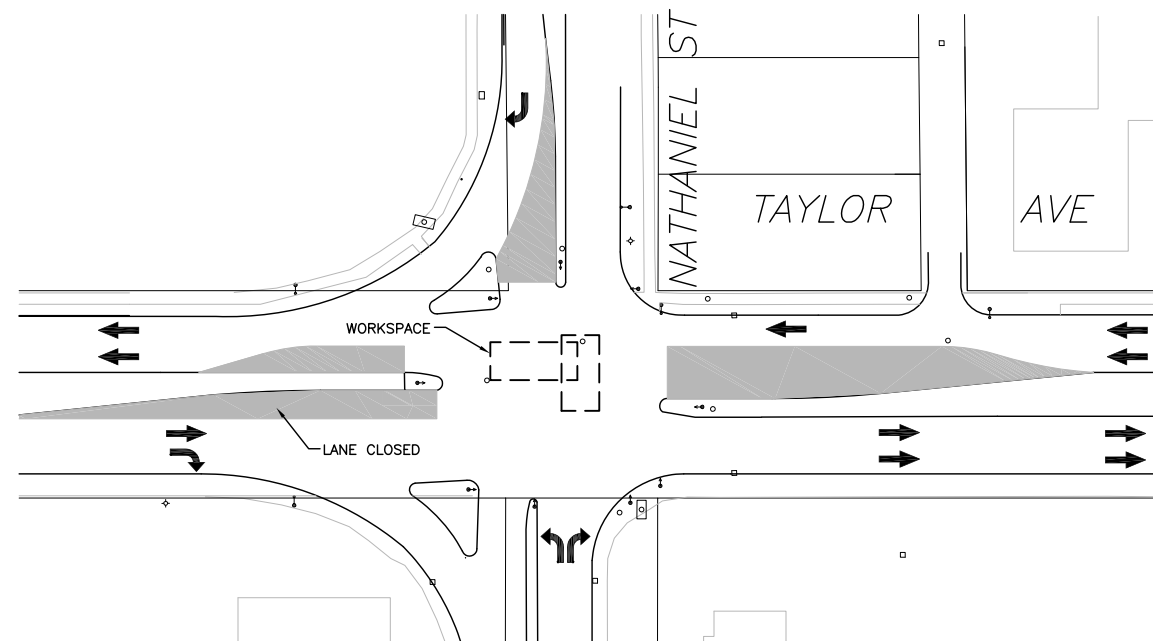

STAGE 2 – INSTALL TEMPORARY 375 LDS/ REMOVE EXISTING 750 CS

TRAFFIC CONTROLS IMPLEMENTED

- S/B NATHANIEL CLOSED – RIGHT TURN ONLY.
- N/B NATHANIEL CLOSED – LEFT OR RIGHT TURN ONLY.
- NO LEFT TURN – TAYLOR E/B
- NO LEFT TURN – TAYLOR W/B
- MEDIAN LANE CLOSED – TAYLOR W/B
- SIGNAGE REQUIRED AT GRANT AVE ABOUT NATHANIEL ST CLOSURE

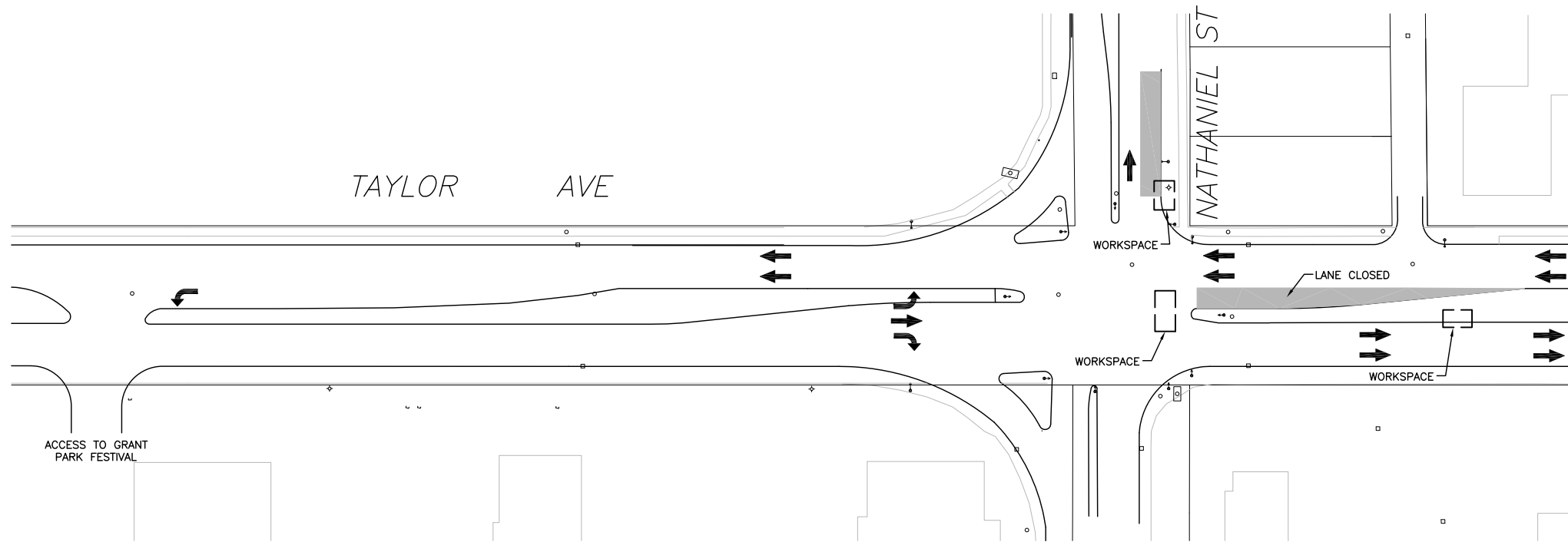

STAGE 3 – WATERMAIN WORK

TRAFFIC CONTROLS IMPLEMENTED

- CURB LANE CLOSED – NATHANIEL N/B
- NO LEFT TURN – TAYLOR W/B

NOTE:
ALL LOCATES AND DISTANCES FROM
EXISTING UTILITIES TO BE CONFIRMED
PRIOR TO CONSTRUCTION

DESCRIPTION OF WORK
750 CS/ 375 LDS BYPASS
WATERMAIN REPLACEMENT

LEGEND

- ➔ TRAFFIC FLOW
- LANE CLOSURE

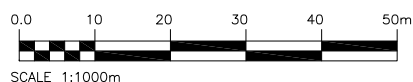

COCKBURN AND CALROSSIE COMBINED
SEWER RELIEF WORKS – CONTRACT 5
Traffic Management Plan
Phase 1

CONCEPTUAL ONLY

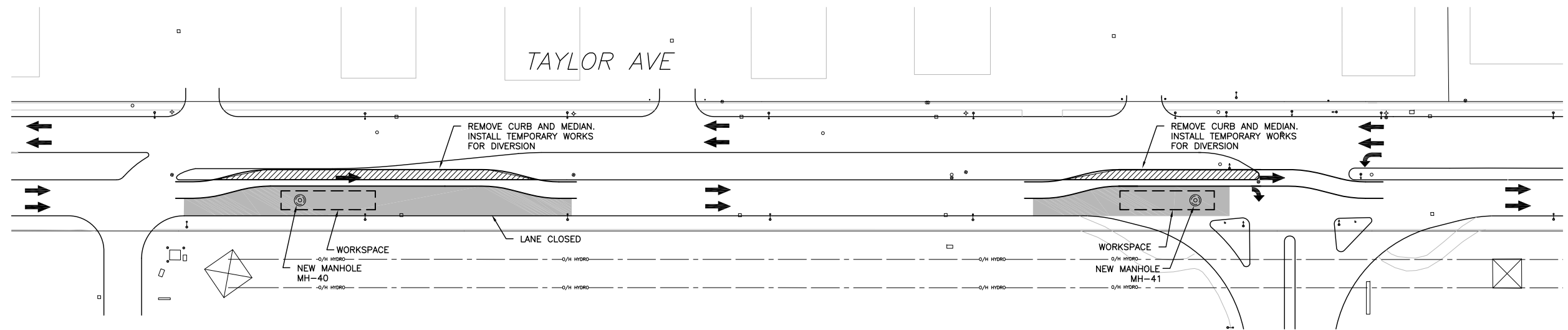

TRAFFIC CONTROLS IMPLEMENTED

- E/B TAYLOR AVE TWO LANE TO ONE LANE DIVERSION

NOTE:
ALL LOCATES AND DISTANCES FROM
EXISTING UTILITIES TO BE CONFIRMED
PRIOR TO CONSTRUCTION

DESCRIPTION OF WORK
INSTALL MH-40 AND MH-41

LEGEND

- ➔ TRAFFIC FLOW
- LANE CLOSURE

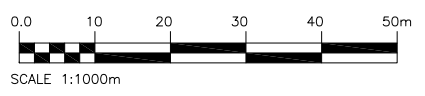

COCKBURN AND CALROSSIE COMBINED
SEWER RELIEF WORKS — CONTRACT 5

Traffic Management Plan
Phase 2

CONCEPTUAL ONLY

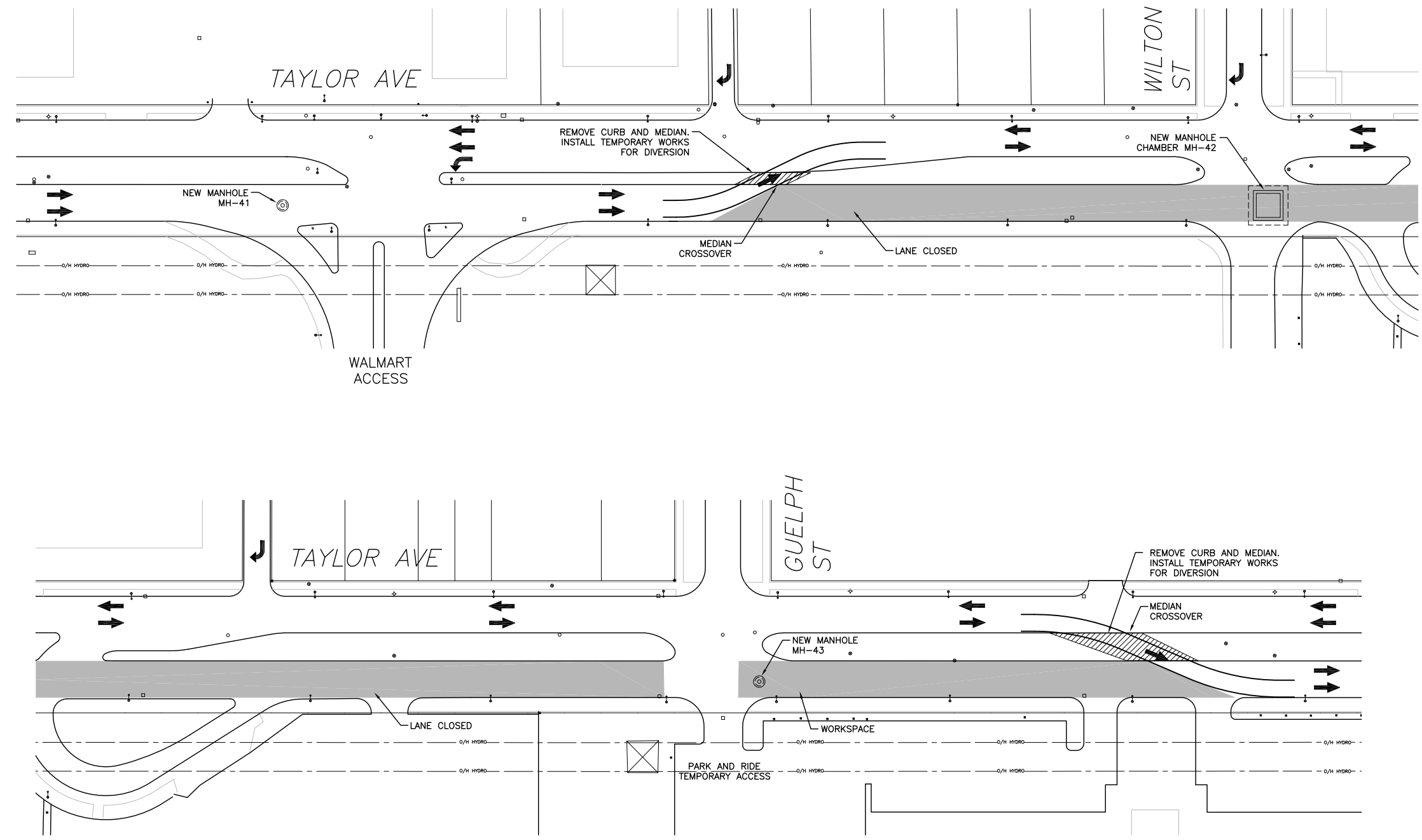

NOTE:
ALL LOCATES AND DISTANCES FROM
EXISTING UTILITIES TO BE CONFIRMED
PRIOR TO CONSTRUCTION

DESCRIPTION OF WORK
INSTALL MH-42 WILTON CHAMBER
INSTALL MH-43

- TRAFFIC CONTROLS IMPLEMENTED
- RIGHT TURN ONLY – WILTON S/B
 - NO LEFT TURN AT WILTON – TAYLOR E/B
 - TWO MEDIAN CROSSOVERS – TWO LANE TO SINGLE LANE IN BOTH DIRECTIONS

LEGEND
 TRAFFIC FLOW
 LANE CLOSURE

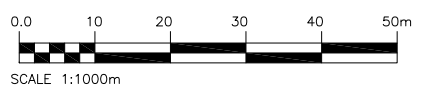

COCKBURN AND CALROSSIE COMBINED
SEWER RELIEF WORKS – CONTRACT 5
Traffic Management Plan
Phase 3

CONCEPTUAL ONLY

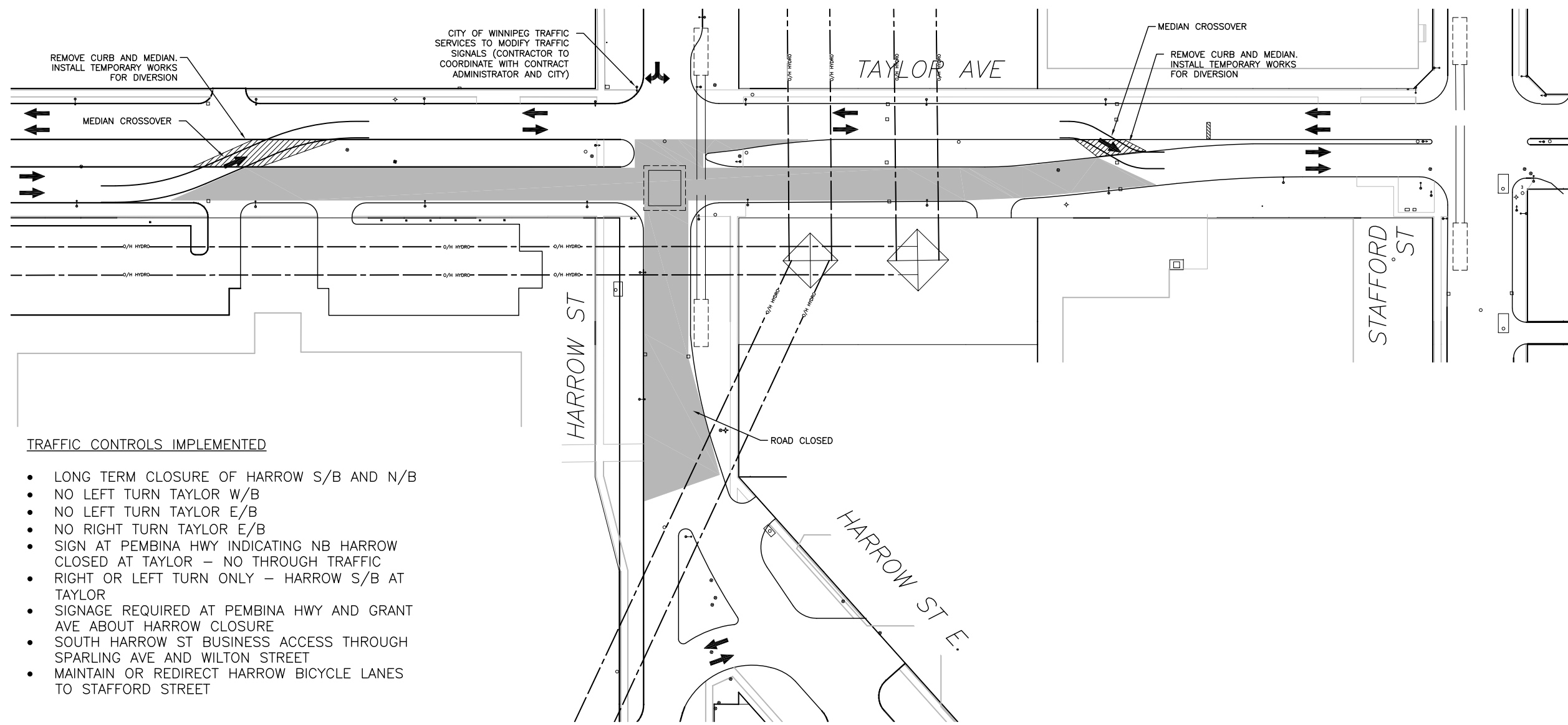

TRAFFIC CONTROLS IMPLEMENTED

- LONG TERM CLOSURE OF HARROW S/B AND N/B
- NO LEFT TURN TAYLOR W/B
- NO LEFT TURN TAYLOR E/B
- NO RIGHT TURN TAYLOR E/B
- SIGN AT PEMBINA HWY INDICATING NB HARROW CLOSED AT TAYLOR – NO THROUGH TRAFFIC
- RIGHT OR LEFT TURN ONLY – HARROW S/B AT TAYLOR
- SIGNAGE REQUIRED AT PEMBINA HWY AND GRANT AVE ABOUT HARROW CLOSURE
- SOUTH HARROW ST BUSINESS ACCESS THROUGH SPARLING AVE AND WILTON STREET
- MAINTAIN OR REDIRECT HARROW BICYCLE LANES TO STAFFORD STREET

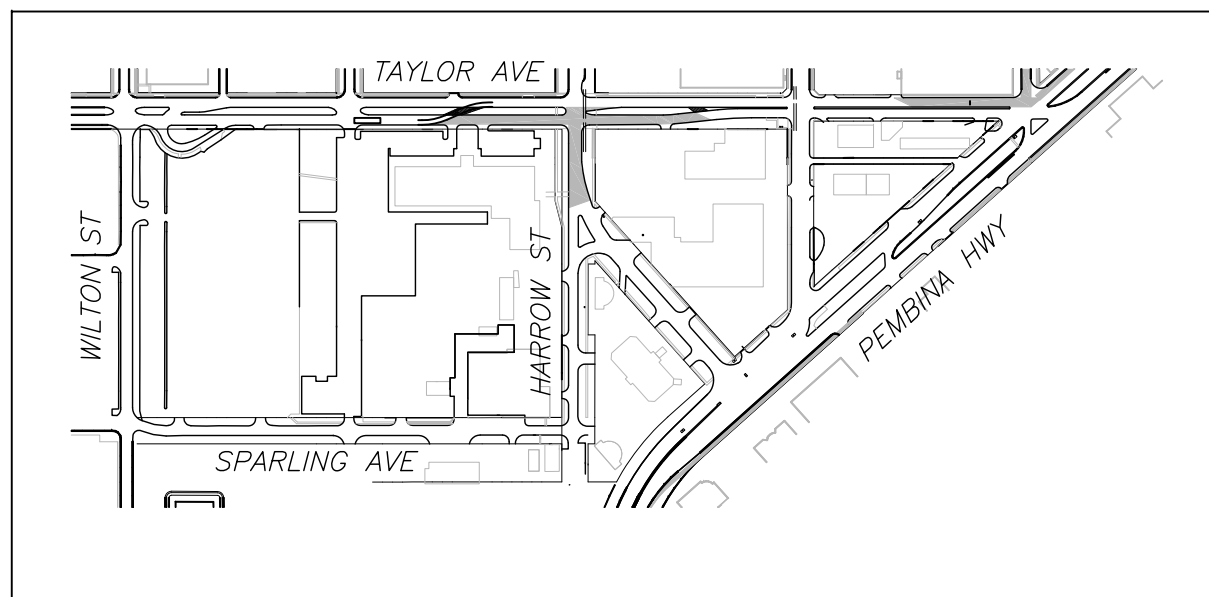

NOTE:
ALL LOCATES AND DISTANCES FROM EXISTING UTILITIES TO BE CONFIRMED PRIOR TO CONSTRUCTION

DESCRIPTION OF WORK
INSTALL HARROW 1950 CS CROSSING MODIFICATION

COCKBURN AND CALROSSIE COMBINED
SEWER RELIEF WORKS – CONTRACT 5
Traffic Management Plan
Phase 4

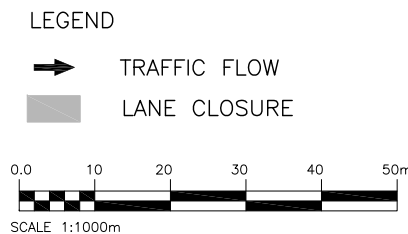

CONCEPTUAL ONLY

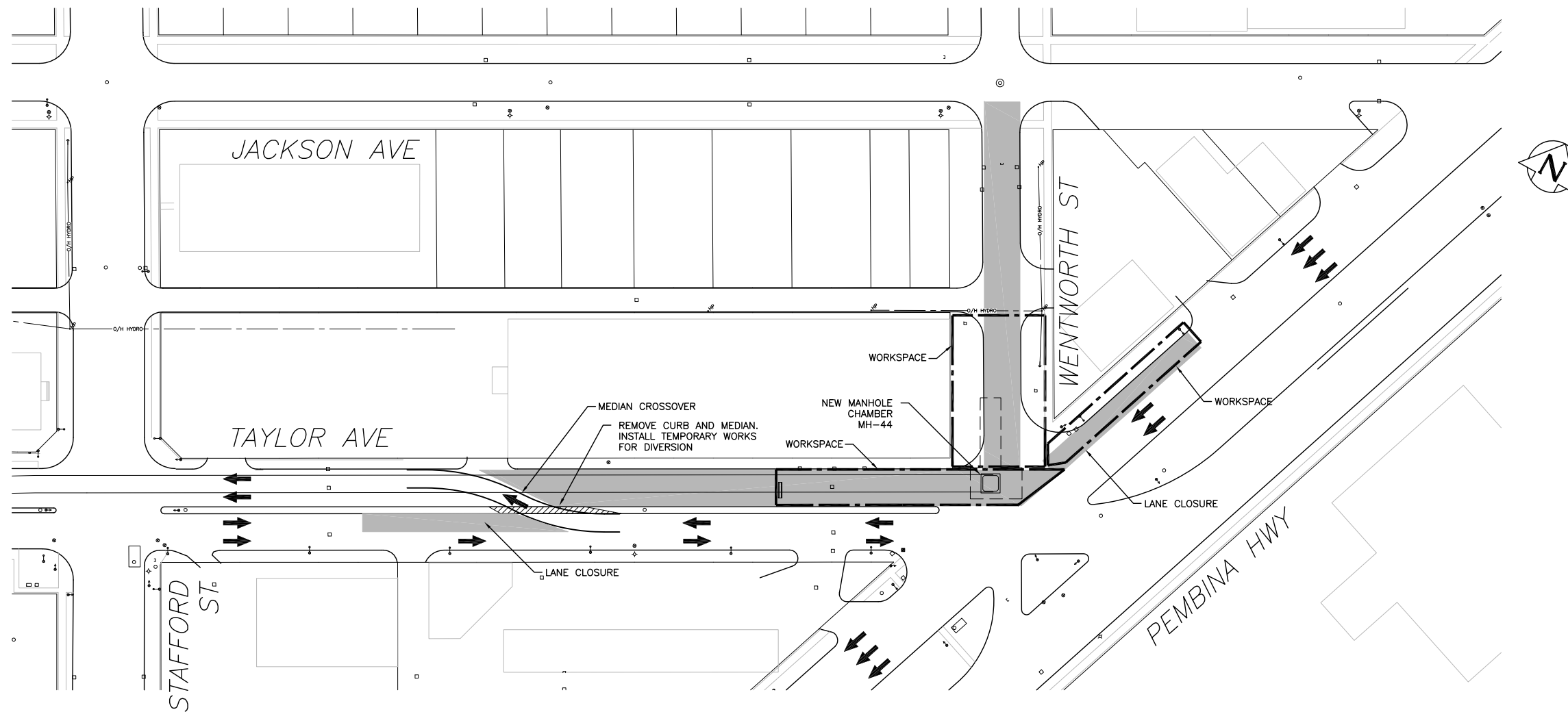

NOTE:
 ALL LOCATES AND DISTANCES FROM
 EXISTING UTILITIES TO BE CONFIRMED
 PRIOR TO CONSTRUCTION

TRAFFIC CONTROLS IMPLEMENTED

- CURB LANE CLOSED – S/B PEMBINA
- TWO WESTBOUND LANES CLOSED – TAYLOR AVE
- WENTWORTH STREET CLOSED PEMBINA HWY TO JACKSON ST

DESCRIPTION OF WORK
 CONSTRUCT RECEIVING SHAFT
 INSTALL MH-44 CHAMBER

LEGEND

- ➔ TRAFFIC FLOW
- LANE CLOSURE

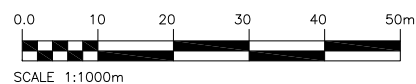

COCKBURN AND CALROSSIE COMBINED SEWER RELIEF WORKS – CONTRACT 5

Traffic Management Plan
 Phase 5

CONCEPTUAL ONLY