

Owner

City of Winnipeg  
185 King Street  
WINNIPEG, MANITOBA, R3B 1J1  
(204) 794-4418 (204) 986-4354

Rev. No.	Date	Revision Notes
1.	2017.11.28	Issued for Construction

### GENERAL NOTES:

- THIS DRAWING IS DIAGRAMMATIC ONLY. DO NOT SCALE.
- THE MECHANICAL SYSTEMS SHOWN ARE APPROXIMATE IN LOCATION ONLY. CONTRACTOR TO VERIFY EXACT LOCATION OF SYSTEMS BEING MODIFIED ON SITE PRIOR TO COMMENCEMENT OF WORK.
- ALL WORK SHALL COMPLY WITH THE MOST CURRENT VERSION OF ALL APPLICABLE CODES AND STANDARDS, WHICH SHALL BE CONSIDERED PART OF THESE CONTRACT DOCUMENTS. IN THE CASE OF CONFLICTING REQUIREMENTS, THE MOST STRINGENT REGULATION SHALL PREVAIL.
- CONTRACTOR TO MAINTAIN CURRENT AND READILY REVENABLE AS-BUILT DRAWINGS ACCURATELY REFLECTING SITE INSTALLATIONS.
- CONTRACTOR TO ENSURE ALL MATERIALS MODIFIED OR INSTALLED IN AN AIR PLENUM ARE RATED FOR SUCH USE.
- CONTRACTOR TO MAINTAIN DIGITAL PHOTOGRAPHIC RECORDS OF ALL INSTALLATIONS PRIOR TO CONCEALMENT.
- MECHANICAL SUBCONTRACTOR TO COORDINATE WITH CONTRACTOR FOR SCANNING, CUTTING AND PATCHING OF FLOOR AND SLAB TO DETERMINE EXACT LOCATION OF EXISTING DRAIN PIPES WHERE NEW DRAIN PIPES TIE IN.
- PROVIDE CAP ON ALL PIPING TO PREVENT DEBRIS ENTERING SYSTEM.
- PROVIDE PROWRAP (TM) ON ALL EXPOSED PIPING UNDER BARRIER FREE LAVATORIES AND SINKS.
- MATERIAL INSTALLED IN CEILING SPACE TO BE RATED FOR AIR PLENUM INSTALLATION.

### DRAWING NOTES:

- INSTALL NEW LAVATORY IN SIMILAR LOCATION AS EXISTING. MODIFY EXTEND PIPING AS REQUIRED.
- INSTALL NEW TOILET IN SIMILAR LOCATION AT EXISTING. MODIFY EXTEND PIPE AS NECESSARY.
- COORDINATE PIPE INSTALLATION HEIGHTS WITH ARCHITECTURAL CEILING REQUIREMENTS PRIOR TO INSTALLATION.
- SANITARY FROM FLOOR DRAIN ABOVE.
- SANITARY LINE FROM LAVATORY ABOVE.
- SANITARY LINE FROM TOILET ABOVE.
- LOOP VENT SINK AS NECESSARY AND TIE INTO NEAREST VENT MAIN.
- RUN VENT FROM NEW WASHROOM OVER TO LOCATION OF EXISTING WASHROOM AND CONNECT TO EXISTING VENT STACK.
- NEW SANITARY PIPING. CONTRACTOR TO SCAN EXISTING 100# MAIN. CONTRACTOR TO SCAN SLAB TO DETERMINE EXACT LOCATION PRIOR TO COMMENCING WORK.
- CONNECT NEW WASHROOM SANITARY DRAIN INTO EXISTING 100# MAIN. CONTRACTOR TO SCAN SLAB TO DETERMINE EXACT LOCATION PRIOR TO COMMENCING WORK.
- RUN NEW PIPING IN MILLWORK OVER TO TIE-IN LOCATION.
- CONNECT NEW PIPING DOWNSTREAM OF EXISTING WATER METER AT THIS LOCATION.

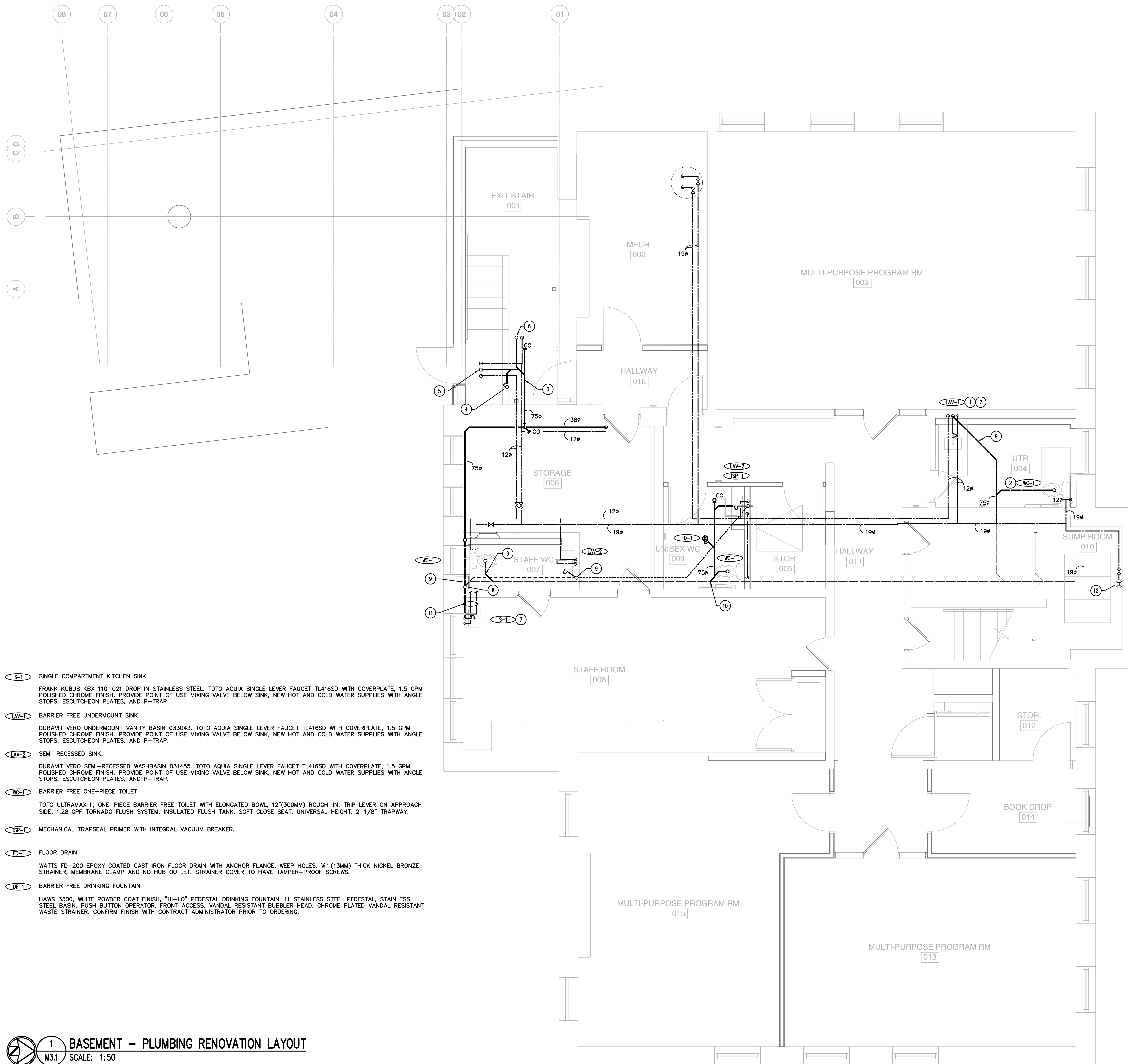

- S-1** SINGLE COMPARTMENT KITCHEN SINK  
FRANK KUBUS KBX 110-021 DROP IN STAINLESS STEEL. TOTO AQUIA SINGLE LEVER FAUCET TL416SD WITH COVERPLATE, 1.5 GPM POLISHED CHROME FINISH. PROVIDE POINT OF USE MIXING VALVE BELOW SINK, NEW HOT AND COLD WATER SUPPLIES WITH ANGLE STOPS, ESCUTCHEON PLATES, AND P-TRAP.
- LAV-1** BARRIER FREE UNDERMOUNT SINK.  
DURAVIT VERO UNDERMOUNT VANITY BASIN Q33043. TOTO AQUIA SINGLE LEVER FAUCET TL416SD WITH COVERPLATE, 1.5 GPM POLISHED CHROME FINISH. PROVIDE POINT OF USE MIXING VALVE BELOW SINK, NEW HOT AND COLD WATER SUPPLIES WITH ANGLE STOPS, ESCUTCHEON PLATES, AND P-TRAP.
- LAV-2** SEMI-RECESSED SINK.  
DURAVIT VERO SEMI-RECESSED WASHBASIN Q31455. TOTO AQUIA SINGLE LEVER FAUCET TL416SD WITH COVERPLATE, 1.5 GPM POLISHED CHROME FINISH. PROVIDE POINT OF USE MIXING VALVE BELOW SINK, NEW HOT AND COLD WATER SUPPLIES WITH ANGLE STOPS, ESCUTCHEON PLATES, AND P-TRAP.
- WC-1** BARRIER FREE ONE-PIECE TOILET  
TOTO ULTRAMAX II, ONE-PIECE BARRIER FREE TOILET WITH ELONGATED BOWL, 12"(300MM) ROUGH-IN. TRIP LEVER ON APPROACH SIDE, 1.28 GPF TORNADO FLUSH SYSTEM. INSULATED FLUSH TANK. SOFT CLOSE SEAT. UNIVERSAL HEIGHT. 2-1/8" TRAPWAY.
- ISP-1** MECHANICAL TRAPSEAL PRIMER WITH INTEGRAL VACUUM BREAKER.
- FD-1** FLOOR DRAIN  
WATTS FD-200 EPOXY COATED CAST IRON FLOOR DRAIN WITH ANCHOR FLANGE, WEEP HOLES, 1/2" (13MM) THICK NICKEL BRONZE STRAINER, MEMBRANE CLAMP AND NO HUB OUTLET. STRAINER COVER TO HAVE TAMPER-PROOF SCREWS.
- DF-1** BARRIER FREE DRINKING FOUNTAIN  
HAWS 3300, WHITE POWDER COAT FINISH, "HI-LO" PEDESTAL DRINKING FOUNTAIN, 11 STAINLESS STEEL PEDESTAL, STAINLESS STEEL BASIN, PUSH BUTTON OPERATOR, FRONT ACCESS, VANDAL RESISTANT BUBBLER HEAD, CHROME PLATED VANDAL RESISTANT WASTE STRAINER. CONFIRM FINISH WITH CONTRACT ADMINISTRATOR PRIOR TO ORDERING.

**1** BASEMENT - PLUMBING RENOVATION LAYOUT  
M3.1 SCALE: 1:50



15557  
**MCW / AGE**  
Consulting Professional Engineers  
210-1021 Wellington Avenue  
Winnipeg, Manitoba, R3H 0G4  
Phone: (204) 778-7900 Fax: (204) 778-1119  
E-Mail: mcw\_age@meow.com

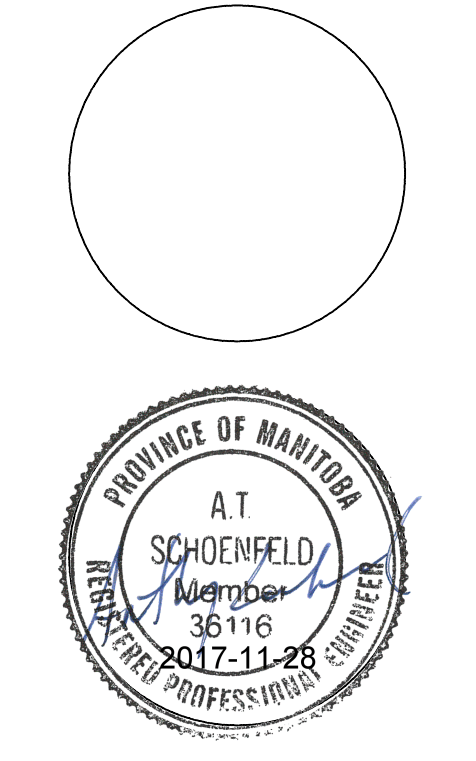

This drawing must not be scaled. The contractors shall verify all dimensions and other data on site prior to commencement of work. Discrepancies, errors, and omissions are to be reported to Public City Architecture Inc. prior to proceeding with the Work.  
Drawings and specifications as instruments of service are the property of Public City Architecture Inc. The copyright in the same being reserved.  
No reproduction or revision to these drawings may be made without the permission of Public City Architecture Inc., and when made, must bear their name. All prints to be returned to Public City Architecture Inc. upon request.

Project  
**Cornish Library Renovation**

Drawing  
**BASEMENT - PLUMBING RENOVATION LAYOUT**

Drawn By  
TL  
Scale  
As noted  
Reviewed By  
ATS  
Drawing No.  
**M3.1**

Date  
2017.11.28  
Project No.  
1503a