

P:\2018\16015690-2018 Regional Street Renewal Program\CAD\07_Sheets\Staging\1601568-Inkster-ST-02.dwg Last Saved: 12/17/2018 3:39 PM by kberard Plotted: 2/12/2019 11:35 AM by Kevin Berard

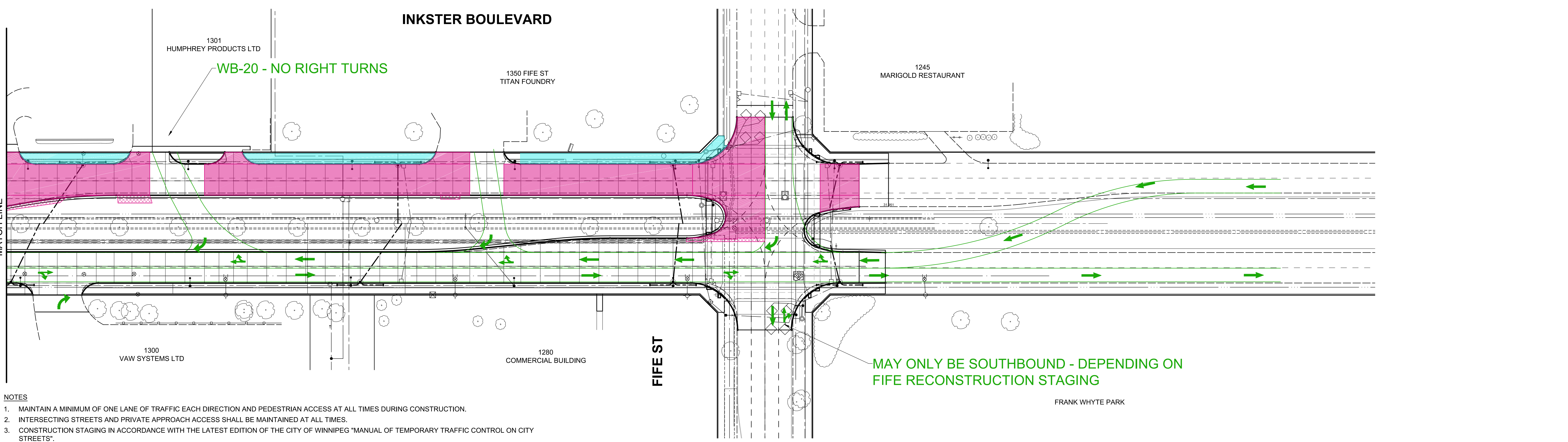
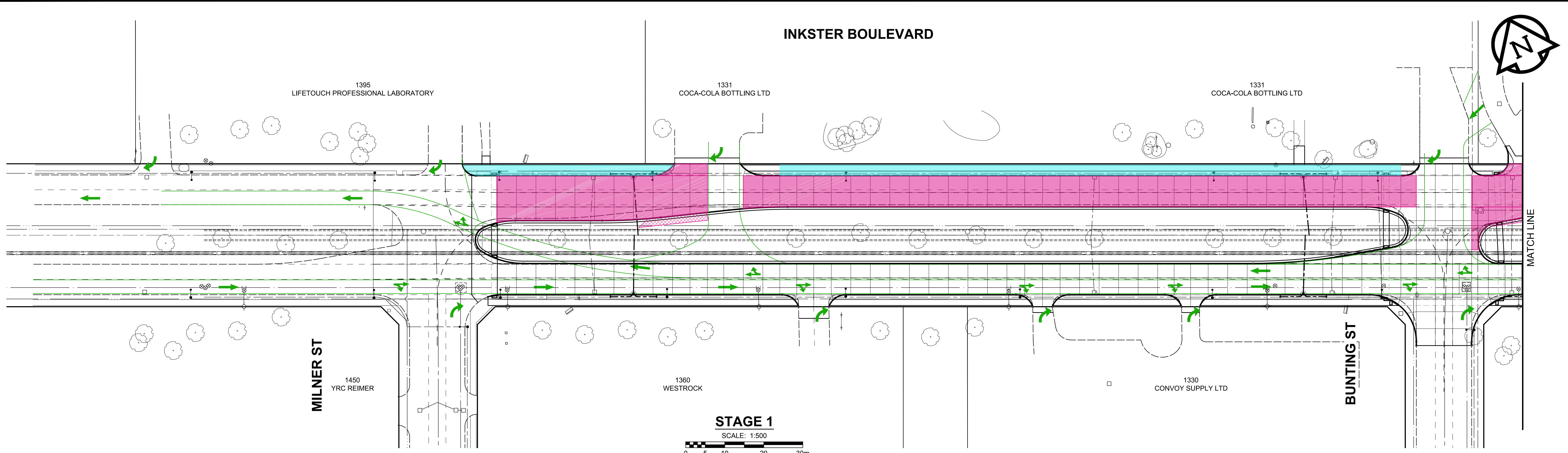

- NOTES**
1. MAINTAIN A MINIMUM OF ONE LANE OF TRAFFIC EACH DIRECTION AND PEDESTRIAN ACCESS AT ALL TIMES DURING CONSTRUCTION.
 2. INTERSECTING STREETS AND PRIVATE APPROACH ACCESS SHALL BE MAINTAINED AT ALL TIMES.
 3. CONSTRUCTION STAGING IN ACCORDANCE WITH THE LATEST EDITION OF THE CITY OF WINNIPEG "MANUAL OF TEMPORARY TRAFFIC CONTROL ON CITY STREETS".
 4. MAINTAIN EXISTING DRAINAGE AND INSTALL PROPOSED DRAINAGE APPURTENANCES AS REQUIRED DURING THE APPROPRIATE STAGES AND AS DIRECTED BY THE CONTRACT ADMINISTRATOR.
 5. TO FACILITATE LDS INSTALLATION, SAWCUT EXISTING PAVEMENT (FULL DEPTH) PRIOR TO REMOVAL.
 6. CONSTRUCT TEMPORARY ASPHALT PAVEMENT AND RAMPS AS REQUIRED TO FACILITATE THE CONSTRUCTION STAGING. THE TEMPORARY ASPHALT PAVEMENT SHALL CONSIST OF 75 mm - TYPE 1A ASPHALTIC CONCRETE PAVEMENT, 75 mm BASE COURSE, 300 - 100 mm SUB-BASE AND GEOTEXTILE / GEOGRID.
 7. LEFT TURN LANE WIDTH TO BE PARTIALLY EXCAVATED AND PERMANENT SUB-BASE / BASE STRUCTURE INSTALLED, IN ADDITION TO THE THROUGH LANES, WHILE MAINTAINING REQUIRED TRAFFIC (TO AVOID UNDERMINING OF PAVEMENT IN SUBSEQUENT STAGES).
 8. SAWCUT EXISTING PAVEMENT FULL DEPTH PRIOR TO REMOVAL TO ENSURE INTEGRITY OF REMAINING PAVEMENT LEFT OPEN TO TRAFFIC.
 9. PROPOSED SIDEWALKS TO BE CONSTRUCTED FOLLOWING CONSTRUCTION OF MAIN LANES.

LEGEND

STAGE 2 - TRAFFIC	
STAGE 2 - TEMP PAVEMENT	
STAGE 2 - CONSTRUCTION	
STAGE 2 - SIDEWALK	

**CITY OF WINNIPEG
INKSTER BOULEVARD
RECONSTRUCTION
STAGING - STAGE 2 - PHASE 1
INKSTER BOULEVARD
FIGURE ST-02**