

NOTE:  
 THE TUNNEL ALIGNMENT RADII SHOWN ARE PRELIMINARY AND  
 BASED ON TWO-PASS TUNNELING. THE FINAL RADII FOR BOTH  
 THE TWO-PASS AND SINGLE PASS (PIPE JACKING) WILL BE  
 UPLOADED IN THE UPCOMING RFP 1067-2018B.

COCKBURN AND CALROSSIE COMBINED  
 SEWER RELIEF WORKS – CONTRACT 5  
 Overall Plan

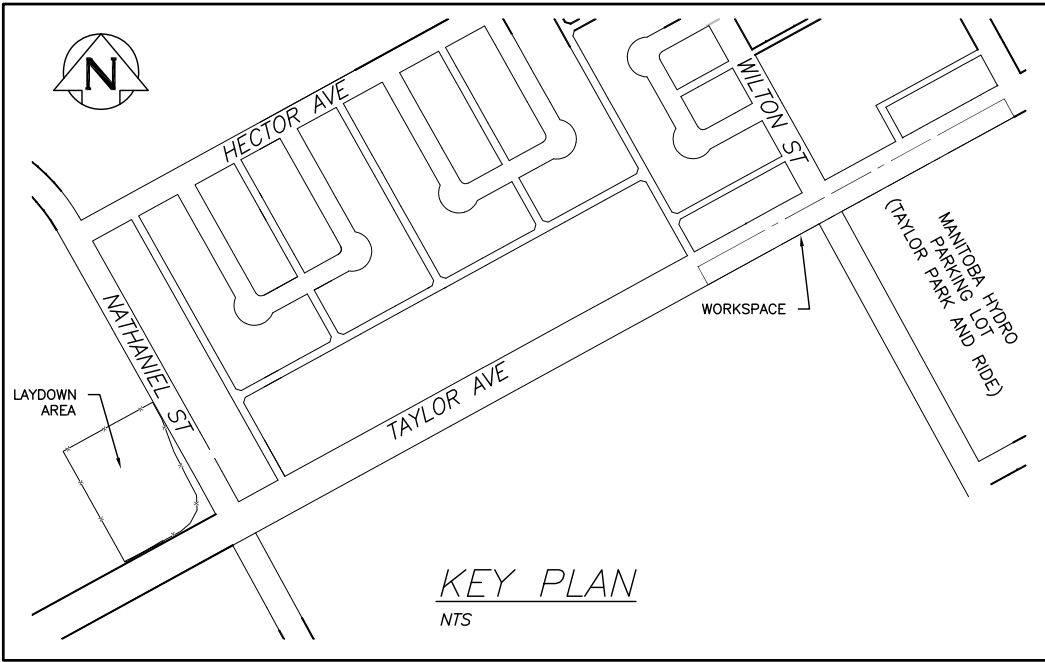

NOTE:  
 ALL LOCATES AND DISTANCES FROM EXISTING  
 UTILITIES TO BE CONFIRMED PRIOR TO  
 CONSTRUCTION

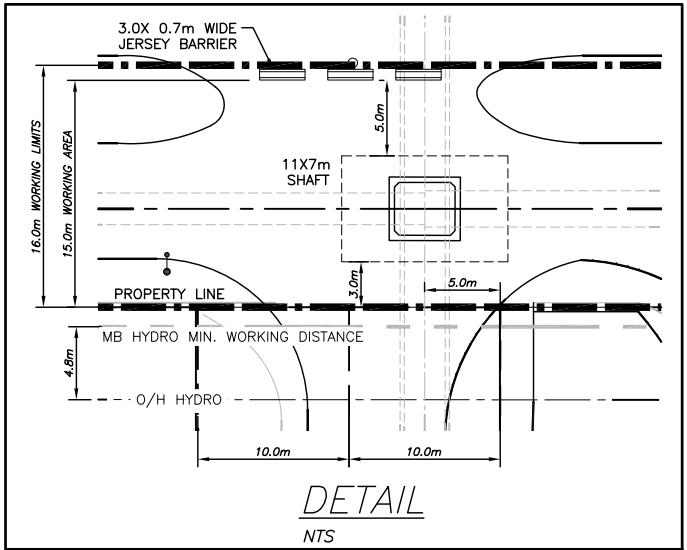
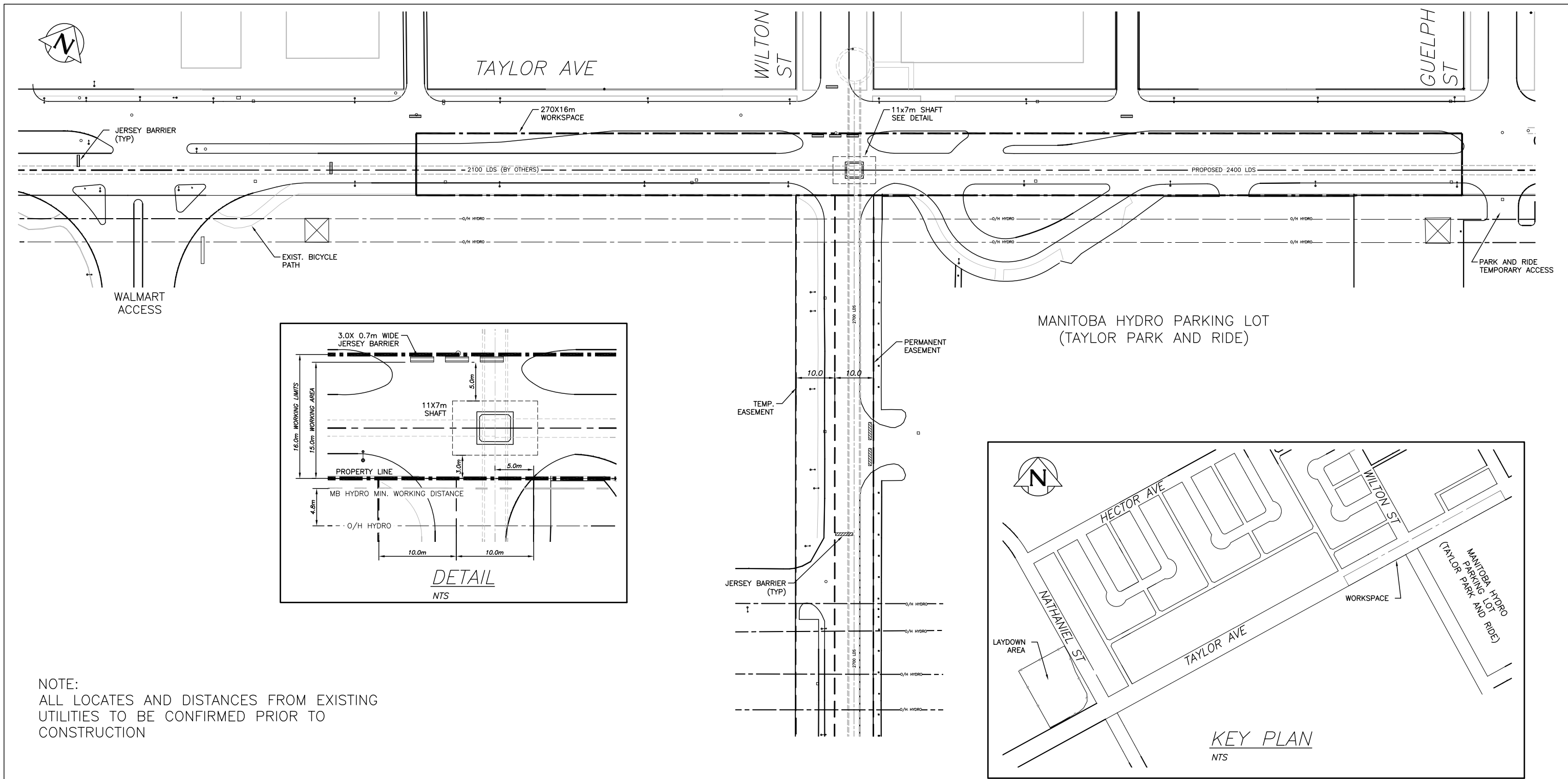
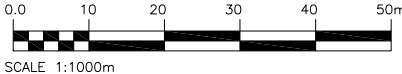

COCKBURN AND CALROSSIE COMBINED  
 SEWER RELIEF WORKS — CONTRACT 5  
 Workspace Plan

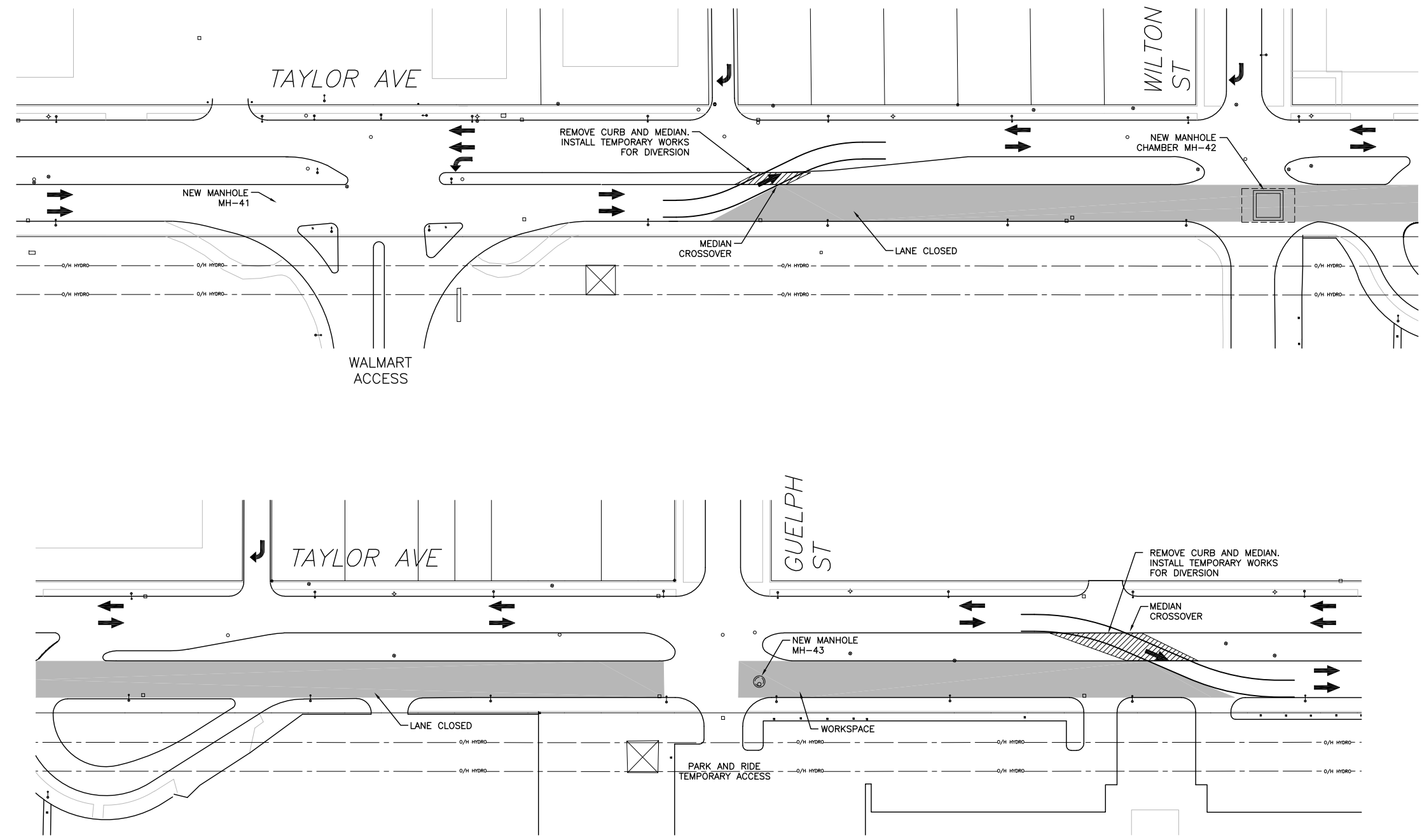

NOTE:  
 ALL LOCATES AND DISTANCES FROM  
 EXISTING UTILITIES TO BE CONFIRMED  
 PRIOR TO CONSTRUCTION

DESCRIPTION OF WORK  
 INSTALL MH-42 WILTON CHAMBER  
 INSTALL MH-43

- TRAFFIC CONTROLS IMPLEMENTED
- RIGHT TURN ONLY – WILTON S/B
  - NO LEFT TURN AT WILTON – TAYLOR E/B
  - TWO MEDIAN CROSSOVERS – TWO LANE TO SINGLE LANE IN BOTH DIRECTIONS

LEGEND  
 → TRAFFIC FLOW  
 █ LANE CLOSURE

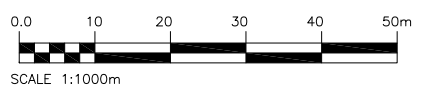

COCKBURN AND CALROSSIE COMBINED  
 SEWER RELIEF WORKS – CONTRACT 5  
 Traffic Management Plan  
 1 of 2

CONCEPTUAL ONLY

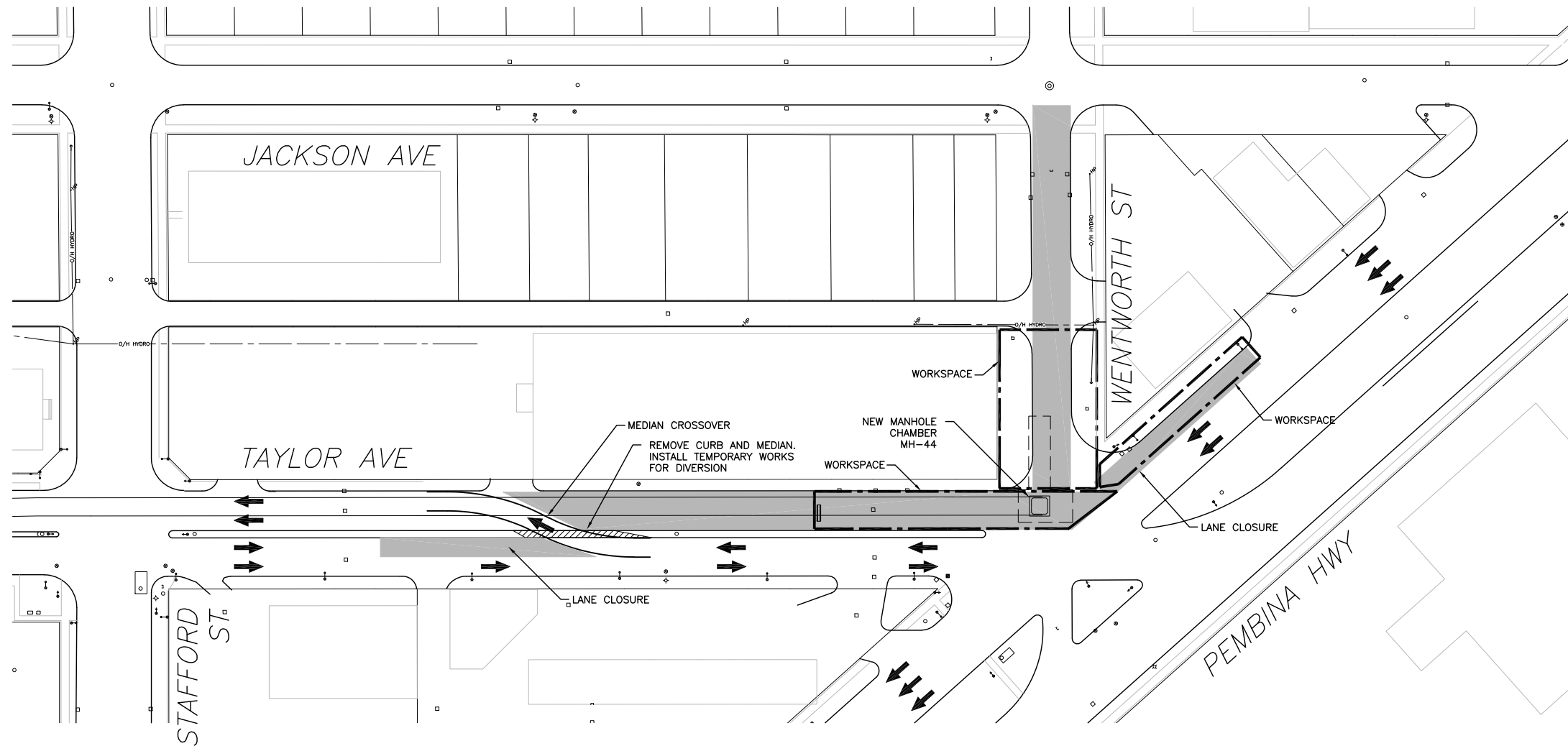

NOTE:  
ALL LOCATES AND DISTANCES FROM  
EXISTING UTILITIES TO BE CONFIRMED  
PRIOR TO CONSTRUCTION

TRAFFIC CONTROLS IMPLEMENTED

- CURB LANE CLOSED – S/B PEMBINA
- TWO WESTBOUND LANES CLOSED – TAYLOR AVE
- WENTWORTH STREET CLOSED PEMBINA HWY TO JACKSON ST

DESCRIPTION OF WORK  
CONSTRUCT RECEIVING SHAFT  
INSTALL MH-44 CHAMBER

LEGEND

- ➔ TRAFFIC FLOW
- LANE CLOSURE

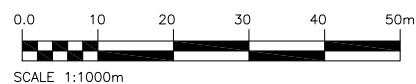

COCKBURN AND CALROSSIE COMBINED  
SEWER RELIEF WORKS – CONTRACT 5

Traffic Management Plan

2 of 2

CONCEPTUAL ONLY