

**WARNING**  
 IF POWER EQUIPMENT OR EXPLOSIVES ARE TO BE USED FOR EXCAVATION ON THIS PROJECT THE CONTRACTOR MUST:  
 1) NOTIFY THE GAS COMPANY OF THE PROPOSED LOCATION OF EXCAVATION.  
 2) TAKE PRECAUTION TO AVOID DAMAGE TO GAS COMPANY INSTALLATIONS.  
 SEE PROVINCIAL REGULATION 210/72 FOR DETAILS

**PROPERTY LIMITS DELINEATION**  
 DELINEATION OF PROPERTY LIMITS AS SHOWN ON THIS DRAWING DOES NOT REPRESENT A "LEGAL SURVEY". CH2M HILL MAKES NO REPRESENTATION OR WARRANTY AS TO THE ACCURACY OF PROPERTY LIMITS DELINEATED ON THIS DRAWING, NOR ON THE DIMENSIONAL ACCURACY OF DRAWING FEATURES RELATIVE TO THOSE PROPERTY LIMITS.

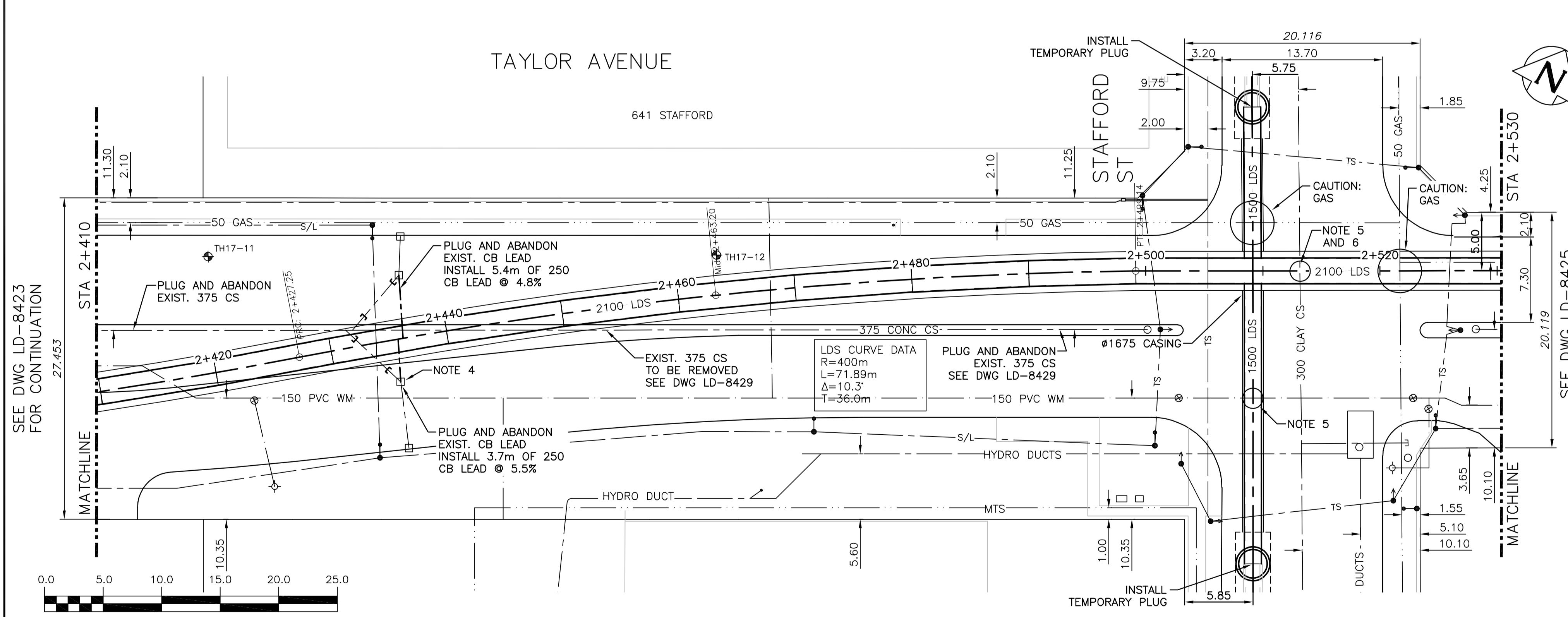

- CONSTRUCTION NOTES:**
- SEWER AND WATER SERVICES SHOWN ON DRAWING ARE APPROXIMATE ONLY.
  - LOCATION OF ALL SEWER AND WATER LINES TO BE CONFIRMED IN FIELD.
  - INSTALL NEW SEWER BY TRENCHLESS METHODS, UNLESS OTHERWISE NOTED.
  - REPLACE SOLID MANHOLE LID WITH SLOTTED LID. HYDRO EXCAVATE UTILITY PRIOR TO CONSTRUCTION.
  - PRE AND POST CCTV OF UTILITY CROSSING.
  - LOCATE AND HYDRO EXCAVATE SEWER SERVICE(S) ALONG TAYLOR AVENUE FROM BUILDING AT 651 STAFFORD STREET.

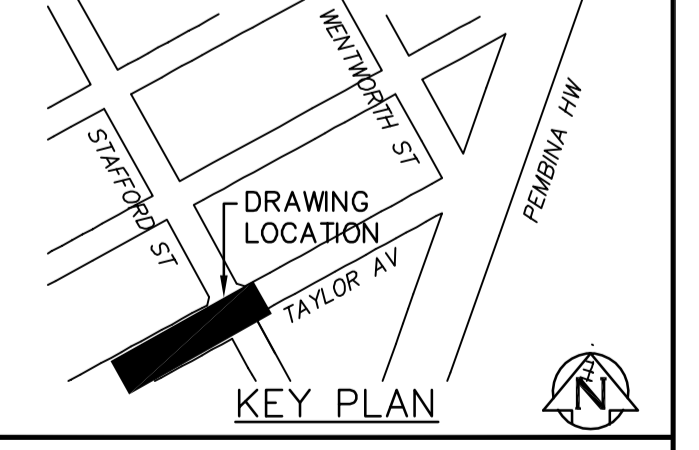

EXISTING	LEGEND-PLAN	PROPOSED	EXISTING	LEGEND-PLAN	PROPOSED	EXISTING	LEGEND-PROFILE	PROPOSED
150 WM	WATER MAIN	150 WM	HYDRO	M.T.S.	150 WM	WATER MAIN	150 WM	HYDRANT, VALVE
300 LDS	LAND DRAINAGE SEWER	300 LDS	CONCRETE	CONCRETE	300 LDS	LAND DRAINAGE SEWER	300 LDS	LAND DRAINAGE SEWER
250 WWS	WASTE WATER SEWER	250 WWS	ASPHALT	ASPHALT	250 WWS	WASTE WATER SEWER	250 WWS	WASTE WATER SEWER
MANHOLE	MANHOLE	MANHOLE	SIDEWALK	SIDEWALK	MANHOLE	MANHOLE	MANHOLE	MANHOLE
CATCH BASIN	CATCH BASIN	CATCH BASIN	PLANNING	PLANNING	CATCH BASIN	CATCH BASIN	CATCH BASIN	CATCH BASIN
CURB INLET	CURB INLET	CURB INLET	PROPERTY LINE	PROPERTY LINE	CURB INLET	CURB INLET	CURB INLET	CURB INLET
BEND	BEND	BEND	SURVEY BAR	SURVEY BAR	BEND	BEND	BEND	BEND
REDUCER	REDUCER	REDUCER	GAS	GAS	REDUCER	REDUCER	REDUCER	REDUCER
TEE	TEE	TEE	CURB STOP	CURB STOP	TEE	TEE	TEE	TEE

**LOCATION APPROVED UNDERGROUND STRUCTURES**

SUPV. U/G STRUCTURES COMMITTEE DATE

NOTE:  
 LOCATION OF UNDERGROUND STRUCTURES AS SHOWN ARE BASED ON THE BEST INFORMATION AVAILABLE BUT NO GUARANTEE IS GIVEN THAT ALL EXISTING UTILITIES ARE SHOWN OR THAT THE GIVEN LOCATIONS ARE EXACT. CONFIRMATION OF EXISTENCE AND EXACT LOCATION OF ALL SERVICES MUST BE OBTAINED FROM THE INDIVIDUAL UTILITIES BEFORE PROCEEDING WITH CONSTRUCTION.

NO.	REVISIONS	DATE	BY
2	ISSUED FOR RFQ	11/2018	JBC
1	ISSUED FOR ADDENDUM 3	02/2018	JBC
0	ISSUED FOR TENDER	01/2018	JBC

**KGS GROUP CONSULTING ENGINEERS**

**JACOBS**

DESIGNED BY: SDG  
 DRAWN BY: JBC

CHECKED BY: MD  
 APPROVED BY: RBO

HOR. SCALE: 1:250  
 VERTICAL: 1:50

RELEASED FOR CONSTRUCTION: K. ZUREK  
 DATE: JAN 19, 2018

ENGINEER'S SEAL

PRELIMINARY  
 NOT FOR CONSTRUCTION

**THE CITY OF WINNIPEG WATER AND WASTE DEPARTMENT**

PROJECT TITLE: COCKBURN AND CALROSSIE COMBINED SEWER RELIEF WORKS - CONTRACT 5

TAYLOR AVENUE FROM STA 2+410 TO STA 2+530

SHEET OF 8 OF 10  
 COMPUTER FILE NAME: C-250.dwg  
 CITY DRAWING NUMBER: LD-8424

File name: C:\pw\_workdir\ch2mhill\_wbg\jcoritez\1d0436657\