

NOTE:
LOCATIONS ARE APPROXIMATE AND FURTHER INVESTIGATION TO CONFIRM
LOCATIONS OF EXISTING SERVICES MAY BE REQUIRED BY THE CONTRACTOR.

NOTE: CHAINAGES SHOWN ARE ALONG C OF PROPOSED LDS

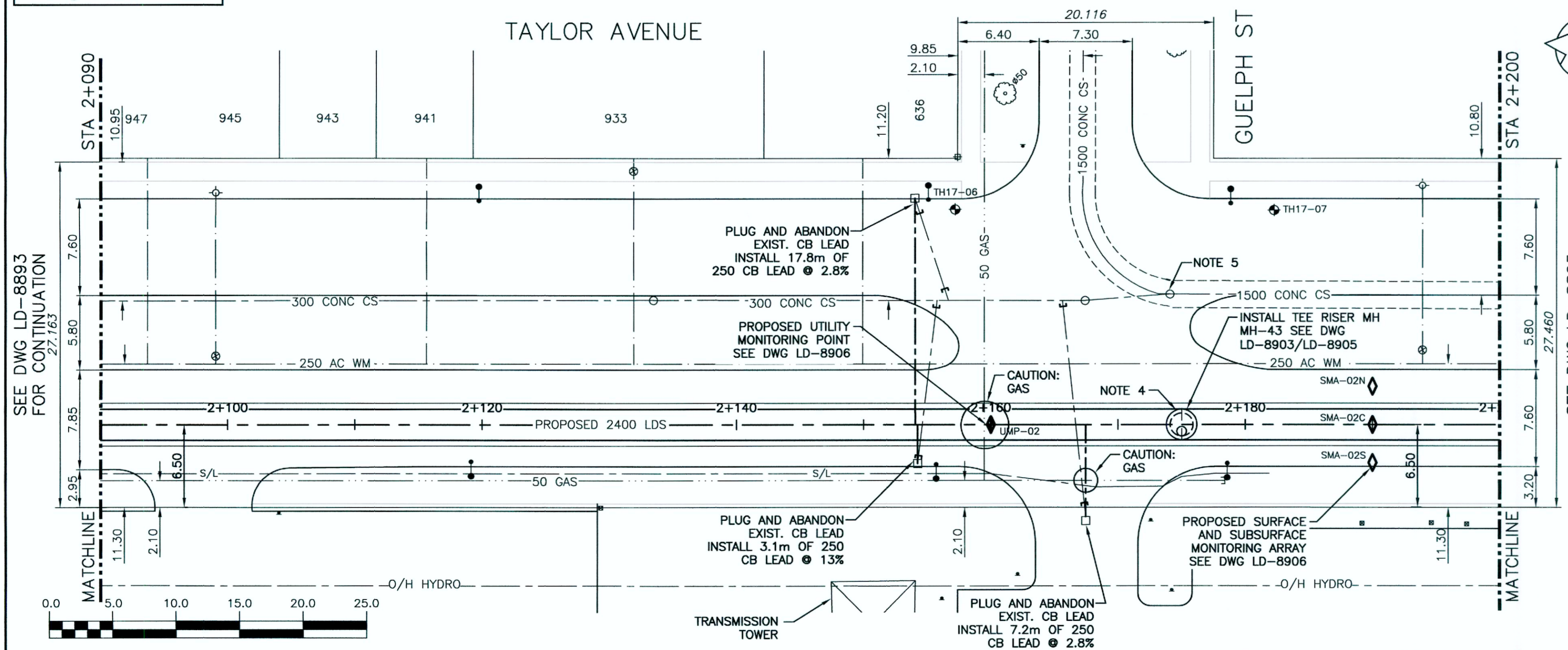

WARNING
IF POWER EQUIPMENT OR EXPLOSIVES ARE TO BE USED FOR EXCAVATION ON THIS PROJECT THE CONTRACTOR MUST:
1) NOTIFY THE GAS COMPANY OF THE PROPOSED LOCATION OF EXCAVATION.
2) TAKE PRECAUTION TO AVOID DAMAGE TO GAS COMPANY INSTALLATIONS.
SEE PROVINCIAL REGULATION 210/72 FOR DETAILS

PROPERTY LIMITS DELINEATION
DELINEATION OF PROPERTY LIMITS AS SHOWN ON THIS DRAWING DOES NOT REPRESENT A "LEGAL SURVEY". JACOBS AND KGS GROUP MAKE NO REPRESENTATION OR WARRANTY AS TO THE ACCURACY OF PROPERTY LIMITS DELINEATED ON THIS DRAWING, NOR ON THE DIMENSIONAL ACCURACY OF DRAWING FEATURES RELATIVE TO THOSE PROPERTY LIMITS.

- CONSTRUCTION NOTES:**
- SEWER AND WATER SERVICES SHOWN ON DRAWING ARE APPROXIMATE ONLY.
 - LOCATION OF ALL SEWER AND WATER LINES TO BE CONFIRMED IN FIELD BY CONTRACTOR.
 - INSTALL NEW SEWER BY TRENCHLESS METHODS, UNLESS OTHERWISE NOTED.
 - TWO-PASS INSTALLATION REQUIRES TEMPORARY MANHOLE TEE RISER SHAFT TO BE CONSTRUCTED PRIOR TO TUNNEL INSTALLATION. REFER TO DRAWING LD-8903.
 - REPLACE GRATED COVER WITH SOLID LID AP-007.
 - CASING PIPE SHOWN FOR CONVENTIONAL TWO-PASS TUNNELLING OPTION ONLY. DISREGARD FOR PIPE JACKING.
 - FOR TWO-PASS MAINTAIN A MINIMUM 250mm CLEARANCE BETWEEN TUNNEL AND CARRIER PIPE.

APEGM
Certificate of Authorization
CH2M HILL Canada Ltd.
No. 1441

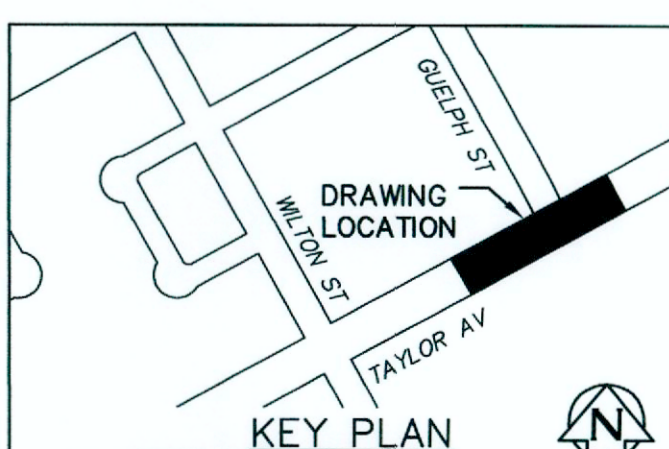

150 WM	WATER MAIN	150 WM	HYDRO	150 WM	WATER MAIN	150 WM
Hydrant	Valve	Hydrant	M.T.S.	Hydrant, Valve	Hydrant, Valve	Hydrant, Valve
300 LDS	LAND DRAINAGE SEWER	300 LDS	CONCRETE	300 LDS	LAND DRAINAGE SEWER	300 LDS
250 WWS	WASTE WATER SEWER	250 WWS	ASPHALT	250 WWS	WASTE WATER SEWER	250 WWS
Manhole	Manhole	Manhole	SIDEWALK	Manhole	WASTE WATER SEWER	Manhole
Catch Basin	Catch Basin	Catch Basin	PLANNING	Manhole	WASTE WATER SEWER	Manhole
Curb Inlet	Curb Inlet	Curb Inlet	PROPERTY LINE	Manhole	WASTE WATER SEWER	Manhole
Bend	Bend	Bend	SURVEY BAR	Manhole	WASTE WATER SEWER	Manhole
Reducer	Reducer	Reducer	GAS	Manhole	WASTE WATER SEWER	Manhole
Existing	Legend-Plan	Proposed	TEE	Manhole	WASTE WATER SEWER	Manhole
Existing	Legend-Profile	Proposed	CURB STOP	Manhole	WASTE WATER SEWER	Manhole
Existing	Legend-Profile	Proposed	TEE	Manhole	WASTE WATER SEWER	Manhole

LOCATION APPROVED UNDERGROUND STRUCTURES
SUPV. U/G STRUCTURES COMMITTEE DATE
NOTE:
LOCATION OF UNDERGROUND STRUCTURES AS SHOWN ARE BASED ON THE BEST INFORMATION AVAILABLE BUT NO GUARANTEE IS GIVEN THAT ALL EXISTING UTILITIES ARE SHOWN OR THAT THE GIVEN LOCATIONS ARE EXACT. CONFIRMATION OF EXISTENCE AND EXACT LOCATION OF ALL SERVICES MUST BE OBTAINED FROM THE INDIVIDUAL UTILITIES BEFORE PROCEEDING WITH CONSTRUCTION.

B.M. ELEV.	
NO.	REVISIONS
0	ISSUED FOR TENDER
	DATE
	BY

KGS GROUP CONSULTING ENGINEERS
JACOBS

DESIGNED BY SDG
CHECKED BY MD
DRAWN BY JBC
APPROVED BY RBO (KGS Group)

HOR. SCALE: 1:250
VERTICAL: 1:50

RELEASED FOR CONSTRUCTION: 01/09/19

ENGINEER'S SEAL
PROVINCE OF MANITOBA
DRAPER
21/01/2019
37958
REGISTERED PROFESSIONAL ENGINEER

THE CITY OF WINNIPEG WATER AND WASTE DEPARTMENT

PROJECT TITLE
COCKBURN AND CALROSSIE COMBINED SEWER RELIEF WORKS - CONTRACT 5
TAYLOR AVENUE
FROM STA 2+090 TO STA 2+200

SHEET OF 19
COMPUTER FILE NAME
C-262.dwg
CITY DRAWING NUMBER
LD-8894