

ASBESTOS INVENTORY CONTROL



Planning, Property and Development Department
Municipal Accommodations Division
4th Floor - 185 King Street • Winnipeg, MB • R3B 1J1

Building Name:	Canada Post Tower	Inspection Date:	June 28, 2018
Building Code:	LO-11	Inspected By:	Will Deller & Ryan Matthews
Building Address:	266 Graham Avenue	Construction Date:	1965

Material Location	Material Description	Drawing Label	Material Condition	Testing Status	Date M/Y	Test %	Est. %
2nd Floor Tower							
All Areas	All areas have asbestos containing plaster above dropped ceiling.	PL	Good	TESTED		<1	
	All exterior walls and columns have asbestos containing plaster.	PL	Good				<1
	All areas have asbestos containing black mastic above dropped ceiling.	MA	Good	TESTED		12	
Stairwell	Grout		Good	TESTED	Sep/'14	0	
Elevator Lobby	Hardboard - Wall	HB	Good	TESTED	Oct/'14	0	
	Plaster - Ceiling	PL	Good	TESTED	Nov/'14	<1	
Kitchen/ Storage Area	Plaster - Ceiling	PL	Good	TESTED	Mar/'15	0	
Back Hallway @ Elec Office	Pipe Fitting Insulation	PF	Good	TESTED	Mar/'15	0	
Electrician's Office	Plaster - Ceiling	PL	Good	TESTED	Mar/'15	0	
Dr. Lecher's Office	Drywall Compound - Ceiling	DC	Good	TESTED	Apr/'15	0	
Pipe Chase "A"	Pipe Insulation	PI	Good	TESTED	Mar/'15	25	
Pipe Chase "Hot HPS"	Pipe Insulation	PI	Good	TESTED	Mar/'15	70	
Pipe Chase "HP REC"	Pipe Insulation	PI	Good	TESTED	Mar/'15	70	
Pipe Chase "Hot LPS"	Pipe Insulation	PI	Good	TESTED	Mar/'15	50	
Pipe Chase "Cold 1"	Pipe Insulation	PI	Good	TESTED	Mar/'15	50	
Pipe Chase "Cold 2"	Pipe Insulation	PI	Good	TESTED	Mar/'15	50	
Pipe Chase	Duct Insulation	DI	Good	TESTED	Mar/'15	85	
Pipe Chase	Pipe Fitting Insulation	PF	Good	TESTED	Mar/'15	85	
Pipe Chase	Pipe Insulation	PI	Good	TESTED	Mar/'15	40	
Pipe Chase @ Crawlspace	Pipe Fitting Insulation	PF	Good	TESTED	Mar/'15	80	
Men's Changeroom South	Drywall Compound	DC	Good	TESTED	Oct/'15	0	
Men's Changeroom North	Drywall Compound	DC	Good	TESTED	Oct/'15	0	
Men's Changeroom Column	Drywall Compound	DC	Good	TESTED	Oct/'15	0	

Material Location	Material Description	Drawing Label	Material Condition	Testing Status	Date M/Y	Test %	Est. %
Women's Changeroom South	Drywall Compound	DC	Good	TESTED	Oct/'15	0	
Museum Storage Room	Plaster - Ceiling	PL	Good	TESTED	Jan/'17	<1	
South Storage Room	Transite Board	TB	Removed/17	TESTED	Jan/'17	15	
Subway Storage - South Wall	Plaster (3 samples)	PI	Good	TESTED	Sep/'17	0	
	Mortar - (3 samples)	M	Good	TESTED	Sep/'17	0	
	Transite Board	TB	Removed/17	TESTED	Jan/'17	15	
Police Meeting Area	24"x48" Ceiling Tile	DC	Good	TESTED	Mar/'13	0	
	Drywall Compound - Southwest Corner	DC	Good	TESTED	Oct/'16	0	
	Drywall Compound - Midwest Wall	DC	Good	TESTED	Oct/'16	0	
	Drywall Compound - Northwest Corner	DC	Good	TESTED	Oct/'16	0	
	Drywall Compound - Bathroom	DC	Good	TESTED	Oct/'16	0	
	Drywall Compound - Doorway to Escalator	DC	Good	TESTED	Oct/'16	0	
	Plaster - Ceiling	PL	Good				<1
	Plaster - Walls	PL	Good				<1
	Pipe Insulation	PI	Good				25-80
	Pipe Fittings	PF	Good				25-70
	Black Mastic on Ductwork	MA	Good				12

NOTES:

1. Asbestos inspections and inventory updates are conducted annually.
2. There may be asbestos containing materials present that were not located during asbestos inspections.
3. Floor tile and sheet flooring installed before 1990 may contain asbestos and must be treated as an asbestos containing material.
4. Vermiculite insulation may contain pockets of asbestos. All vermiculite insulation must be treated as an asbestos containing material.
5. For asbestos related inquiries, call Central Control at 204-986-2382

LO-11

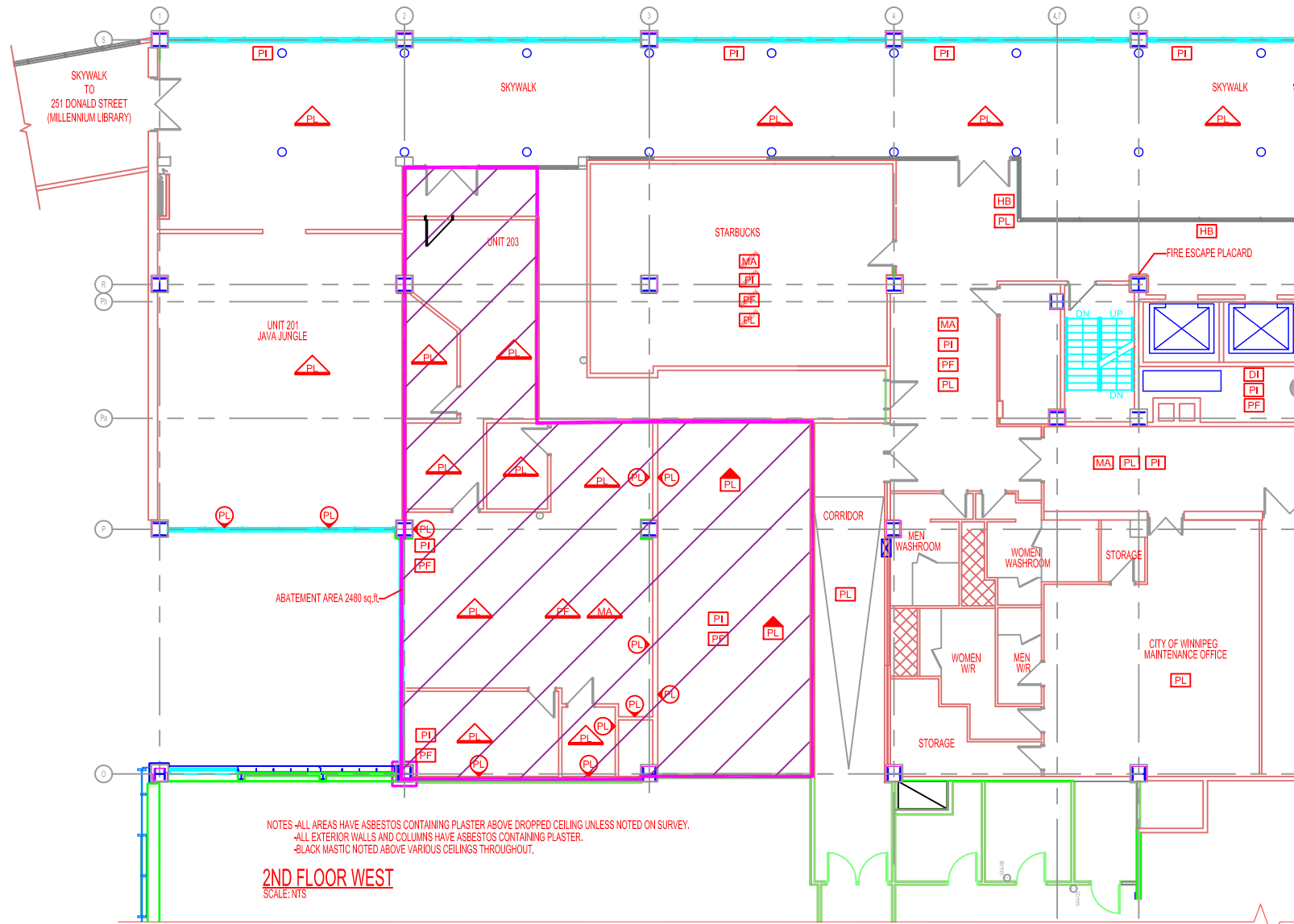

NOTES -ALL AREAS HAVE ASBESTOS CONTAINING PLASTER ABOVE DROPPED CEILING UNLESS NOTED ON SURVEY.
 -ALL EXTERIOR WALLS AND COLUMNS HAVE ASBESTOS CONTAINING PLASTER.
 -BLACK MASTIC NOTED ABOVE VARIOUS CEILINGS THROUGHOUT.

2ND FLOOR WEST
 SCALE: NTS

ATTACHED TO 245 SMITH STREET BUILDING

LEGEND	GENERAL LABELS	ON CEILING	ABOVE CEILING	UNDER FLOORING	WALL DETAIL	ENCAPSULATED ASBESTOS
?? =	??	??	??	??	??	
AF: ASBESTOS FABRIC	BR: BOILER REFRACTORY	CA: CAULKING	C12: 12X12 CEILING TILE	C24: 24X24 CEILING TILE	C48: 24X48 CEILING TILE	DC: DRYWALL COMPOUND
DI: DUCT INSULATION	FS: SHEET FLOORING	FL: FLOOR LEVELING CMP	F9: 9X9 FLOOR TILE	F12: 12X12 FLOOR TILE	HB: HARDBOARD	MA: MASTIC
PF: PIPE FITTING INSULATION	PI: PIPE INSULATION	RD: ROOF DRAIN	ST: STIPPLE CEILING	SO: SPRAY ON	ST: STUCCO	TI: TANK INSULATION
TP: TRANSITE PIPE	VE: VERMICULITE					

NOTES:
 1. THERE MAY BE ASBESTOS CONTAINING MATERIALS PRESENT THAT WERE NOT LOCATED DURING BUILDING INSPECTIONS
 2. REFER TO THE ASBESTOS INVENTORY SURVEY SHEET FOR MORE INFORMATION
 3. DO NOT DISTURB ASBESTOS. FOR HANDLING PROCEDURES CALL CENTRAL CONTROL AT 986-2382

ASBESTOS LOCATIONS			
BUILDING:	LO-11 CANADA POST TOWER 266 GRAHAM AVENUE WINNIPEG, MANITOBA		
REVISED BY:	DATE:	SCALE:	SHEET #:
REM	JUNE 11, 2018	N.T.S.	1/2

CITY OF WINNIPEG
 PLANNING, PROPERTY & DEVELOPMENT DEPARTMENT
 MUNICIPAL ACCOMMODATIONS DIVISION
 4th FLOOR - 185 KING STREET
 WINNIPEG, MANITOBA R3B 1J1
 PHONE: (204) 986-7266
 FAX: (204) 986-7311

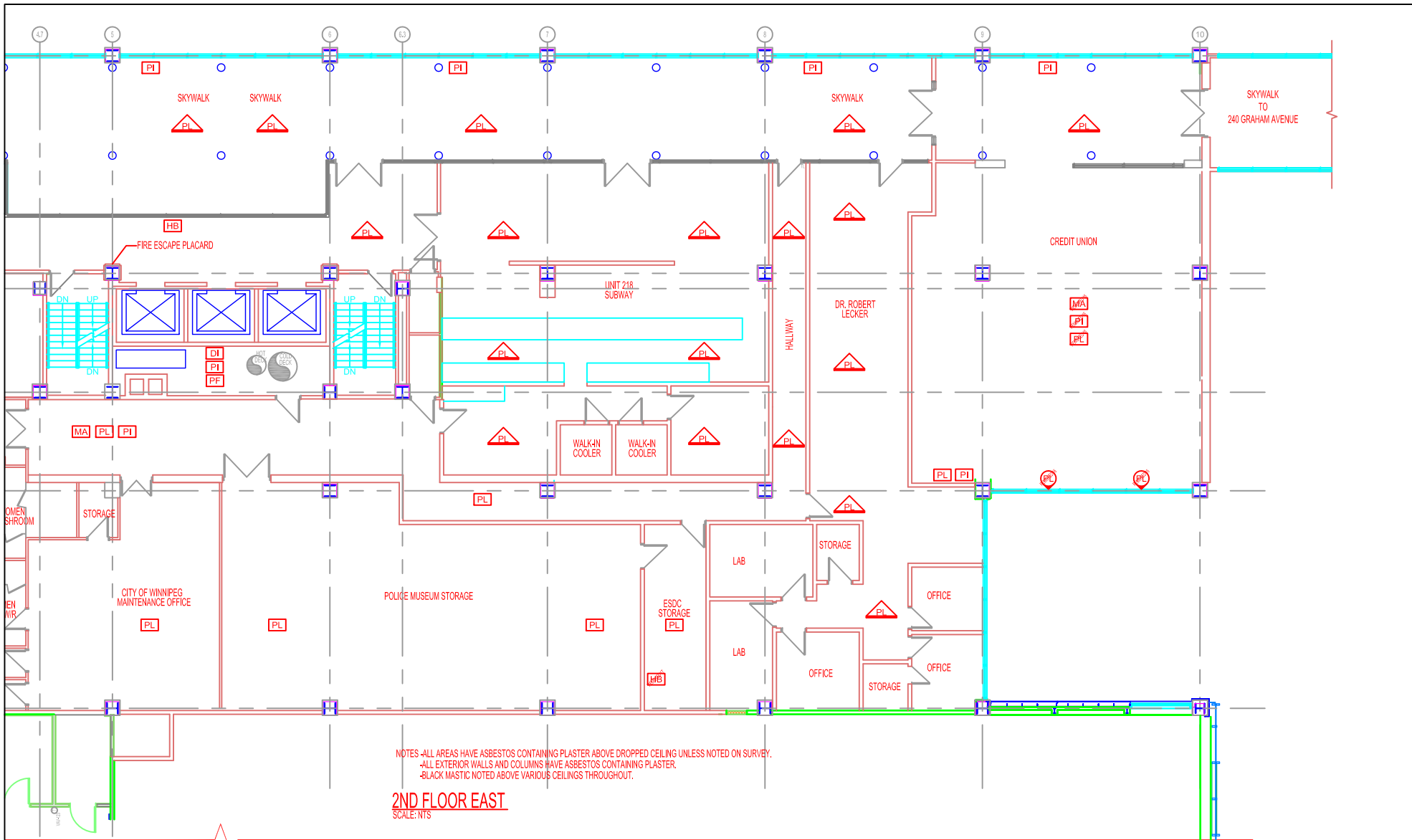

NOTES - ALL AREAS HAVE ASBESTOS CONTAINING PLASTER ABOVE DROPPED CEILING UNLESS NOTED ON SURVEY.
 - ALL EXTERIOR WALLS AND COLUMNS HAVE ASBESTOS CONTAINING PLASTER.
 - BLACK MASTIC NOTED ABOVE VARIOUS CEILINGS THROUGHOUT.

2ND FLOOR EAST
 SCALE: N.T.S.

ATTACHED TO 245 SMITH STREET BUILDING

LEGEND

GENERAL LABELS	ON CEILING	ABOVE CEILING	UNDER FLOORING	WALL DETAIL	ENCAPSULATED ASBESTOS
?? =	??	??	??	??	??
AF: ASBESTOS FABRIC	FL: FLOOR LEVELING CMP	ST: STIPPLE CEILING			
BR: BOILER REFRACTORY	F9: 9X9 FLOOR TILE	SO: SPRAY ON			
CA: CAULKING	F12: 12X12 FLOOR TILE	ST: STUCCO			
C12: 12X12 CEILING TILE	HB: HARDBOARD	TI: TANK INSULATION			
C24: 24X24 CEILING TILE	MA: MASTIC	TP: TRANSITE PIPE			
C48: 24X48 CEILING TILE	PF: PIPE FITTING INSULATION	VE: VERMICULITE			
DC: DRYWALL COMPOUND	PI: PIPE INSULATION				
DI: DUCT INSULATION	PL: PLASTER				
FS: SHEET FLOORING	RD: ROOF DRAIN				

NOTES:
 1. THERE MAY BE ASBESTOS CONTAINING MATERIALS PRESENT THAT WERE NOT LOCATED DURING BUILDING INSPECTIONS
 2. REFER TO THE ASBESTOS INVENTORY SURVEY SHEET FOR MORE INFORMATION
 3. DO NOT DISTURB ASBESTOS. FOR HANDLING PROCEDURES CALL CENTRAL CONTROL AT 986-2382

ASBESTOS LOCATIONS			
BUILDING:	LO-11 CANADA POST TOWER 266 GRAHAM AVENUE WINNIPEG, MANITOBA		
REVISED BY:	DATE:	SCALE:	SHEET #:
REM	JUNE 11, 2018	N.T.S.	2/2

CITY OF WINNIPEG
 PLANNING, PROPERTY & DEVELOPMENT DEPARTMENT
 MUNICIPAL ACCOMMODATIONS DIVISION
 4th FLOOR - 185 KING STREET
 WINNIPEG, MANITOBA R3B 1J1
 PHONE: (204) 986-7266
 FAX: (204) 986-7311