

ISO A1 - 594mm x 841mm

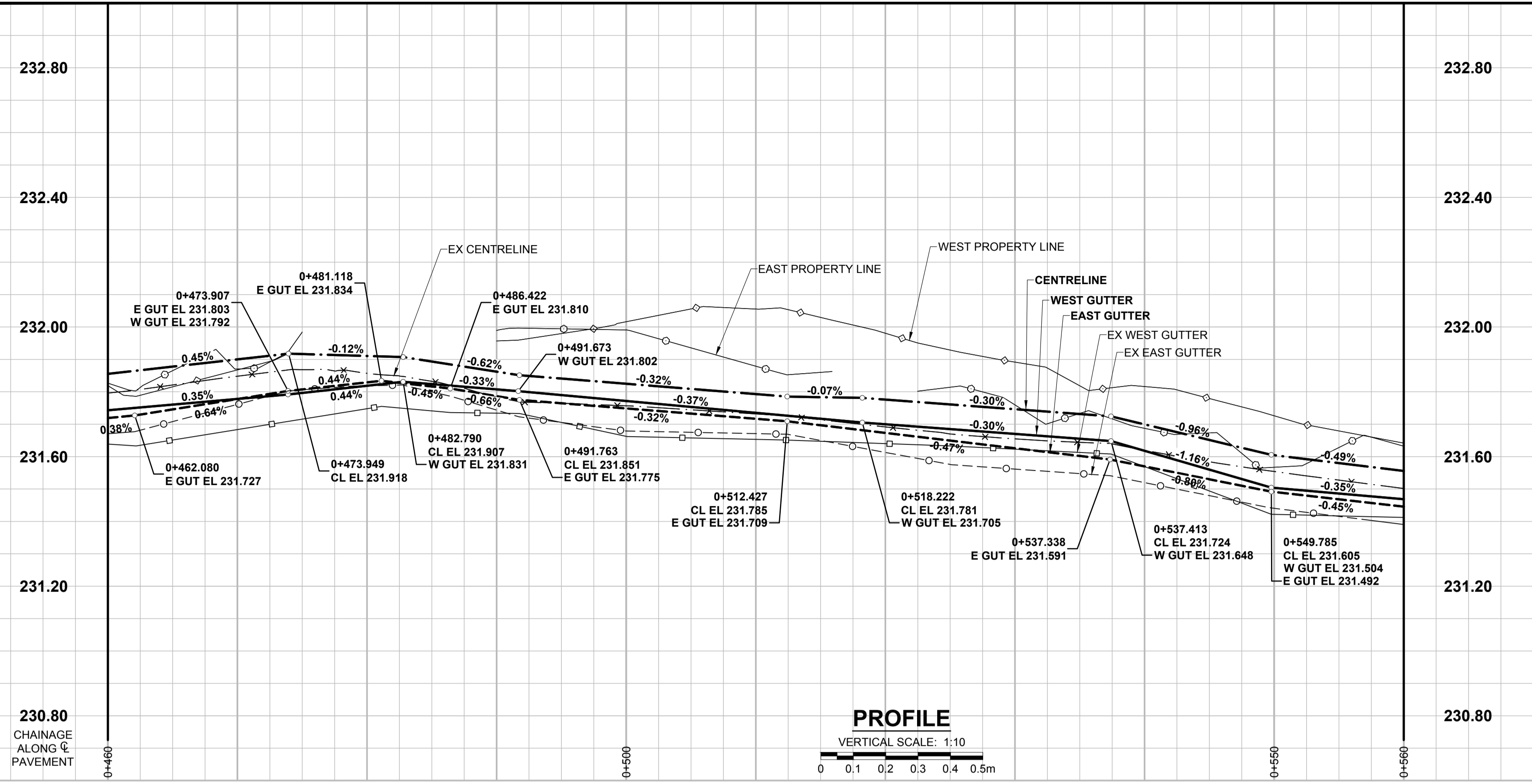

- NOTES**
- ADJUST MH AND CB RIMS TO NEW GRADES.
 - LAMP STANDARDS, HYDRO POLES, AND ANCHORS THAT REQUIRE TEMPORARY SUPPORT, REMOVAL OR REPLACEMENT, TO BE DONE SO AT THE EXPENSE OF THE CONTRACTOR AS NECESSARY.
 - CONTRACTOR TO REGRADE/RENEW EXISTING PRIVATE SIDEWALKS TO LIMITS AS SHOWN. SIDEWALKS TO BE RENEWED WITH CONCRETE UNLESS NOTED OTHERWISE.
 - CONTRACTOR TO TAKE PRECAUTIONARY STEPS TO PROTECT EXISTING TREES WITHIN THE LIMITS OF CONSTRUCTION FROM DAMAGE FROM CONSTRUCTION ACTIVITIES AS OUTLINED IN THE SPECIFICATIONS.
 - CONTRACTOR TO CONFIRM THE LOCATION OF ALL UTILITIES/SERVICES IN THE FIELD PRIOR TO CONSTRUCTION.
 - MODIFIED BARRIER CURB TO BE USED AT ALL INTERSECTION RADII, BACK LANE RADII AND BULLNOSES.
 - CONTRACTOR TO OVERLAY DRIVEWAYS TO ENSURE POSITIVE DRAINAGE TO NEW STREET GRADES. FINAL LIMITS TO BE DETERMINED IN THE FIELD BY CONTRACT ADMINISTRATOR.
 - CB SD-023 & SD-024 OFFSETS ARE DIMENSIONED TO BOC. CB SD-025 OFFSETS ARE DIMENSIONED O/C.
 - REFER TO BID OPPORTUNITY FOR DETAILS REGARDING TRAFFIC MANAGEMENT.
 - ADD 200.000 m TO ABBREVIATED ELEVATIONS TO OBTAIN GEODETIC ELEVATIONS.

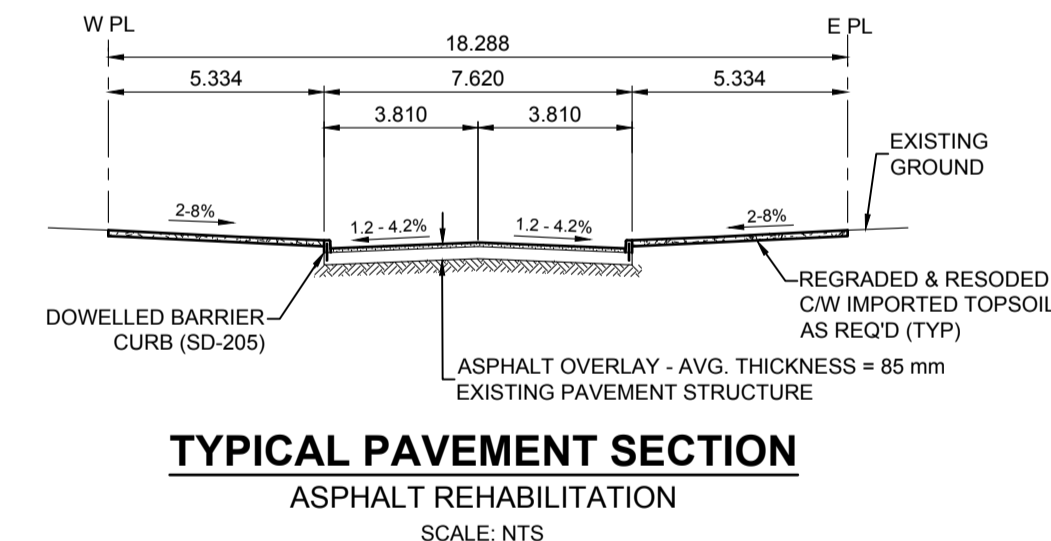
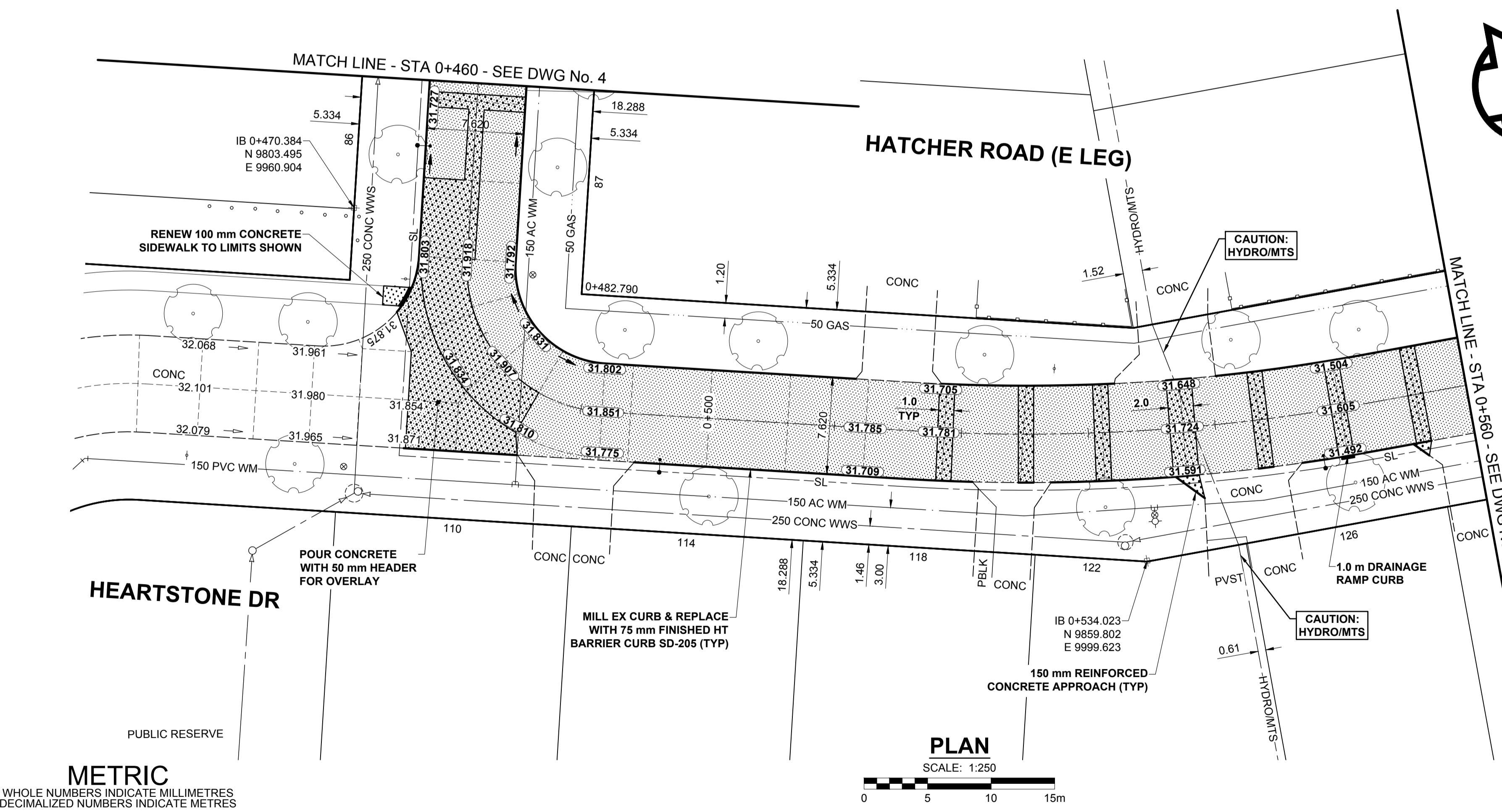

METRIC
WHOLE NUMBERS INDICATE MILLIMETRES
DECIMALIZED NUMBERS INDICATE METRES

EXISTING	LEGEND - PLAN	NEW	EXISTING	LEGEND - PLAN	NEW	EXISTING	LEGEND - PLAN	NEW
(Symbol)	GAS	(Symbol)	MANHOLE	(Symbol)	CONCRETE PAVEMENT	(Symbol)	LOCATION APPROVED UNDERGROUND STRUCTURES	(Symbol)
(Symbol)	MTS HANDWELL/PEDESTAL	(Symbol)	CATCH BASIN/CATCH PIT	(Symbol)	CONC SIDEWALK/MEDIAN	(Symbol)		(Symbol)
(Symbol)	HYDRO HANDWELL/CABINET	(Symbol)	CURB INLET WITH BOX	(Symbol)	ASPHALT PAVEMENT	(Symbol)		(Symbol)
(Symbol)	CATV/FIBRE OPTIC	(Symbol)	TREE	(Symbol)	PAVING STONE	(Symbol)		(Symbol)
(Symbol)	TRAFFIC SIGNALS/PIT	(Symbol)	TEST HOLE	(Symbol)	GRAVEL	(Symbol)		(Symbol)
(Symbol)	LAND DRAINAGE SEWER	(Symbol)	PROPERTY LINE	(Symbol)	RAMP CURB	(Symbol)		(Symbol)
(Symbol)	SANITARY/COMBINED SEWER	(Symbol)	SURVEY BAR	(Symbol)	PLANING/REMOVAL	(Symbol)		(Symbol)
(Symbol)	CB LEAD/SSP/DCP	(Symbol)	FENCE	(Symbol)		(Symbol)		(Symbol)
(Symbol)	WATERMAIN	(Symbol)	BOC/EDGE OF PAVEMENT	(Symbol)		(Symbol)		(Symbol)
(Symbol)	SUBDRAIN	(Symbol)	ELEVATION	(Symbol)		(Symbol)		(Symbol)
(Symbol)	DITCH	(Symbol)	TRAFFIC SIGN	(Symbol)		(Symbol)		(Symbol)

LOCATION APPROVED UNDERGROUND STRUCTURES
SURF. U/G STRUCTURES COMMITTEE DATE
NOTE: LOCATION OF UNDERGROUND STRUCTURES AS SHOWN ARE BASED ON THE BEST INFORMATION AVAILABLE BUT NO GUARANTEE IS GIVEN THAT ALL EXISTING UTILITIES ARE SHOWN OR THAT THE GIVEN LOCATIONS ARE EXACT. CONFIRMATION OF EXISTENCE AND EXACT LOCATION OF ALL SERVICES MUST BE OBTAINED FROM THE INDIVIDUAL UTILITIES BEFORE PROCEEDING WITH CONSTRUCTION.

No.	REVISIONS	DATE	BY
B	ISSUED FOR TENDER	18/03/27	GFC
A	ISSUED FOR CLIENT REVIEW	18/02/09	GFC

DESIGNED BY	GFC	CHECKED BY	WRJ
DRAWN BY	DML	APPROVED BY	BWB
DATE	18/02/01	RELEASED FOR CONSTRUCTION	

PRELIMINARY DRAWING
NOT TO BE USED FOR CONSTRUCTION
CONSULTANT FILE NAME
1800598-Hatcher-PP-04.dwg

THE CITY OF WINNIPEG
PUBLIC WORKS DEPARTMENT
ENGINEERING DIVISION
2018 LOCAL STREETS PACKAGE
HATCHER ROAD
BOURNAIS DR TO ROUGEAU AVE
REHABILITATION
PAVING AND GRADING
STA 0+460 TO STA 0+560

CITY DRAWING NUMBER
N/A
SHEET 5 OF 18
DRAWING No.
5

ENGINEERS GEOSCIENTISTS MANITOBA
Certificate of Authorization
MORRISON HERSHFIELD
No. 1736
BID OPPORTUNITY No. 123-2017

P:\2018\1800598\Local Streets Program\18-05-05009_CAD\07_Sheets\PAET_A1\1800598-Hatcher-PP-04.dwg Last Saved: 3/26/2018 12:54 PM by Dave Lane