

- NOTES**
- ADJUST MH AND CB RIMS TO NEW GRADES.
 - LAMP STANDARDS, HYDRO POLES, AND ANCHORS THAT REQUIRE TEMPORARY SUPPORT, REMOVAL OR REPLACEMENT, TO BE DONE SO AT THE EXPENSE OF THE CONTRACTOR AS NECESSARY.
 - CONTRACTOR TO REGRADE/RENEW EXISTING PRIVATE SIDEWALKS TO LIMITS AS SHOWN. SIDEWALKS TO BE RENEWED WITH CONCRETE UNLESS NOTED OTHERWISE.
 - CONTRACTOR TO TAKE PRECAUTIONARY STEPS TO PROTECT EXISTING TREES WITHIN THE LIMITS OF CONSTRUCTION FROM DAMAGE FROM CONSTRUCTION ACTIVITIES AS OUTLINED IN THE SPECIFICATIONS.
 - CONTRACTOR TO CONFIRM THE LOCATION OF ALL UTILITIES/SERVICES IN THE FIELD PRIOR TO CONSTRUCTION.
 - CB SD-023 & SD-024 OFFSETS ARE DIMENSIONED TO BOC. CB SD-025 OFFSETS ARE DIMENSIONED O/C.
 - IN GENERAL, PAVEMENT AND SIDEWALK AREAS TO BE REMOVED. MATCH RECONSTRUCTION LIMITS.
 - REFER TO BID OPPORTUNITY FOR DETAILS REGARDING TRAFFIC MANAGEMENT.
 - EXISTING LONG WATER SERVICES TO BE INSULATED (SD-018). REFER TO BID OPPORTUNITY FOR FURTHER REQUIREMENTS AND AS NOTED IN PLAN.
 - ALL COSTS, MATERIALS AND LABOR ASSOCIATED WITH THE RESTORATION OF THE CATHODIC PROTECTED WATERMAIN WILL BE RESPONSIBILITY OF THE CONTRACTOR.
 - MODIFIED BARRIER CURB & GUTTER INLET FRAME & COVER TF-122.
 - ADD 200.000 m TO ABBREVIATED ELEVATIONS TO OBTAIN GEODETIC ELEVATIONS.

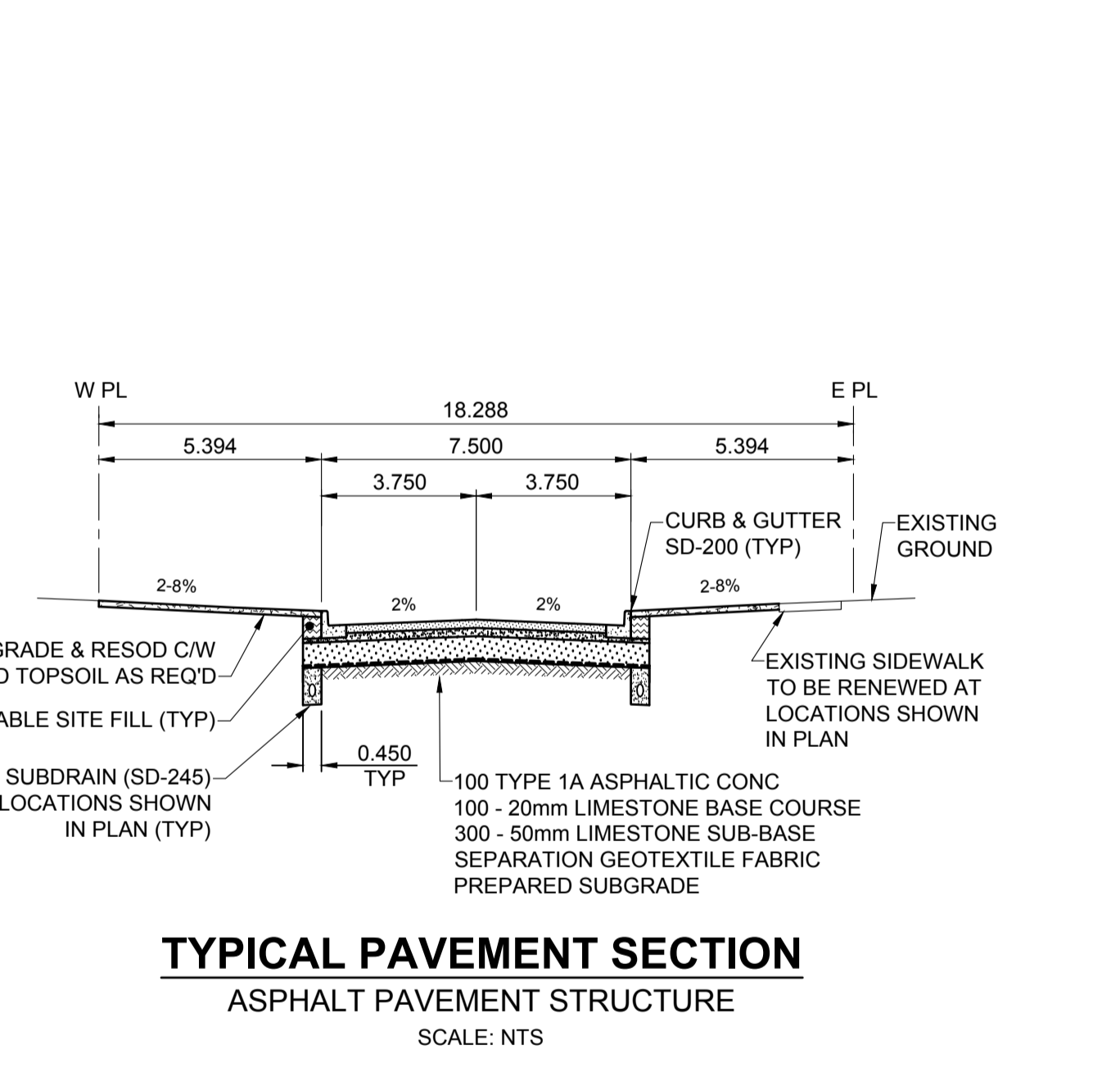
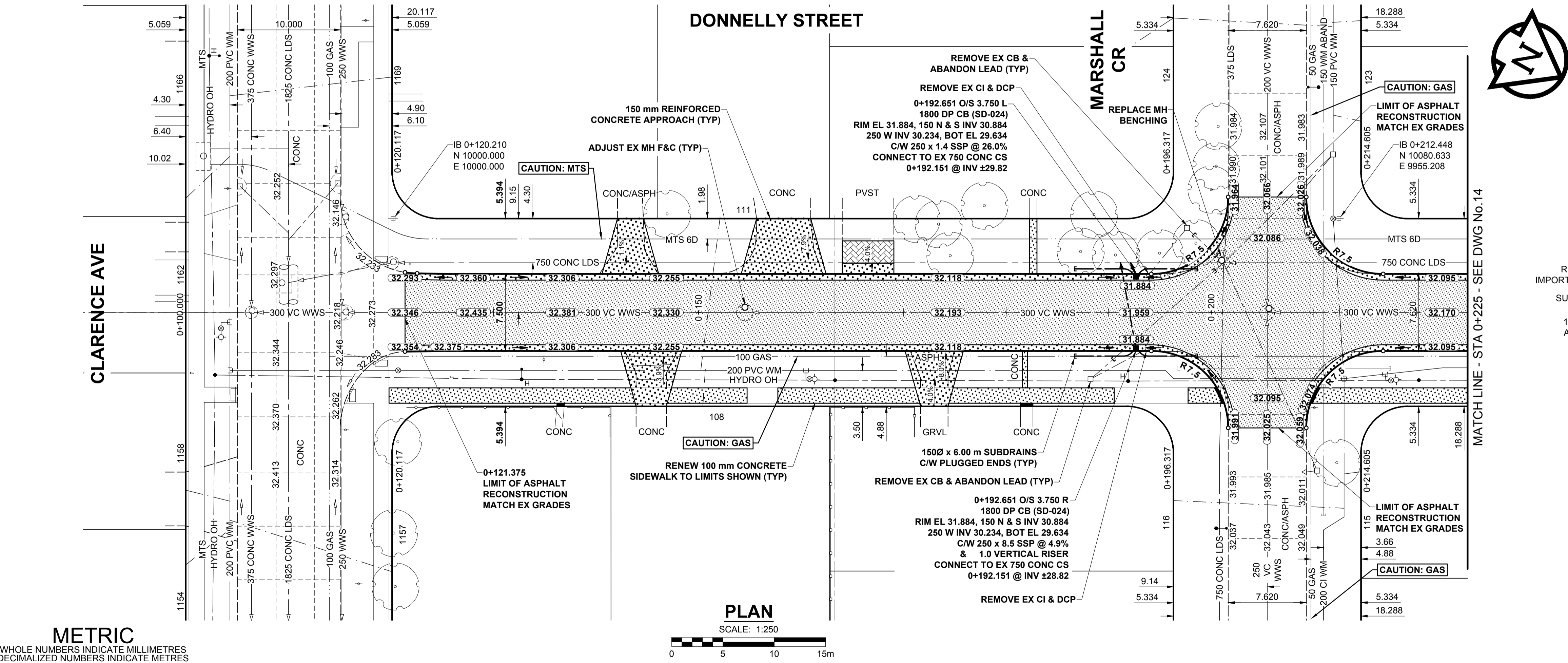

METRIC
WHOLE NUMBERS INDICATE MILLIMETRES
DECIMALIZED NUMBERS INDICATE METRES

EXISTING	NEW	EXISTING	NEW	EXISTING	NEW	EXISTING	NEW
MTS HANDWELL/PEDESTAL	MTS HANDWELL/PEDESTAL	CATCH BASIN/CATCH PIT	CATCH BASIN/CATCH PIT	CONC SIDEWALK/MEDIAN	CONC SIDEWALK/MEDIAN	LOCATION APPROVED	LOCATION APPROVED
HYDRO HANDWELL/CABINET	HYDRO HANDWELL/CABINET	CURB INLET WITH BOX	CURB INLET WITH BOX	ASPHALT PAVEMENT	ASPHALT PAVEMENT	UNDERGROUND STRUCTURES	UNDERGROUND STRUCTURES
CATV/FIBRE OPTIC	CATV/FIBRE OPTIC	TREE	TREE	PAVING STONE	PAVING STONE	DATE	DATE
TRAFFIC SIGNALS/PIT	TRAFFIC SIGNALS/PIT	TEST HOLE	TEST HOLE	GRAVEL	GRAVEL	NOTE:	NOTE:
LAND DRAINAGE SEWER	LAND DRAINAGE SEWER	PROPERTY LINE	PROPERTY LINE	RAMP CURB	RAMP CURB	LOCATION OF UNDERGROUND STRUCTURES	LOCATION OF UNDERGROUND STRUCTURES
SANITARY/COMBINED SEWER	SANITARY/COMBINED SEWER	SURVEY BAR	SURVEY BAR	PLANING/REMOVAL	PLANING/REMOVAL	AS SHOWN ARE BASED ON THE BEST	AS SHOWN ARE BASED ON THE BEST
CB LEAD/SSP/DCP	CB LEAD/SSP/DCP	FENCE	FENCE			INFORMATION AVAILABLE BUT NO	INFORMATION AVAILABLE BUT NO
WATERMAIN	WATERMAIN	BOC/EDGE OF PAVEMENT	BOC/EDGE OF PAVEMENT			GUARANTEE IS GIVEN THAT ALL EXISTING	GUARANTEE IS GIVEN THAT ALL EXISTING
SUBDRAIN	SUBDRAIN	ELEVATION	ELEVATION			UTILITIES ARE SHOWN OR THAT THE GIVEN	UTILITIES ARE SHOWN OR THAT THE GIVEN
DITCH	DITCH	TRAFFIC SIGN	TRAFFIC SIGN			LOCATIONS ARE EXACT. CONFIRMATION OF	LOCATIONS ARE EXACT. CONFIRMATION OF
						EXISTENCE AND EXACT LOCATION OF ALL	EXISTENCE AND EXACT LOCATION OF ALL
						SERVICES MUST BE OBTAINED FROM THE	SERVICES MUST BE OBTAINED FROM THE
						INDIVIDUAL UTILITIES BEFORE PROCEEDING	INDIVIDUAL UTILITIES BEFORE PROCEEDING
						WITH CONSTRUCTION.	WITH CONSTRUCTION.

LOCATION APPROVED
UNDERGROUND STRUCTURES

DATE

NOTE:
LOCATION OF UNDERGROUND STRUCTURES AS SHOWN ARE BASED ON THE BEST INFORMATION AVAILABLE BUT NO GUARANTEE IS GIVEN THAT ALL EXISTING UTILITIES ARE SHOWN OR THAT THE GIVEN LOCATIONS ARE EXACT. CONFIRMATION OF EXISTENCE AND EXACT LOCATION OF ALL SERVICES MUST BE OBTAINED FROM THE INDIVIDUAL UTILITIES BEFORE PROCEEDING WITH CONSTRUCTION.

No.	REVISIONS	DATE	BY
B	ISSUED FOR TENDER	18/03/28	GFC
A	ISSUED FOR CLIENT REVIEW	18/03/02	GFC

MORRISON HERSHFIELD

DESIGNED BY: GFC
CHECKED BY: RPB

DRAWN BY: DML
APPROVED BY: BWB

RELEASED FOR CONSTRUCTION

HOR SCALE: 1:250
VERT SCALE: 1:10

DATE: 18/03/02

PROFESSIONAL'S SEAL

PRELIMINARY DRAWING

NOT TO BE USED FOR CONSTRUCTION

CONSULTANT FILE NAME
1700095-Donnelly-PP-01.dwg

THE CITY OF WINNIPEG
PUBLIC WORKS DEPARTMENT
ENGINEERING DIVISION

2018 LOCAL STREETS PACKAGE
DONNELLY STREET
CLARENCE AVE TO WALLER AVE
ASPHALT RECONSTRUCTION
PAVING AND GRADING
CLARENCE AVE TO STA 0+225

CITY DRAWING NUMBER: N/A
SHEET 13 OF 25
DRAWING No. 13

BID OPPORTUNITY No. 127-2018